



TARPING SYSTEMS & ACCESSORIES

P/N 1114952 Rev. L

OWNER'S MANUAL



Value Series Swing Arm Electric Shur-Lok®

READ BEFORE INSTALLING

PO BOX 713 ■ 2309 SHUR-LOK STREET ■ YANKTON, SD 57078-0713
PHONE 1-800-4-SHUR-LOK (1-800-474-8756) ■ FAX 605-665-0501
www.shurco.com

SHOP ONLINE: www.shopshurco.com

SHIPPING. Orders are shipped F.O.B. from the Shur-Co®, LLC sites listed below. No full freight is allowed or prepaid shipment accepted unless quoted and approved in writing prior to acceptance of the order. All shipments are made by the most reasonable means in accordance with size and weight of order, unless specified routing instructions are furnished by the customer. Shipments are made daily via U.P.S. and common carrier. Claims for shortages must be made within 10 days. All claims for damages or loss in transit must be made with the carrier. No collect calls will be accepted. To ensure delivery of orders, we need your full street address and phone number. When you receive your shipment, examine it carefully. Be sure all cartons listed on the delivery sheet are accounted for. Large items may be packaged separately. If a carton is damaged, open it and inspect the contents before signing for delivery. If merchandise is damaged, describe damage on the delivery receipt. Failure on your part to document damaged or missing merchandise on the delivery receipt releases the carrier of all liability; repair or replacement will be the customer's responsibility.

WARRANTY. We warrant all new products are free of defects in materials and workmanship.* This warranty is effective if products are properly installed and used for the purpose for which they were intended and applies to the original buyer only. Except as set forth above or in any product-specific warranty documentation, we make no other warranties, express or implied, including but not limited to warranties of merchantability of fitness for a particular use.

Returns of a product for warranty must be accompanied by a Return Merchandise Authorization number (RMA#), obtained by calling Customer Service at 866-748-7435, and sent, with freight paid by us, to Shur-Co®, LLC, 2309 Shur-Lok St., PO Box 713, Yankton, SD 57078. All products returned without an RMA# will be refused. When we issue the RMA#, we will also issue a call tag to have UPS (or other freight company) pick up the product. C.O.D. returns not accepted. We will pay no storage fees for a warranty product return prior to pick by us or the freight company. If a warranty product return is scheduled to be picked up by us, we will pick up the product at our earliest convenience.

If a product returned is found, in our judgement, to be defective in material or workmanship, our obligation under this warranty is limited to the repair or replacement of the product, which will be made by us. Repair or replacement will be at our discretion, with replacements being made using current products performing in the equivalent function. Labor charges, other than those incurred at our factory, including, but not limited to, any labor to install a repaired or replacement product, are not covered under this warranty. All expenses associated with delivering defective products to our factory and delivering repaired or replacement products from our factory to the owner will be paid by us.

If the product returned is found, in our judgement, to be non-warrantable, the owner will be contacted to authorize repair work, purchase of a replacement product or return of the product, all of which will be at the owner's expense. Payment authorization must be received by us before any non-warrantable product is repaired, replaced or returned. All expenses associated with delivering the repaired non-warrantable product, a replacement product or the non-warrantable product from our factory to the owner will be paid by the owner.

In no event will we be liable for any damages of any kind to person, product or property, including but not limited to indirect, incidental, special, consequential or punitive damages, or damages for loss of profits or revenue, even if we have been advised of the possibility of such damages. There are no warranties for used products or products that have been repaired, altered, modified or subjected to misuse, negligence or accident. We will not repair or replace products that fail or malfunction due to ordinary wear and tear, except as expressly noted in a product-specific warranty. Use of non-Shur-Co®, LLC parts in conjunction with Shur-Co®, LLC products will void this product warranty.

*Certain products have specific warranties that differ from this warranty, for example motors and electronics. Product-specific warranty documentation is available for these items. In the event of a conflict between this warranty and a product-specific warranty, the product-specific warranty will govern.

RETURN POLICY. All sales final. See WARRANTY above for return details.

OTHER. All prices, product listings, sizes, weights and manufacturing details are subject to change without notice. No person is authorized to modify the foregoing conditions of sale whatsoever.

SHUR-CO®, LLC SERVICE AND DISTRIBUTION CENTERS

Corporate HQ and Outlet Store

SHUR-CO® of SOUTH DAKOTA
2309 Shur-Lok St., PO Box 713
Yankton, SD 57078-0713
Ph 800.474.8756 | Fax 605.665.0501

ShurTite™ Service Centers

SHUR-CO® of CANADA
490 Elgin St., Unit #1
Brantford, Ontario N3S 7P8
Ph 800.265.0823 | Fax 519.751.3997

SHUR-CO® of SIOUX FALLS
47184 258th St., Suite B
Sioux Falls, SD 57107
Ph 844.573.9322 | Fax 605.543.5469

SHUR-CO® of ILLINOIS
Ph 866.356.0246 | Fax 217.877.8270

SHUR-CO® of OHIO
Ph 866.356.0242 | Fax 330.297.5599

SHUR-CO® of COLORADO
10220 Brighton Rd., Unit #1
Henderson, CO 80640
Ph 866.355.9173 | Fax 303.289.2298

SHUR-CO® of FLORIDA
3353 SE Gran Park Way
Stuart, FL 34997
Ph 800.327.8287 | Fax 772.287.0431

SHUR-CO® of ILLINOIS
3993 E. Mueller Ave.
Decatur, IL 62526
Ph 866.356.0246 | Fax 217.877.8270

SHUR-CO® of IOWA
3839 Midway Blvd.
Ft. Dodge, IA 50501
Ph 866.356.0245 | Fax 515.576.5578

SHUR-CO® of MICHIGAN
5100 Lakeshore Dr.
Lexington, MI 48450
Ph 800.327.8287 | Fax 772.287.0431

SHUR-CO® of NORTH DAKOTA
1746 4th Ave. NW
West Fargo, ND 58078
Ph 877.868.4488 | Fax 701.277.1283

SHUR-CO® of OHIO
1100 N. Freedom, St. Rt. 88 & 14
Ravenna, OH 44266
Ph 866.356.0242 | Fax 330.297.5599

SHUR-CO® of TEXAS
34505 I-10 West, S. Frontage Rd.
Brookshire, TX 77423
Ph 866.689.0039 | Fax 281.934.3311

SHUR-CO® UK, Ltd.
Unit 41 Rochester Airport Estates
Laker Rd., Rochester, Kent ME1 3QX
Ph +44 (0)1795.473499
Fax +44 (0)871.272.8278

For more info, log on to our website:
www.shurco.com

MESSAGE TO OWNERS

Thank you for buying this tarping system from Shur-Co®. We appreciate your confidence in our products. Please read and thoroughly understand this manual before installing and/or operating this system.

Pay particular attention to important safety and operating instructions, as well as warnings and cautions. The hazard symbol  is used to alert users to potentially hazardous conditions and is followed by caution, warning or danger messages.

Failure to READ AND FOLLOW INSTRUCTIONS could result in failure of your tarping system and/or personal injury. Your trailer requirements may, however, call for minor variations to these instructions.

Please inspect your tarping system periodically. Repair or replace worn or damaged parts to your system.

QUESTIONS? CALL OUR HELP LINE:

1-866-748-7435

MON-FRI 8 AM-5 PM CENTRAL TIME

SAFETY

We at Shur-Co® are concerned with your safety and the safety of all those operating this system. Therefore, we have provided safety decals at various locations on your tarping system. Keep decals as clean as possible at all times. Replace any decal that has become worn or damaged, painted over or otherwise difficult to read. Replacement decals are available through Shur-Co® dealers.

PARTS INSPECTION

Inspect all parts in your Value Series Electric kit upon arrival. Please inspect your tarping system regularly, and repair or replace parts when continued use could damage your system.

SAFETY INSTRUCTIONS

- 1. Always wear safety glasses during installation and operation.**
- 2. Stay clear of moving parts.**
- 3. No other use of this system is authorized, except as designed.**

RUST PREVENTION

To prevent rust, paint all exposed metal, such as weld seams and/or metal exposed by grinding or cutting, with corrosion-resistant paint.

TABLE OF CONTENTS

- Hardware Identification..... 1
- Swing Arm, Slide Arm & Motor 2
- Roll Tube Extension..... 3
- Shock Cord..... 4
- Roll Tube Eyes 5-6
- Electric Motor..... 7
- Electric Mounting & Wiring 8-9
- Replacement Parts 10-11

TOOLS REQUIRED

- 1. Welder
- 2. Hammer
- 3. Center Punch or Transfer Punch
- 4. #3 Phillips Insert Bit
- 5. Air or Electric Impact Wrench (9/16" deep socket)
- 6. 7/16" Deep Socket
- 7. 3/8" Combination Wrench
- 8. 9/16" Combination Wrench
- 9. 1/2" Combination Wrench
- 10. 1/8" Hex Wrench Long T-Handle
- 11. 3/16" Hex Wrench Long T-Handle (recommended)
- 12. 5/16" Drill Bit (for 3/8" self-tapping screws)
- 13. 13/32" Drill Bit
- 14. 3/8" Drill Bit
- 15. 1/4" Drill Bit
- 16. 17/64" Drill Bit
- 17. 3/8" Drill
- 18. 2" Hole Saw
- 19. Standard/Flathead Screwdriver
- 20. #2 Phillips Screwdriver
- 21. Utility Knife
- 22. Ratchet
- 23. Hack Saw (metal cutter)
- 24. Pliers
- 25. Snap Ring Pliers
- 26. Wire Cutters
- 27. Grinder
- 28. Tape Measure

A

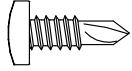

1700398 - Self-Drilling Screw - 1/4" x 3/4"

B

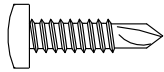

1705198 - Self-Drilling Screw - 1/4" x 1"

C

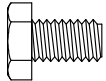

1703171 - Cap Screw - 5/16" x 1/2"

D

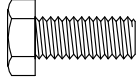

1701045 - Cap Screw - 5/16" x 3/4"

E

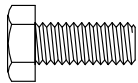

1201269 - Cap Screw - 5/16" x 3/4" - SS

F

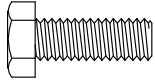

1702926 - Cap Screw - 5/16" x 7/8"

G

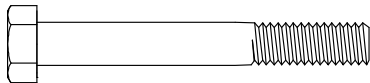

1703237 - Cap Screw - 5/16" x 2 1/2"

H

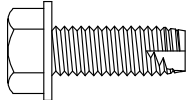

1700400 - Self-Tapping Screw - 3/8" x 1"

J

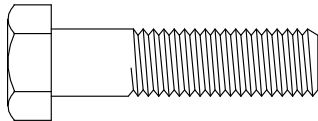

1701042 - Cap Screw - 1/2" x 2"

K

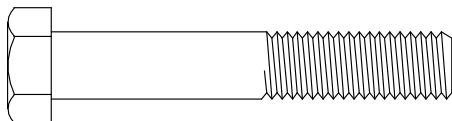

1704779 - Cap Screw - 1/2" x 3"

L



1702492 - Top Lock Nut - 5/16"

M



1700411 - Hex Nut - 5/16"

N



1700419 - Nylon Lock Nut - 5/16"

P



1700407 - Hex Nut - 3/8"

Q

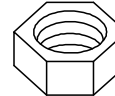

1700413 - Hex Jam Nut - 1/2"

R

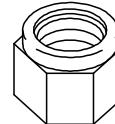

1702115 - Nylon Lock Nut - 1/2"

S

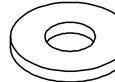

1700428 - Flat Washer - 5/16"

T



1201237 - Flat Washer - 5/16" - SS

U



1700434 - Lock Washer - 3/8"

V

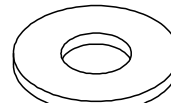

1702114 - Flat Washer - 1/2"

NOTE: Use lock washers and nuts with self-tapping screws whenever possible. A minimum material thickness of 3/16" is required in order to use self-tapping screws without lock washers and nuts. Drill 13/32" holes if lock washers and nuts are used; drill 5/16" holes if lock washers and nuts are not used.

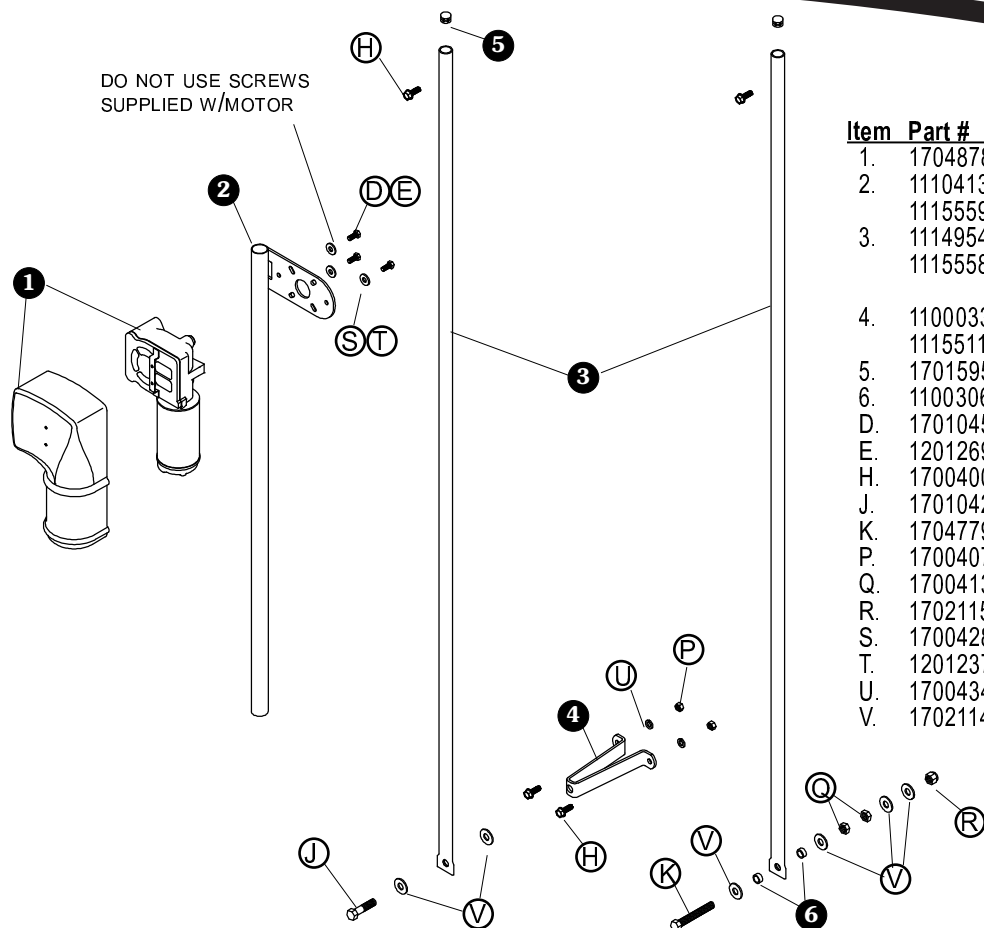

Item	Part #	Description
1.	1704878	Durabuilt Motor - 3 1/8" Shaft
2.	1110413	Slide Arm
	1115559	Slide Arm - SS
3.	1114954	Value Series Electric Swing Arm
	1115558	Value Series - SS
		Electric Swing Arm
4.	1100033	Crank Retainer Standoff - 7"
	1115511	Crank Retainer Standoff - 7" - SS
5.	1701595	End Plug - 1"
6.	1100306	Retainer Bushing - 11/16" x 5/16"
D.	1701045	Cap Screw - 5/16" x 3/4"
E.	1201269	Cap screw - 5/16" x 3/4" - SS
H.	1700400	Self-Tapping Screw - 3/8" x 1"
J.	1701042	Cap Screw - 1/2" x 2"
K.	1704779	Cap Screw - 1/2" x 3"
P.	1700407	Hex Nut - 3/8"
Q.	1700413	Jam Nut - 1/2"
R.	1702115	Nylon Lock Nut - 1/2"
S.	1700428	Flat Washer - 5/16"
T.	1201237	Flat Washer - 5/16" - SS
U.	1700434	Lock Washer - 3/8"
V.	1702114	Flat Washer - 1/2"

STEP 1: Farm bodies. Locate center line on front of box. Drill 9/16" hole on center line 38" to 56" from top of box.

Semi trailers. Locate center line on front of truck box. Drill 5/16" holes through 7" standoff on center line 38" to 56" from top of box.

NOTE: Installation procedures and/or parts used may vary to fit your truck box.

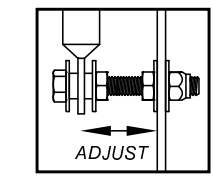
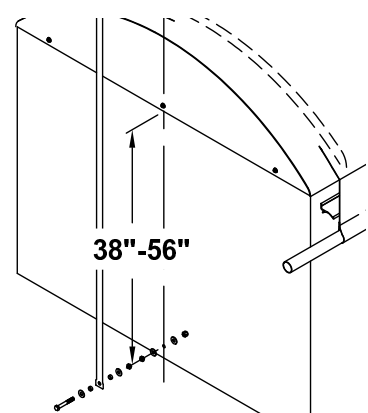

NOTE: Swing arm must operate without interference. Locate hole to allow clearance for swing arm operation.

STEP 2: Fasten as shown below. For farm bodies, adjust as needed to allow clearance for arm and motor, to avoid hitting any obstacles.

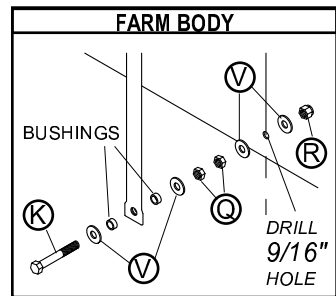
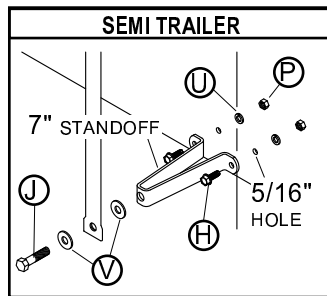

STEP 3: Mount electric motor to upper slide arm, fastening with three screws D or E, and washers S or T.

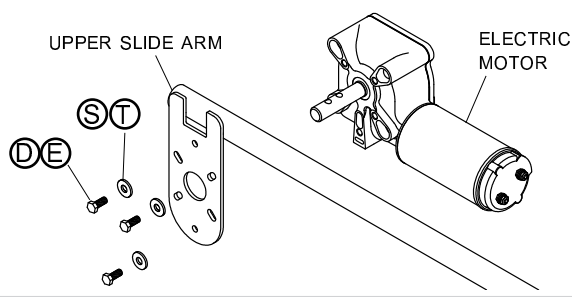

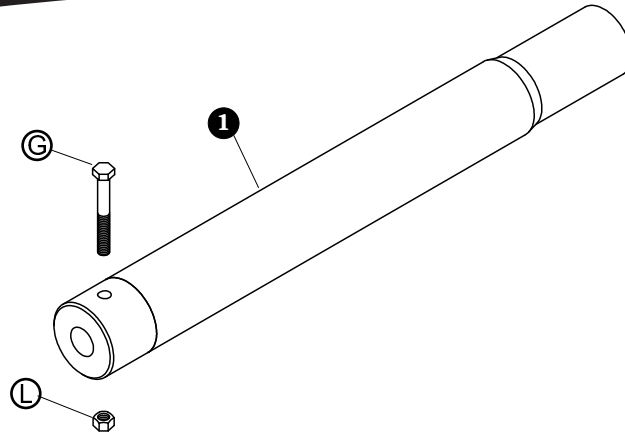

Item	Part #	Description
1.	1114916	Roll Tube Extension w/Adapter
G.	1703237	Cap Screw - 5/16" x 2 1/2"
L.	1702492	Top Lock Nut - 5/16"

STEP 1: Roll tarp closed over box with roll tube hanging below latchplate. Remove crank assembly from roll tube.

STEP 2: Hold motor and install upper slide arm over lower swing arm. Insert motor shaft into roll tube adapter. Fasten with screw **G** and nut **L**. Align swing arm vertically so it swings freely without hitting any obstructions.

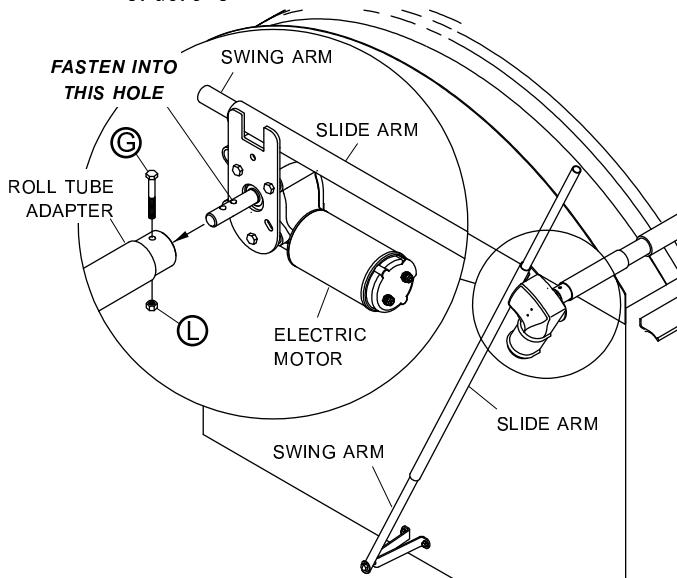

STEP 3: At front of trailer, slide tarp back on roll tube and adjust roll tube away from any obstructions, leaving space for roll tube eye and retaining rings on roll tube.

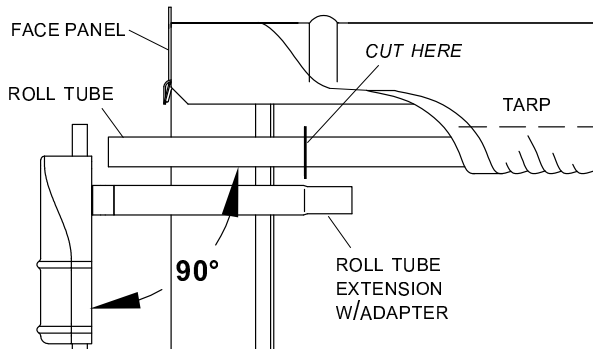

STEP 4: Hold swing/slide arms with motor and roll tube extension 90° to roll tube. Mark roll tube and cut at marked location.

STEP 5: Unfasten and remove motor from roll tube extension. Insert swaged end of roll tube extension w/drive shaft into roll tube. Align extension straight with roll tube and weld all around. Grind smooth.

NOTE: Pull roll tube away from tarp and trailer before welding to protect from weld spatter. Align roll tube extension straight with roll tube before welding so tarp system will roll smoothly.

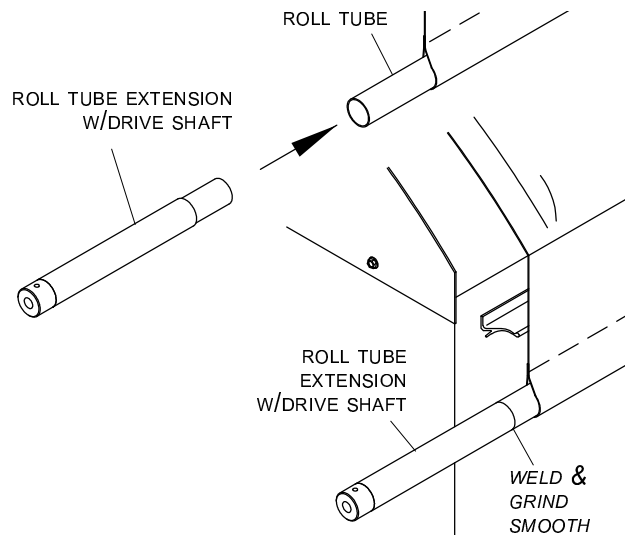

NOTE: To prevent rust, paint all exposed metal, such as weld seams and/or metal exposed by grinding or cutting, with corrosion-resistant paint.

STEP 6: Slide roll tube extension weldment back into position.

Item	Part #	Description
1.	1703445	Shock Cord Eye Bracket
2.	1114948	Shock Cord Tie-Down Strap
3.	1100169	Shock Cord - 138"
H.	1700400	Self-Tapping Screw - 3/8" x 1"

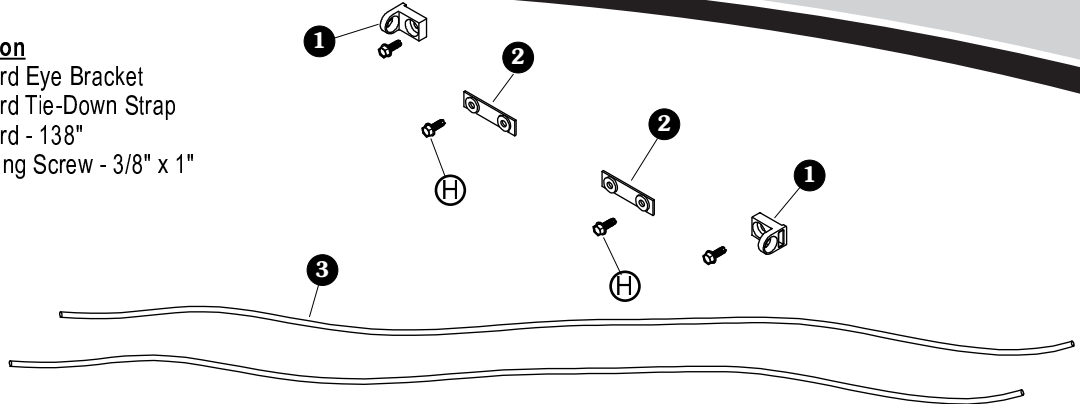

STEP 1: Open tarp against tarp stops. At rear of box and on square front boxes without obstructions, locate eye bracket in configuration shown at left. For non-square front boxes, notch latchplate 1" and align eye bracket with edge of notch on latchplate.

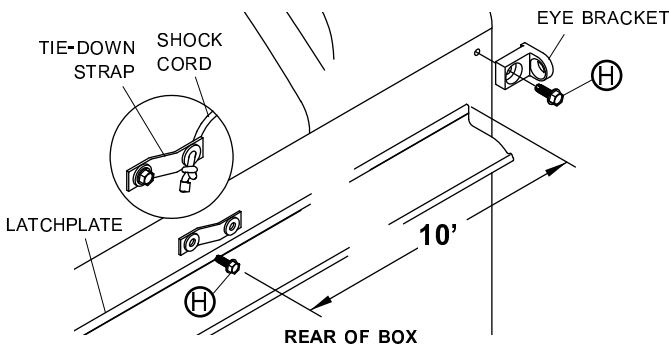
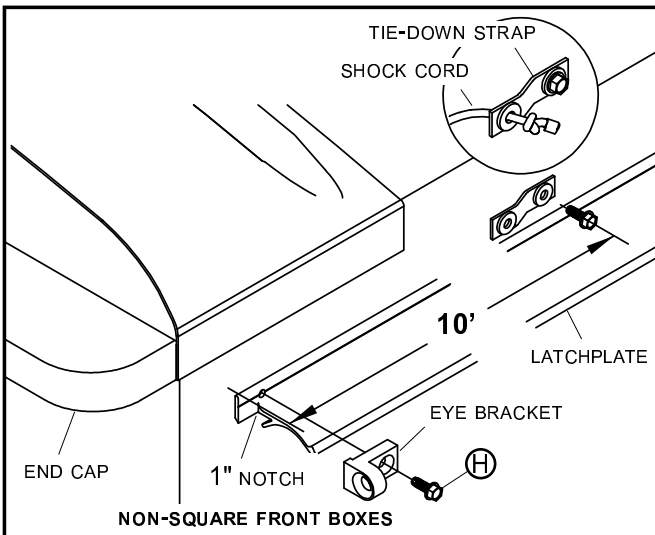
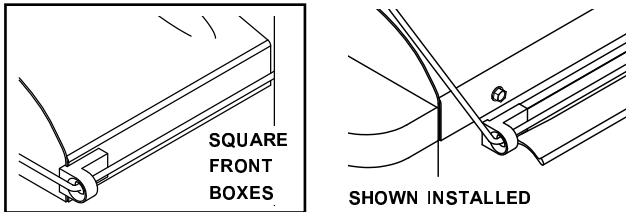

STEP 2: Using eye brackets as a guide, mark and drill 5/16" holes in trailer. Fasten brackets to trailer with screws (H).

STEP 3: Mount shock cord tie-down straps 10' back from outer edges of latchplate. Drill 5/16" holes and fasten with screws (H).

STEP 4: Lead first shock cord through front eye bracket, then through grommet on rear tie-down strap. Lead second shock cord through rear eye bracket, then through front tie-down strap. Tie knots in shock cords at tie-down straps to secure. Trim ends of shock cords and wrap with tape to prevent fraying.

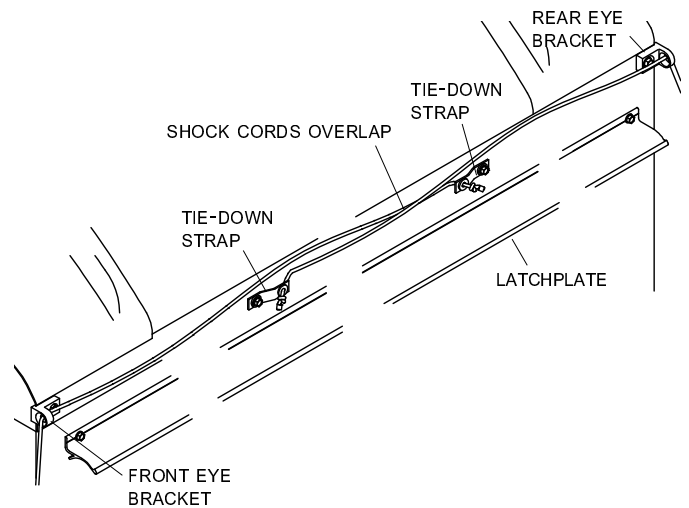

Item	Part #	Description
1.	1701354	Plastic U-Clamp
2.	1704352	Retaining Collar
3.	1114947	Roll Tube Eye
A.	1700398	Self-Drilling Screw - 1/4" x 3/4"
B.	1705198	Self-Drilling Screw - 1/4" x 1"

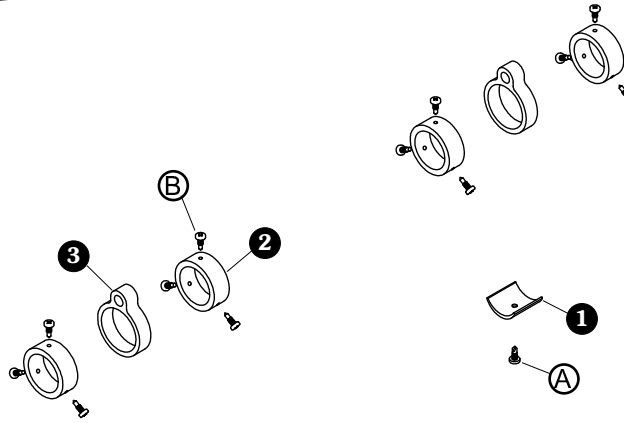

STEP 1: Roll tarp closed and let hang. Slide roll tube eyes and retaining collars onto front and rear of roll tube. Refasten motor to roll tube and re-align swing arm vertically so arm swings freely without interference. When swing arm is aligned and roll tube is in place, secure tarp to roll tube with U-clamps, fastening with screws A.

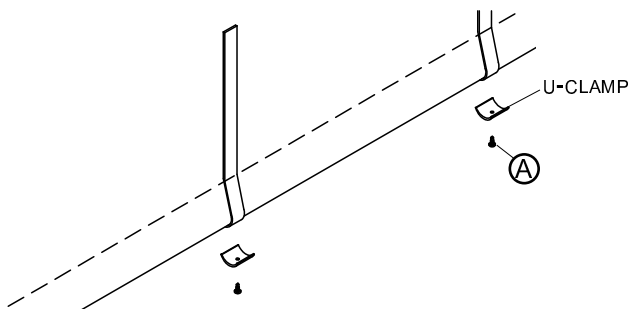

STEP 2: Allow shock cords to hang down. Slide roll tube eyes onto each end of roll tube and align eyes approximately 1" from shock cords, toward outside of trailer. Space retaining rings about 1/8" from each side of roll tube eyes. Tighten screws B to secure retaining rings.

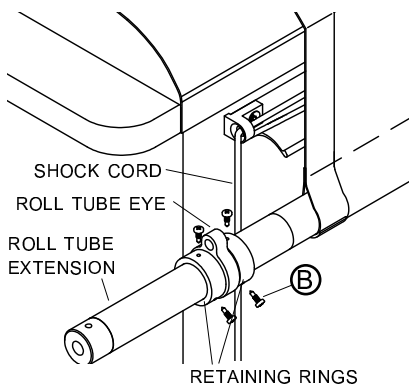

RADIUS-FRONT TRAILER

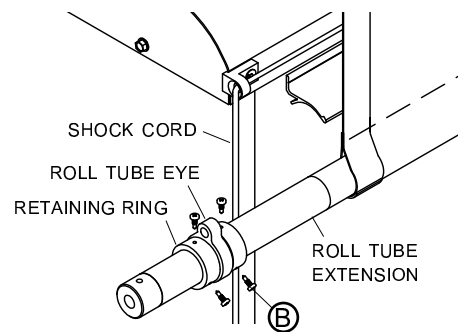

SQUARE-FRONT TRAILER

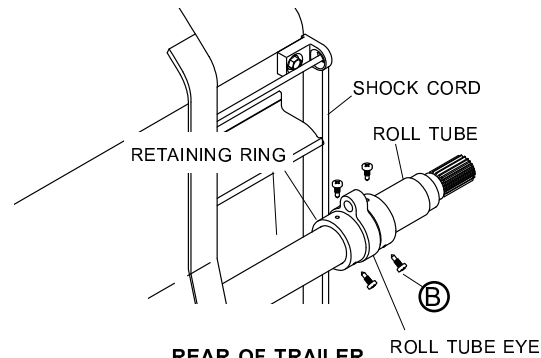

REAR OF TRAILER

STEP 3: With lower swing arm extending past top of slide arm and motor in the most extended position, drill 5/16" hole in lower swing arm. Install screw H to secure slide arm. Remove excess length on swing arm, if required, and install end plug.

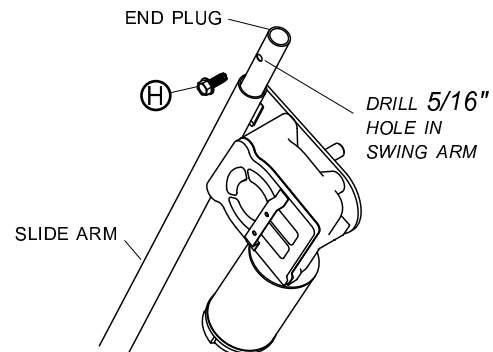

STEP 4: Roll tarp closed tight under latchplate and pull shock cords through roll tube eyes to create tension. Tie permanent knots in shock cords at front and rear of roll tube.

NOTE: Shock cord must not cross over windshield during operation.

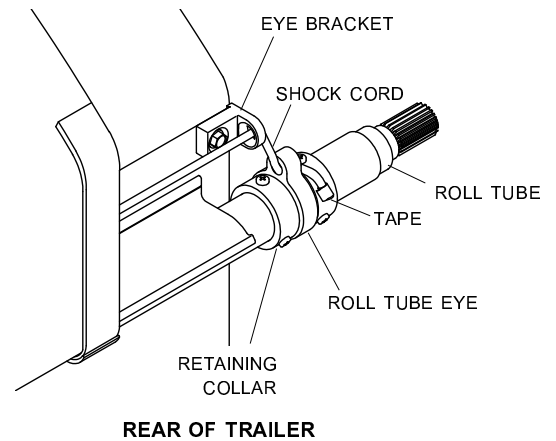
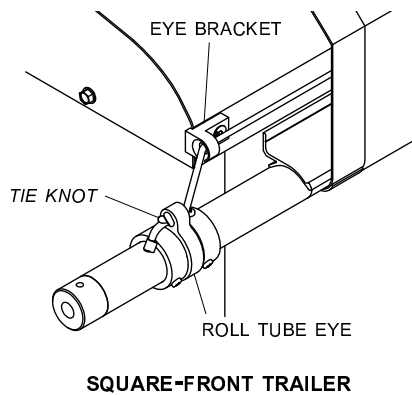
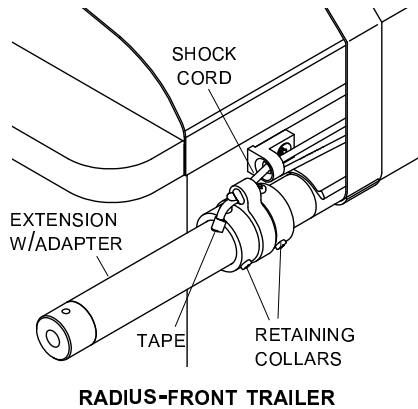

STEP 5: Roll tarp open and closed to make sure roll tube returns correctly. Adjust tension in shock cords as needed. Trim end of shock cord and wrap with tape to prevent fraying.

STEP 1: Electric motor. Connect wires as shown. Push shrink wrap over connections and apply heat to seal.

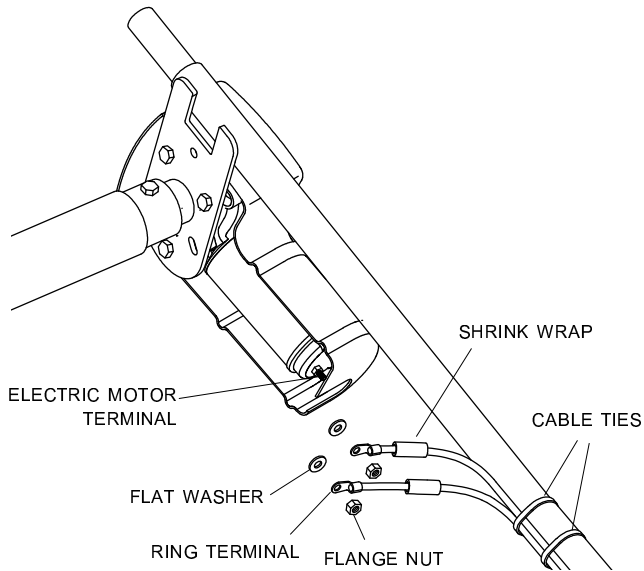

STEP 2: Fasten motor cover to motor with screws supplied.

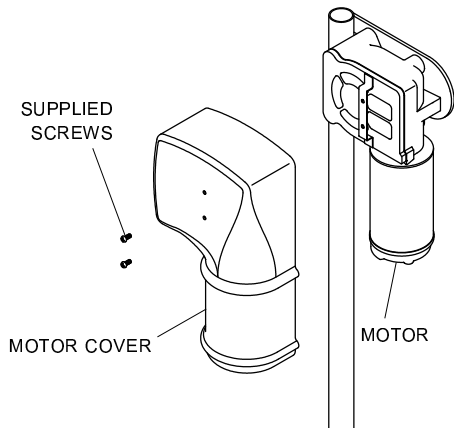

OPERATION:

- A) Check motor direction** by activating switch to “OPEN.” If switch is running system backwards, change wire leads on motor to opposite connections.
- B) Close tarp:** Push switch to “CLOSE” and hold. Observe tarp and release switch when tarp is fully closed.
- C) Open tarp:** Push switch to “OPEN” and hold. Observe tarp and release switch when tarp is fully open.

NOTE: Release switch at end of cycle or modified-reset circuit breaker will trip. After breaker resets, switch will activate motor again. To reduce unnecessary strain on tarp components, release switch at end of each cycle.

NOTE: Pressure Wash. Receiver may be pressure washed, but keep nozzle at least 3' from system while spraying.

⚠ CAUTION

Check all hardware for complete assembly before operating. Inspect system at this time and adjust as required.

Item	Part #	Description
1.	1703896	Solenoid Cover
2.	1116020	Rocker Switch
3.	1701543	Nylon Lock Nut - 1/4"
4.	1703845	Motor-Reversing Solenoid
5.	1704354	40-Amp Modified-Reset Circuit Breaker
6.	1703661	Rocker Switch Mounting Bracket
7.	1700407	Hex Nut - 3/8"
8.	1700434	Lock Washer - 3/8"
9.	1700411	Hex Nut - 5/16"
10.	1109015	Mounting Bracket
11.	1700400	Self-Tapping Screw - 3/8" x 1"
12.	1704573	Conductor Socket Sealed Boot
13.	1115386	Heavy-Duty Dual-Conductor Socket
14.	1701045	Cap Screw - 5/16" x 3/4"
15.	1115385	Heavy-Duty Dual-Conductor Plug
16.	1703245	Ring Terminal - 6 Ga. x #10 Stud
17.	1703244	Ring Terminal - 6 Ga. x 3/8" Stud
18.	1704153	Ring Terminal - 14 Ga. x 1/4" Stud
19.	1703659	Push-On Terminal - 14 Ga. - 1/4"
20.	1702707	Ring Terminal - 6 Ga. x 1/4"
21.	1700381	Cap Screw - 1/4" x 1"

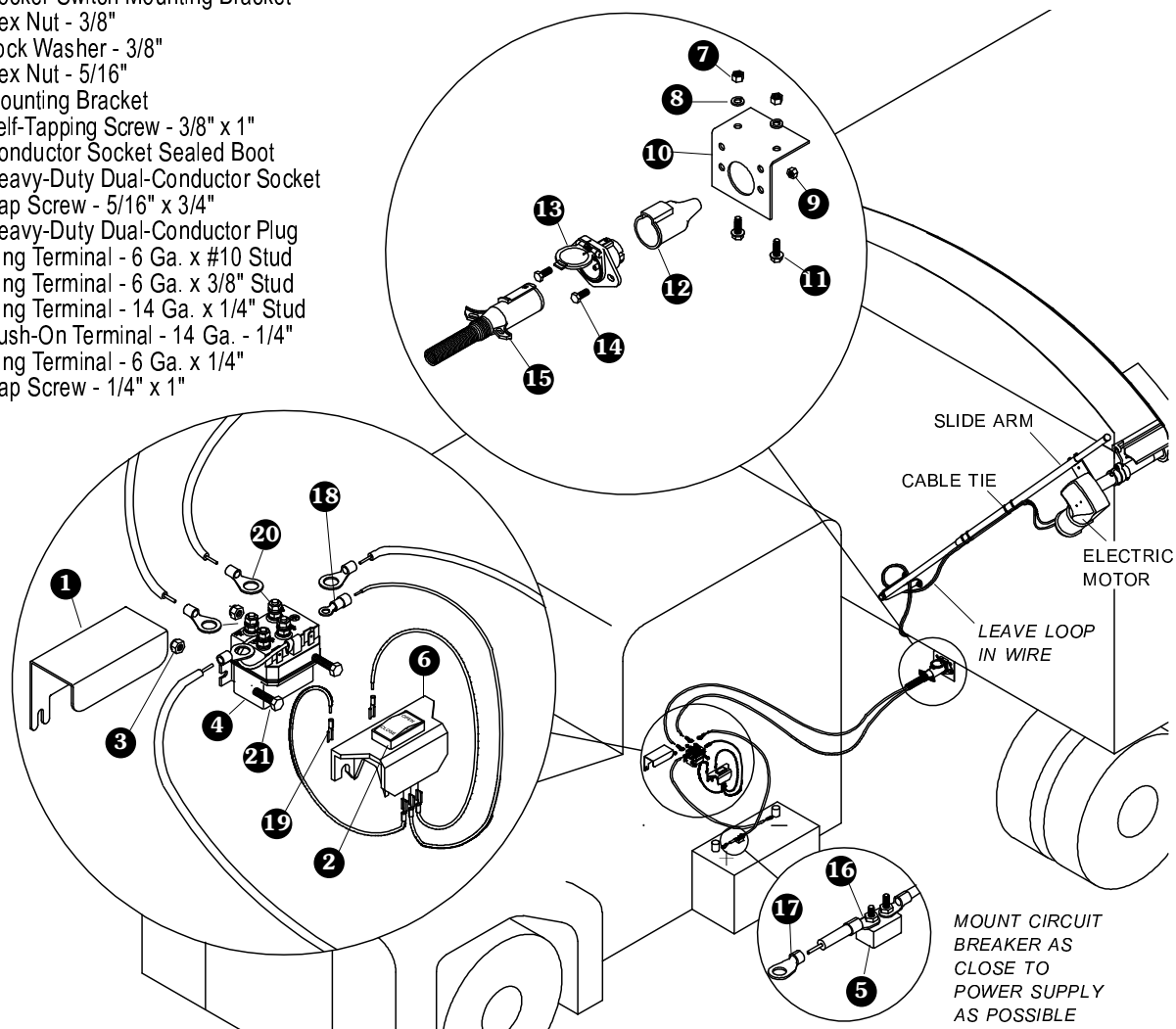

STEP 1: Wire routing. Bring wire up from front of box and loop around 7" standoff, leaving slack in wire. Route wire along lower swing arm, up slide arm and to motor connectors. Secure wire to upper slide arm with nylon cable ties. Leave sufficient slack in wire to allow for movement of swing arm.

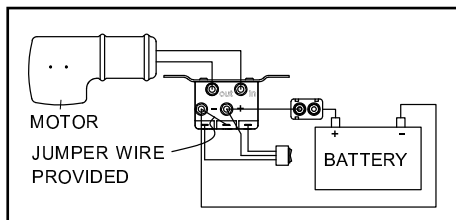

STEP 2: Mount solenoid. Mount solenoid in a suitable location - a ventilated area near the battery is ideal. Determine best route for wire. This is usually along frame with existing wire harness. Run 6-ga. wire from motor to solenoid and from power supply to solenoid as shown in diagram. Run 14-ga. wire from solenoid to switch as shown, and mount switch in area convenient to operator. Mount switch inside or outside cab. Mount with bracket or install directly into dash panels.

NOTE: For farm trucks with hoists, run wire to rear of box, around hoist pin and back to front of box (there is no plug connection).

STEP 3: Dual-conductor socket. Mount dual-conductor socket at suitable location on front of box, usually near existing plugs. Fasten conductor socket to mounting bracket and fasten mounting bracket to box. Slide 6-ga. wire through boot. Connect wire ends to conductor socket. Slide boot up against conductor socket. Secure boot to 6-ga. wire with cable tie.

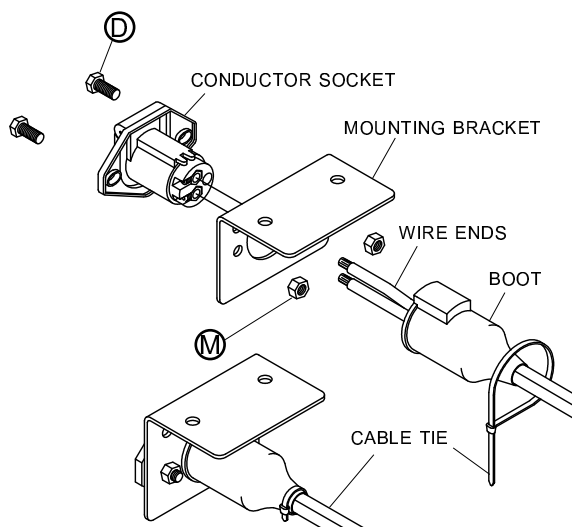
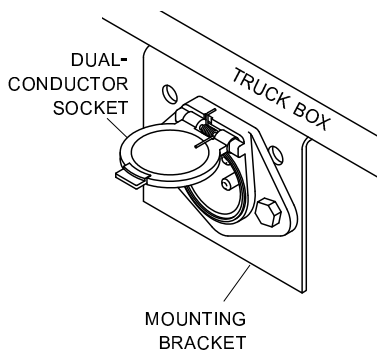

CAUTION
 Swing arm, slide arm and wiring must have a clear path to operate. Inspect system at this time and make adjustments as required.

STEP 4: Dual-conductor plug. Remove insert from conductor plug. Feed wire through plug and into brass contacts on insert. Tighten set screws to secure wires. Replace insert into conductor plug and replace screws.

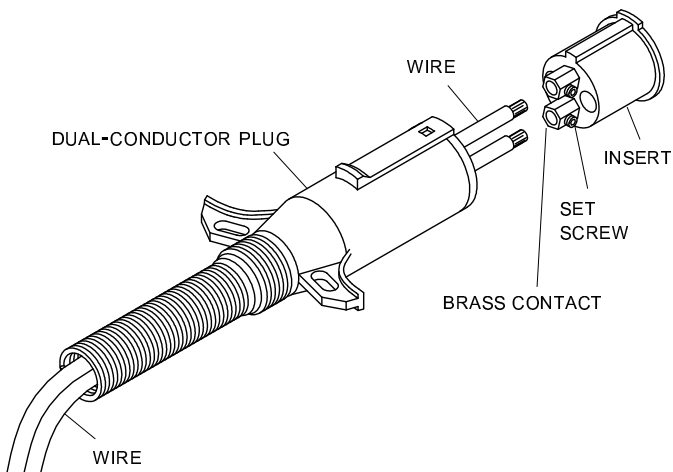

STEP 5: Rocker switch. Locate rocker switch in a convenient operating area. Switch can be mounted inside cab to dashboard, in dash panel, on driver side door jamb or in a convenient location outside cab.

STEP 6: Electrical wire. Cut wires to length and strip only enough wire insulation to install ring terminals. Shrink wrap can be applied to 6-ga. wire connectors. Insert bare wire into ring terminals and crimp securely. Slide shrink wrap over entire connection and apply heat to seal.

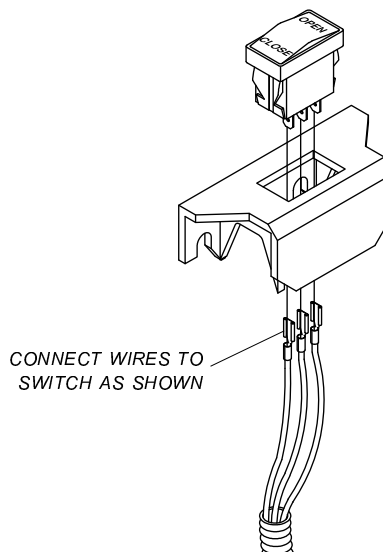
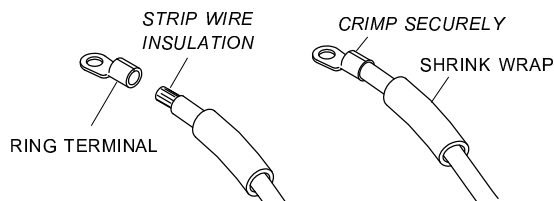

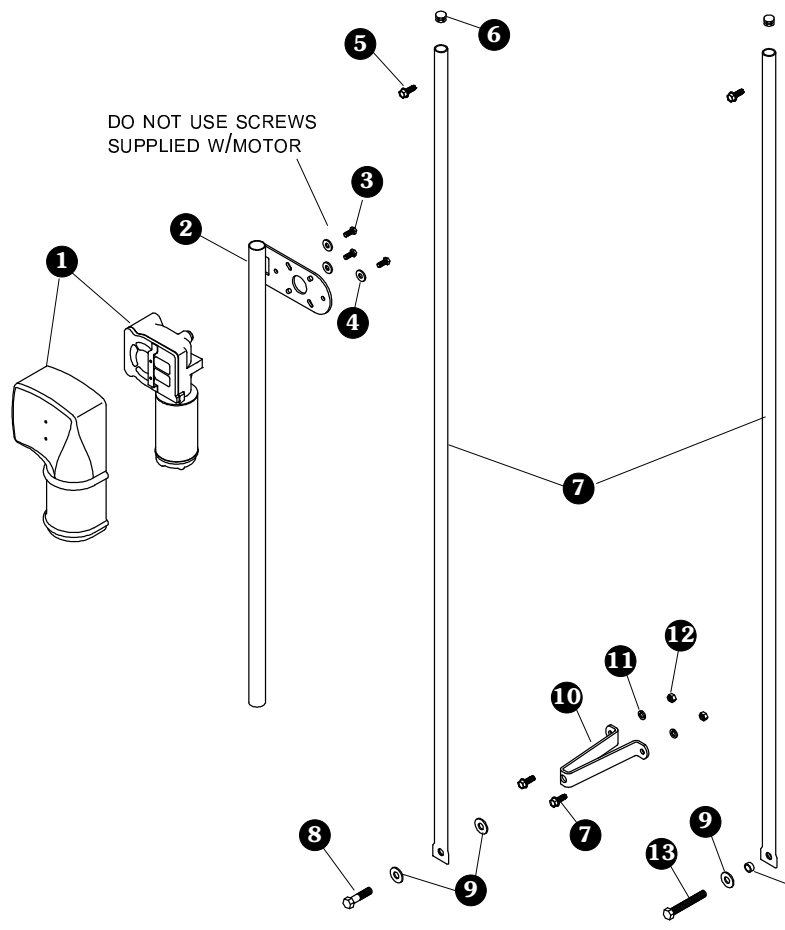

SWING ARMS, SLIDE ARMS & ELECTRIC MOTORS

Item	Part #	Description
1.	1704878	Durabuilt Electric Motor
2.	1110413	Slide Arm
	1115559	Slide Arm - SS
3.	1701045	Hex Head Cap Screw - 5/16" x 3/4"
	1201269	Hex Head Cap Screw - 5/16" x 3/4" - SS
4.	1700428	Flat Washer - 5/16"
	1201237	Flat Washer - 5/16" - SS
5.	1700400	Self-Tapping Screw - 3/8" x 1"
6.	1701595	End Plug - 1"
7.	1114954	Value Series Electric Swing Arm
	1115558	Value Series Electric Swing Arm - SS
8.	1701042	Cap Screw - 1/2" x 2"
9.	1702114	Flat Washer - 1/2"
10.	1100033	Crank Retainer Standoff - 7"
	1115511	Crank Retainer Standoff - 7" - SS
11.	1700434	Lock Washer - 3/8"
12.	1700407	Hex Nut - 3/8"
13.	1704779	Cap Screw - 1/2" x 3"
14.	1700413	Jam Nut - 1/2"
15.	1100306	Retainer Bushing - 11/16" x 5/16"
16.	1702115	Nylon Lock Nut - 1/2"

ROLL TUBE EXTENSIONS & ROLL TUBE EYES

Item	Part #	Description
1.	1114916	Roll Tube Extension w/Adapter
2.	1703237	Cap Screw - 5/16" x 2 1/2"
3.	1702492	Top Lock Nut - 5/16"
4.	1704352	Retaining Collar
5.	1114947	Roll Tube Eye
6.	1705198	Self-Drilling Screw - 1/4" x 1"

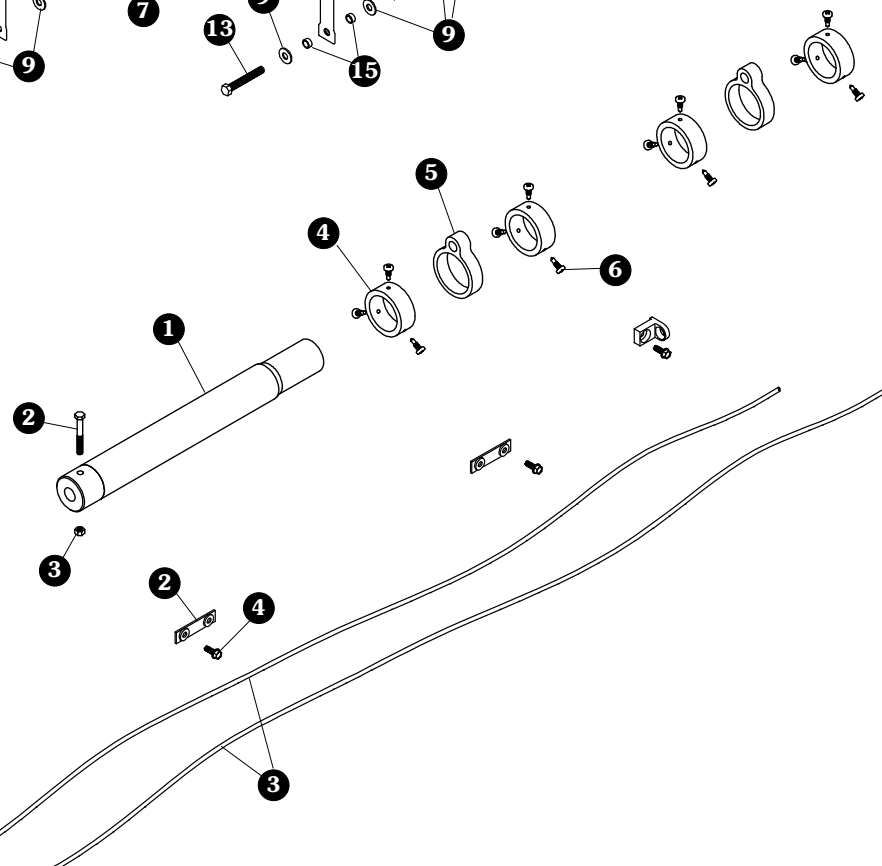

SHOCK CORDS

Item	Part #	Description
1.	1703445	Shock Cord Eye Bracket
2.	1114948	Shock Cord Tie-Down Strap
3.	1100169	Shock Cord - 138"
4.	1700400	Self-Tapping Screw - 3/8" x 1"

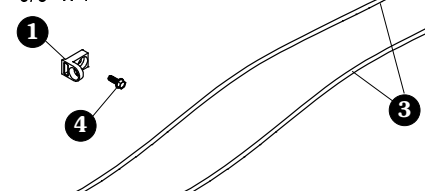

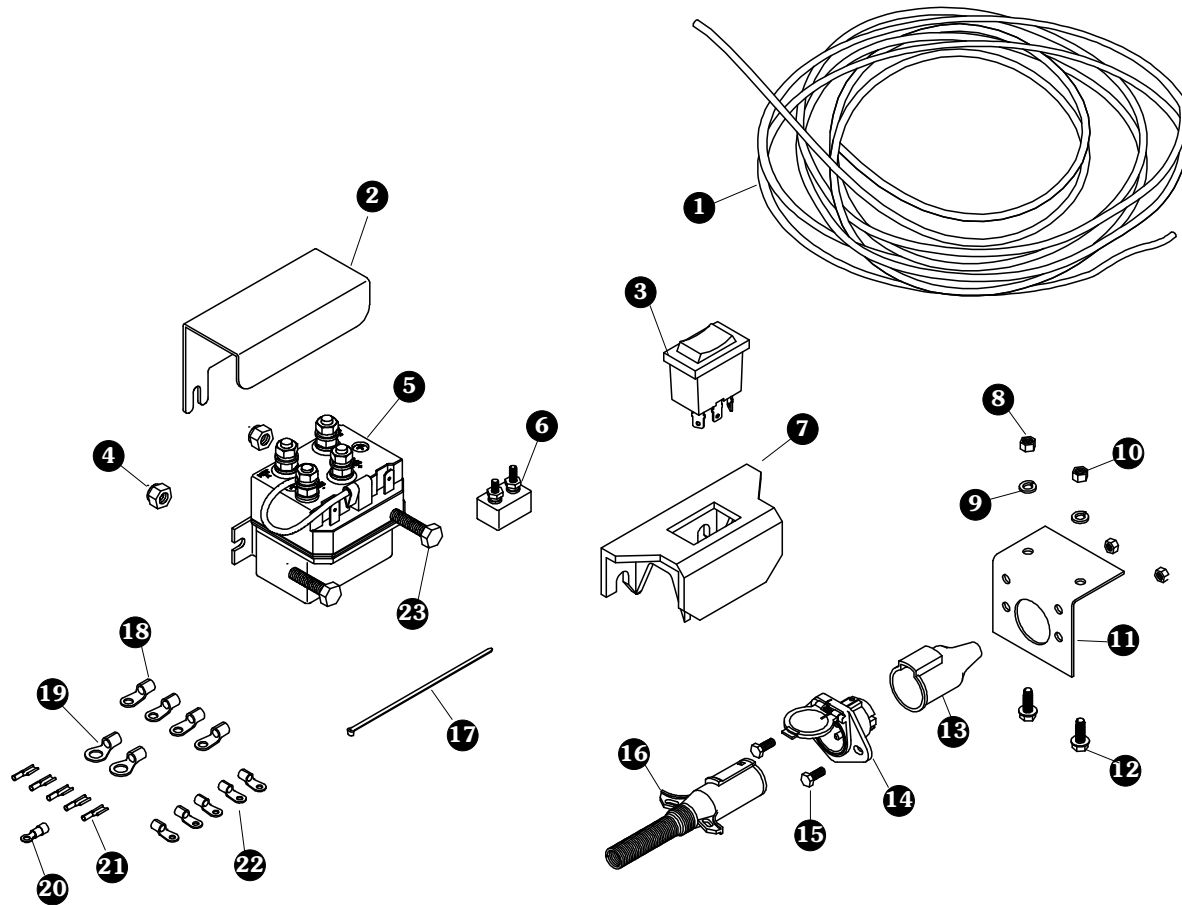

ELECTRICS

Item	Part #	Description
1.	1110312	Dual Conductor 6-Ga. Wire - 50'
	1108102	Dual Conductor 6-Ga. Wire - 75'
	1116482	Electrical Wire 14-Ga. Lead - 15'
2.	1703896	Solenoid Cover
3.	1116020	Rocker Switch
4.	1701543	Nylon Lock Nut - 1/4"
5.	1703845	Motor-Reversing Solenoid
6.	1704354	40-Amp Modified-Reset Circuit Breaker
7.	1703661	Rocker Switch Mounting Bracket
8.	1700407	Hex Nut - 3/8"
9.	1700434	Lock Washer - 3/8"
10.	1700411	Hex Nut - 5/16"
11.	1109015	Mounting Bracket - Conductor Plug
12.	1700400	Self-Tapping Screw - 3/8" x 1"
13.	1704573	Conductor Socket Sealed Boot
14.	1115386	Heavy-Duty Dual-Conductor Socket
15.	1701045	Cap Screw - 5/16" x 3/4"
16.	1115385	Heavy-Duty Dual-Conductor Plug
17.	1703231	Cable Tie - 8"
18.	1703245	Ring Terminal - 6 Ga. x #10 Stud - Motor Breaker
19.	1703244	Ring Terminal - 6 Ga. x 3/8 Stud - Battery
20.	1704153	Ring Terminal - 14 Ga. x 1/4" Stud - Solenoid
21.	1703659	Push-On Terminal - 14 Ga. - 1/4" - Switch/Solenoid
22.	1702707	Ring Terminal - 6 Ga. x 1/4" - Motor/Solenoid
23.	1700381	Hex Head Cap Screw - 1/4" x 1"

MORE QUALITY PRODUCTS FROM SHUR-CO®

- **Genuine Replacement Tarps**
- **Genuine Replacement Parts**

- **Agriculture Products**
 - Value Series Shur-Lok®
 - Super Duty Shur-Lok®
 - Shur-Lok® Junior
 - Premium Belt 'n Ratchet
 - Cable-Lok™
 - Turning Point™ Bow

- **SMARTrailer™ Accessories for Agriculture Products**
 - SMART2™ Remote
 - SMART1 +™ Remote
 - 4500 Series HD Electric
 - Electric Shur-Lok®
 - AutoTrap™ Hopper Opener
 - ProTrap® Hopper Opener
 - Electric Gate & Hoist
 - LiteALL™ Work Lights
 - Cable-Lok™ Electric Upgrade
 - Electric Turning Point™ Bow
 - Solar Power Pack

- **Flatbed Products**
 - ShurTite™ Retractable Tarps
 - Stock Lumber & Steel Tarps

- **Custom Products**
 - Fitted Truck Covers
 - Flat Utility Tarps
 - Bean Drill Covers
 - Shur-Lok® Tarp Cords
 - Gustbuster™ Tarp Cords

- **Construction Products**
 - Super Duty Shur-Lok®
 - Shur-Trak II™
 - Cover-Pro II®
 - Turning Point™ Bow
 - IronSide™ Side-Dump System
 - Arm-Matic™
 - DuraPull™
 - Econo-Pull™
 - Turbo Tarp2™
 - 2000 Series
 - 5000 Series
 - Hammer™
 - Bullet™
 - Flash™
 - Long Arm™

- **SMARTrailer™ Accessories for Construction Products**
 - 4500 Series HD Electric w/Gate Flex™
 - Shur-Trak II™ Electric Upgrade
 - Cover-Pro II® Electric Upgrade
 - Electric Turning Point™ Bow
 - Solar Power Pack

- **Waste Products**
 - The Ox™
 - Quick-Flip III™
 - Sidewinder™
 - Sidewinder™ 350
 - HyTower™ SL
 - HyTower™ DL
 - Double-Flip™

TARPING SYSTEMS & ACCESSORIES

