

| Item | Part # | Description |
|------|---------|--|
| | 1119637 | Junction Box Kit w/Breaker- ProTrap® 150- 8 Hole |
| | 1119636 | Junction Box Kit w/Breaker- ProTrap® 250- 8 Hole |
| 1. | 1119364 | Junction Box Back Plate |
| 2. | 1119647 | Junction Box w/Breaker - 8 Hole |
| 3. | 1119438 | Junction Box Mtg Plate |
| 4. | 1702653 | Machine Screw Nut w/Washer |
| 5. | 1704308 | Flange Hd. Cap Screw - #10 x 1/2" |
| 6. | 1700381 | Cap Screw - 1/4" x 1" |
| 7. | 1700398 | Self-Drilling Screw - 1/4" x 3/4" |
| 8. | 1704556 | Rubber Grommet |
| 9. | 1702707 | Ring Terminal - 6 Ga. x 1/4" Stud |
| 10. | 1703245 | Ring Terminal - 6 Ga. x #10 Stud |
| 11. | 1700436 | Lock Washer - 1/4" |
| 12. | 1700408 | Hex Nut - 1/4" |
| 13. | 1704563 | 30-Amp Manual Reset Circuit Breaker - ProTrap® 150 |
| | 1704557 | 35-Amp Manual Reset Circuit Breaker - ProTrap® 250 |
| 14. | 1704555 | Gasket for Circuit Breaker |

HARDWARE SUPPLIED WITH JUNCTION BOX

HARDWARE SUPPLIED WITH CIRCUIT BREAKER

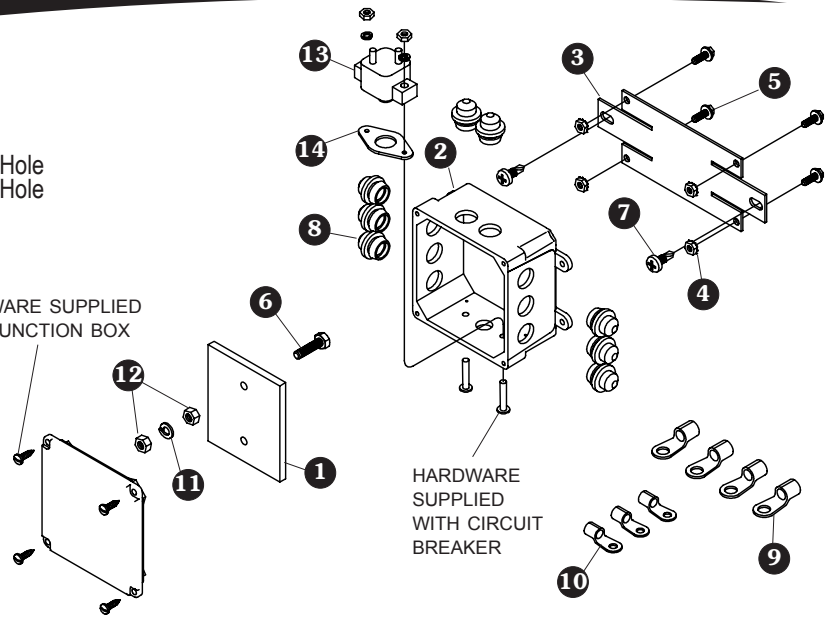

Routing wires through the sealed junction box greatly reduces corrosion on wire connections. Used with the 3500 Series and ProTrap® systems.

NOTE: Use junction boxes on trailers with two or more hoppers.

STEP 1: Insert 1/4" X 1" cap screw through top hole in back plate and secure with nut.

1/4" x 1" CAP SCREW

BACK PLATE

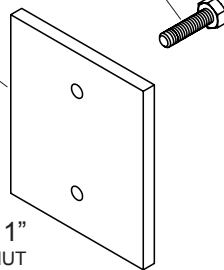

NOTE: Place back plate into junction box before installing circuit breaker.

JUNCTION BOX

1/4" x 1" HEX NUT

BACK PLATE

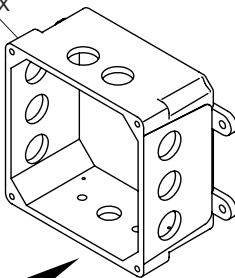

STEP 2: Place back plate loosely into junction box.

STEP 3: Fasten circuit breaker and gasket to bottom of junction box with supplied screws, washers and nuts.

CIRCUIT BREAKER

SUPPLIED HARDWARE

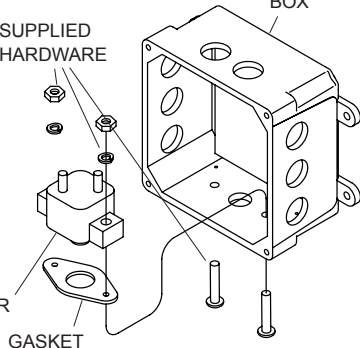

STEP 4: Fasten mounting plate to junction box with #10 X 1/2" cap screws and nut/washers.

JUNCTION BOX

#10 x 1/2" CAP SCREW

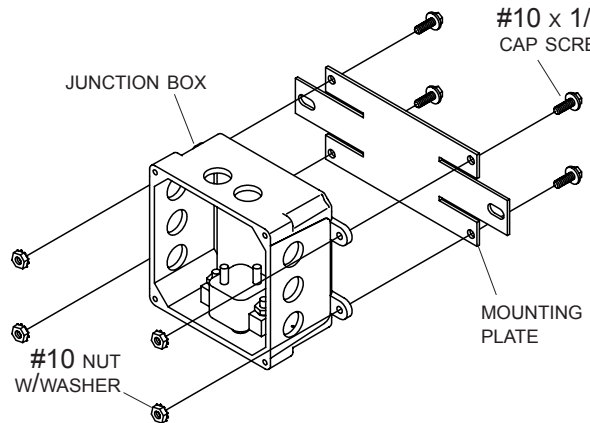

#10 NUT W/WASHER

MOUNTING PLATE

STEP 5: Install rubber grommets into holes in junction box.

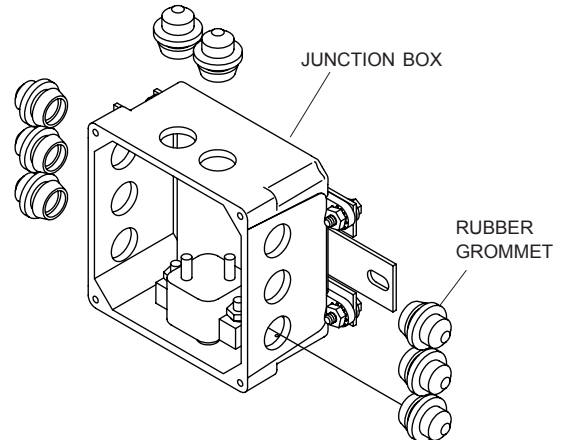

JUNCTION BOX

RUBBER GROMMET

STEP 6: Two-hopper trailer: Locate junction box between hoppers to supply power to ProTrap® units. Using slots in junction box assembly as a guide, mark and drill 3/16" holes and fasten to trailer with 1/4" x 3/4" self-drilling screws.

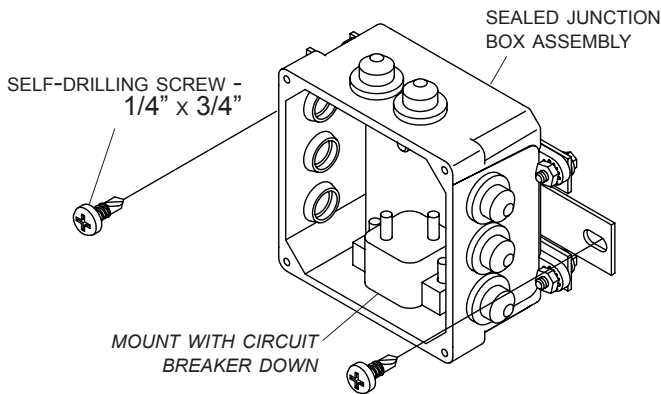

STEP 7: Pierce grommets with ballpoint pen so that terminal wires can be inserted through pierced holes.

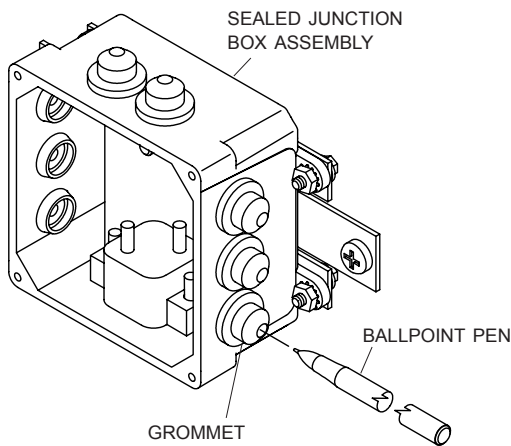

STEP 8: Run 6 ga. wire from conductor socket to junction box. Crimp 1/4" ring terminals to wire ends. Remove hex nut and lock washer from junction post assembly. Place positive wires on positive post and negative wires on negative post. Secure with hex nuts and lock washers.

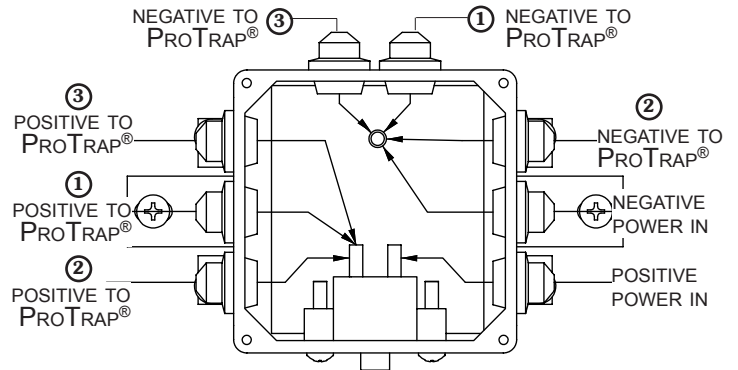

STEP 9: Fasten cover to junction box with supplied screws.

