



TARP SYSTEMS, PARTS & TARPS

P/N 1121423 Rev. F

OWNER'S MANUAL



DuraPull™ Tarp System Belly Dumps, End Dumps, Dump Bodies & Pups

READ BEFORE INSTALLING

3353 SE GRAN PARK WAY ■ STUART, FL 34997
PHONE 1-800-327-8287 ■ FAX 772-287-0431
www.donovan-tarps.com

SHIPPING. Orders are shipped F.O.B. from the Shur-Co[®], LLC sites listed below. No full freight is allowed or prepaid shipment accepted unless quoted and approved in writing prior to acceptance of the order. All shipments are made by the most reasonable means in accordance with size and weight of order, unless specified routing instructions are furnished by the customer. Shipments are made daily via U.P.S. and common carrier. Claims for shortages must be made within 10 days. All claims for damages or loss in transit must be made with the carrier. No collect calls will be accepted. To ensure delivery of orders, we need your full street address and phone number. When you receive your shipment, examine it carefully. Be sure all cartons listed on the delivery sheet are accounted for. Large items may be packaged separately. If a carton is damaged, open it and inspect the contents before signing for delivery. If merchandise is damaged, describe damage on the delivery receipt. Failure on your part to document damaged or missing merchandise on the delivery receipt releases the carrier of all liability; repair or replacement will be the customer's responsibility.

WARRANTY. We warrant all new products are free of defects in materials and workmanship.* This warranty is effective if products are properly installed and used for the purpose for which they were intended and applies to the original buyer only. Except as set forth above or in any product-specific warranty documentation, we make no other warranties, express or implied, including but not limited to warranties of merchantability of fitness for a particular use.

Returns of a product for warranty must be accompanied by a Return Merchandise Authorization number (RMA#), obtained by calling Customer Service at 866-748-7435, and sent, with freight paid by us, to Shur-Co[®], LLC, 2309 Shur-Lok St., PO Box 713, Yankton, SD 57078. All products returned without an RMA# will be refused. When we issue the RMA#, we will also issue a call tag to have UPS (or other freight company) pick up the product. C.O.D. returns not accepted. We will pay no storage fees for a warranty product return prior to pick by us or the freight company. If a warranty product return is scheduled to be picked up by us, we will pick up the product at our earliest convenience.

If a product returned is found, in our judgement, to be defective in material or workmanship, our obligation under this warranty is limited to the repair or replacement of the product, which will be made by us. Repair or replacement will be at our discretion, with replacements being made using current products performing in the equivalent function. Labor charges, other than those incurred at our factory, including, but not limited to, any labor to install a repaired or replacement product, are not covered under this warranty. All expenses associated with delivering defective products to our factory and delivering repaired or replacement products from our factory to the owner will be paid by us.

If the product returned is found, in our judgement, to be non-warrantable, the owner will be contacted to authorize repair work, purchase of a replacement product or return of the product, all of which will be at the owner's expense. Payment authorization must be received by us before any non-warrantable product is repaired, replaced or returned. All expenses associated with delivering the repaired non-warrantable product, a replacement product or the non-warrantable product from our factory to the owner will be paid by the owner.

In no event will we be liable for any damages of any kind to person, product or property, including but not limited to indirect, incidental, special, consequential or punitive damages, or damages for loss of profits or revenue, even if we have been advised of the possibility of such damages. There are no warranties for used products or products that have been repaired, altered, modified or subjected to misuse, negligence or accident. We will not repair or replace products that fail or malfunction due to ordinary wear and tear, except as expressly noted in a product-specific warranty. Use of non-Shur-Co[®], LLC parts in conjunction with Shur-Co[®], LLC products will void this product warranty.

*Certain products have specific warranties that differ from this warranty, for example motors and electronics. Product-specific warranty documentation is available for these items. In the event of a conflict between this warranty and a product-specific warranty, the product-specific warranty will govern.

RETURN POLICY. All sales final. See WARRANTY above for return details.

OTHER. All prices, product listings, sizes, weights and manufacturing details are subject to change without notice. No person is authorized to modify the foregoing conditions of sale whatsoever.

SHUR-CO[®], LLC SERVICE AND DISTRIBUTION CENTERS

Corporate HQ and Outlet Store

SHUR-CO[®] of SOUTH DAKOTA

2309 Shur-Lok St., PO Box 713
Yankton, SD 57078-0713
Ph 800.474.8756 | Fax 605.665.0501

ShurTite[™] Service Centers

SHUR-CO[®] of CANADA

490 Elgin St., Unit #1
Brantford, Ontario N3S 7P8
Ph 800.265.0823 | Fax 519.751.3997

SHUR-CO[®] of SIOUX FALLS

47184 258th St., Suite B
Sioux Falls, SD 57107
Ph 844.573.9322 | Fax 605.543.5469

SHUR-CO[®] of ILLINOIS

Ph 866.356.0246 | Fax 217.877.8270

SHUR-CO[®] of OHIO

Ph 866.356.0242 | Fax 330.297.5599

SHUR-CO[®] of FLORIDA

3353 SE Gran Park Way
Stuart, FL 34997
Ph 800.327.8287 | Fax 772.287.0431

SHUR-CO[®] of ILLINOIS

3993 E. Mueller Ave.
Decatur, IL 62526
Ph 866.356.0246 | Fax 217.877.8270

SHUR-CO[®] of IOWA

3839 Midway Blvd.
Ft. Dodge, IA 50501
Ph 866.356.0245 | Fax 515.576.5578

SHUR-CO[®] of MICHIGAN

5100 Lakeshore Dr.
Lexington, MI 48450
Ph 800.327.8287 | Fax 772.287.0431

SHUR-CO[®] of NORTH DAKOTA

1746 4th Ave. NW
West Fargo, ND 58078
Ph 877.868.4488 | Fax 701.277.1283

SHUR-CO[®] of OHIO

1100 N. Freedom, St. Rt. 88 & 14
Ravenna, OH 44266
Ph 866.356.0242 | Fax 330.297.5599

SHUR-CO[®] UK, Ltd.

Unit 41 Rochester Airport Estates
Laker Rd., Rochester, Kent ME1 3QX
Ph +44 (0)1795.473499
Fax +44 (0)871.272.8278

For more info, log on to our website:

www.shurco.com

MESSAGE TO OWNERS

Thank you for buying this tarping system from Shur-Co®. We appreciate your confidence in our products. Please read and thoroughly understand this manual before installing and/or operating this system.

Pay particular attention to important safety and operating instructions, as well as warnings and cautions. The hazard symbol  is used to alert users to potentially hazardous conditions and is followed by caution, warning or danger messages.

Failure to READ AND FOLLOW INSTRUCTIONS could result in failure of your tarping system and/or personal injury. Your trailer requirements may, however, call for minor variations to these instructions.

Please inspect your tarping system periodically. Repair or replace worn or damaged parts to your system.

QUESTIONS? CALL OUR HELP LINE:
1-866-748-7435
MON-FRI 8 AM-5 PM CENTRAL TIME

SAFETY

We at Shur-Co® are concerned with your safety and the safety of all those operating this system. Therefore, we have provided safety decals at various locations on your tarping system. Keep decals as clean as possible at all times. Replace any decal that has become worn or damaged, painted over or otherwise difficult to read. Replacement decals are available through Shur-Co® dealers.

SAFETY INSTRUCTIONS

- 1. Always wear safety glasses during installation and operation.**
- 2. Stay clear of moving parts.**
- 3. Do not operate under low-hung power lines. Always check for overhead obstructions before opening or closing.**
- 4. Open and close tarp only at the job site.**
- 5. Use caution when operating tarp system in windy conditions. Face vehicle into wind when opening and closing tarp.**
- 6. Place safety decals in visible locations. Replace worn or damaged decals.**
- 7. No other use of this system is authorized, except as designed.**

TABLE OF CONTENTS

Hardware Identification..... 1

Mounting Locations 2

Tarp Housing Installation 3

Pull Bar Hook Installation 4

Tarp Installation 5

Pull Bar Assembly..... 6

Rope & Box Hook Installation..... 7

Setting Spring Tension..... 8

Replacement Parts..... 9-11

TOOLS REQUIRED

1. Wrenches - 1/2", 9/16", 7/8"
2. Ratcheting Socket Wrench
3. Sockets - 1/2", 9/16"
5. Drill Bit (metal cutting) - 5/16"
6. Center Punch
7. Hammer
8. Tape Measure
10. Grinder
11. Air or Electric Impact Wrench w/9/16" Socket
12. Metal Saw
13. Steel Welder or Aluminum Welder
14. Hex Driver Bit - 5/16"
15. Phillips Driver Bit for Drill - #3

MAINTENANCE

- Tighten any loose bolts.
- Replace worn/damaged/bent parts.
- Replace/repair worn or damaged tarps.

RUST PREVENTION

To prevent rust, paint all exposed metal, such as weld seams and/or metal exposed by grinding or cutting, with corrosion-resistant paint.

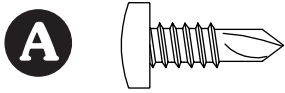

A 1700398 Self-Drilling Screw - 1/4" x 3/4"

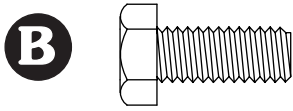

B 1701045 Cap Screw - 5/16" x 3/4"

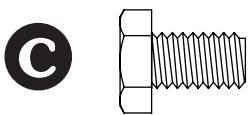

C 1703171 Cap Screw - 5/16" x 1/2"

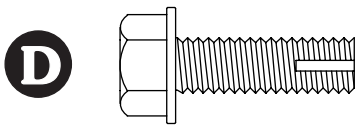

D 1701059 Self-Tapping Screw - 5/16" x 1"

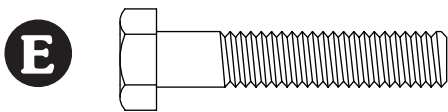

E 1704451 Cap Screw - 5/16" x 1 5/8"

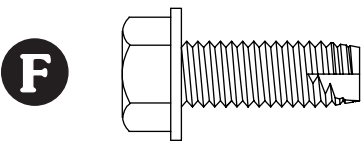

F 1700400 Self-Tapping Screw - 3/8" x 1"

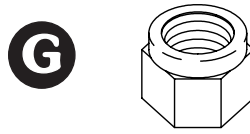

G 1704454 Nylon Lock Nut - 5/16"



H 1700433 Lock Washer - 5/16"



J 1700428 Flat Washer - 5/16"

STEP 1: Determine desired mounting location for tarp housing.

NOTE: The DuraPull™ system is designed to universally fit many different truck box designs. Brackets may need to be fabricated in order to mount tarp housing as desired.

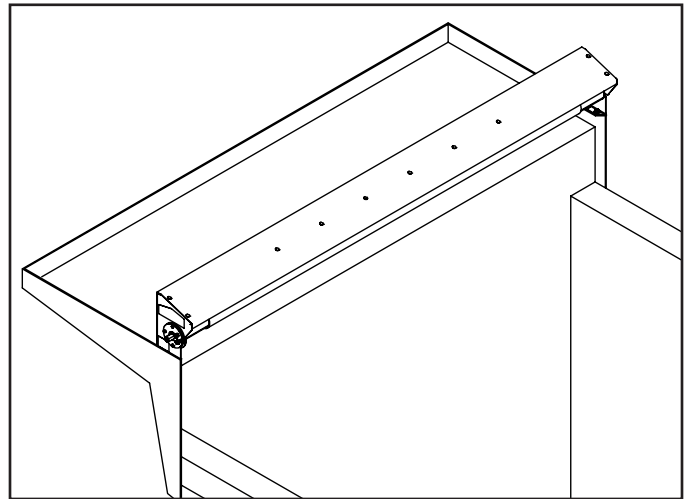
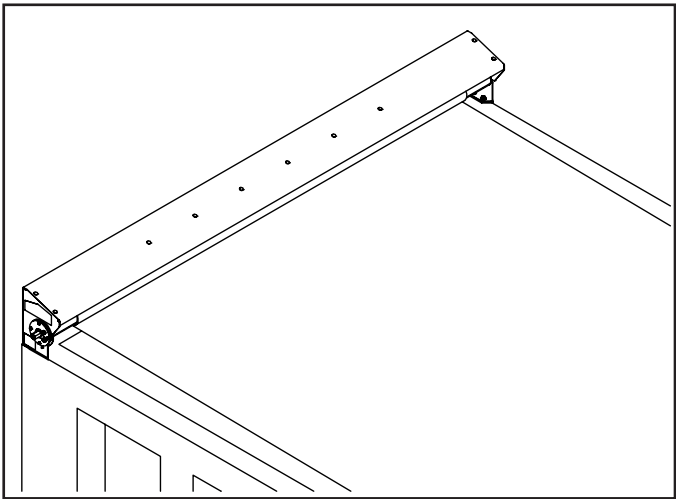
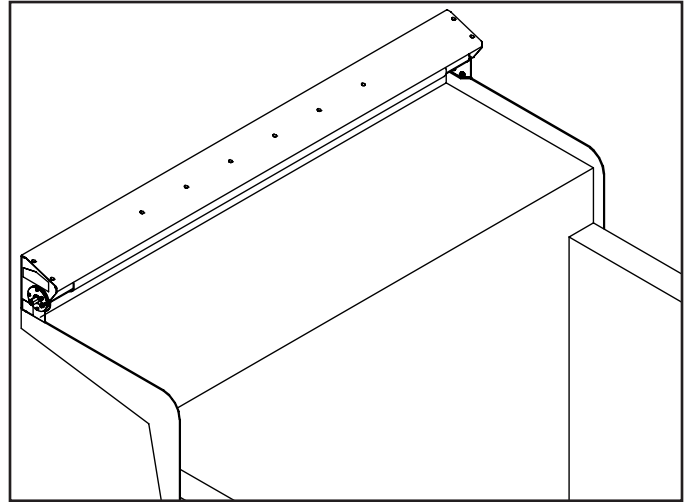
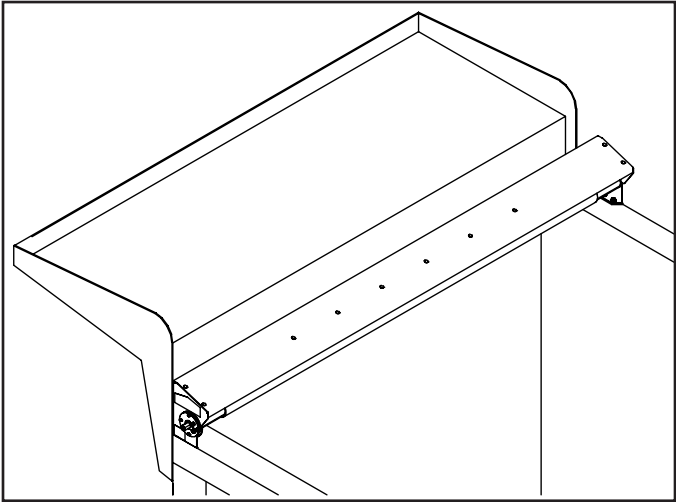

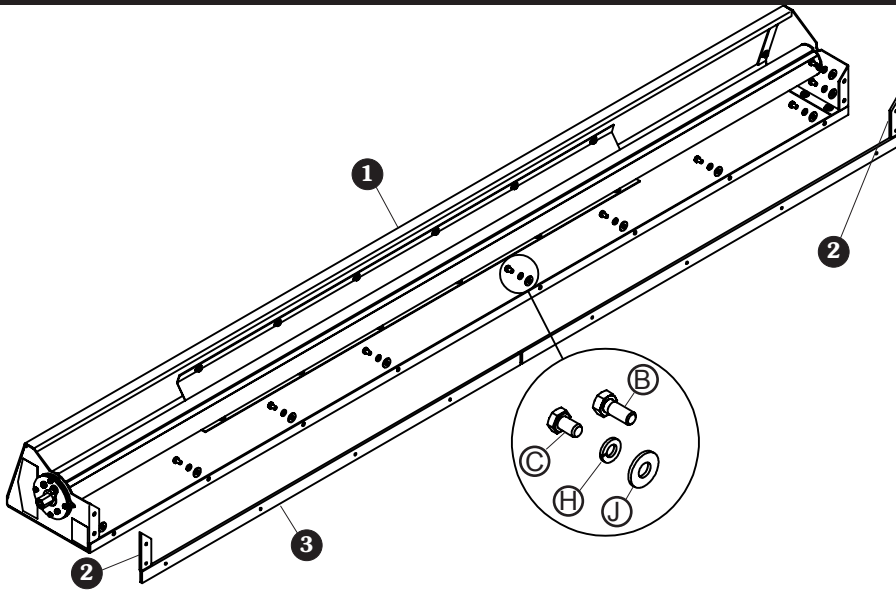

Item	Part #	Description
1.	1121315	Tarp Housing Assembly - 96"
	1121316	Tarp Housing Assembly - 102"
	1121922	Tarp Housing Assembly - 80"
	1121964	Tarp Housing Assembly - 84"
	1121957	Tarp Housing Assembly - 88"
	1126639	Tarp Housing Assembly - 90"
	1121556	Tarp Housing Assembly - 92"
2.	1121361	End Panel Mounting Strip - Steel
	1121364	End Panel Mounting Strip - Aluminum

Item Part #	Description
3. 1121359	Shield Mounting Strip - 47 7/8" - Steel (for 96" wide housing)
1121362	Shield Mounting Strip - 47 7/8" - Aluminum (for 96" wide housing)
1121360	Shield Mounting Strip - 50 7/8" - Steel (for 102" wide housing)
1121363	Shield Mounting Strip - 50 7/8" - Aluminum (for 102" wide housing)
1121926	Shield Mounting Strip - 39 7/8" - Steel (for 80" wide housing)
1121927	Shield Mounting Strip - 39 7/8" - Aluminum (for 80" housing)
1121968	Shield Mounting Strip - 41 7/8" - Steel (for 84" wide housing)
1121969	Shield Mounting Strip - 41 7/8" - Aluminum (for 84" wide housing)
1121961	Shield Mounting Strip - 43 7/8" - Steel (for 88" wide housing)
1121962	Shield Mounting Strip - 43 7/8" - Aluminum (for 88" wide housing)
1126641	Shield Mounting Strip - 44 7/8" - Steel (for 90" wide housing)
1126640	Shield Mounting Strip - 44 7/8" - Aluminum (for 90" wide housing)
1121570	Shield Mounting Strip - 45 7/8" - Steel (for 92" wide housing)
1121571	Shield Mounting Strip - 45 7/8" - Aluminum (for 92" wide housing)
B. 1701045	Cap Screw - 5/16" x 3/4" (for aluminum strips)
C. 1703171	Cap Screw - 5/16" x 1/2" (for steel strips)
H. 1700433	Lock Washer - 5/16"
J. 1700428	Flat Washer - 5/16"

STEP 1: Fasten mounting strips to bottom of tarp housing with screws **B** or **C**, lock washers **H** and flat washers **J**, as shown. Do not fully tighten screws at this point.

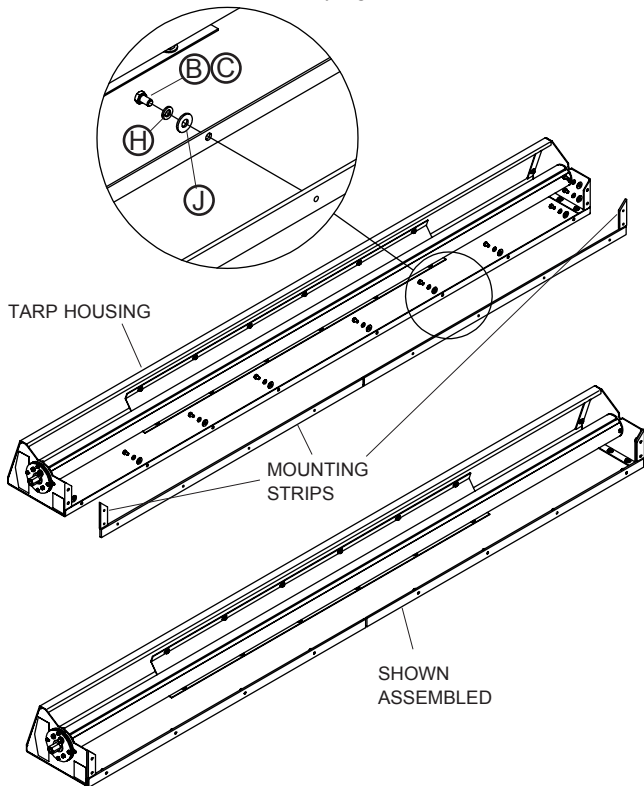

STEP 2: Place tarp housing in desired mounting location. Stitch weld mounting strips to truck box every 6" all around. Securely tighten fasteners holding tarp housing to mounting strips.

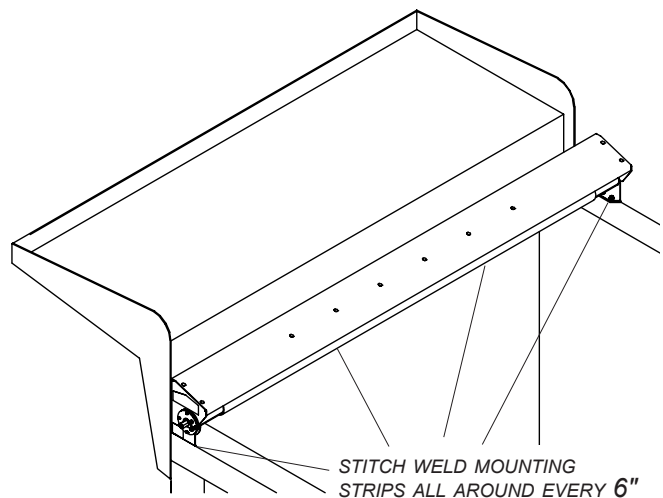

NOTE: To prevent rust, paint all exposed metal, such as weld seams and/or metal exposed by grinding or cutting, with corrosion-resistant paint (not necessary for unpainted aluminum boxes).

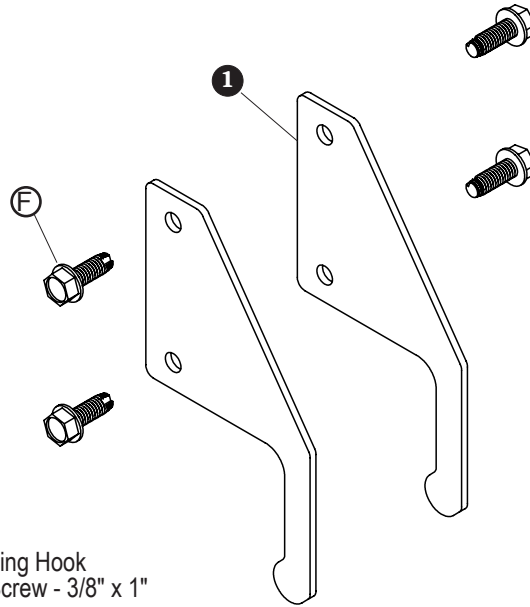

Item	Part #	Description
1.	1121357	Pull-Bar Retaining Hook
F.	1700400	Self-Tapping Screw - 3/8" x 1"

STEP 1: Align pull-bar hooks on rear gate. Space hooks far enough apart to allow tarp to fit between hooks. Mount hooks on rear gate as high as possible. Make sure pull bar can travel over gate to hooks without catching on any obstructions. Mount hooks to allow a 2 1/2" gap inside each hook for storing pull bar.

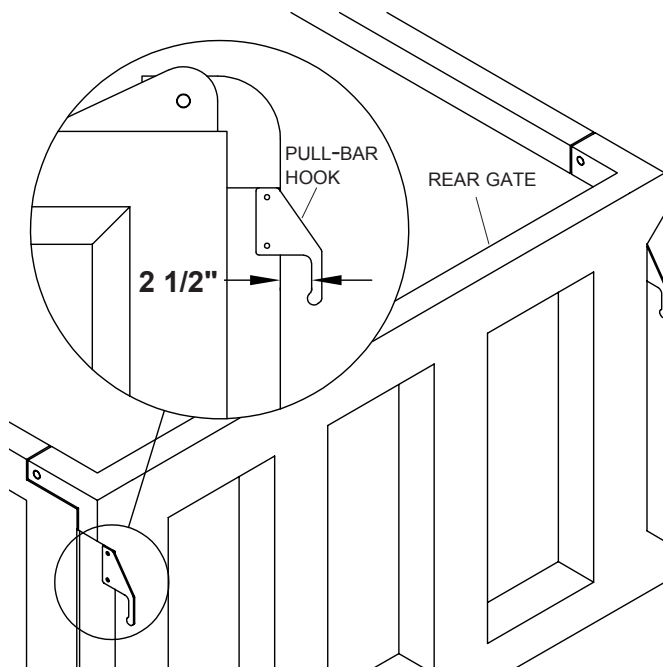

STEP 2: Mark and drill 5/16" holes and fasten pull-bar hooks to rear gate with screws (F) or weld hooks to gate.

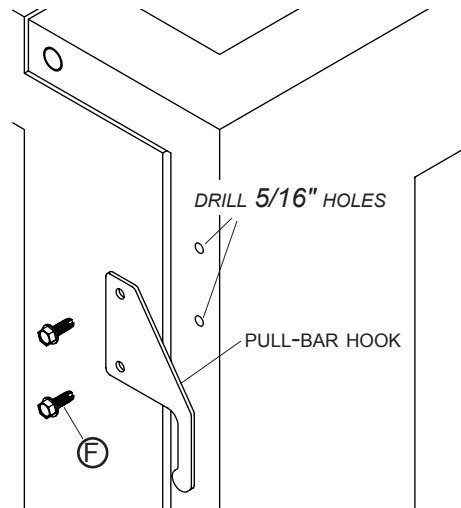

NOTE: If gate hinge is raised, a guide plate may need to be added to help the pull-bar ramp over the hinge.

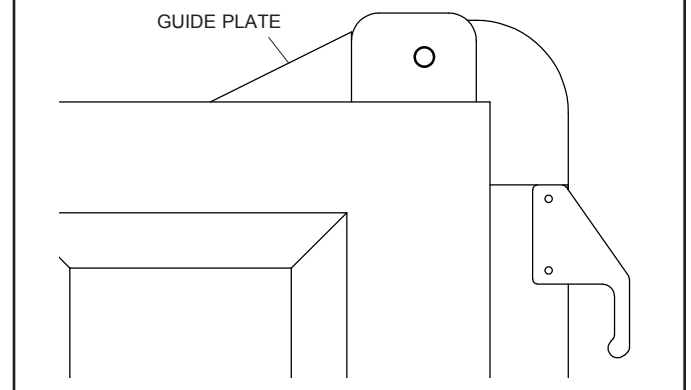

STEP 1: On passenger side end panel, align groove in tarp roller with notch.

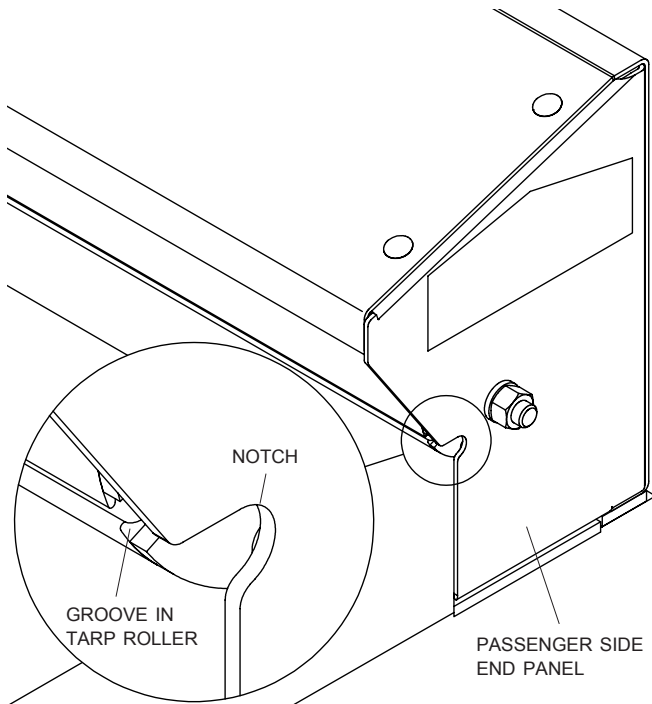

STEP 2: Lay out tarp, logo side up. Find front edge of tarp with plastic rod sewn in hem.

STEP 3: Install tarp into tarp roller. From passenger side of tarp housing, slide front edge of tarp into groove in tarp roller. Center tarp on tarp roller.

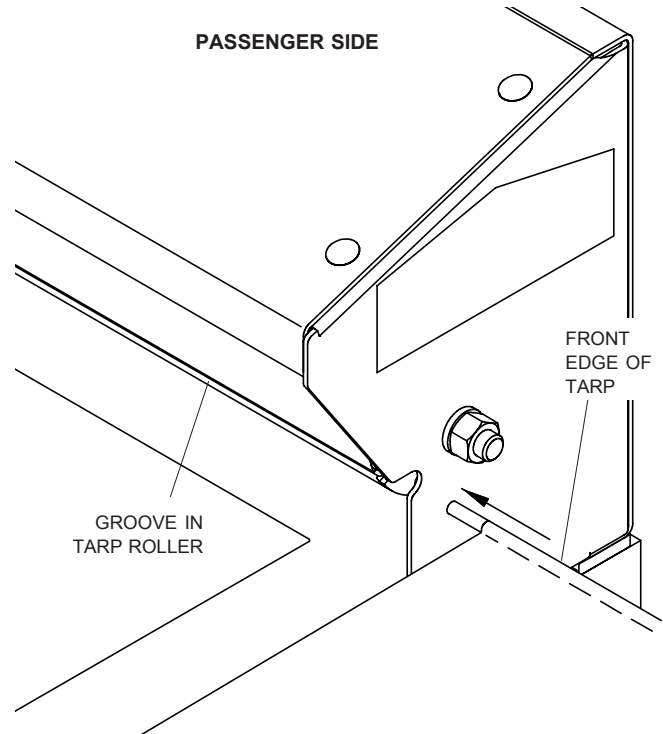

TIP: Before sliding tarp into tarp roller, spray tarp roller groove with silicone lubricant or soapy water, to help tarp slide more easily.

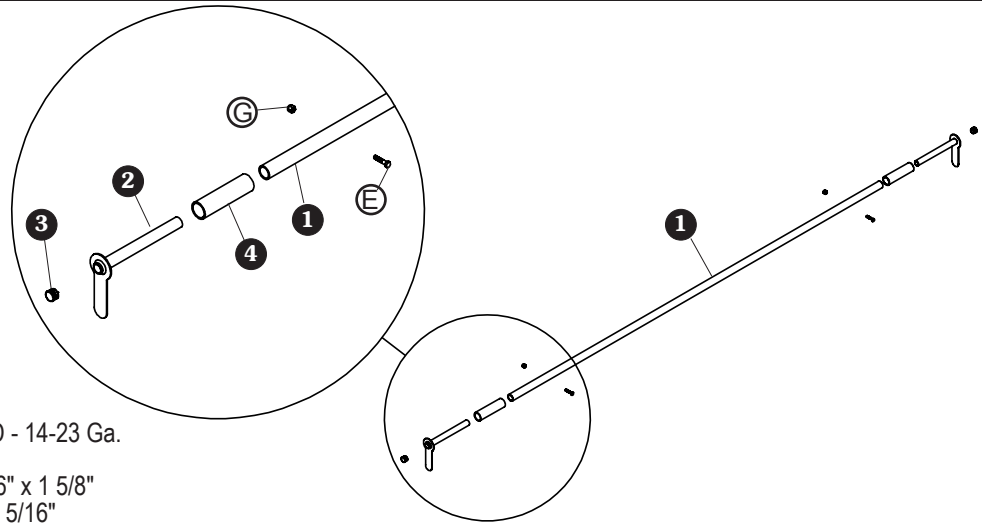

Item	Part #	Description
1.	1121350	Pull Bar - 104"
2.	1121351	Pull-Bar Guide
3.	1701595	End Plug - 1" OD - 14-23 Ga.
4.	1121355	Pull-Bar Roller
E.	1704451	Cap Screw - 5/16" x 1 5/8"
G.	1704454	Nylon Lock Nut - 5/16"

STEP 1: Cut pull bar to fit truck box. Pull bar must be 2" wider than tarp housing or 2" wider than widest point on truck box, whichever distance is greater.

STEP 2: Insert pull-bar guides into ends of pull bar, aligning guide plates to face in same direction. Drill 5/16" holes through pull bar and guides as shown.

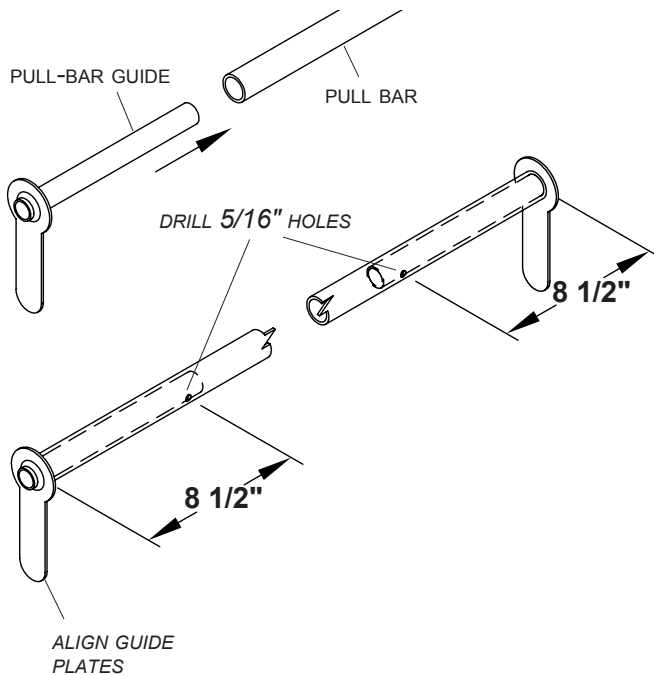

STEP 3: Remove guides and slide pull bar through rear pocket on tarp. Slide pull-bar rollers onto ends of pull bar and reinsert pull-bar guides into ends of pull bar. Fasten guides to pull bar with screws **E** and lock nuts **G**, tightening securely.

NOTE: In most cases, screws will be hidden inside tarp pocket.

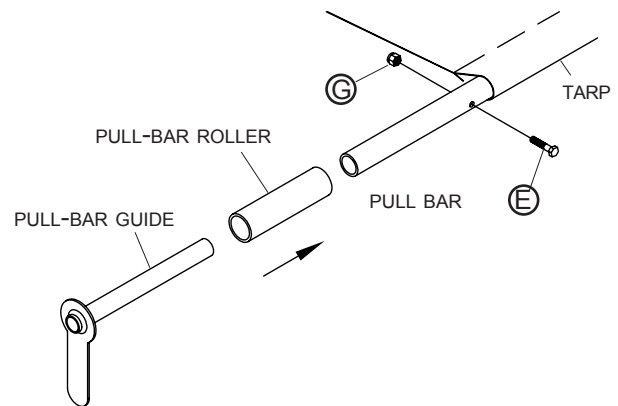

NOTE: Pull-bar rollers should fit between tarp edges and pull-bar guide plates. If tarp is wide enough for rollers to fit inside tarp pocket, cut rollers shorter so they fit between tarp and guide plates.

STEP 4: Install end caps into ends of pull-bar guides.

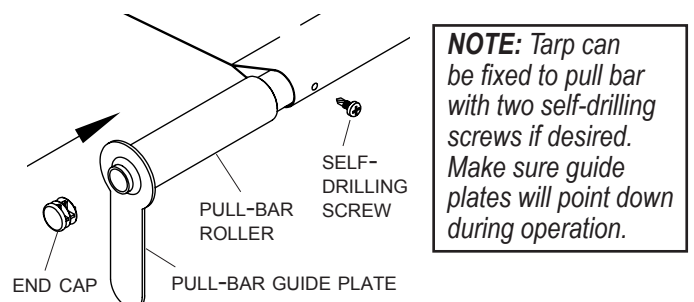

NOTE: Tarp can be fixed to pull bar with two self-drilling screws if desired. Make sure guide plates will point down during operation.

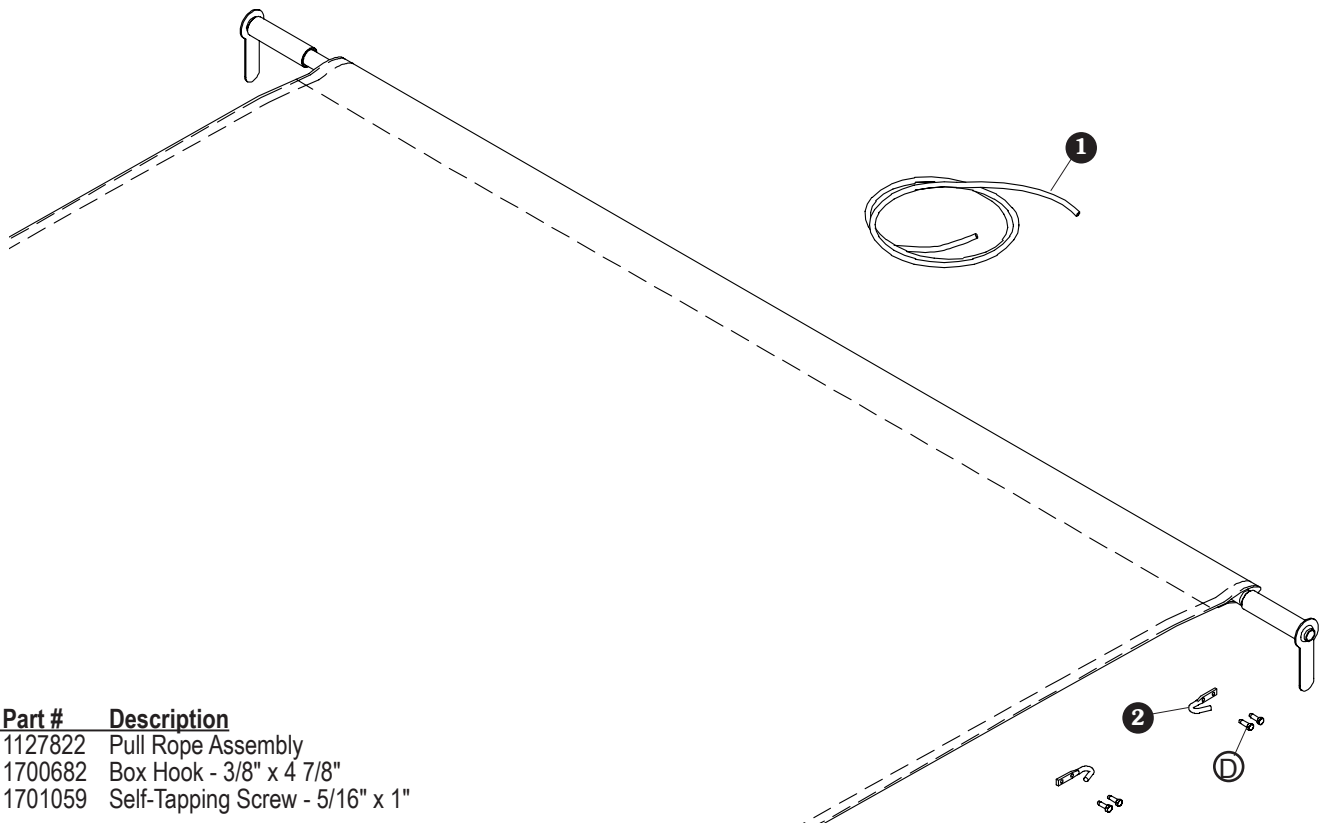

Item	Part #	Description
1.	1127822	Pull Rope Assembly
2.	1700682	Box Hook - 3/8" x 4 7/8"
D.	1701059	Self-Tapping Screw - 5/16" x 1"

STEP 1: Rope return. Cut small hole in center of tarp just above tarp tube. Slide rope through hole in tarp and around tarp tube.

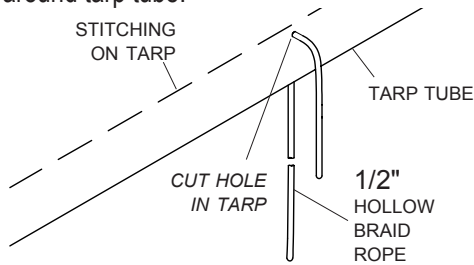

STEP 2: Wrap tape tightly around short end of rope and make loop in rope. Slide rope through rope braids and hollow center while compressing section of rope past loop. Insert rope minimum of 8".

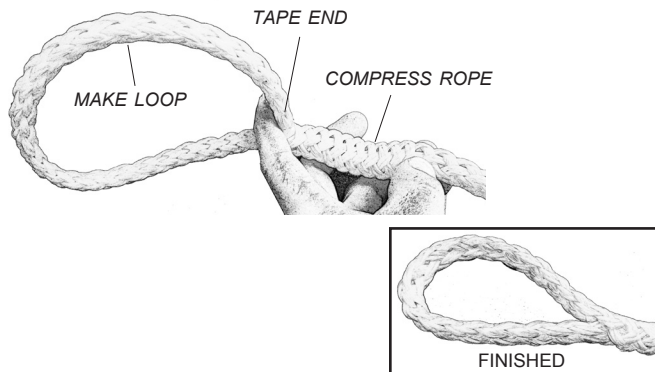

STEP 3: Install box hooks at rear and on side of box for rope storage. Place in convenient location, spacing at least 24" apart. Mark and drill 1/4" holes and fasten with screws D.

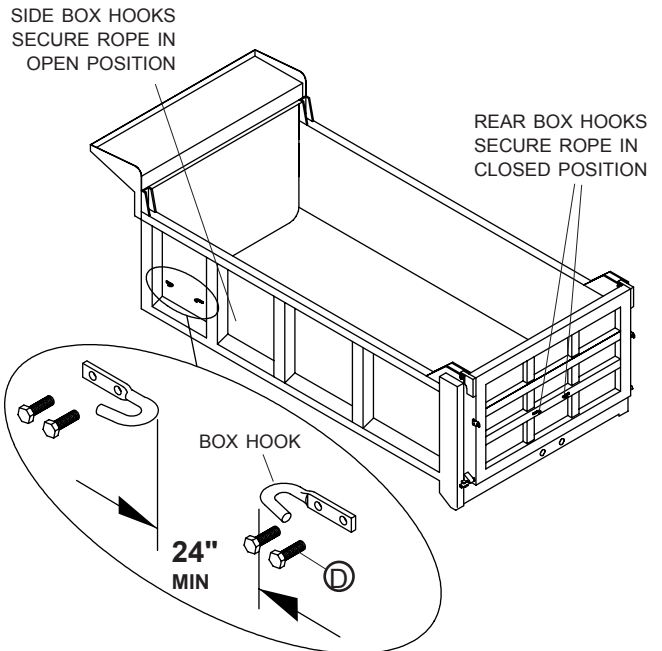

STEP 1: Before setting spring tension, pull tarp out and over tailgate as far as it will go. Secure tarp to tailgate with a rope to prevent tarp from retracting. Loosen screw holding gear-lock plate to tarp housing. Remove screw, lock washer and gear-lock plate.

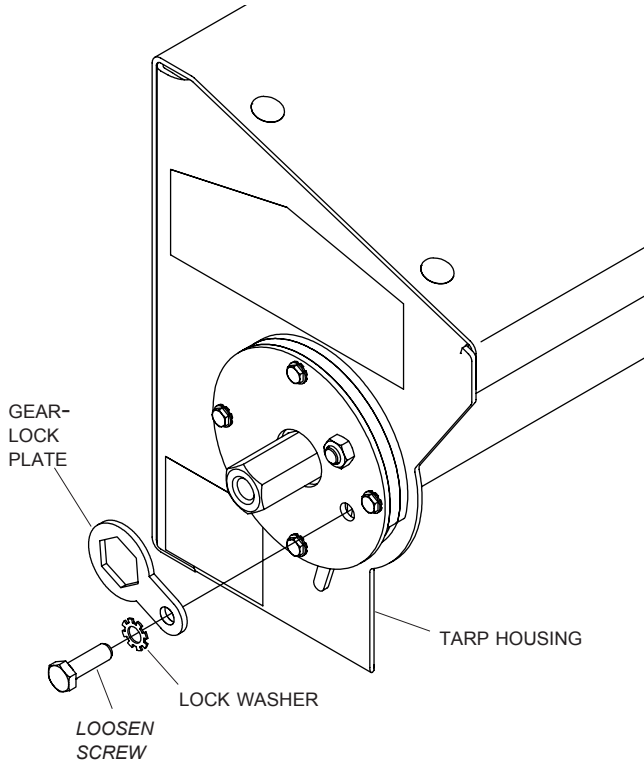

STEP 2: Using a 7/8" wrench, crank ratchet nut clockwise to build spring tension. Count the number of turns and use the table below as a guide.

APPROXIMATE PRE-LOAD TURNS			
Tarp Length	13'	18'	25'
Turns	30/35	35/40	40/45

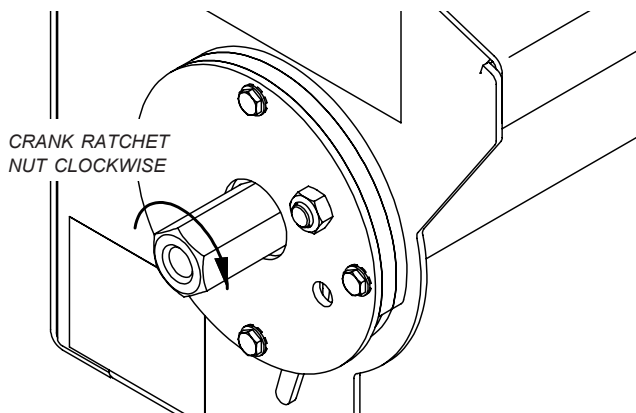

STEP 3: Untie rope from tailgate and open and close tarp a few times. If tarp does not fully retract, or if more tension is needed, pull tarp toward tailgate as far as possible and secure tarp to tailgate. Add five more turns to ratchet assembly and test operation again. Repeat this procedure until you reach desired spring tension. Do not exceed 60 turns.

STEP 4: When spring tension is adequate, reinstall gear-lock plate and fasten plate to tarp housing by replacing lock washer and screw, tightening securely.

STEP 5: To decrease tension or remove ratchet assembly, first remove gear-lock plate. Place 7/8" wrench onto ratchet nut and apply pressure in clockwise direction. Pull back lever at bottom of ratchet assembly to disengage ratchet pawl and slowly turn wrench counter-clockwise to reduce spring tension. Release lever to reengage ratchet. When ratchet has reengaged, remove wrench.

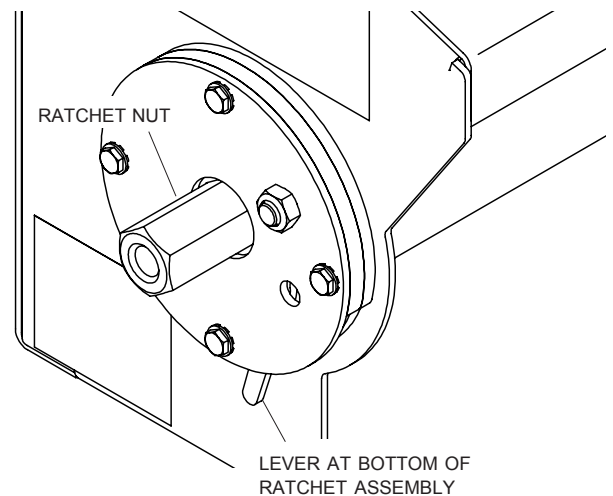

NOTE: If removing ratchet assembly, make sure all spring tension is removed before disassembling.

TARP HOUSINGS

Item	Part #	Description
	1121315	Tarp Housing Assembly - 96"
	1121316	Tarp Housing Assembly - 102"
	1121922	Tarp Housing Assembly - 80"
	1121964	Tarp Housing Assembly - 84"
	1121957	Tarp Housing Assembly - 88"
	1126639	Tarp Housing Assembly - 90"
	1121556	Tarp Housing Assembly - 92"
1.	1121319	Tarp Housing Shield - 96"
	1121320	Tarp Housing Shield - 102"
	1121923	Tarp Housing Shield - 80"
	1121965	Tarp Housing Shield - 84"
	1121958	Tarp Housing Shield - 88"
	1126643	Tarp Housing Shield - 90"
	1121557	Tarp Housing Shield - 92"
2.	1121317	Tarp Housing End Panel - Driver Side
3.	1121318	Tarp Housing End Panel - Pass. Side
4.	1121321	Tarp Housing Shield Brace
5.	1121322	Tarp Spool Assembly - 96"
	1121323	Tarp Spool Assembly - 102"
	1121924	Tarp Spool Assembly - 80"
	1121966	Tarp Spool Assembly - 84"
	1121959	Tarp Spool Assembly - 88"
	1126644	Tarp Spool Assembly - 90"
	1121558	Tarp Spool Assembly - 92"
6.	1121339	Tarp Spool Ratchet Assembly
7.	1121349	Tarp Spool Idler Stud
8.	1704905	Hex Flange Cap Screw - #10 x 1"
9.	1704913	Lock Washer - #10 - External Tooth
10.	1704906	Carriage Bolt - 1/4" x 1/2" - Zinc Plated
11.	1700427	Flat Washer - 1/4 USS
12.	1704185	Nylon Lock Nut - 1/4" - Thin
13.	1700413	Hex Jam Nut - 1/2"
14.	1700409	Hex Nut - 1/2" ZP
15.	1700437	Lock Washer - 1/2"
16.	1110649	Manual Crank Pulley Spacer
17.	1704935	Decal - DuraPull™
18.	1704936	Decal - Ratchet Warning - DuraPull™

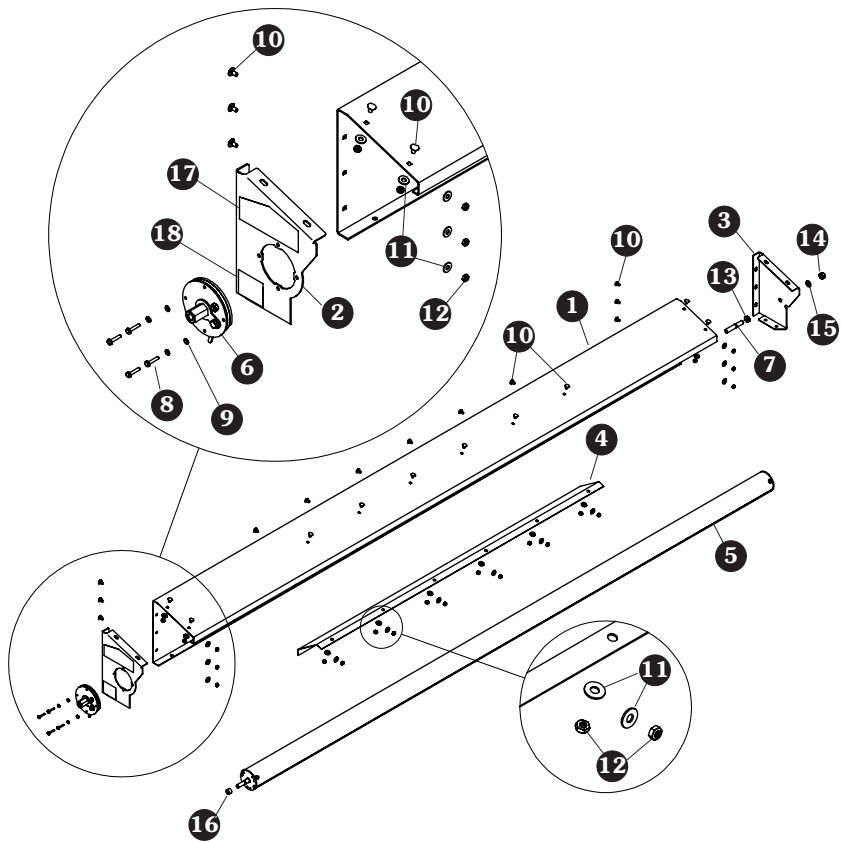

TARP HOUSING MOUNTING STRIPS

Item	Part #	Description
1.	1121361	End Panel Mounting Strip - Steel
	1121364	End Panel Mounting Strip - Aluminum
2.	1121359	Shield Mounting Strip - 47 7/8" - Steel (for 96" wide housing)
	1121362	Shield Mounting Strip - 47 7/8" - Aluminum (for 96" wide housing)
	1121360	Shield Mounting Strip - 50 7/8" - Steel (for 102" wide housing)
	1121363	Shield Mounting Strip - 50 7/8" - Aluminum (for 102" wide housing)
	1121926	Shield Mounting Strip - 39 7/8" - Steel (for 80" wide housing)
	1121927	Shield Mounting Strip - 39 7/8" - Aluminum (for 80" wide housing)
	1121968	Shield Mounting Strip - 41 7/8" - Steel (for 84" wide housing)
	1121969	Shield Mounting Strip - 41 7/8" - Aluminum (for 84" wide housing)
	1121961	Shield Mounting Strip - 43 7/8" - Steel (for 88" wide housing)
	1121962	Shield Mounting Strip - 43 7/8" - Aluminum (for 88" wide housing)
	1126641	Shield Mounting Strip - 44 7/8" - Steel (for 90" wide housing)
	1126640	Shield Mounting Strip - 44 7/8" - Aluminum (for 90" wide housing)
	1121570	Shield Mounting Strip - 45 7/8" - Steel (for 92" wide housing)
	1121571	Shield Mounting Strip - 45 7/8" - Aluminum (for 92" wide housing)
3.	1703171	Cap Screw - 5/16" x 1/2" (for steel strips)
4.	1701045	Cap Screw - 5/16" x 3/4" (for aluminum strips)
5.	1700433	Lock Washer - 5/16"
6.	1700428	Flat Washer - 5/16"

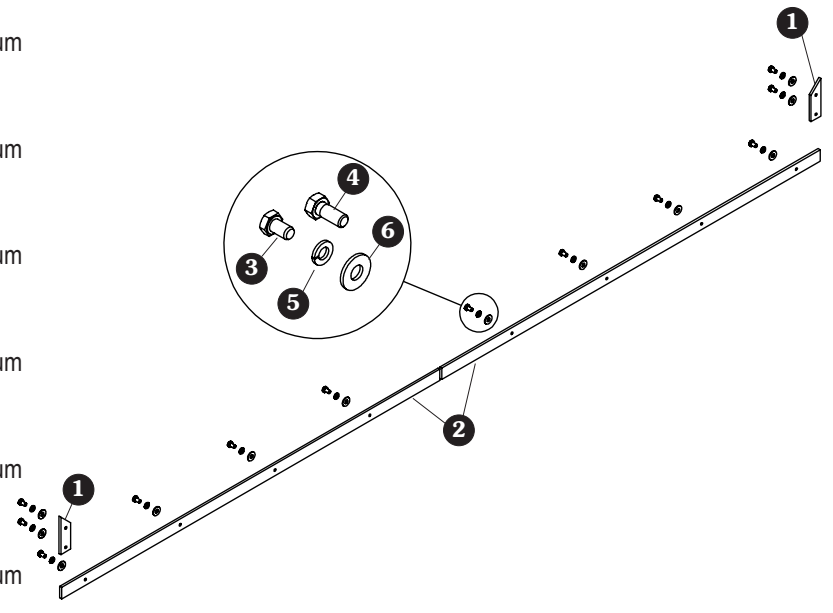

TARP SPOOLS

Item	Part #	Description
	1121322	Tarp Spool Assembly - 96"
	1121323	Tarp Spool Assembly - 102"
	1121924	Tarp Spool Assembly - 80"
	1121966	Tarp Spool Assembly - 84"
	1121959	Tarp Spool Assembly - 88"
	1126644	Tarp Spool Assembly - 90"
	1121558	Tarp Spool Assembly - 92"
1.	1704908	Flange Bearing - 1/2" - Snap In
2.	1128200	Tarp Spool End Cap
3.	1700398	Self-Drilling Screw - 1/4" x 3/4"
4.	1121332	Spring Shaft
5.	1121337	Tarp Spool Tube - 94 3/4"
	1121338	Tarp Spool Tube - 100 3/4"
	1121925	Tarp Spool Tube - 78 3/4"
	1121967	Tarp Spool Tube - 82 3/4"
	1121960	Tarp Spool Tube - 86 3/4"
	1126647	Tarp Spool Tube - 88 3/4"
	1121559	Tarp Spool Tube - 90 3/4"
6.	1704765	Torsion Spring - 1 1/2" x 1/8" x 47"
7.	1121327	Spring Spacer Tube
8.	1121328	Spring Tube Catch
9.	1704919	Flat Washer - 1/2"
10.	1704907	Cotter Pin - 1/8" x 1"

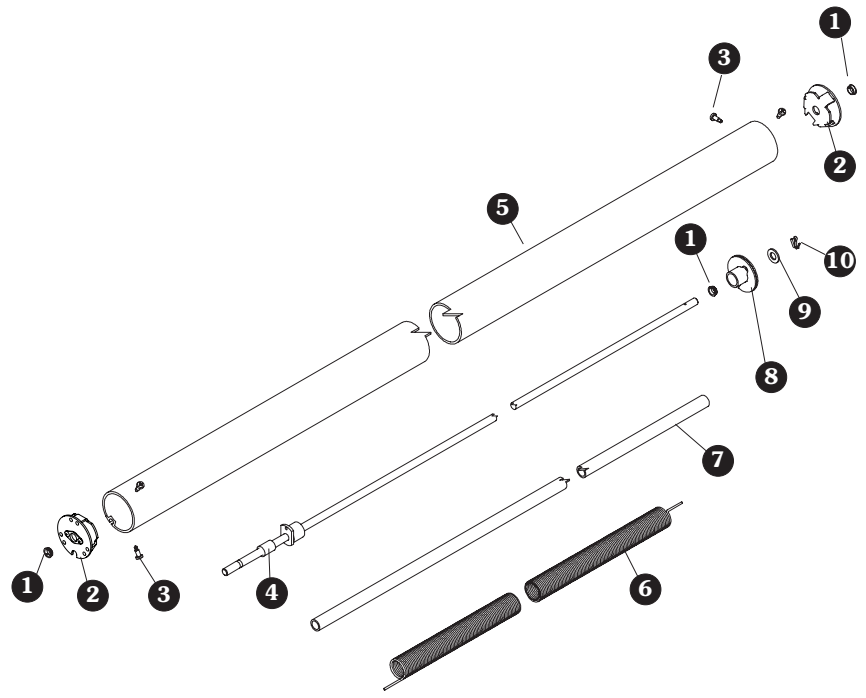

TARP SPOOL RATCHETS

Item	Part #	Description
	1121339	Tarp Spool Ratchet Assembly
1.	1704416	Cap Screw - 5/16" x 1"
2.	1704912	Lock Washer - 5/16" - External Tooth
3.	1704813	Nylon Lock Nut - #10
4.	1121348	Ratchet Lock Plate
5.	1704454	Nylon Lock Nut - 5/16"
6.	1121347	Ratchet Cover Plate
7.	1704904	Extension Spring - 7/32" x .023" x 1 5/16"
8.	1702881	Pawl Washer - 3/8"
9.	1121346	Ratchet Pawl
10.	1704911	Nylon Washer - 1/16" x 3/4" x 5/16"
11.	1705718	Ratchet Gear
12.	1121340	Ratchet Base Assembly

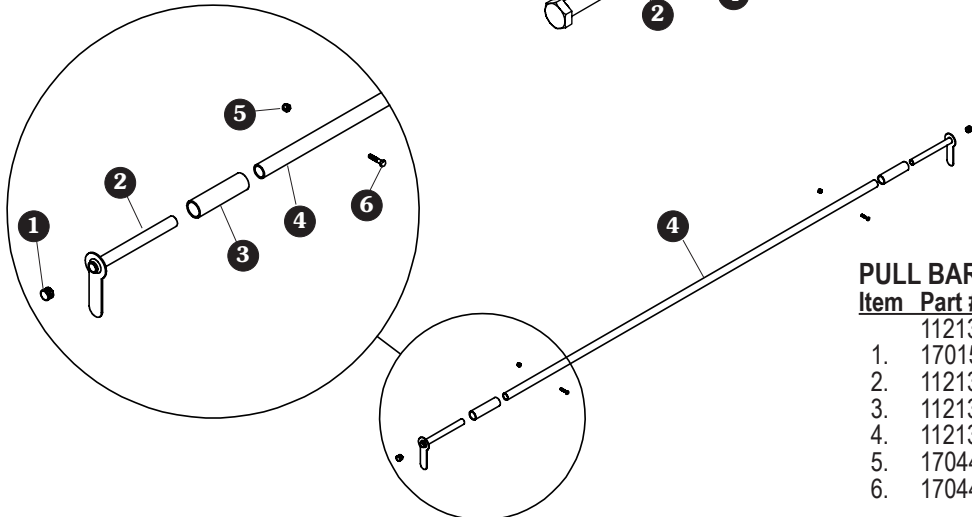
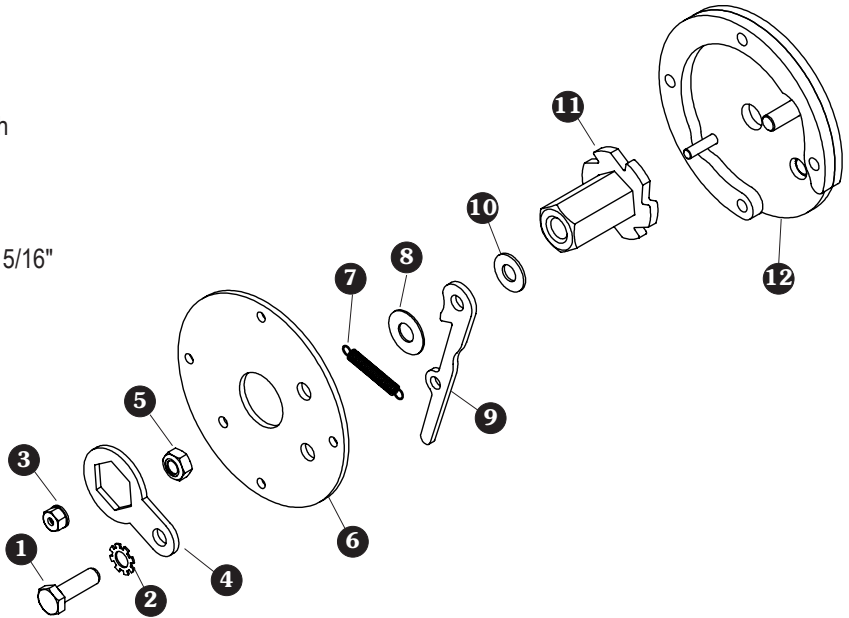

PULL BARS

Item	Part #	Description
	1121390	Pull-Style System Base
1.	1701595	End Plug - 1" OD - 14 to 23 Ga. Poly
2.	1121351	Pull-Bar Guide
3.	1121355	Pull-Bar Roller
4.	1121350	Pull-Bar - 104"
5.	1704454	Nylon Lock Nut - 5/1" - Thin
6.	1704451	Cap Screw - 5/16" x 1 5/8"

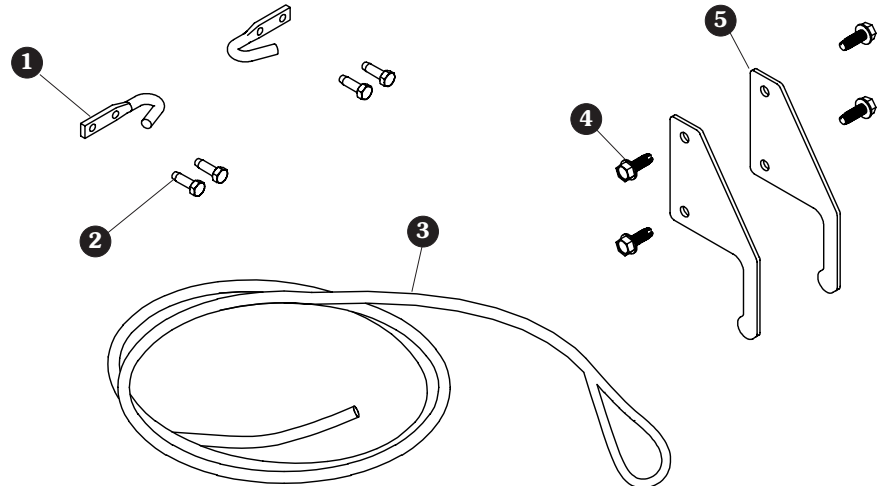

PULL ROPES & HOOKS

Item	Part #	Description
1.	1706059	Box Hook - 3/8" x 4 7/8"
2.	1701059	Self-Tapping Screw - 5/16" x 1"
3.	1127822	Pull Rope Assembly
4.	1700400	Self-Tapping Screw - 3/8" x 1"
5.	1121357	Pull-Bar Retaining Hook

MORE QUALITY PRODUCTS FROM DONOVAN™

■ Construction Products

- Arm-Matic™
- DuraPull™
- Econo-Pull™
- Turbo Tarp2™
- 2000 Series
- 5000 Series
- Hammer™
- Bullet™
- Flash™
- Long Arm™

■ Waste Products

- SWAT™
- The Ox™
- Quick-Flip III™
- Sidewinder™
- Sidewinder™ 350
- HyTower™ SL
- HyTower™ DL
- Double-Flip™
- Donovan Belt & Ratchet (DBR)

TARP SYSTEMS, PARTS & TARPS

