

# Telescoping Crank - Replacement Crank Arm

P/N 1124847 Rev. A

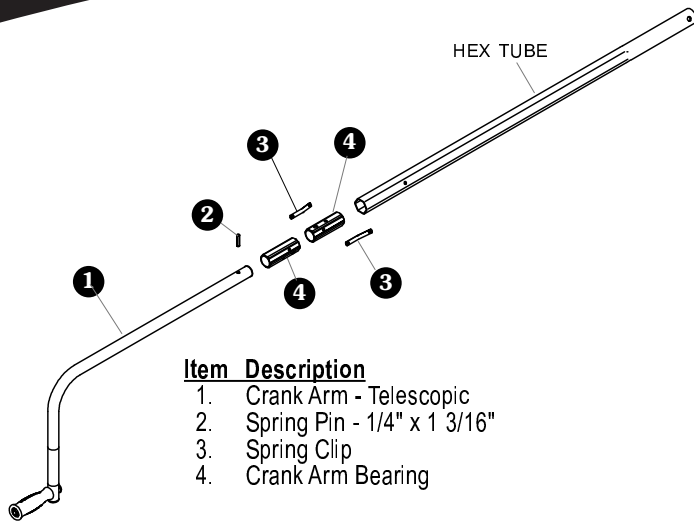

**Item Description**

- 1. Crank Arm - Telescopic
- 2. Spring Pin - 1/4" x 1 3/16"
- 3. Spring Clip
- 4. Crank Arm Bearing

1. REMOVE HEX TUBE FROM CRANK ARM (SECURE HEX TUBE IN VISE).

A. SLIDE CRANK ARM INTO HEX TUBE.

B. PRESS & HOLD BUTTONS.

C. SLIDE CRANK ARM OUT OF HEX TUBE.

2. SLIDE HEX TUBE OVER SECOND BEARING ON CRANK ARM, ALIGNING GROOVES IN BEARING W/HOLES IN HEX TUBE. HOLD SPRING CLIPS AS SHOWN. SLIDE BEARING W/SPRING CLIPS INTO HEX TUBE UNTIL SPRING CLIPS SNAP INTO HOLES IN HEX TUBE.

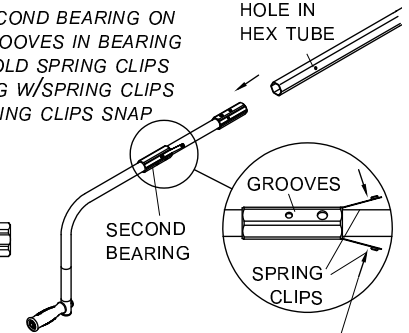
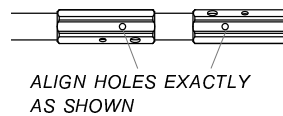

PRESS ENDS OF CLIPS AGAINST ROUND TUBE WHILE INSERTING INTO HEX TUBE

PO BOX 713 ■ 2309 SHUR-LOK STREET  
YANKTON, SOUTH DAKOTA 57078-0713  
PH. 1-800-474-8756 ■ FAX 605-665-0501



SHUR-CO® HELP LINE  
CALL: 1-866-748-7435  
www.shurco.com

# Telescoping Crank - Replacement Crank Arm

P/N 1124847 Rev. A

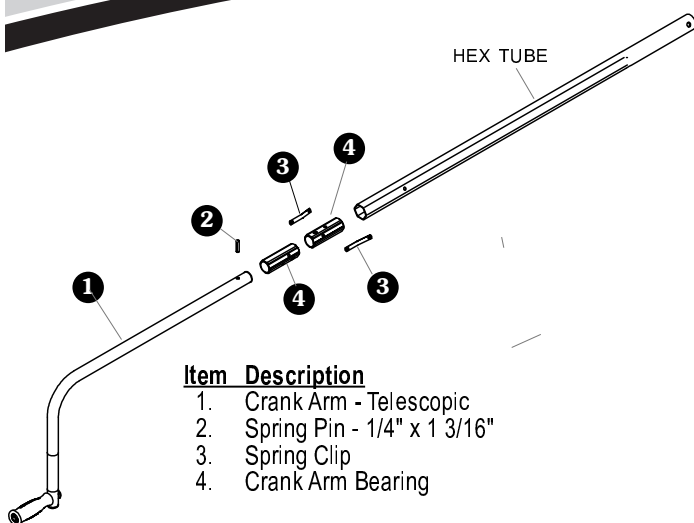

**Item Description**

- 1. Crank Arm - Telescopic
- 2. Spring Pin - 1/4" x 1 3/16"
- 3. Spring Clip
- 4. Crank Arm Bearing

1. REMOVE HEX TUBE FROM CRANK ARM (SECURE HEX TUBE IN VISE).

A. SLIDE CRANK ARM INTO HEX TUBE.

B. PRESS & HOLD BUTTONS.

C. SLIDE CRANK ARM OUT OF HEX TUBE.

2. SLIDE HEX TUBE OVER SECOND BEARING ON CRANK ARM, ALIGNING GROOVES IN BEARING W/HOLES IN HEX TUBE. HOLD SPRING CLIPS AS SHOWN. SLIDE BEARING W/SPRING CLIPS INTO HEX TUBE UNTIL SPRING CLIPS SNAP INTO HOLES IN HEX TUBE.

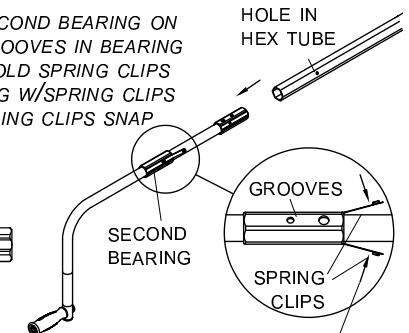
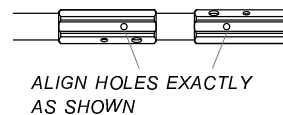

PRESS ENDS OF CLIPS AGAINST ROUND TUBE WHILE INSERTING INTO HEX TUBE

PO BOX 713 ■ 2309 SHUR-LOK STREET  
YANKTON, SOUTH DAKOTA 57078-0713  
PH. 1-800-474-8756 ■ FAX 605-665-0501



SHUR-CO® HELP LINE  
CALL: 1-866-748-7435  
www.shurco.com