

| Item | Part #  | Description                        |
|------|---------|------------------------------------|
|      | 1124875 | Shur-Return™ Kit - 3"              |
|      | 1124876 | UPS-able Shur-Return™ Kit - 3"     |
| 1.   | 1100138 | Nylon End Plug                     |
| 2.   | 1700717 | Eyebolt - 5/16"                    |
| 3.   | 1700419 | Nylon Lock Nut - 5/16"             |
| 4.   | 1700411 | Hex Nut - 5/16"                    |
| 5.   | 1704743 | Self-Drilling Screw - #10 x 1/2"   |
| 6.   | 1121041 | Roll Tube Cap - 3"                 |
| 7.   | 1100827 | Spring Retainer Plug               |
| 8.   | 1107879 | Connector Sleeve                   |
| 9.   | 1100826 | Shur-Return™ Rope                  |
| 10.  | 1701423 | Hex Socket Set Screw - #10 x 3/16" |
| 11.  | 1705198 | Self-Drilling Screw - 1/4" x 1"    |

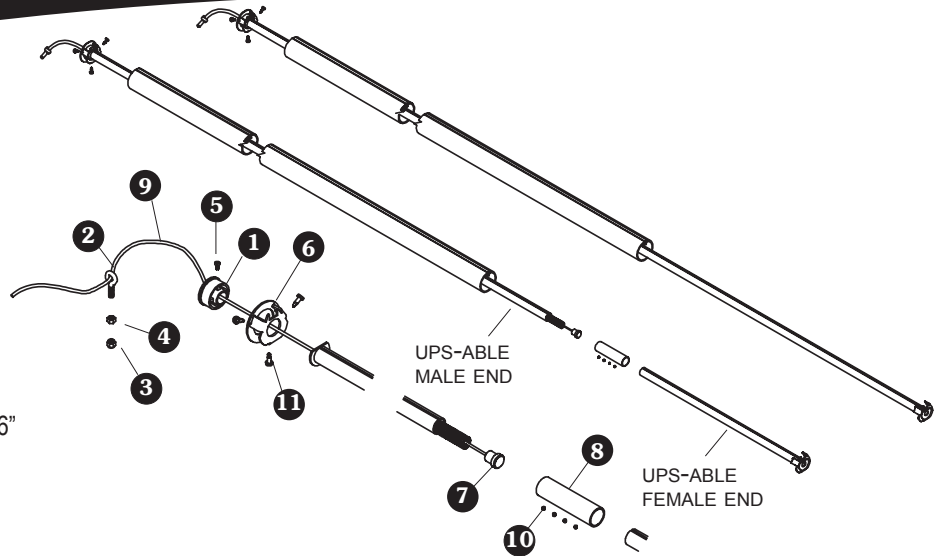

**NOTE:** Steps 1 and 2 are for UPS-able Shur-Return™ only.

**STEP 1:** Align grooves in male and female UPS-able Shur-Return™ ends and insert female end into connector sleeve. Tighten set screws.

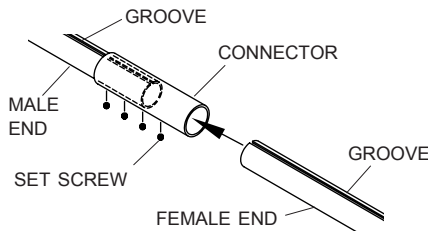

**NOTE:** Install set screws 180° from groove. Do not over tighten set screws.

**STEP 2:** Cautiously untie knot and slowly allow spring to expand to full length of UPS-able Shur-Return™.

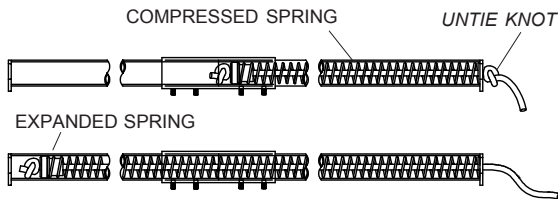

**NOTE:** Spring is compressed. Use caution when untying knot.

**STEP 3:** Remove and discard existing 1/4" x 3/4" screws from U-clamps on front 11' of tarp.

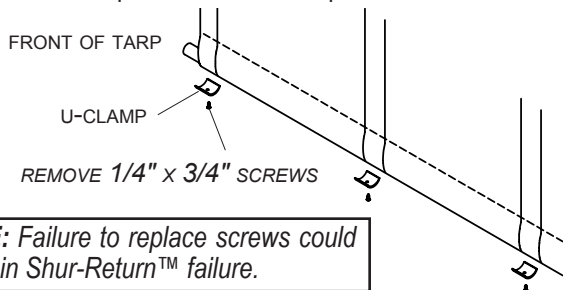

**NOTE:** Failure to replace screws could result in Shur-Return™ failure.

**STEP 4:** Insert Shur-Return™ into roll tube at front of trailer as shown. Thread rope through nylon end plug/roll tube cap. Refasten U-clamps with screws ⑬.

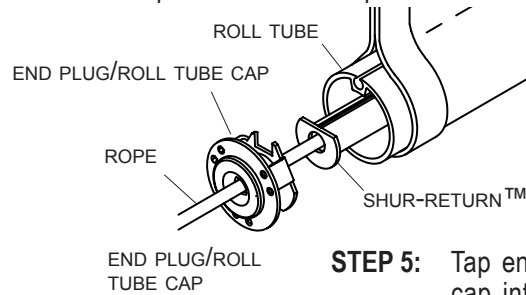

**STEP 5:** Tap end plug/roll tube cap into roll tube and mark location 7/16" from edge of end plug. Secure to roll tube with screws ⑬.

**STEP 6:** Drill 11/32" hole into latchplate 1 1/2" past end of tarp. Insert eyebolt ④ through hole and secure with nut ⑥ and lock nut ⑤.

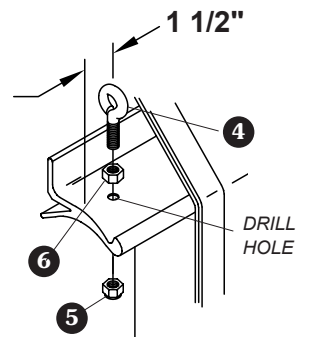
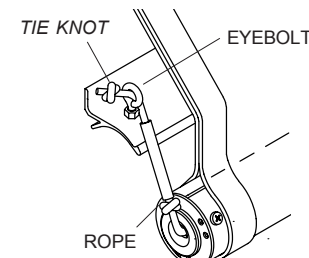

**STEP 7:** Insert Shur-Return™ rope through eyebolt, remove all slack from rope and tie knot. Cut off excess rope and melt frayed end.

| Item | Part #  | Description                             |
|------|---------|---|
|      | 1124882 | Front Stretch Cord Roll Return Kit - 3" |
| 1    | 1111067 | Roll Return Tube Set - 2 Pc.            |
| 2    | 1114360 | Roll Return Stretch Cord - 11 1/2"      |
| 3    | 1100138 | Nylon End Plug                          |
| 4    | 1703373 | Flat Washer - 1/2"                      |
| 5    | 1700717 | Eyebolt Anchor - 5/16"                  |
| 6    | 1700419 | Nylon Lock Nut - 5/16"                  |
| 7    | 1700411 | Hex Nut - 5/16"                         |
| 8    | 1107680 | Protective Stretch Cord Cover           |
| 9    | 1121041 | Roll Tube Cap - 3"                      |
| 10   | 1705198 | Self-Drilling Screw - 1/4" x 1"         |

**NOTE:** If PVC pipe is not seen after removing end plug, raise crank handle end of roll tube in order for the roll return components to slide out of roll tube.

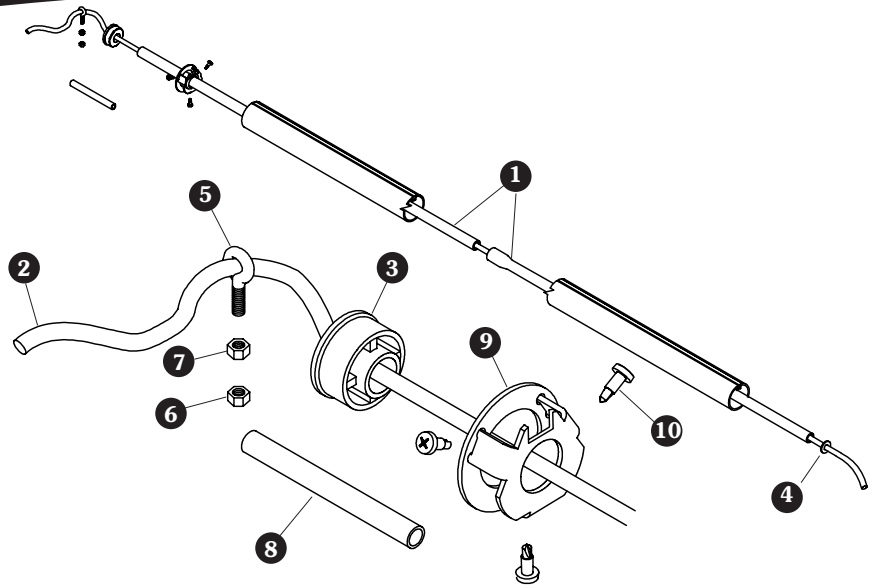

**STEP 1:** Press belled PVC pipe over end of straight PVC pipe. Press end plug into roll tube cap, then into end of straight pipe.

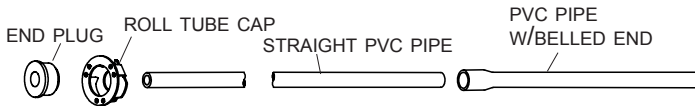

**STEP 2:** Insert stretch cord through pipes and end plug and cap. Slide flat washer on end of stretch rope and tie knot.

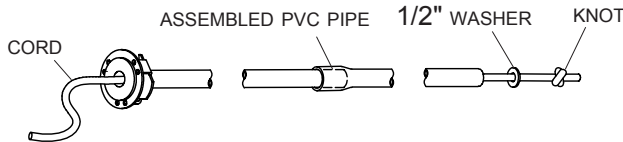

**STEP 3:** Insert roll return assembly into roll tube and lightly tap end plug and roll tube cap into place.

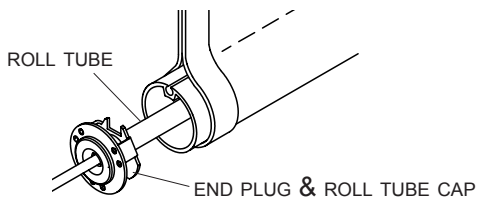

**STEP 4:** Mark location 7/16" from edge of roll return end plug. Secure end plug to roll tube with screws 10.

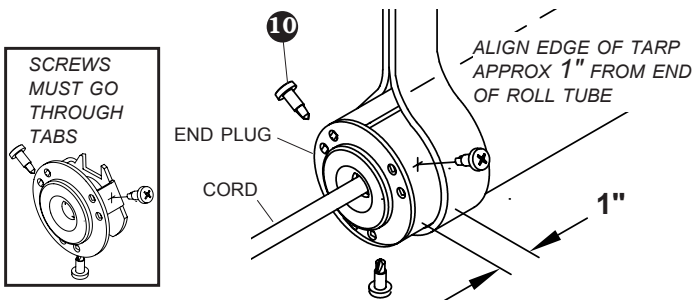

**STEP 5:** Drill 13/32" hole through latchplate 1 1/2" from end. Grind rough edges smooth. Insert eye bolt 5 through hole, secure with nut 7 and lock nut 6.

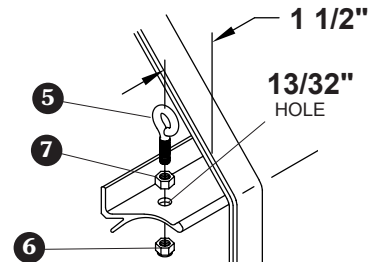

**STEP 6:** With tarp hanging over edge of box, pull stretch cord to remove slack in roll return assembly. Tie knot 6" to 12" from end of cord.

**STEP 7:** Slide protective cover over stretch cord.

**STEP 8:** Thread stretch cord through eye bolt. Tie knot on end of cord, creating enough tension to lift roll return slightly.

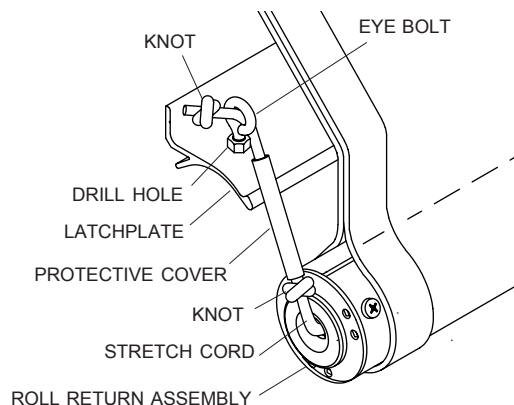

**STEP 9:** Test operation. Cut excess stretch cord and melt any frayed ends.