



TARP SYSTEMS & ACCESSORIES

P/N 1126365 Rev. A

# OWNER'S MANUAL



## For Potato Box

READ BEFORE INSTALLING

2309 SHUR-LOK STREET • YANKTON, SD 57078-0713  
PHONE: 1-800-SHUR-LOK (1-800-474-8756) • FAX: 1-605-665-0501  
[www.SHURCO.com](http://www.SHURCO.com)

SHOP ONLINE: [www.SHOPSHURCO.com](http://www.SHOPSHURCO.com)

**SHIPPING.** Orders are shipped F.O.B. from the Shur-Co®, LLC sites listed below. No full freight is allowed or prepaid shipment accepted unless quoted and approved in writing prior to acceptance of the order. All shipments are made by the most reasonable means in accordance with size and weight of order, unless specified routing instructions are furnished by the customer. Shipments are made daily via U.P.S. and common carrier. Claims for shortages must be made within 10 days. All claims for damages or loss in transit must be made with the carrier. No collect calls will be accepted. To ensure delivery of orders, we need your full street address and phone number. When you receive your shipment, examine it carefully. Be sure all cartons listed on the delivery sheet are accounted for. Large items may be packaged separately. If a carton is damaged, open it and inspect the contents before signing for delivery. If merchandise is damaged, describe damage on the delivery receipt. Failure on your part to document damaged or missing merchandise on the delivery receipt releases the carrier of all liability; repair or replacement will be the customer's responsibility.

**WARRANTY.** We warrant all new products are free of defects in materials and workmanship.\* This warranty is effective if products are properly installed and used for the purpose for which they were intended and applies to the original buyer only. Except as set forth above or in any product-specific warranty documentation, we make no other warranties, express or implied, including but not limited to warranties of merchantability of fitness for a particular use.

Returns of a product for warranty must be accompanied by a Return Merchandise Authorization number (RMA#), obtained by calling Customer Service at 866-748-7435, and sent, with freight paid by us, to Shur-Co®, LLC, 2309 Shur-Lok St., PO Box 713, Yankton, SD 57078. All products returned without an RMA# will be refused. When we issue the RMA#, we will also issue a call tag to have UPS (or other freight company) pick up the product. C.O.D. returns not accepted. We will pay no storage fees for a warranty product return prior to pick by us or the freight company. If a warranty product return is scheduled to be picked up by us, we will pick up the product at our earliest convenience.

If a product returned is found, in our judgement, to be defective in material or workmanship, our obligation under this warranty is limited to the repair or replacement of the product, which will be made by us. Repair or replacement will be at our discretion, with replacements being made using current products performing in the equivalent function. Labor charges, other than those incurred at our factory, including, but not limited to, any labor to install a repaired or replacement product, are not covered under this warranty. All expenses associated with delivering defective products to our factory and delivering repaired or replacement products from our factory to the owner will be paid by us.

If the product returned is found, in our judgement, to be non-warrantable, the owner will be contacted to authorize repair work, purchase of a replacement product or return of the product, all of which will be at the owner's expense. Payment authorization must be received by us before any non-warrantable product is repaired, replaced or returned. All expenses associated with delivering the repaired non-warrantable product, a replacement product or the non-warrantable product from our factory to the owner will be paid by the owner.

In no event will we be liable for any damages of any kind to person, product or property, including but not limited to indirect, incidental, special, consequential or punitive damages, or damages for loss of profits or revenue, even if we have been advised of the possibility of such damages. There are no warranties for used products or products that have been repaired, altered, modified or subjected to misuse, negligence or accident. We will not repair or replace products that fail or malfunction due to ordinary wear and tear, except as expressly noted in a product-specific warranty. Use of non-Shur-Co®, LLC parts in conjunction with Shur-Co®, LLC products will void this product warranty.

\*Certain products have specific warranties that differ from this warranty, for example motors and electronics. Product-specific warranty documentation is available for these items. In the event of a conflict between this warranty and a product-specific warranty, the product-specific warranty will govern.

**RETURN POLICY.** All sales final. See WARRANTY above for return details.

**OTHER.** All prices, product listings, sizes, weights and manufacturing details are subject to change without notice. No person is authorized to modify the foregoing conditions of sale whatsoever.

## SHUR-CO®, LLC SERVICE AND DISTRIBUTION CENTERS

*Corporate HQ and Outlet Store*  
**SHUR-CO® of SOUTH DAKOTA**  
 2309 Shur-Lok St., Yankton, SD 57078  
 Ph 800.474.8756 | Fax 605.665.0501

**SHUR-CO® of FLORIDA**  
 3353 SE Gran Park Way, Stuart, FL 34997  
 Ph 800.327.8287 | Fax 772.287.0431

**SHUR-CO® of IDAHO**  
 610 N. 16th Ave., Caldwell, ID 83607  
 Ph 866.356.0246 | Fax 217.877.8270

**SHUR-CO® of ILLINOIS**  
 3993 E. Mueller Ave., Decatur, IL 62526  
 Ph 866.356.0246 | Fax 217.877.8270

**SHUR-CO® of NORTH DAKOTA**  
 1746 4th Ave. NW, West Fargo, ND 58078  
 Ph 877.868.4488 | Fax 701.277.1283

**SHUR-CO® of OHIO**  
 4676 Lynn Rd.  
 Rootstown, OH 44266  
 Ph 866.356.0242 | Fax 330.297.5599

**SHUR-CO® of VERMILLION**  
 1212 N. Norbeck St., Vermillion, SD  
 Ph 605.658.1020 | Fax 605.658.1022

**SHUR-CO® of CANADA**  
 490 Elgin St., Unit #1  
 Brantford, Ontario N3S 7P8  
 Ph 800.265.0823 | Fax 519.751.3997

**SHUR-CO® UK, Ltd.**  
 Unit 41 Rochester Airport Estates  
 Laker Rd., Rochester, Kent ME1 3QX  
 Ph +44 (0)1795.473499  
 Fax +44 (0)871.272.8278

For more information, log on to our website:

**www.shurco.com**

**SHUR-CO® HELP LINE: 1-866-748-7435**

**MESSAGE TO OWNERS**

Thank you for buying this tarping system from Shur-Co®. We appreciate your confidence in our products. Please read and thoroughly understand this manual before installing and/or operating this system.

Pay particular attention to important safety and operating instructions, as well as warnings and cautions. The hazard symbol  is used to alert users to potentially hazardous conditions and is followed by caution, warning or danger messages.

Failure to READ AND FOLLOW INSTRUCTIONS could result in failure of your tarping system and/or personal injury. Your trailer requirements may, however, call for minor variations to these instructions.

Please inspect your tarping system periodically. Repair or replace worn or damaged parts to your system.

QUESTIONS? CALL OUR HELP LINE:  
**1-866-748-7435**  
 MON-FRI 8 AM-5 PM CENTRAL TIME

**SAFETY**

We at Shur-Co® are concerned with your safety and the safety of all those operating this system. Therefore, we have provided safety decals at various locations on your tarping system. Keep decals as clean as possible at all times. Replace any decal that has become worn or damaged, painted over or otherwise difficult to read. Replacement decals are available through Shur-Co® dealers.

**SAFETY INSTRUCTIONS**

- 1. Always wear safety glasses during installation and operation.**
- 2. Stay clear of moving parts.**
- 3. No other use of this system is authorized, except as designed.**

**RUST PREVENTION**

To prevent rust, paint all exposed metal, such as weld seams and/or metal exposed by grinding or cutting, with corrosion-resistant paint.

**TABLE OF CONTENTS**

Hardware Identification..... 1  
 Rear Pivot Bracket.....2-4  
 Fixed Rear Pivot Mount Brackets.....5  
 Front Skin Reinforcement - Pivot Mount.....6  
 Front Pivot Mount Bracket.....7  
 Easy-Off Tarp Stops ..... 8  
 Latchplates ..... 9  
 Roll Tube Deflector.....10  
 Front Cap.....11  
 Back cap.....12  
 Bow Option .....13  
 Tarp Inspection & Fixed Tube.....14  
 Roll Tube & U-Clamps.....15-16  
 Front Pivot Arm.....17-18  
 Rear Pivot Arm .....19-21  
 Fixed Rear Arm Assembly & Installation.....22-23  
 Stretch Cord .....24  
 Wireless Receiver Wiring .....25  
 Operation.....26  
 Pivot Mount Bracket Adjustment - Front & Rear.....27  
 Replacement Parts .....28-34

**TOOLS REQUIRED**

1. Welder
2. Hammer
3. Center Punch or Transfer Punch
4. #3 Phillips Insert Bit
5. Air or Electric Impact Wrench (9/16" deep socket)
6. 7/16" Deep Socket
7. 3/8" Combination Wrench
8. 9/16" Combination Wrench
9. 1/2" Combination Wrench
10. 1/8" Hex Wrench Long T-Handle
11. 3/16" Hex Wrench Long T-Handle (recommended)
12. 7/32" Drill Bit
13. 5/16" Drill Bit (for 3/8" self-tapping screws)
14. 11/32" Drill Bit
15. 13/32" Drill Bit
16. 3/8" Drill
17. 1 1/8" Hole Saw
18. 1 1/2" Hole Saw
19. 2" Hole Saw (if bracket for conductor socket is not used)
20. Standard/Flathead Screwdriver
21. #2 Phillips Screwdriver
22. Utility Knife
23. Ratchet
24. Hack Saw (metal cutter)
25. Pliers
26. Snap-Ring Pliers
27. Wire Cutters
28. Grinder
29. Tape Measure

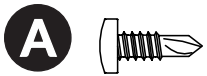

1700398 Pan Hd. Self-Drilling Screw - 1/4" x 3/4"



1704768 Flat Hd. Self-Drilling Screw - 1/4" x 3/4"

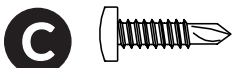

1705198 Self-Drilling Screw - 1/4" x 1"

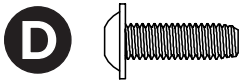

1704441 Self-Tapping Screw - 5/16" x 1"

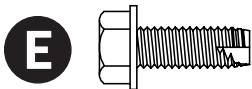

1700400 Self-Tapping Screw - 3/8" x 1"

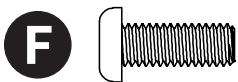

1705322 Button Hd. Screw - 3/8" x 1"

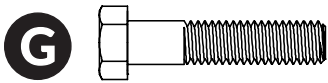

1705680 Cap Screw - 3/8" x 1-3/4"

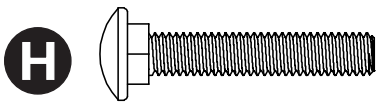

1704516 Carriage Bolt - 3/8" x 2-1/2"



1705758 Button Hd. Cap Screw - 3/8" x 3"

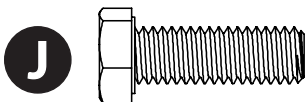

1702075 Cap Screw - 1/2" x 1-1/2"

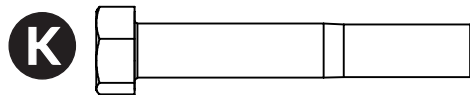

1704808 Cap Screw - 1/2" x 3-1/4"

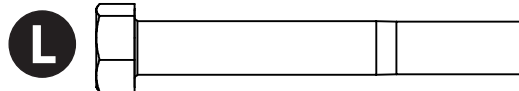

1705687 Cap Screw - 1/2" x 3-3/4"

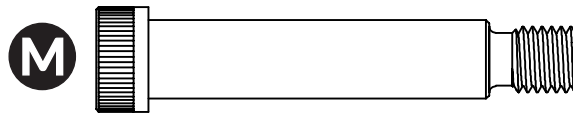

1705694 Shoulder Bolt - 3/4" x 3" Thd.



1704297 Nylon Lock Nut - 5/16"



1700407 Hex Nut - 3/8"



1701580 Nylon Lock Nut - 3/8"



1702115 Nylon Lock Nut - 1/2"

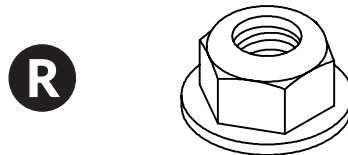

1705695 Flanged Nylon Lock Nut - 5/8"



1700428 Flat Washer - 5/16"



1700434 Lock Washer - 3/8"



1700429 Flat Washer - 3/8"



1703373 Flat Washer - 1/2"

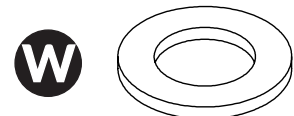

1704810 Flat Washer - 7/8" x 1-1/2"



1702890 Flat Washer - 1-1/4" x 1-7/8"

Inspect all parts upon arrival.

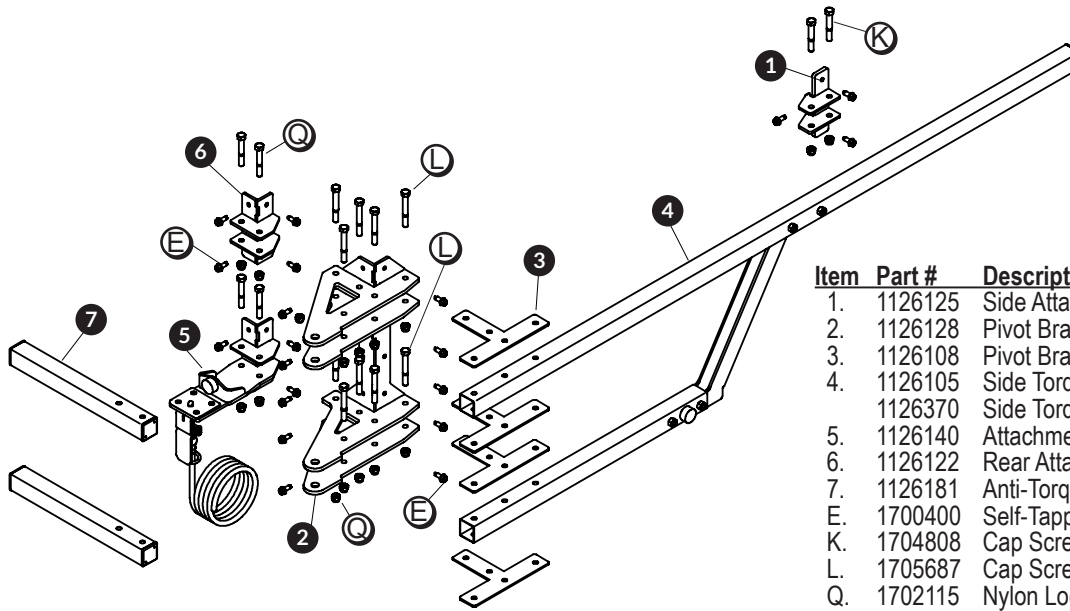

Item	Part #	Description
1.	1126125	Side Attachment Bracket
2.	1126128	Pivot Bracket
3.	1126108	Pivot Bracket Spacer
4.	1126105	Side Torque Arm Assembly - 20' to 24'
	1126370	Side Torque Arm Assembly - 26' to 30'
5.	1126140	Attachment Bracket - Rear Lock Assembly
6.	1126122	Rear Attachment Bracket
7.	1126181	Anti-Torque Tube - Rear Assembly
E.	1700400	Self-Tapping Screw - 3/8" x 1"
K.	1704808	Cap Screw - 1/2" x 3-1/4"
L.	1705687	Cap Screw - 1/2" x 3-3/4"
Q.	1702115	Nylon Lock Nut - 1/2"

**NOTE:** For fixed rear arm, skip to page 5, "Fixed Rear Pivot Mount Bracket".

**STEP 1:** Locate first vertical frame tube in top horizontal recessed rib at rear of box. Use side attachment bracket as guide to drill 5/16" holes and secure bracket to frame tube with screws **E** using impact driver.

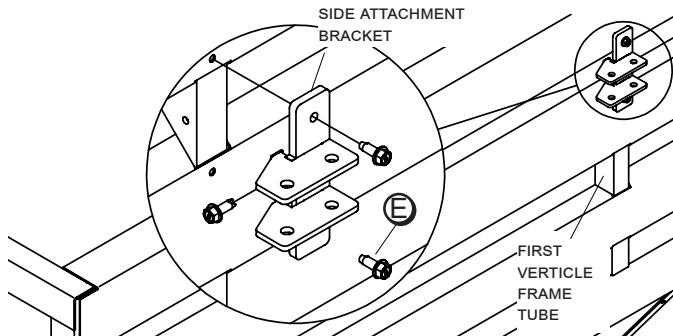

**STEP 2:** Assemble side torque arm assembly to pivot bracket. Align spacers as shown and fasten with six screws **L** and nuts **Q**.

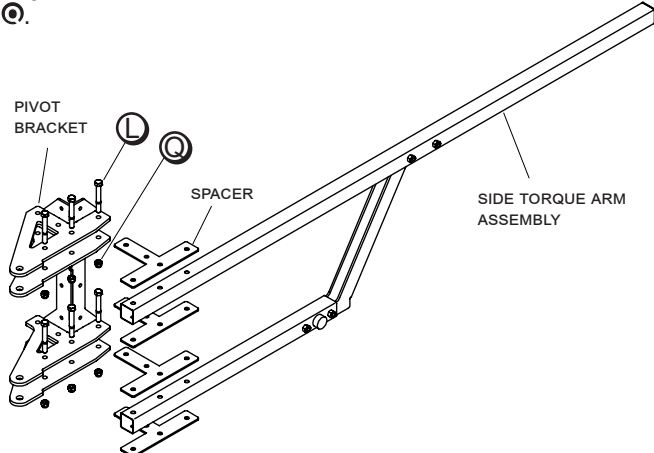

**STEP 3:** Insert long tube on side arm torque assembly into side attachment bracket. Move pivot bracket up and down until longest tube on side arm torque assembly is parallel to top rail. Clamp pivot bracket to corner tube on box.

**NOTE:** Longest tube on side arm torque assembly must be parallel to top rail.

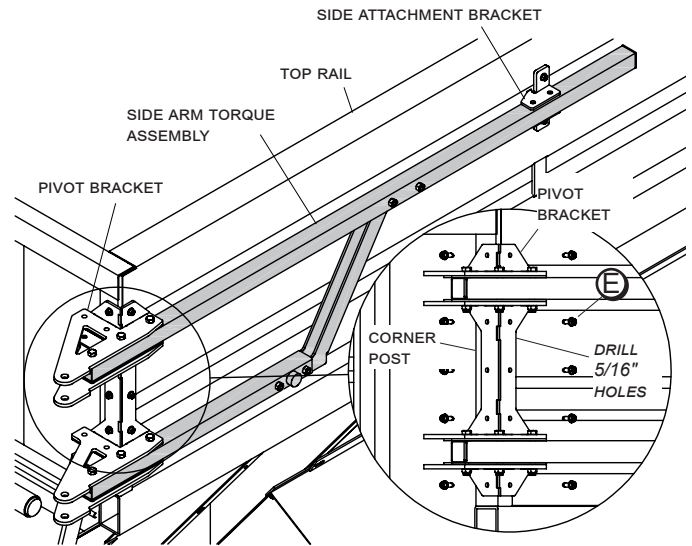

Use holes in pivot bracket as guide to drill ten 5/16" holes in corner post. Use impact driver to secure pivot bracket to corner post with screws **E**.

**STEP 4:** Place rear lock assembly attachment bracket over anti-torque tube. Install tube into pivot bracket and position components as shown. Fasten anti-torque tube to pivot bracket with screws **L** and nuts **Q**.

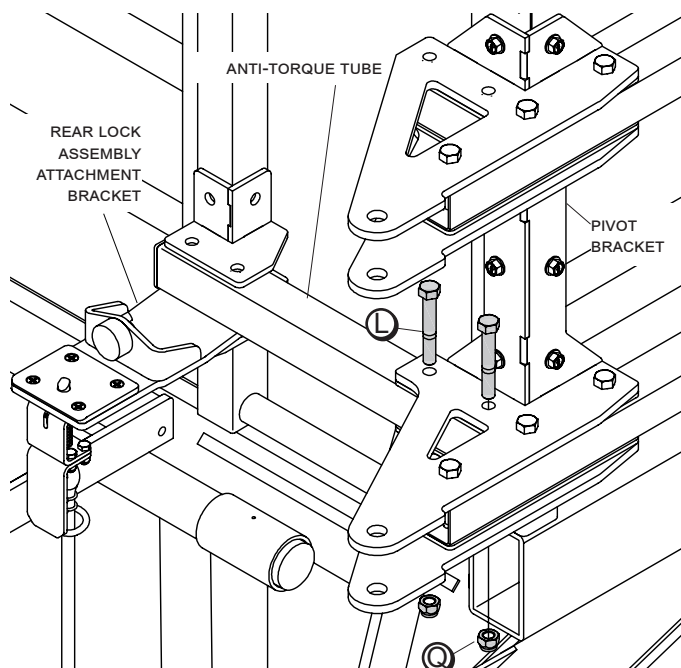

**STEP 6:** Slide rear attachment bracket over anti-torque tube and position components as shown. Fasten anti-torque tube to pivot bracket with two screws **L** and nuts **Q**.

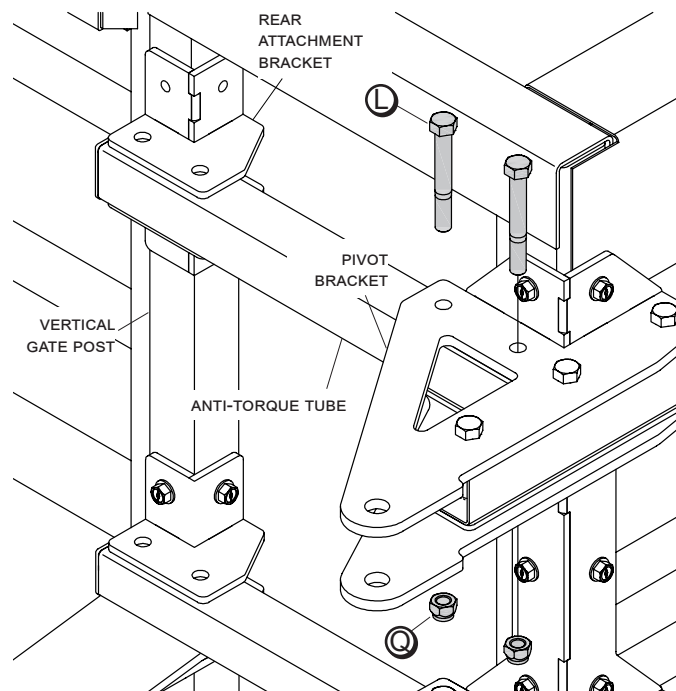

**STEP 5:** Clamp rear lock assembly attachment bracket to vertical gate post. Use holes in bracket as guide to drill 5/16" holes. Use impact driver to secure with four screws **E**.

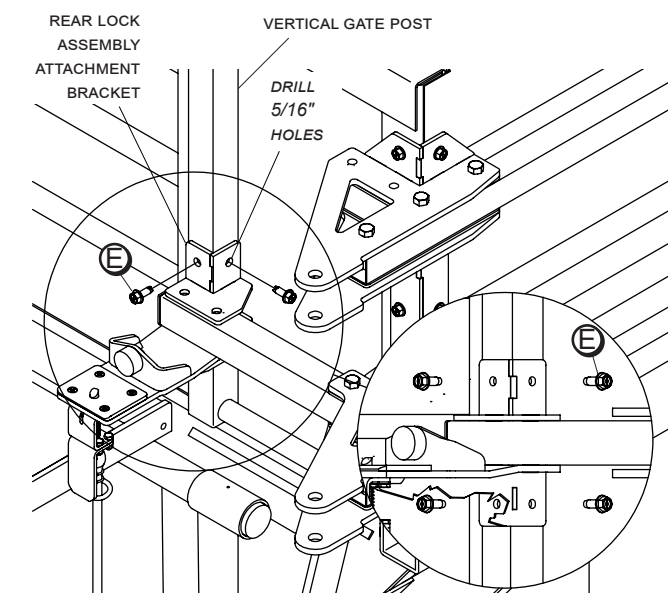

**STEP 7:** Clamp rear attachment bracket to vertical gate post. Use holes in bracket as guide to drill 5/16" holes in gate post. Use impact driver to secure with four screws **E**.

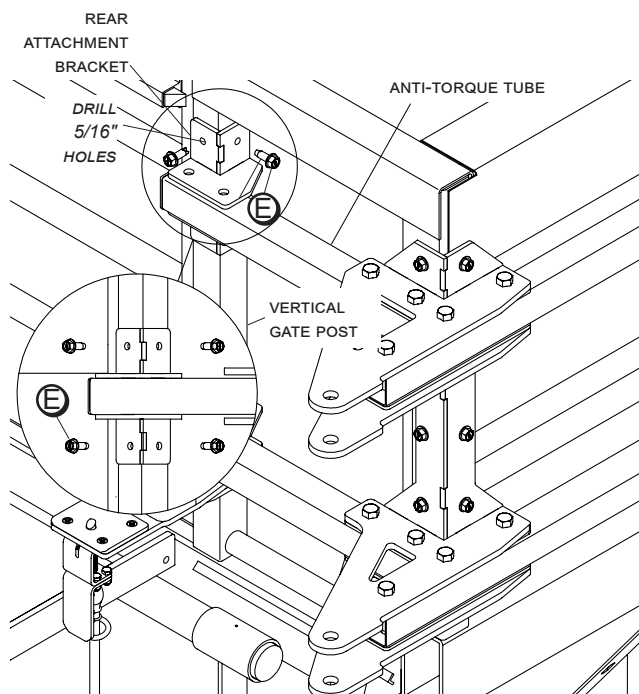

**STEP 8:** Using holes in side and rear attachment brackets as guides, drill 1/2" holes through 2" tubing at both locations.

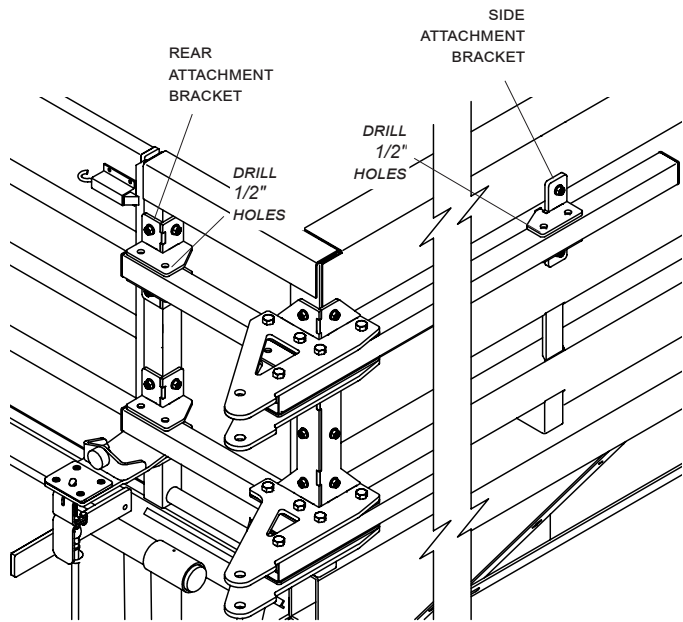

**STEP 9:** Secure with screws **K** and nuts **Q**.

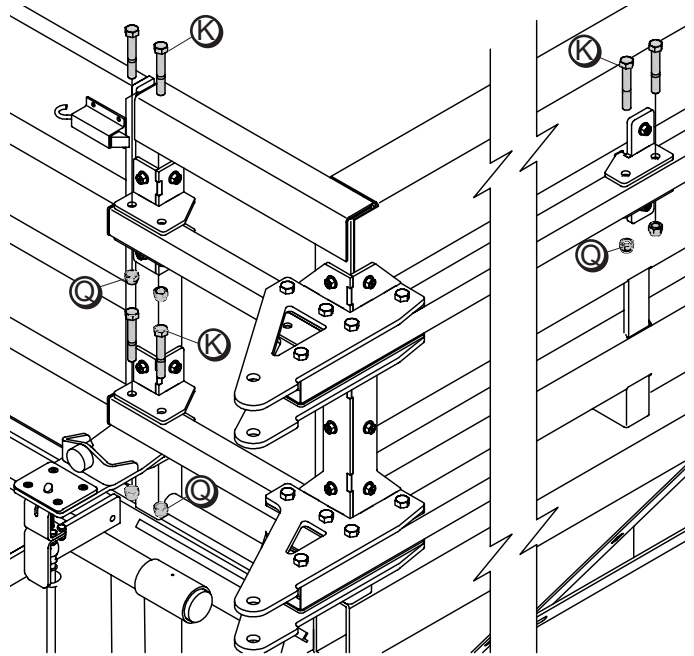

Item	Part #	Description
1.	1126244	Rear Pivot Mount Bracket
F.	1705322	Button Hd. Screw - 3/8" x 1"
O.	1700407	Hex Nut - 3/8"
T.	1700434	Lockwasher - 3/8"
U.	1700429	Flat Washer - 3/8"

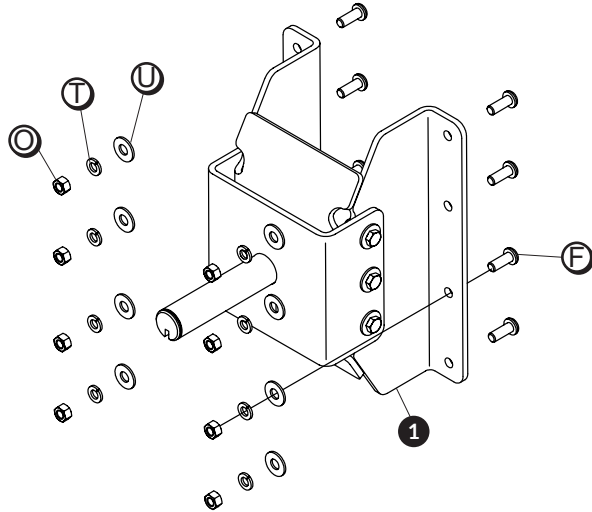

**STEP 1:** Measure and mark hole locations shown and drill two 3/8" holes.

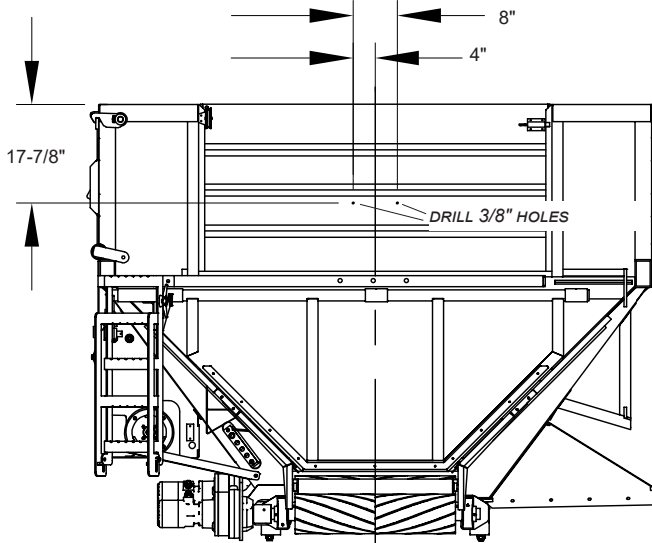

**STEP 2:** Mount rear arm pivot bracket to box with screws **F**, flat washers **U**, lock washers **T** and nuts **O**.

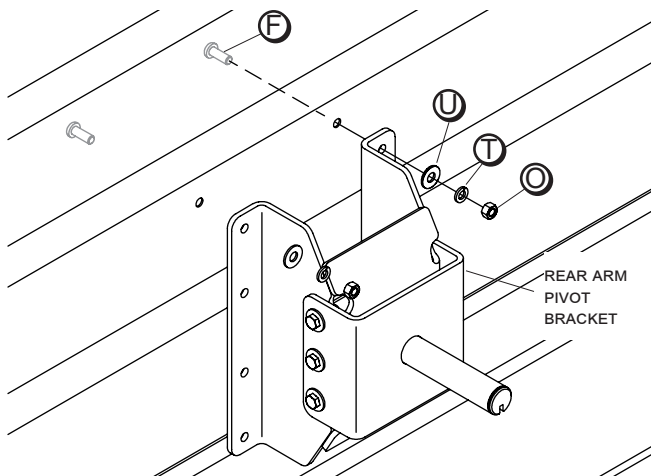

**STEP 3:** Match drill six remaining 3/8" mounting holes.

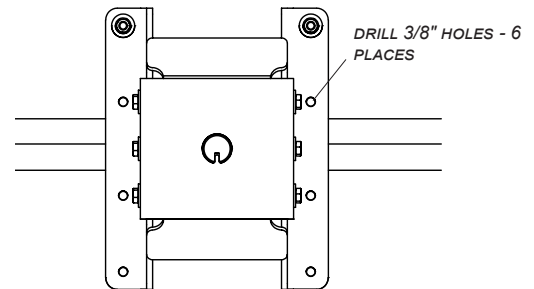

**STEP 4:** Secure with remaining screws **F**, flat washers **U**, lock washers **T** and nuts **O**.

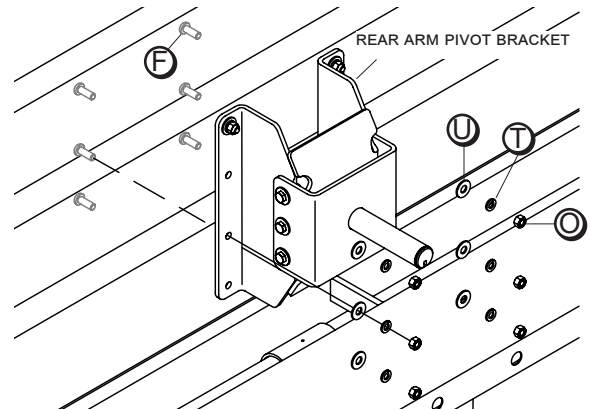

**STEP 5:** Square up shaft to rear face of box with adjustment bolt and nut. Turn nut to adjust bolt length and angle of shaft. Tighten screws on sides of bracket.

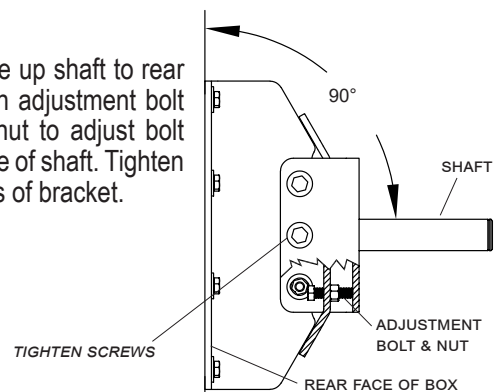



**OPTION 1**

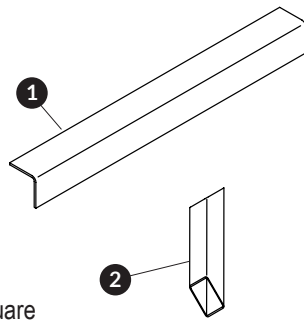

**Item Description**

1. 3" x 3" x 3/16" Angle
2. 2" x 2" 14-Ga. Minimum Square Tubing 45° - 2 Ends

**STEP 1:** Cut 3" x 3" x 3/16" angle to fit between existing vertical frame members. Place between vertical frame members with both legs contacting back side of front skin with lower leg edge maximum of 20-1/8" from top of front rail. Tack weld in place.

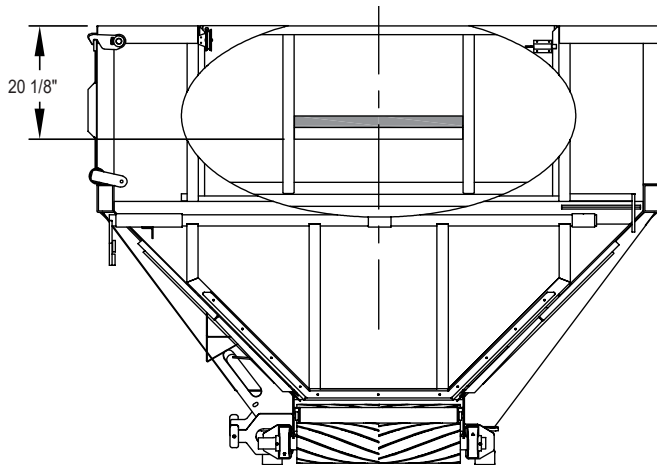

**STEP 2:** Cut two 2" x 2" 14-ga. minimum square tubing with 45° cuts on both ends to fit between two horizontal angle frame members. Tack into place.

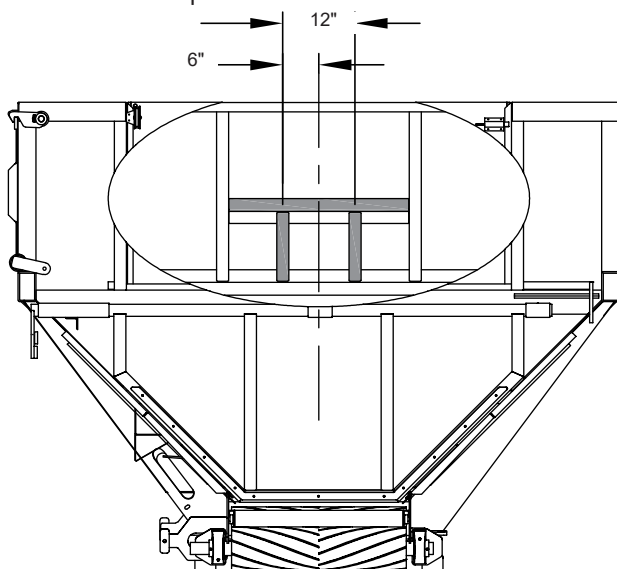

**STEP 3:** Stitch weld to front skin and continuous weld tube to angle.

**OPTION 2**

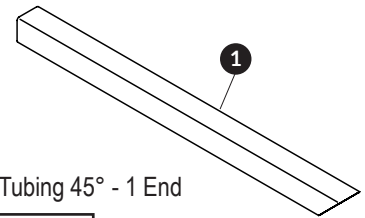

**Item Description**

1. 2" x 2" 14-Ga. Square Tubing 45° - 1 End

**NOTE:** These components are not supplied in kit. To be supplied and installed by OEM.

**STEP 1:** Cut two 2" x 2" 14-ga. minimum wall tubing with one end cut at 45° length to fit between underside of front top rail and horizontal angle frame member. Tack into place.

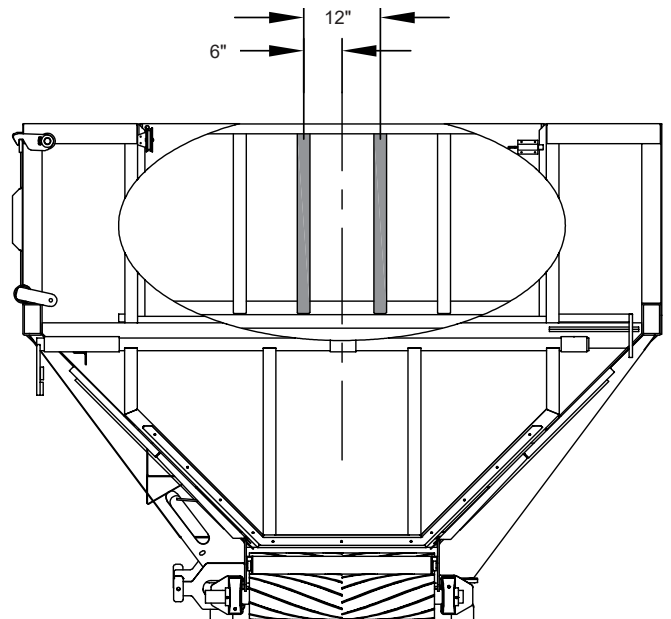

**STEP 2:** Stitch weld to front skin and continuous weld tube to horizontal angle and top rail.

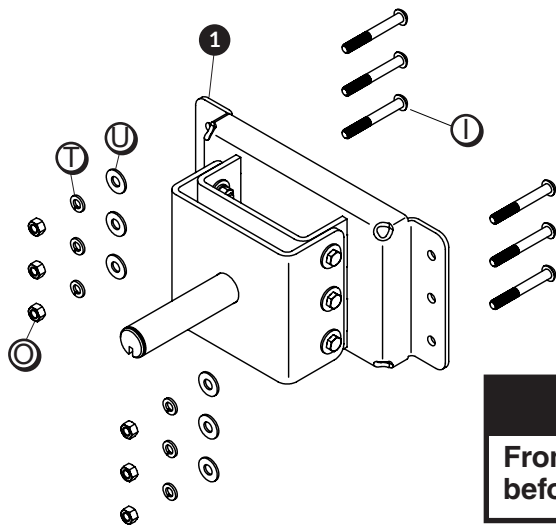

Item	Part #	Description
1.	1126102	Front Pivot Mt. Bracket Assembly
I.	1705758	Button Hd. Cap Screw - 3/8" x 3"
O.	1700407	Hex Nut - 3/8"
T.	1700434	Lock Washer - 3/8"
U.	1700429	Flat Washer - 3/8"

**⚠ WARNING**  
**Front skin reinforcement must be installed before beginning this step.**

**STEP 1:** Measure from top of top rail to top of lower rear 2" square tube (about 22-1/8").

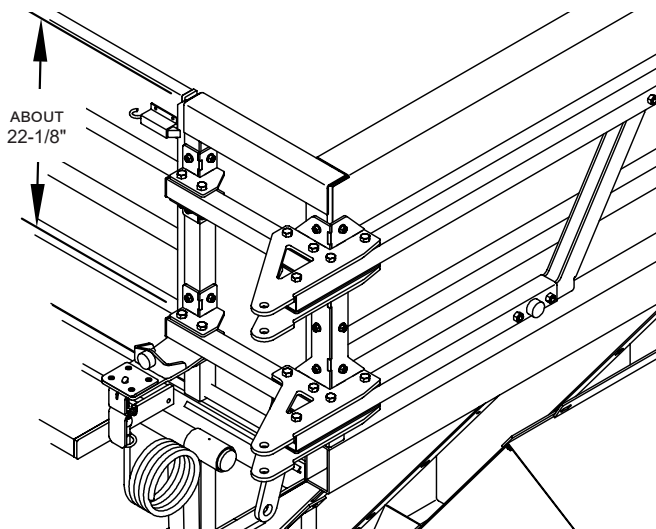

**STEP 2:** Add 1" to distance measured in step 1: (*distance from step 1 + 1" = distance to measure*). Measure down from top rail and mark hole locations 6" on each side of center line on box. Drill 3/8" holes at marked locations through both front skin and 2" square tube reinforcement.

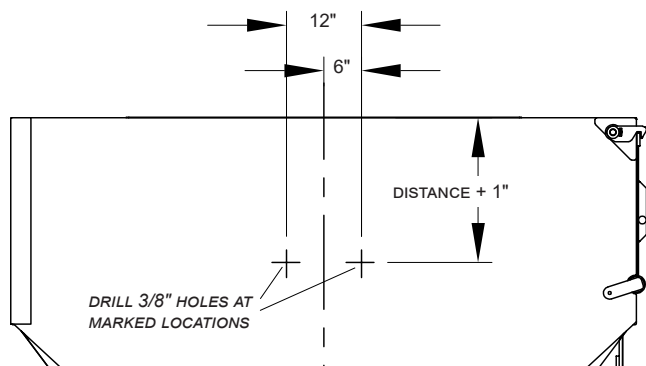

**STEP 3:** Secure front pivot bracket assembly to front of box with two screws 1. Push screws through center set of holes in bracket assembly from inside of box. Secure with flat washers U, lock washers T and nuts O.

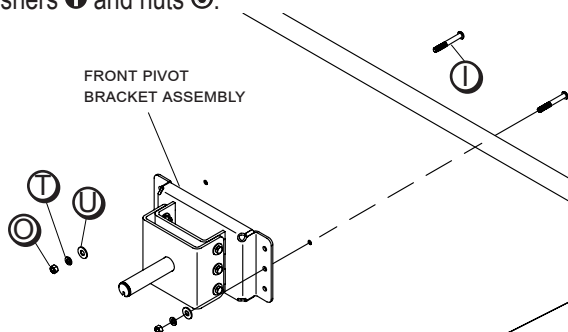

**STEP 4:** Use four remaining holes in bracket as guide to match drill 3/8" holes through front skin and 2" square reinforcement tubing. Secure with remaining screws 1, flat washers U, lock washers T and nuts O.

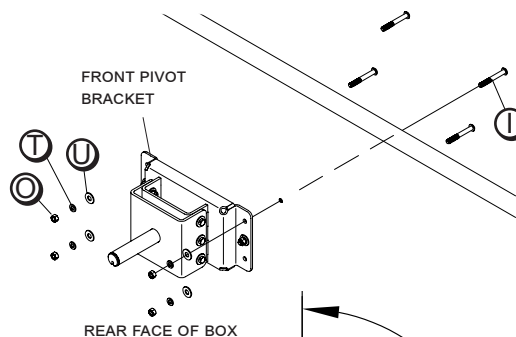

**STEP 5:** Square up shaft to rear face of box with adjustment bolt and nut. Turn nut to adjust bolt length and angle of shaft. Tighten screws on sides of bracket.

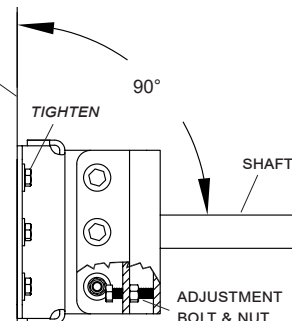

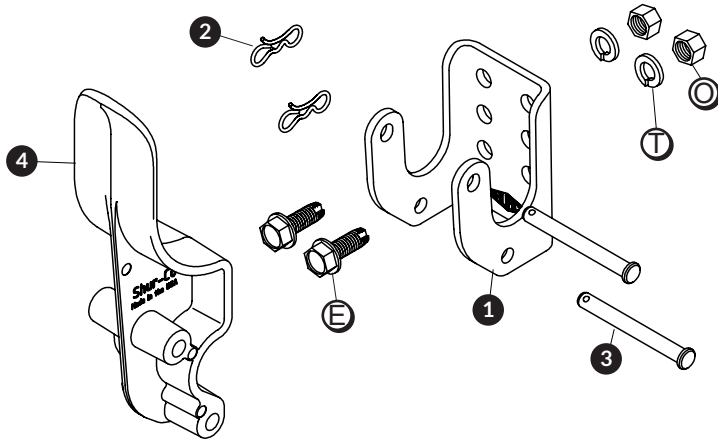

Item	Part #	Description
1.	117/8"	
4.	1705775	Easy-Off Aluminum Tarp Stop Upright
E.	1700400	Self-Tapping Screw - 3/8" x 1"
O.	1700407	Hex Nut - 3/8"
T.	1700434	Lock Washer - 3/8"

**STEP 1:** Locate first tarp stop body 20" from rear edge of box and 1/2" from top edge of rail on passenger side of box.

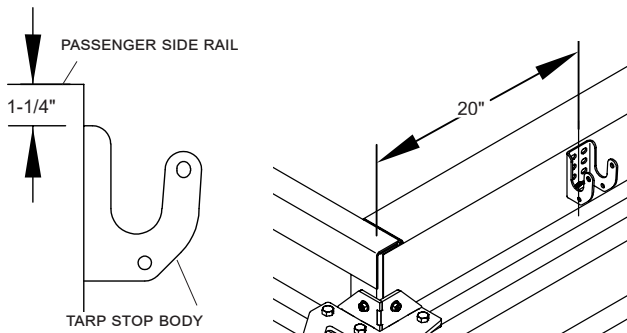

**NOTE:** Install tarp stop body on vertical surface. Fasten through holes that best fit top rail configuration.

**STEP 2:** Locate second tarp stop body 20" from front of box and 1/2" from top edge of rail.

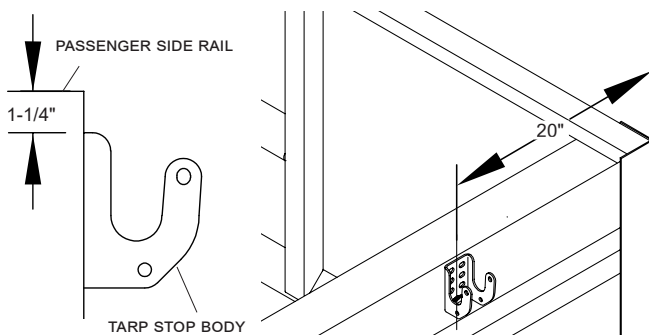

**STEP 3:** Equally space and vertically align remaining tarp stop bodies between front and rear tarp stop bodies.

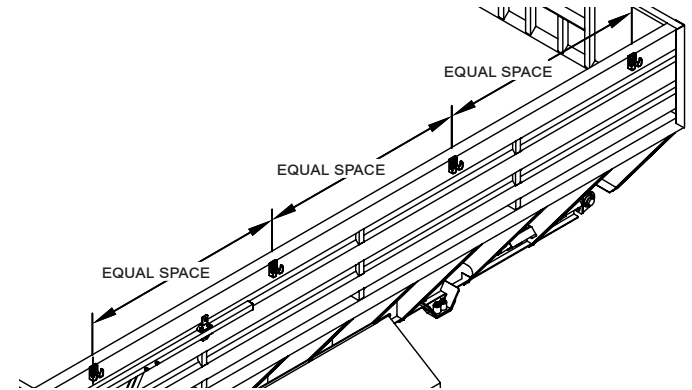

**STEP 4:** Use tarp stop body as guide to mark hole locations. Drill 5/16" holes and fasten to box with screws (E), washers (T) and nuts (O).

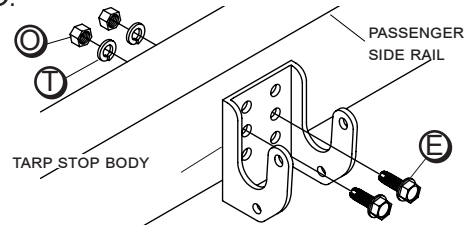

**STEP 5:** Adjust tarp so fixed tube rests squarely in tarp stop bodies. Fasten tarp stop uprights to tarp stop bodies with clevis pins. Secure with bowtie cotter pins.

**NOTE:** Align bowtie cotter pins toward rear of trailer as shown.

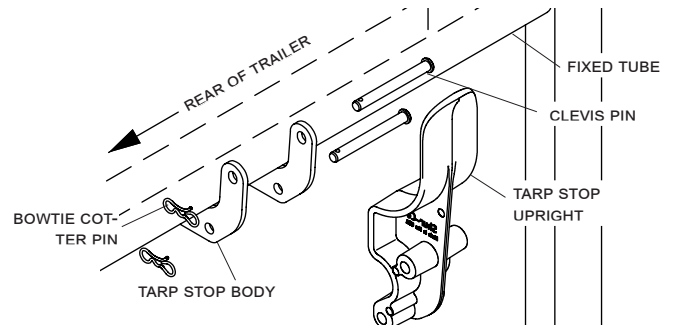

DRIVERSIDE OF BOX

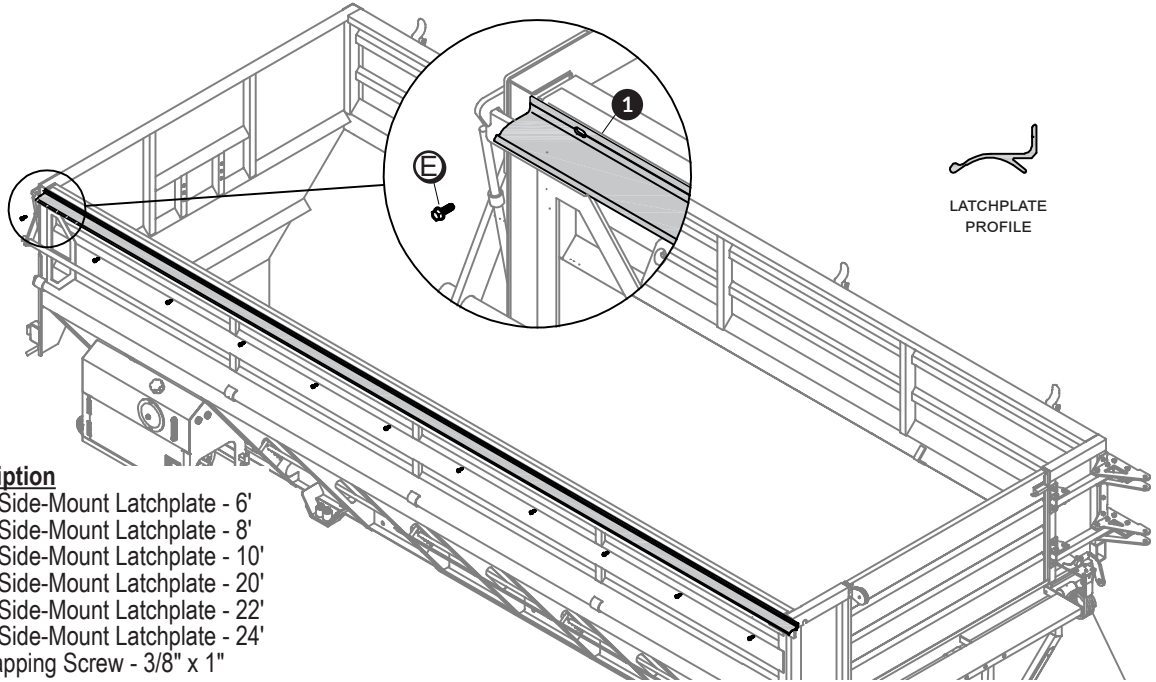

Item	Part #	Description
1.	1120220	Alum. Side-Mount Latchplate - 6'
	1120221	Alum. Side-Mount Latchplate - 8'
	1122085	Alum. Side-Mount Latchplate - 10'
	1125198	Alum. Side-Mount Latchplate - 20'
	1125199	Alum. Side-Mount Latchplate - 22'
	1125200	Alum. Side-Mount Latchplate - 24'
E.	1700400	Self-Tapping Screw - 3/8" x 1"

**STEP 1:** Starting at rear of box, position latchplate approximately 13/16" down from top edge of rail on driver side of box, resting on top side of lock plate. Clamp into position.

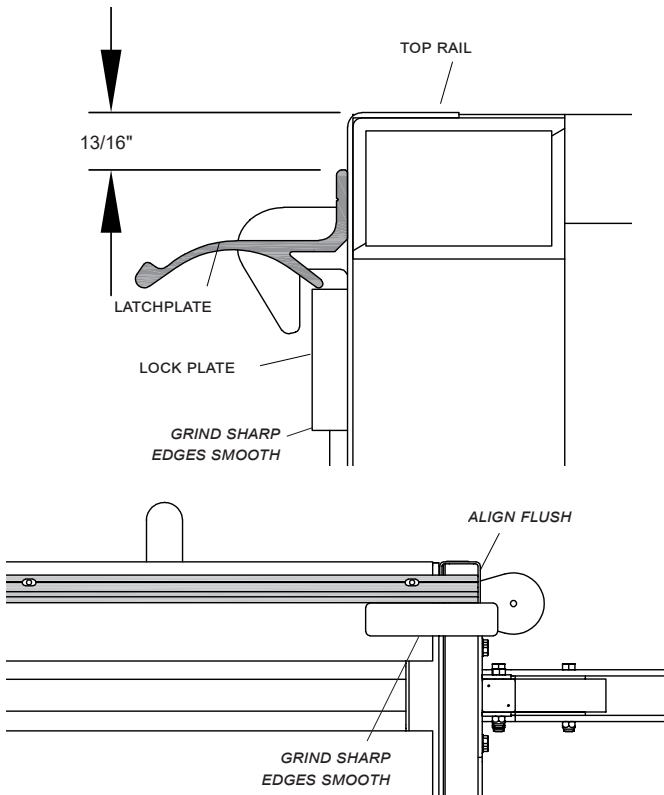

**STEP 2:** Match drill 5/16" pilot holes through pre-punched latchplate and box. Fasten with screws **E**. For stainless steel trailer, drill 11/32" holes.

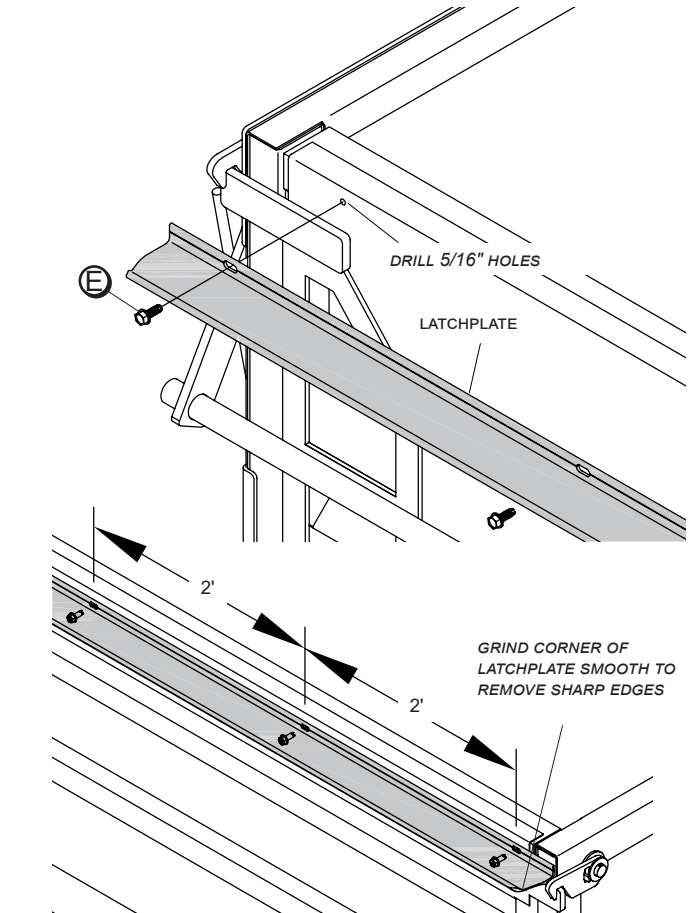

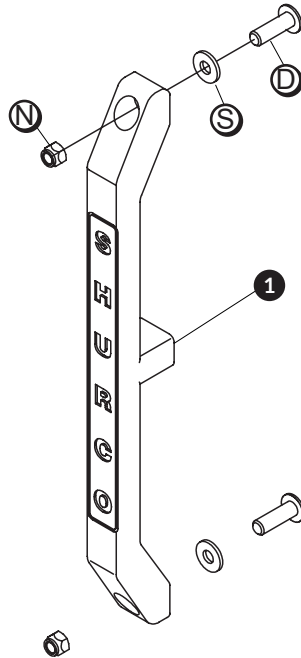

Item	Part #	Description
1.	1112029	Roll Tube Deflector - Gray
	1114658	Roll Tube Deflector - Black
D.	1704441	Flanged Button Hd. Screw - 5/16" x 1"
N	1704297	Nylon Lock Nut - 5/16"
S.	1700428	Flat Washer - 5/16"

**STEP 1:** Mark and drill top row of 5/16" holes 5-3/4" below top rail and 13-1/4" from both ends. Equally space remaining holes on top row for remaining deflectors.

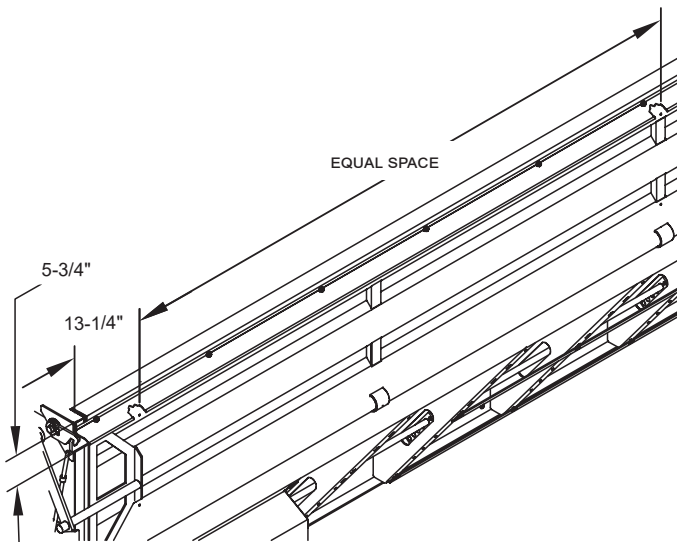

**NOTE:** Deflector must be moved 2" forward or backward if deflector falls on vertical frame tube.

**STEP 2:** Using holes in deflector as guide, mark and drill second row of 5/16" holes. Fasten with screws (D), washers (S) and nuts (N) through both holes.

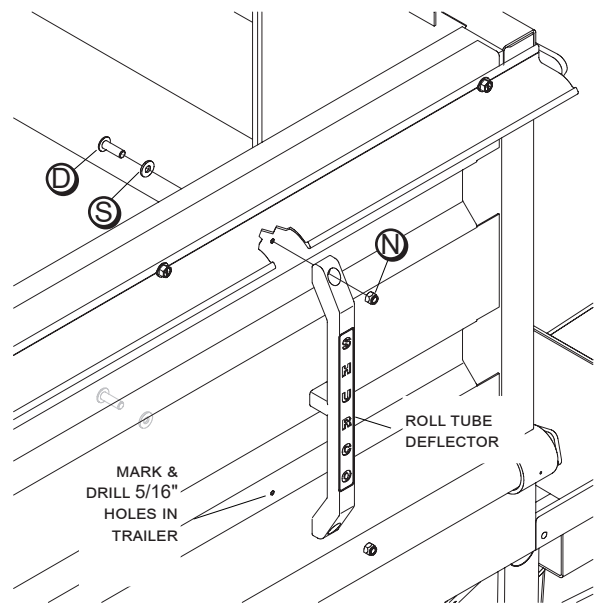

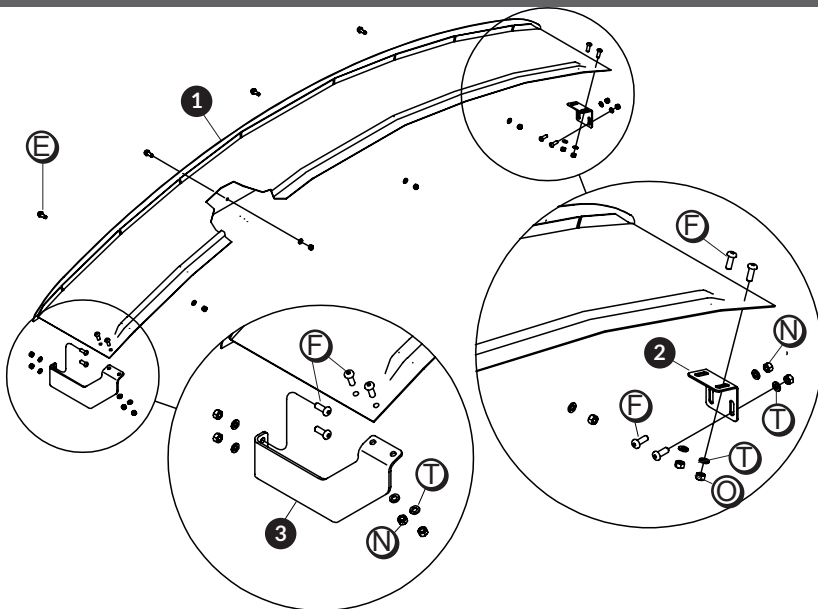

**NOTE:** End caps may need slight modifications to fit box.

**TIP:** Apply bead of caulk or rubber seal where cap meets top rail to improve watertight quality of caps.

Item	Part #	Description
1.	1126294	Galv. Face Mt. Cap - 11" Rise - 100"
	1126503	Galv. Face Mt. Cap - 11" Rise - 94"
2.	1118188	End Cap Brkt. - LR - Side Mt.
3.	1126310	Front Cap Brace
E.	1700400	Self-Tapping Screw - 3/8" x 1"
F.	1705322	Button Hd. Screw - 3/8" x 1"
O.	1700407	Hex Nut - 3/8"
T.	1700434	Lock Washer - 3/8"

**STEP 1:** Center cap on box. Use holes in cap as guide to mark hole locations on top rail. Drill 13/32" holes and fasten cap to rail with screws **E**, washers **T** and nuts **O**.

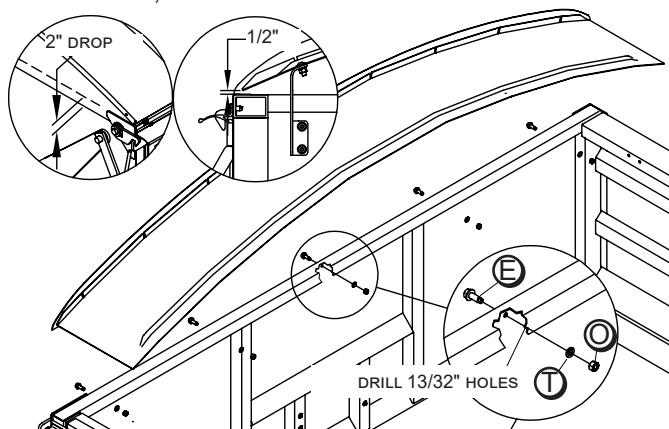

**STEP 2:** Position cap brace against inside of front skin on driver side of box. Move brace upward until brace contacts underside of front cap. Use cap brace as guide to mark hole locations (four places). Drill 3/8" holes and secure with screws **F**, washers **T** and nuts **O**.

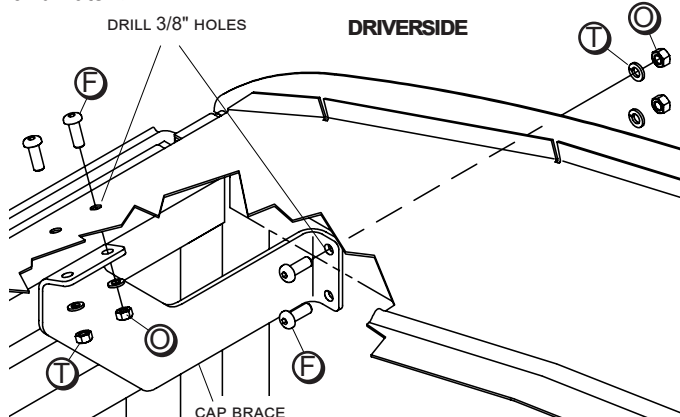

**STEP 3:** Center end cap brackets under truss tube and use as guide to mark hole locations on box and end caps.

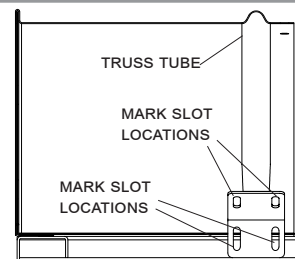

**STEP 2:** Drill 13/32" holes at marked locations on box. Fasten bracket to box with screws **F**, washers **T** and nuts **O**. Drill 11/32" holes and fasten bracket to end cap with screws **F**, washers **T** and nuts **O**.

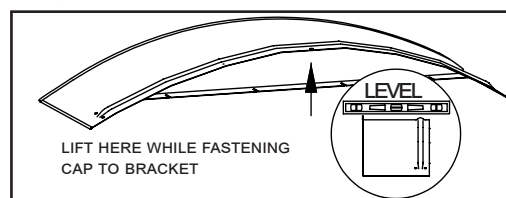
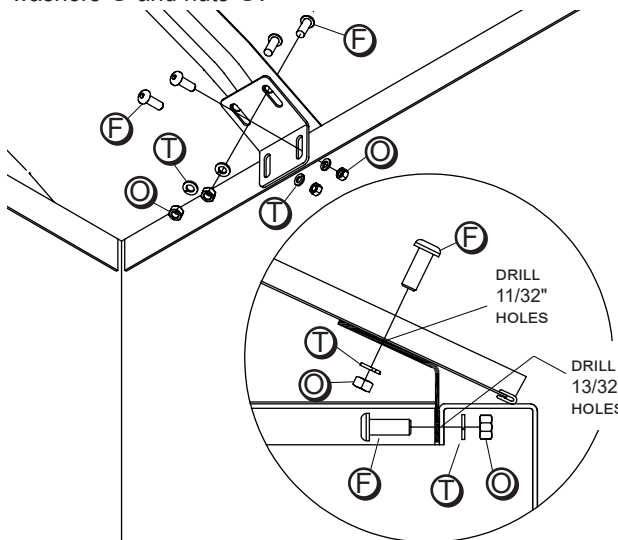

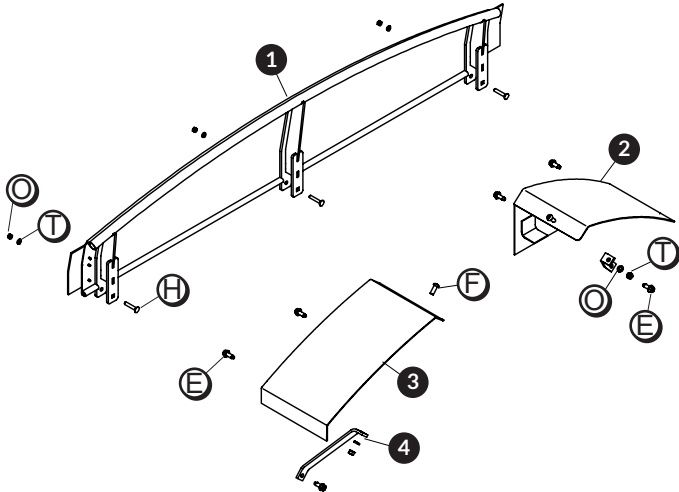

Item	Part #	Description
1.	1126662	Rear Bow - Potato Box
2.	1126297	Back Cap - 1/2 Cap - Al - 11" Rise - 100" - 10" ND - LH
	1126506	Back Cap - 1/2 Cap - Al - 11" Rise - 94" - 10" ND - LH
3.	1126300	Back Cap - 1/2 Cap - Al - 11" Rise - 100" - 10" ND - RH
	1125509	Back Cap - 1/2 Cap - Al - 11" Rise - 94" - 10" ND - RH
4.	1126311	Rear Cap Brace
E.	1700400	Self-Tapping Screw - 3/8" x 1"
F.	1705322	Button Hd. Screw - 3/8"
H.	1704516	Carriage Bolt - 3/8" x 2-1/2"
O.	1700407	Hex Nut - 3/8"
T.	1700434	Lock Washer - 3/8"

**STEP 1:** Place passenger side back cap on back of box as shown. Drill two 5/16" holes in face panel and top rail, then secure cap to box with screws **E**.

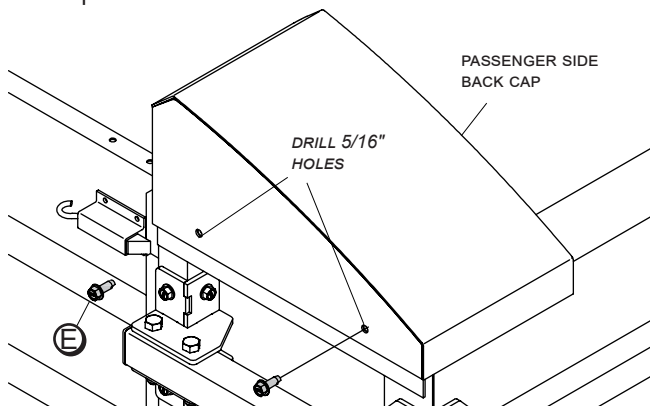

**STEP 2:** Place back cap brace against inside of box wall and flange on cap. Mark and drill 5/16" hole in wall and 3/8" hole in cap. Secure to wall with screw **E**. Secure to cap with screw **F**, washer **T** and nut **O**.

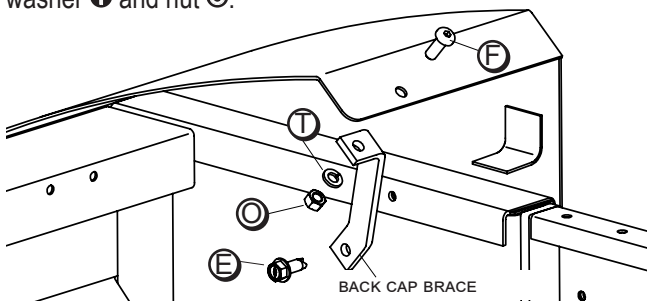

**STEP 3:** Place driver side back cap on back of box as shown. Drill two 5/16" holes in face panel and top rail, then secure cap to box with two screws **E**.

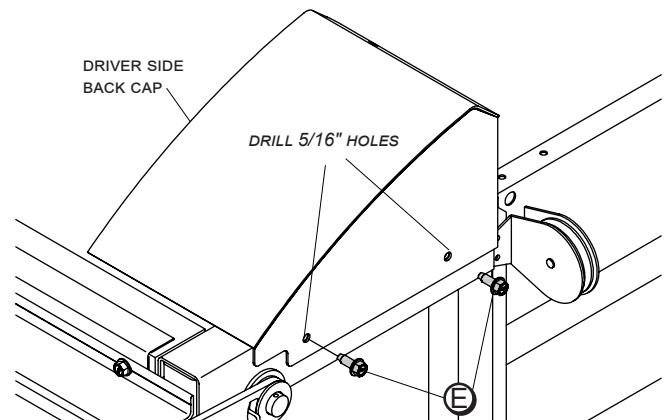

**STEP 4:** Place back cap brace against inside of box wall and flange on cap. Mark and drill 5/16" hole in wall and 3/8" hole in cap. Secure to wall with screw **E**. Secure to cap with screw **F**, washer **T** and nut **O**.

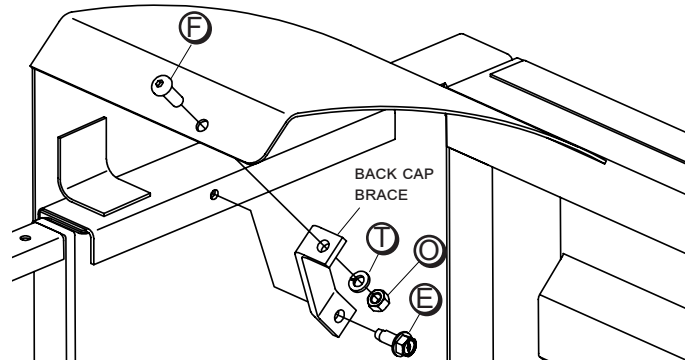

**STEP 5:** Place rear bow on top of gate. Mark mounting hole locations. Drill 3/8" holes and secure with screws **H** washers **T** and nuts **O**.

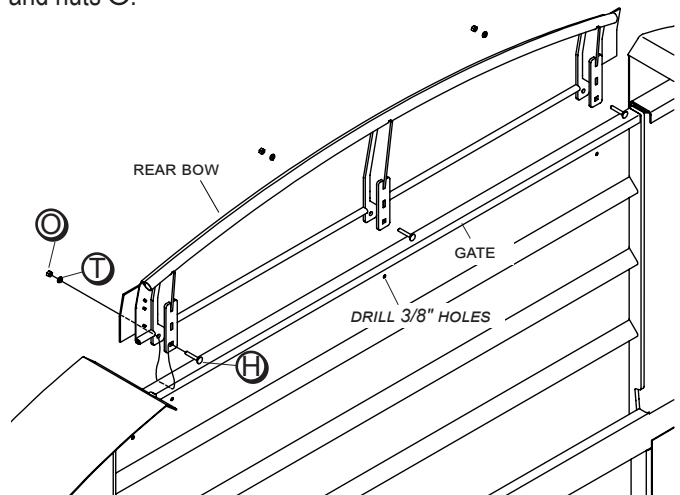

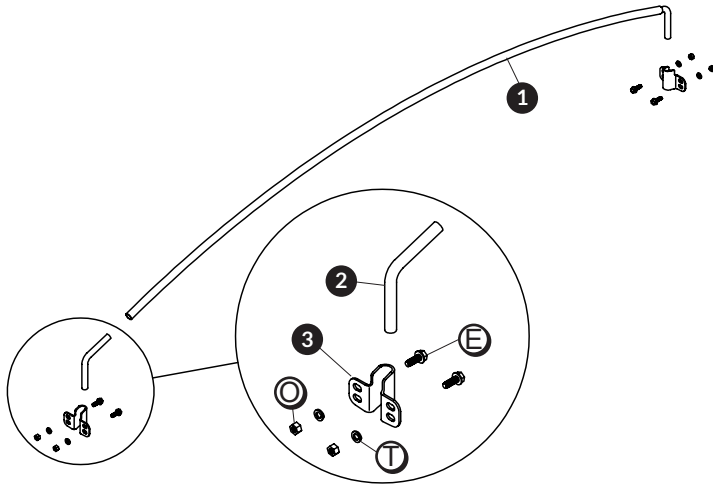

Item	Part #	Description
1.	1117905	Std. High-Rise Bow - 89" to 95"
	1100762	Std. High-Rise Bow - 96" to 102"
	1116120	Std. Low-Rise Bow - 85" to 92"
	1100760	Std. Low-Rise Bow - 93" to 102"
2.	1106925	Std. High-Rise Bow Shank
	1100695	Std. Low-Rise Bow Shank
3.	1120836	Single Bow Bracket
E.	1700400	Self-Tapping Screw - 3/8" x 1"
T.	1700434	Lock Washer - 3/8"
O.	1700407	Hex Nut - 3/8"

**STEP 1:** Mark bow bracket locations on top rails as shown.

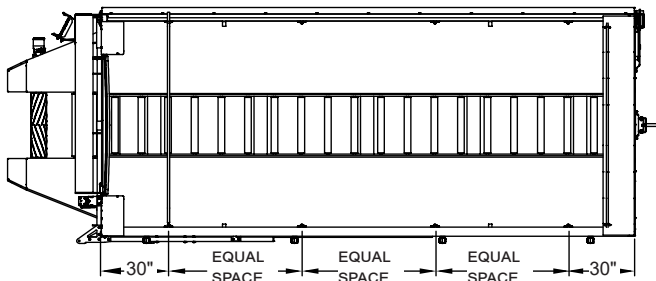

**STEP 2:** Align center of brackets with mark. Clamp brackets to rails.

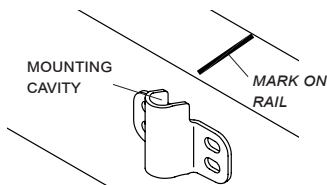

**STEP 3:** Place bow into bow bracket. Place loose bow shank in gate bow bracket on fold-down side.

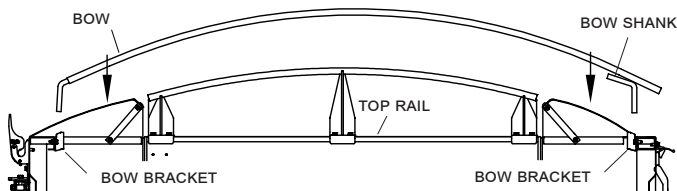

**STEP 4:** Align bow with bow shank. Mark and cut bow at point where bend starts on shank. Grind edges smooth and weld shank to bow.

**NOTE:** Install bows so loose bow shank is on drop-down side wall side of box (driver side).

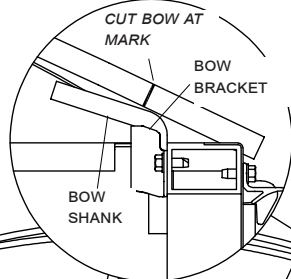

**STEP 5:** Adjust bow brackets vertically to allow 3" to 6" between bend in bow shank and point where tarp will contact bow.

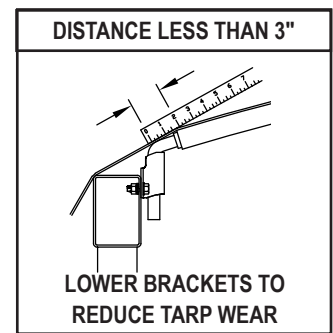
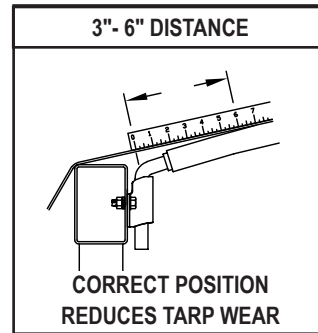

**NOTE:** Orient bow brackets with either long or short side up in order to attain correct bow height.

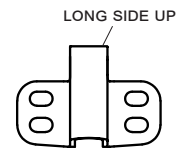
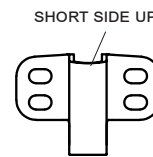

**STEP 6:** Mark and drill 13/32" holes on flange mount top rail. Install bow bracket using screws **E**, lock washers **T** and nuts **O**. For steel tube install, drill 5/16" holes (drill 11/32" holes if using stainless steel). Mount bow bracket with **E**.

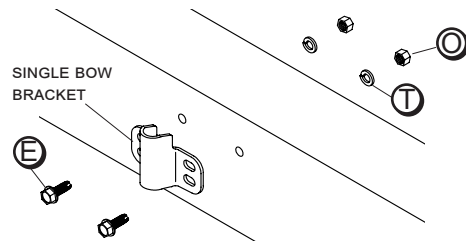



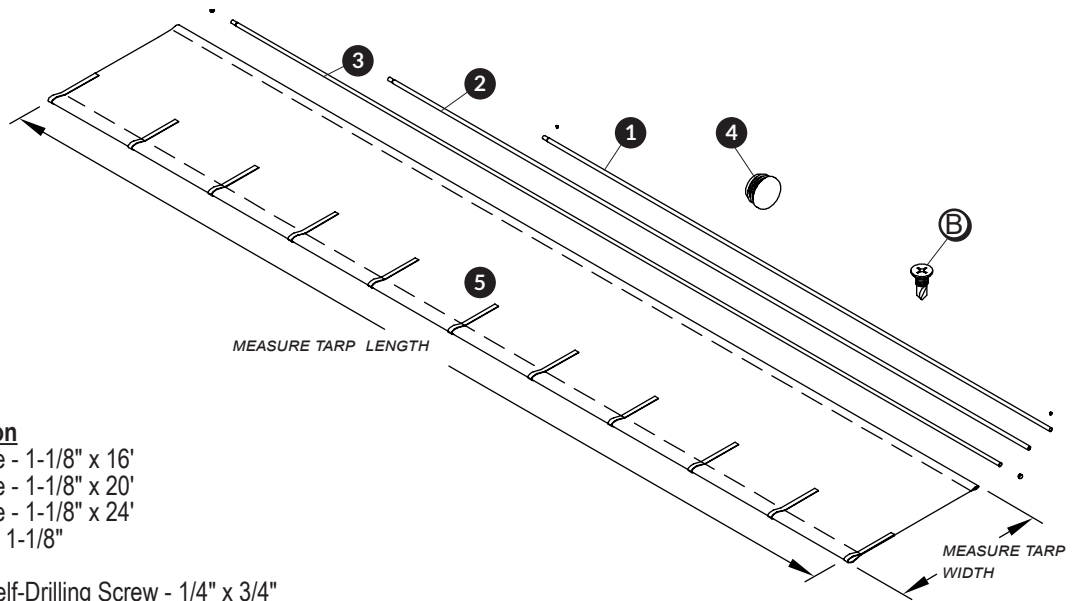

Item	Part #	Description
1.	1700051	Fixed Tube - 1-1/8" x 16'
2.	1700049	Fixed Tube - 1-1/8" x 20'
3.	1701428	Fixed Tube - 1-1/8" x 24'
4.	1700523	End Plug - 1-1/8"
5.		Tarp
B.	1704768	Flat Hd. Self-Drilling Screw - 1/4" x 3/4"

**STEP 1:** Open tarp and stretch tight. Measure and compare tarp measurements with those on spec sheet attached to tarp. Do not proceed with installation if tarp measurements do not match measurements specified on sheet. Call Shur-Co® or your local dealer for alterations or a replacement tarp.

**NOTE:** Tarps cannot be returned for free replacement beyond this point. Tarps damaged beyond this point may be returned for repair or replacement at owner's expense.

**STEP 2:** For boxes over 24', insert swaged end of fixed tube into full end of second tube section. Align tubes, weld and grind smooth.

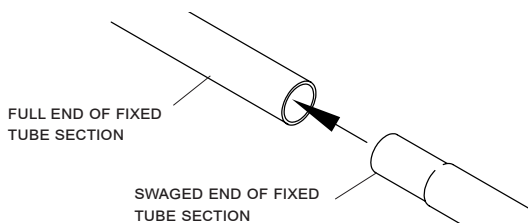

**STEP 3:** Install end plug into full end of tube weldment. Insert tube, end plug first, into 4" pocket on tarp.

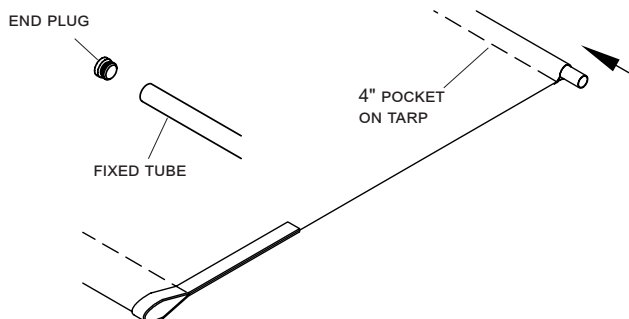

**STEP 4:** Extend fixed tube 2" past tarp edge. Fasten tarp to fixed tube with screw B.

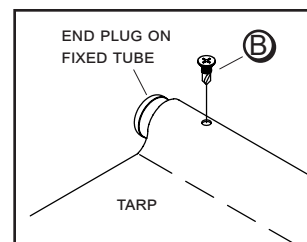

**STEP 5:** Stretch tarp along fixed tube and fasten with second screw B.

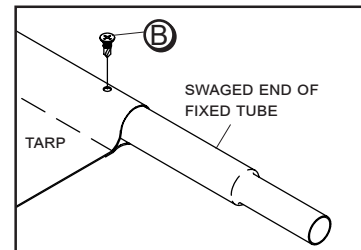

**NOTE:** Tarp must be stretched tight. Pull until all wrinkles are removed, then release and secure with screw.

**STEP 6:** Cut fixed tube 1" past edge of tarp, removing swaged end. Grind smooth.

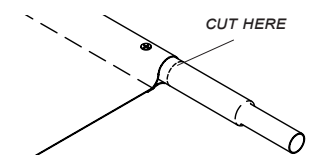

**STEP 7:** Insert end plug.

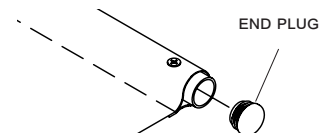

**ItemPart # Description**

- 1. 1120040 Alum. Roll Tube - 3" x 10'
- 1118639 Alum. Roll Tube - 3" x 12'
- 1704439 Alum. Roll Tube - 3" x 16'
- 1704236 Alum. Roll Tube - 3" x 24'
- 2. 1701354 Plastic U-Clamp
- 3. 1704863 Splice - 3" x 36"
- 4. 1121040 Roll Tube Cap - 3" Spline
- 5. 1125923 Front Cartridge Assembly - 3" x 24-1/4"
- 6. 1125921 Rear Cartridge Assembly - 3" x 20"
- 7. 1126668 Tarp Spacer
- A. 1700398 Self-Drilling Screw - 1/4" x 3/4"
- C. 1705198 Self-Drilling Screw - 1/4" x 1"

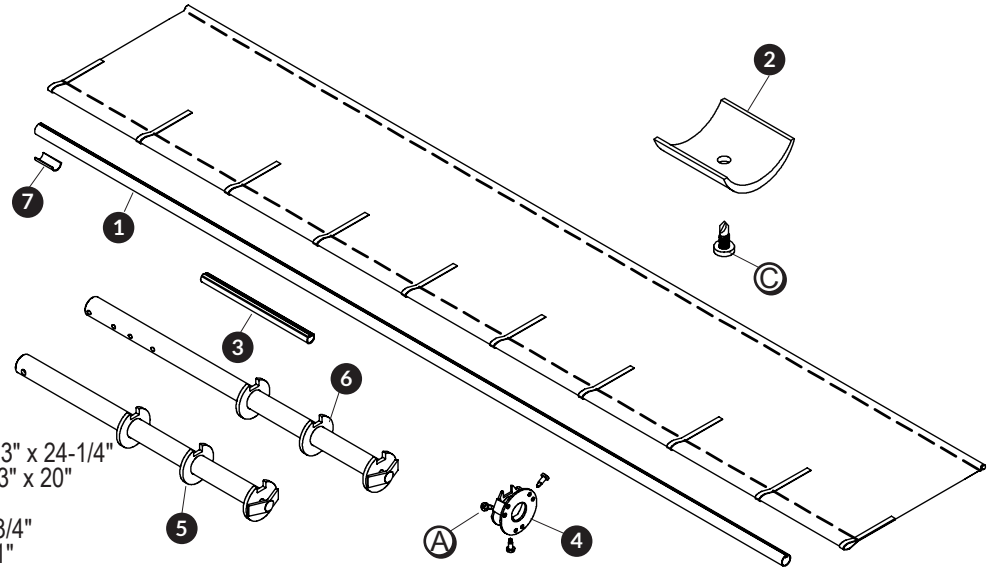

**STEP 1:** Join roll tube sections with splice tube. Insert half of splice tube into each roll tube.

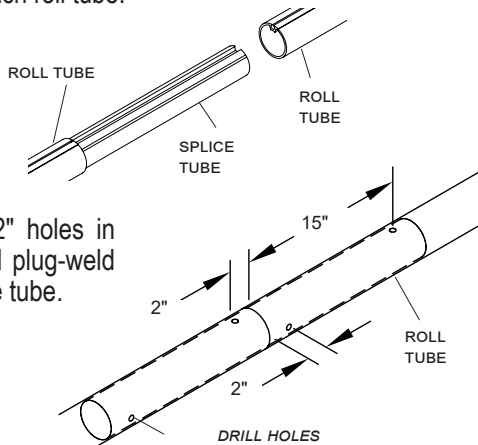

**STEP 2:** Drill 1/2" holes in roll tube only and plug-weld roll tubes to splice tube.

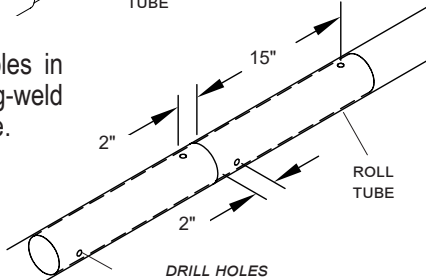

**STEP 3:** Cut roll tube to finished length. Add 5" to box length.

**STEP 4:** Grind weld edges smooth and insert roll tube into 7" tarp pocket.

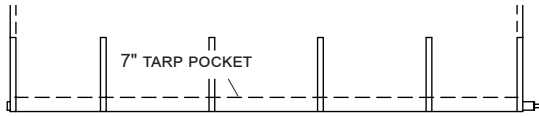

**TIPS:** Inflate 7" tarp pocket with air chuck while inserting roll tube. For ease of handling, wind tarp on roll tube completely before lifting tarp onto box.

**STEP 5:** Insert front cartridge assembly into front of roll tube. Position cartridge to extend 6-1/2" past end of roll tube. Do not secure at this time.

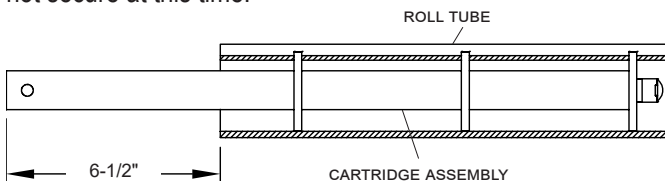

**STEP 6:** Insert cap into roll tube/cartridge assembly. Fasten three screws A through roll tube and flats on sides of cap.

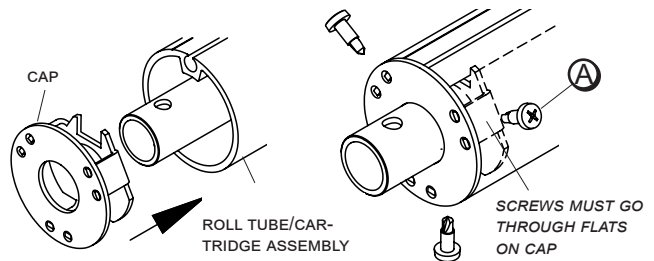

**STEP 7:** Insert tarp spacer between roll tube and tarp as shown, aligning outer edge of spacer with edge of tarp.

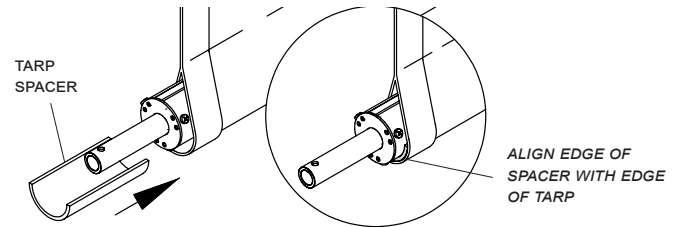

**STEP 8:** Center first U-clamp on front tarp strap, positioning screw C on crease at bottom of tarp pocket. Fasten U-clamp with screw C.

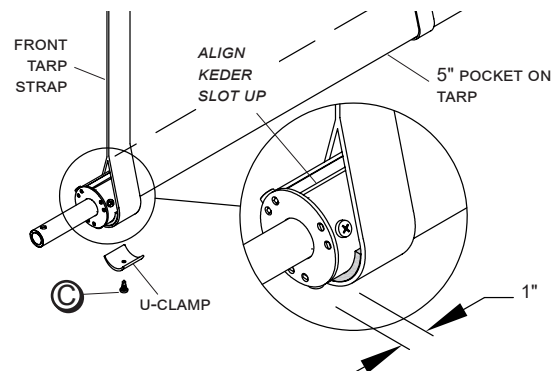

**STEP 9:** Insert rear cartridge assembly into roll tube. Position cartridge to extend 7-1/2" past end of roll tube. **Do not secure at this time.**

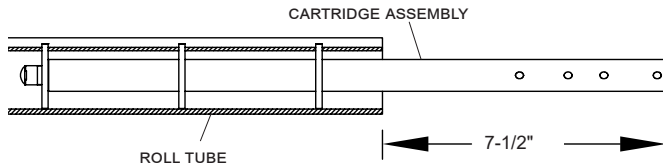

**STEP 10:** Insert cap into rear roll tube/cartridge assembly. Fasten three screws **A** through roll tube and flats on sides of cap.

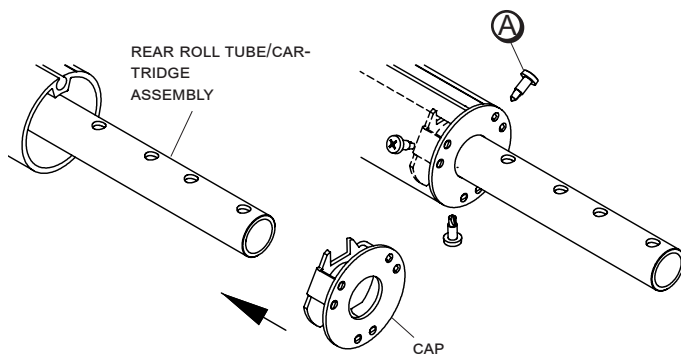

**STEP 11:** If not using bows, lay temporary support tube across top of box from front to back cap, centered on box. Remove any sharp edges that could damage tarp.

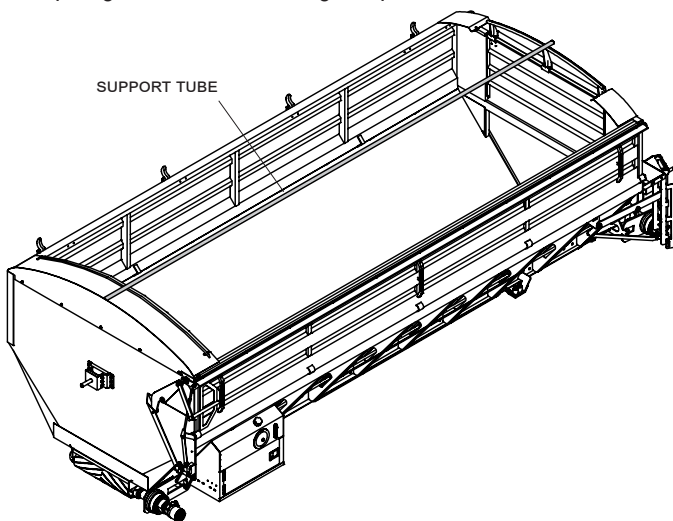

**NOTE:** Required when installing tarp system to keep tarp from falling into box. This will extend life of tarp and aid in correct installation.

**STEP 12:** Stretch tarp along roll tube so both sides of tarp are equal. Install U-clamp on rear tarp strap.

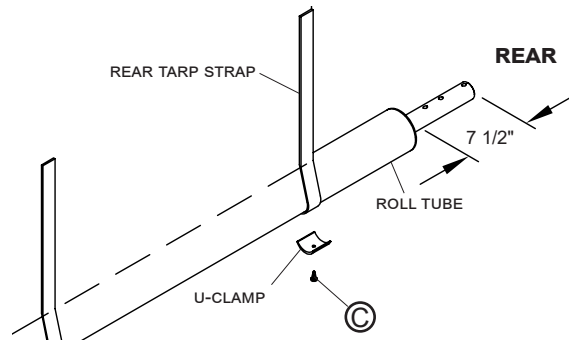

**STEP 13:** Install remaining U-clamps on remaining tarp straps.

**STEP 14:** Wind tarp completely around roll tube. Lift rolled up tarp assembly onto fixed tube side of farm box.

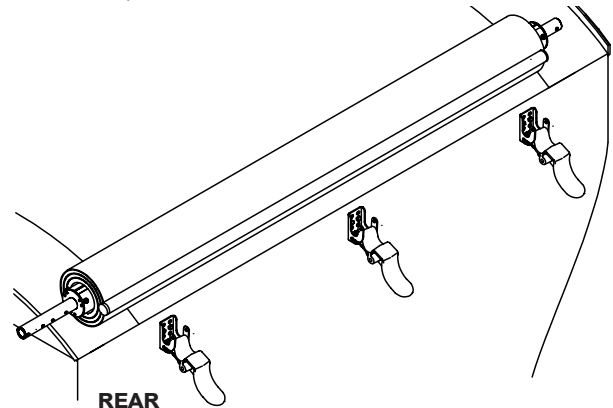

**STEP 15:** Place tarp on box, overlapping end caps. Unroll tarp so fixed tube hangs over edge of box. Square up tarp and fixed tube. Adjust tarp so fixed tube rests squarely in tarp stop bodies and front edge of tarp is 3" in front of face panel cap.

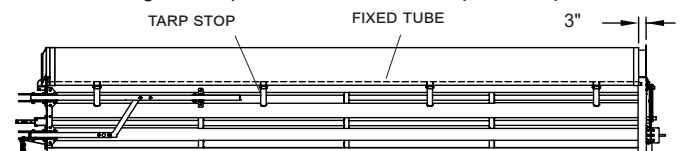

**STEP 16:** Align upper holes in tarp stop uprights with upper holes in tarp stop bodies. Insert clevis pins through aligned holes and secure with bowtie cotter pins. Repeat for each tarp stop.

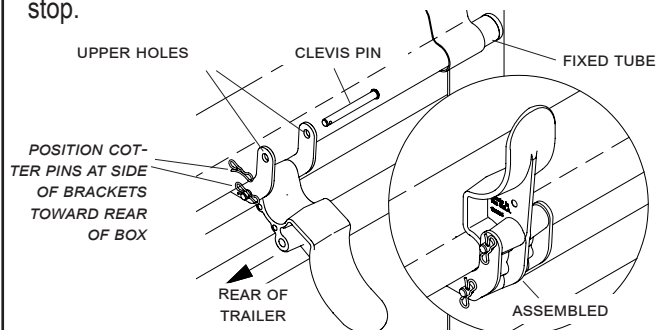

Item	Part #	Description
1.	1126423	Front Arm Assembly
2.	1118318	Spacer Washer - 1.81" OD
3.	1702888	Retaining Ring
4.	1111027	Spiral Torsion Spring
G.	1705680	Cap Screw - 3/8" x 1-3/4"
P.	1701580	Nylon Lock Nut - 3/8"
Y.	1702890	Flat Washer - 1-1/4" x 1-7/8"

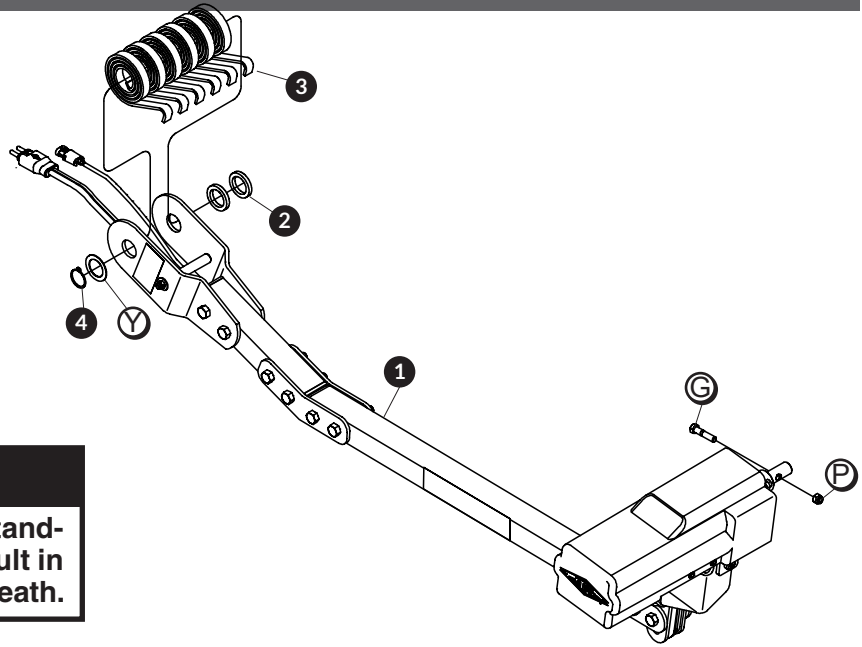

**⚠ WARNING**

Do not stand or climb on flex arm. Standing or climbing on flex arm could result in fall/impact causing serious injury or death.

**STEP 1:** Install two spacer washers onto pivot pin on front pivot mount bracket.

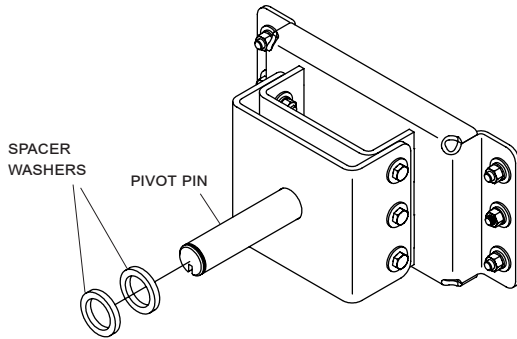

**STEP 2:** Temporarily install front arm assembly onto pivot pin. Secure with flat washer Y and retaining ring.

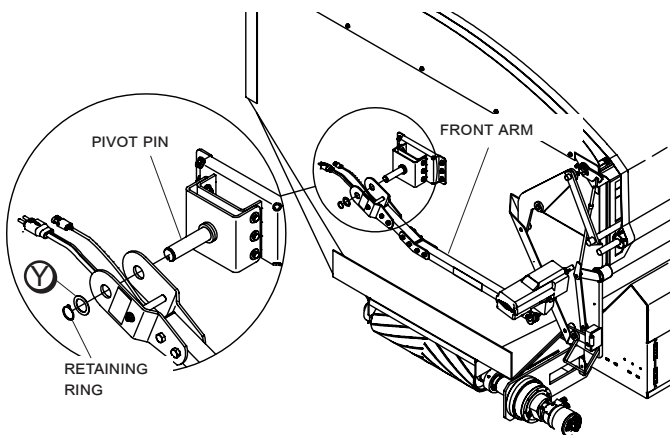

**STEP 3:** Insert motor adaptor shaft into cartridge assembly at front of roll tube. Temporarily secure motor to shaft with screw G and lock nut P.

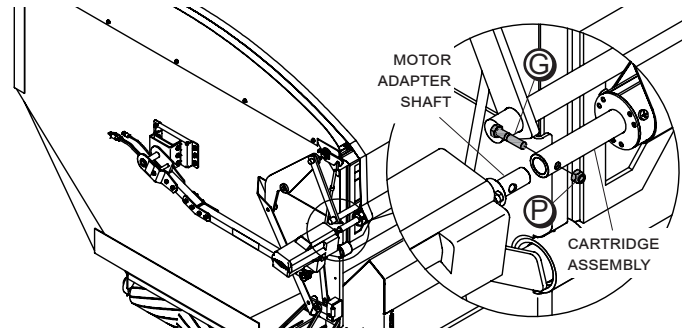

**STEP 4:** While keeping tarp and roll tube stationary, adjust cartridge in and out of roll tube until entire length of front arm is parallel with front of box. Mark cartridge shaft at edge of roll tube cap.

**TOP VIEW**

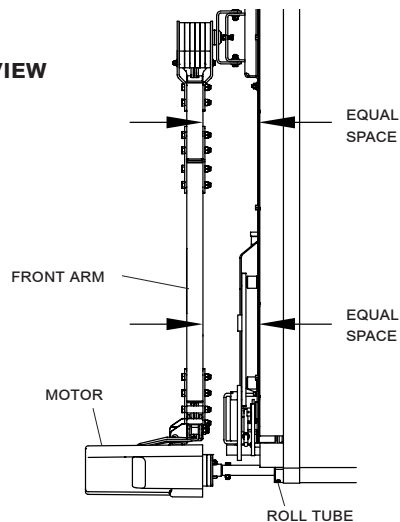

**STEP 5:** Unfasten and remove front arm assembly from cartridge shaft and pivot mount bracket. Tighten nut in cartridge to 20 ft. lbs. with socket wrench and long extension bar.

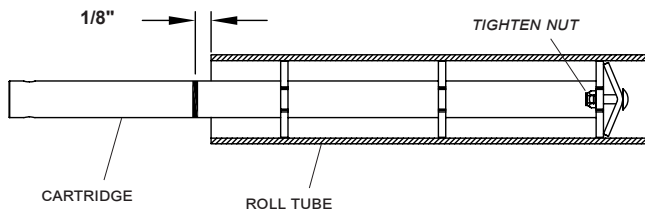
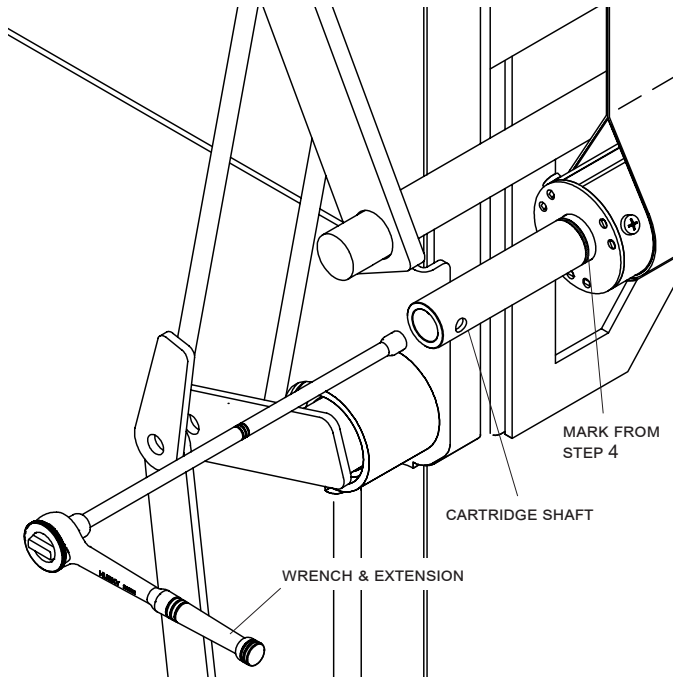

**NOTE:** Use caution because nut can only be tightened once. Pull cartridge shaft away from roll tube 1/8" before tightening because cartridge will move into roll tube as nut is tightened.

**STEP 6:** Add six torsion springs and reinstall front arm.

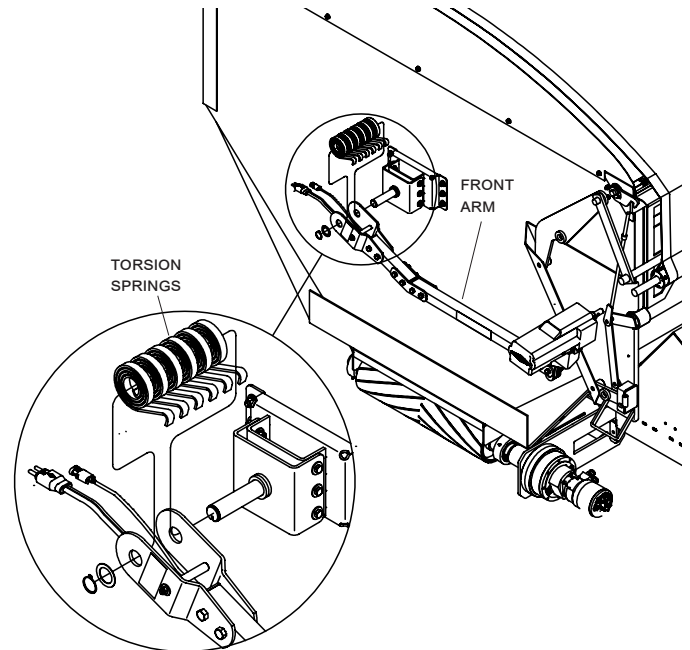

**! WARNING**

Flex arms are under tension while torsion springs are engaged. Use caution while assembling and disassembling arms. Failure to read and follow instructions could result in serious injury or death.

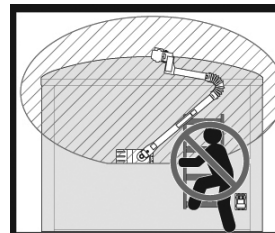

**! WARNING**

Stay clear of the roll tarp and arm(s) sweep area, from front-to-back, during operation. Failure to do so may result in a fall/impact causing serious injury or death. For repair/service of equipment, reference manual for proper safety precautions before proceeding.

Decal P/N 1705523

Item	Part #	Description
1.	1125968	Rear Arm Swivel Assembly
2.	1125924	Upper Rear Arm Assembly
3.	1125935	Spring Support Pin
4.	1126100	Spring Support Plate
5.	1118318	Spacer Washer
6.	1125916	Lower Rear Arm Assembly
7.	1111027	Spiral Torsion Spring
8.	1120712	Lower Arm Hinge Spacer
9.	1702888	Retaining Ring
10.	1126142	Pivot Arm Assembly
11.	1704807	Locking Collar - 1-1/4" ID
12.	1704468	Flange Bushing - 1.281" ID
J.	1702075	Cap Screw - 1/2" x 1-1/2"
K.	1704808	Cap Screw - 1/2" x 3-1/4"
M.	1705694	Shoulder Bolt - 5/8" x 7/8" Thd.
Q.	1702115	Nylon Lock Nut - 1/2"
R.	1705695	Flanged Nylon Lock Nut - 5/8"
V.	1703373	Flat Washer - 1/2"
W.	1704810	Flat Washer - 1/8" x 1-1/2"
Y.	1702890	Flat Washer - 1-1/4" x 1-7/8"

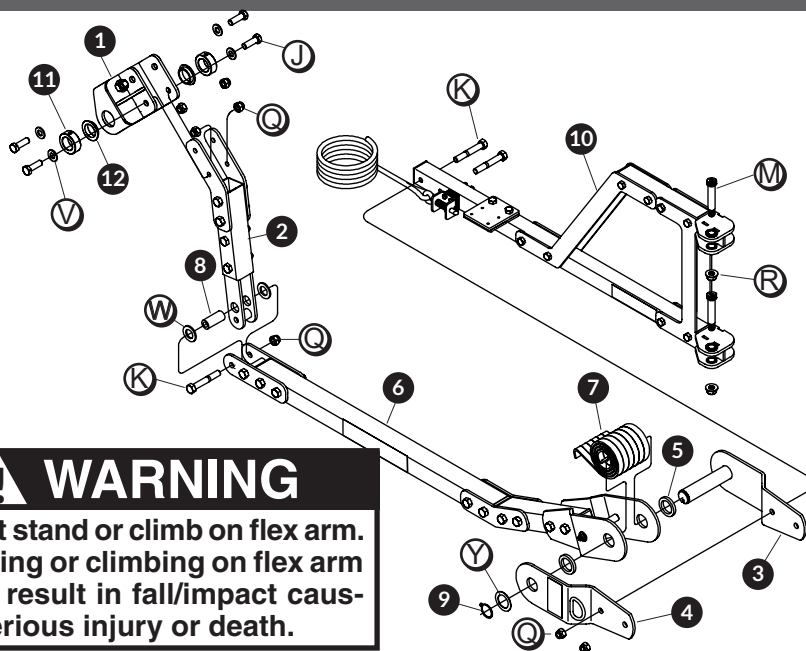

**⚠ WARNING**  
 Do not stand or climb on flex arm. Standing or climbing on flex arm could result in fall/impact causing serious injury or death.

**NOTE:** For fixed rear arm, skip to page 22, "Fixed Rear Arm Assembly & Installation".

**STEP 1: Rear pivot arm.** Assemble rear pivot arm to rear pivot bracket as shown. Secure with 3/4" shoulder bolts **V** and lock nuts **R**.

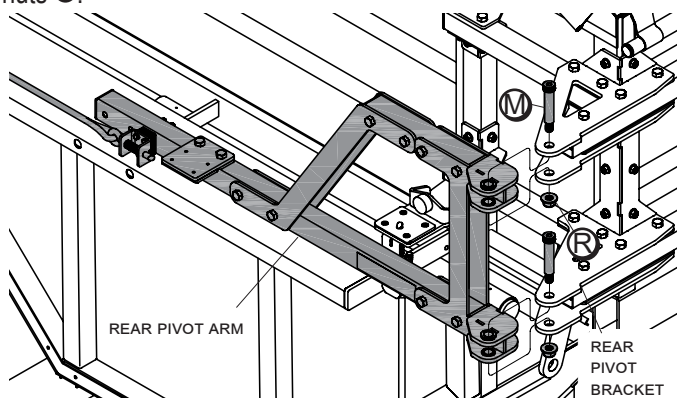

**STEP 2: Assemble rear arm.** Place first spacer washer onto spring support pin. Pass pin through rear lower pivot arm and torsion springs as shown. Install second spacer washer and spring support plate. Secure with flat washer **V** and retaining ring.

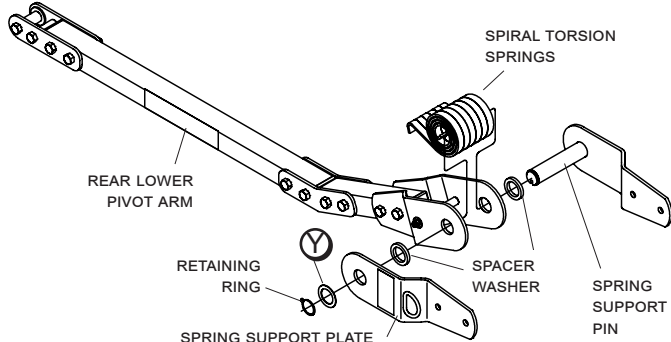

**STEP 3:** Assemble rear arm swivel assembly to upper rear arm with flat washers **V**, bolts **J** and nuts **Q**.

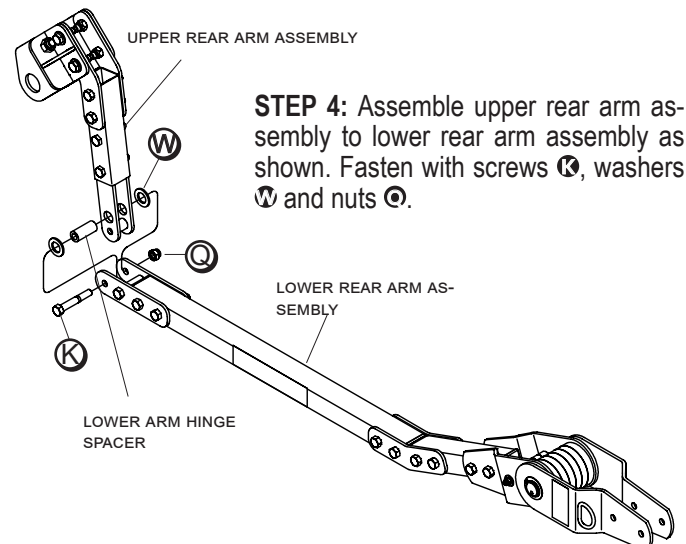
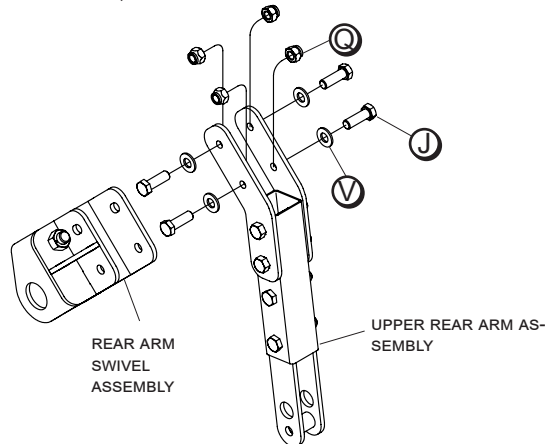

**STEP 4:** Assemble upper rear arm assembly to lower rear arm assembly as shown. Fasten with screws **K**, washers **W** and nuts **Q**.

**STEP 5:** Secure rear arm assembly to pivot arm with screws **K** and lock nuts **O**.

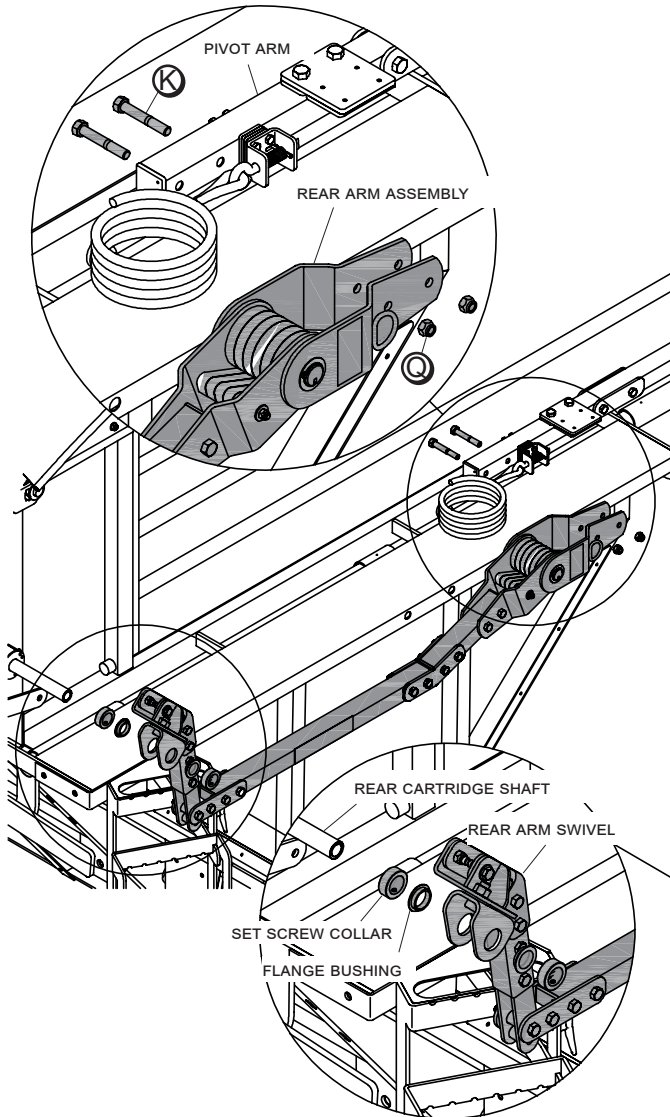

**⚠ WARNING**  
 Flex arms are under tension while torsion springs are engaged. Use caution while assembling and disassembling arms. Failure to read and follow instructions could result in serious injury or death.

**STEP 6:** Assemble swivel end of rear arm assembly to rear cartridge shaft in roll tube with flange bushings and set screw collars.

**STEP 7:** Starting with rear-most locking collar, tighten set screws on locking collars at dimples in cartridge shaft.

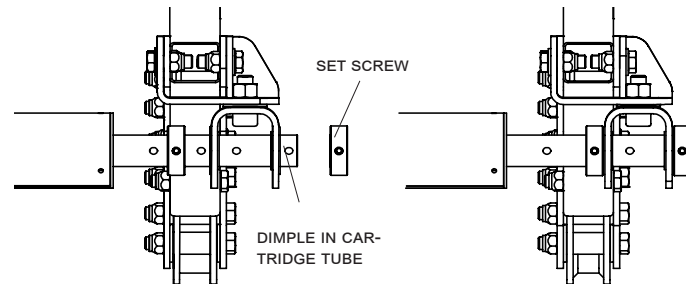

**NOTE:** When tightening set screws, align screws with dimples in cartridge tube.

**STEP 8:** While keeping tarp and roll tube stationary, adjust cartridge in and out of roll tube until entire length of rear arm is parallel with rear of box. Mark cartridge shaft at edge of roll tube cap.

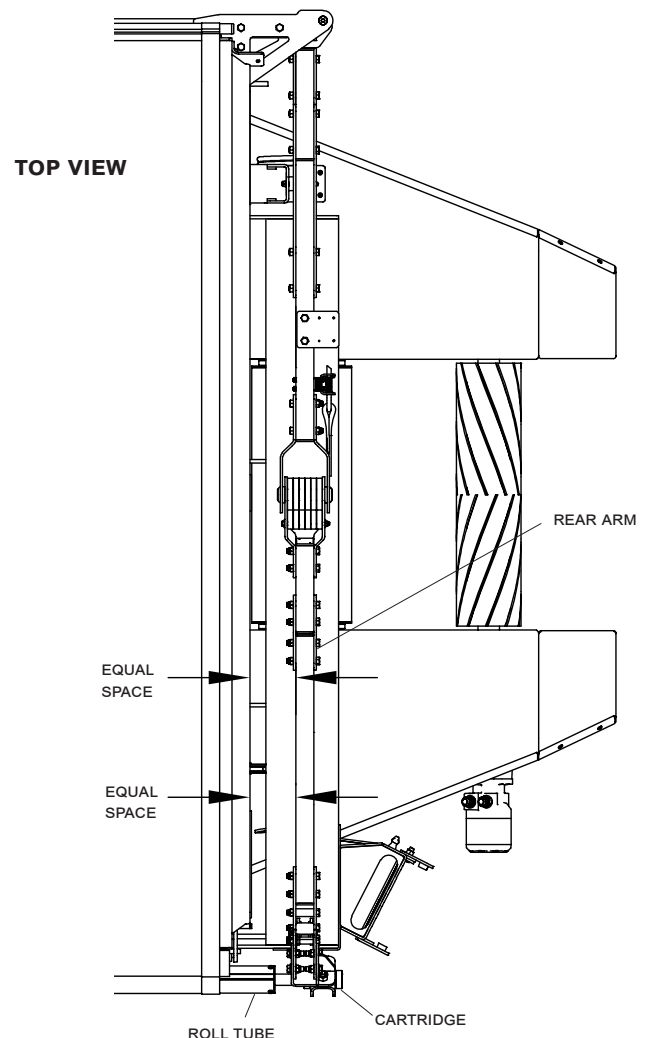

**STEP 9:** Secure rear cartridge shaft to roll tube with 1/2" socket and long extension. Tighten nut in cartridge to 20 ft. lbs. with socket wrench and long extension bar.

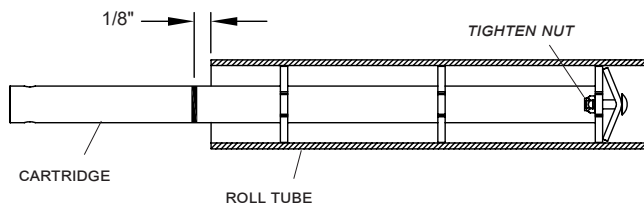
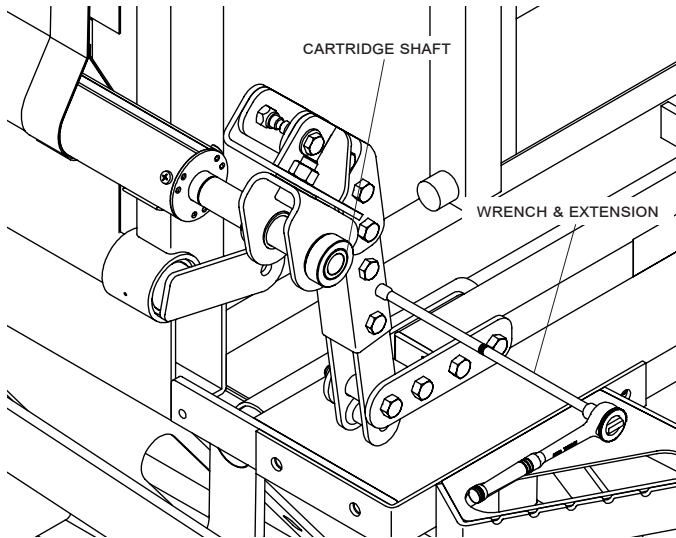

**NOTE:** Use caution because nut can only be tightened once. Pull cartridge shaft away from roll tube 1/8" before tightening because cartridge will move into roll tube as nut is tightened.



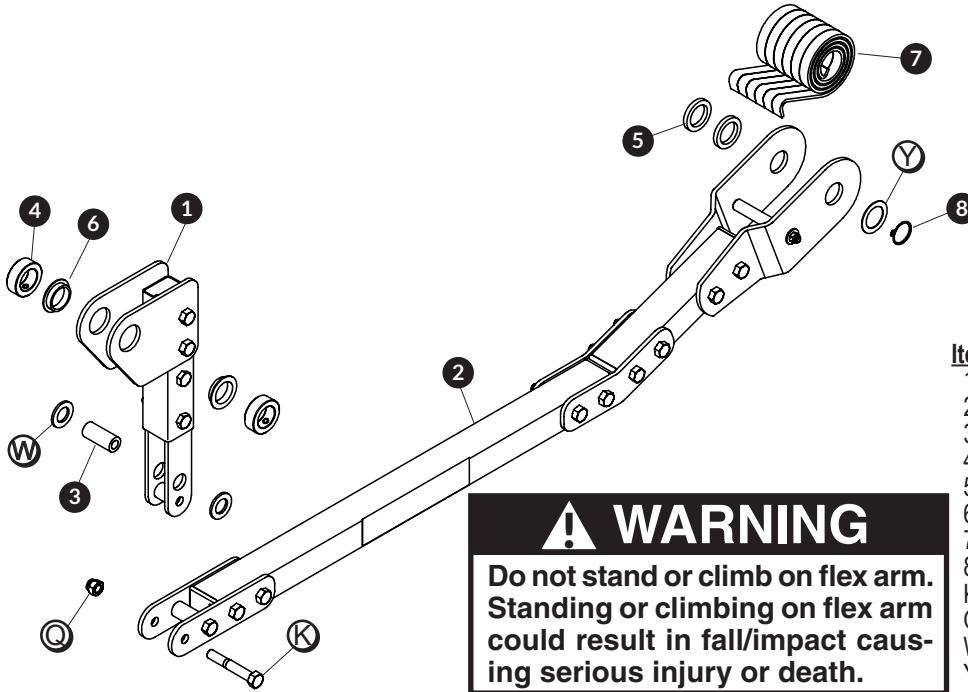

Item	Part #	Description
1.	1126272	Upper Rear Arm Assembly
2.	1125916	Lower Rear Arm Assembly
3.	1120712	Lower Arm Hinge Spacer
4.	1704807	Locking Collar - 1-1/4" ID
5.	1118318	Spacer Washer
6.	1704468	Flange Bushing
7.	1111027	Spiral Torsion Spring
8.	1702888	Retaining Ring
K.	1704808	Cap Screw - 1/2" x 3-1/4"
Q.	1702115	Nylon Lock Nut - 1/2"
W.	1704810	Flat Washer - 7/8" x 1-1/2"
Y.	1702890	Flat Washer - 1-1/4" x 1-7/8"

**⚠ WARNING**  
 Do not stand or climb on flex arm. Standing or climbing on flex arm could result in fall/impact causing serious injury or death.

**STEP 1:** Align hinge spacer and washers W with holes in upper and lower fixed rear arms as shown. Fasten upper arm to lower arm with screws K, lock nuts Q.

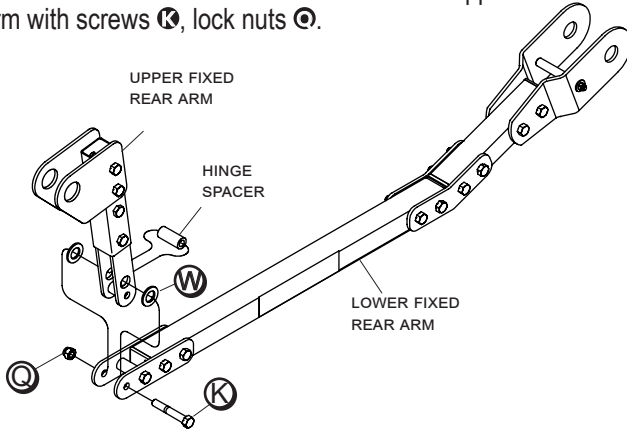

**STEP 2:** Install two spacer washers onto pivot pin on fixed rear pivot mount bracket.

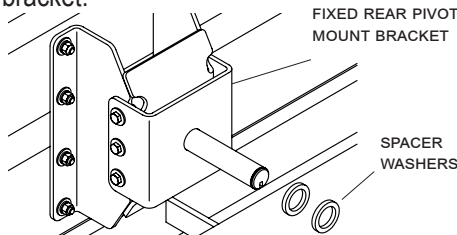

**STEP 3:** Install fixed rear arm with six spiral torsion springs onto fixed rear pivot bracket. Secure with washer Y and retaining ring.

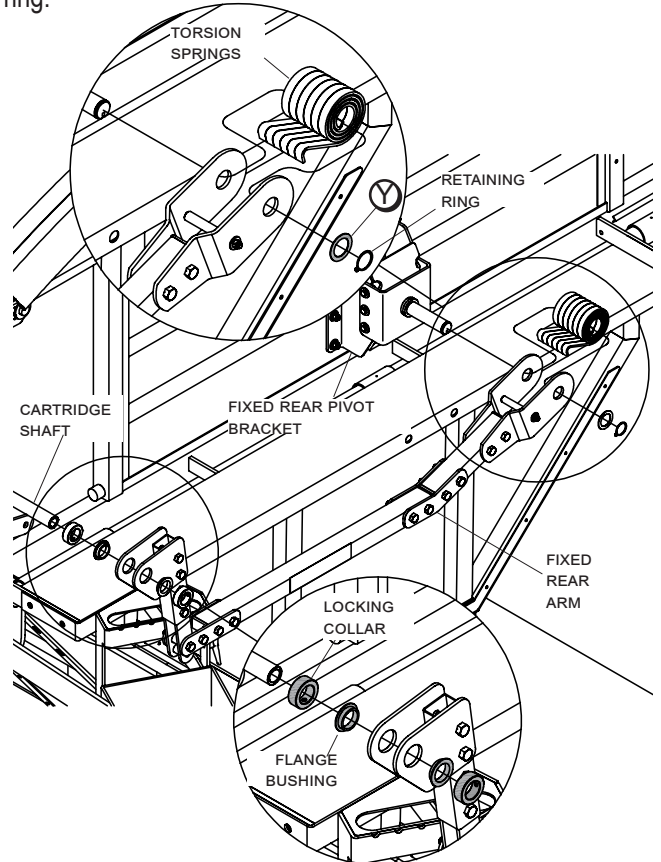

**⚠ WARNING**  
 Flex arms are under tension while torsion springs are engaged. Use caution while assembling and disassembling arms. Failure to read and follow instructions could result in serious injury or death.

**STEP 4:** Assemble fixed rear arm to rear cartridge shaft in roll tube with flange bushings and lock collars.

**STEP 5:** Starting with rear-most locking collar, tighten set screws on locking collars at dimples in cartridge shaft as shown.

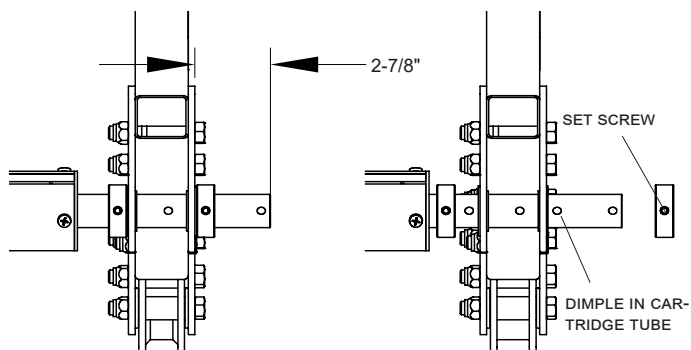

**NOTE:** When tightening set screws, align screws with dimples in cartridge tube.

**STEP 6:** While keeping tarp and roll tube stationary, adjust cartridge in and out of roll tube until entire length of rear arm is parallel with rear of box. Mark cartridge shaft at location shown.

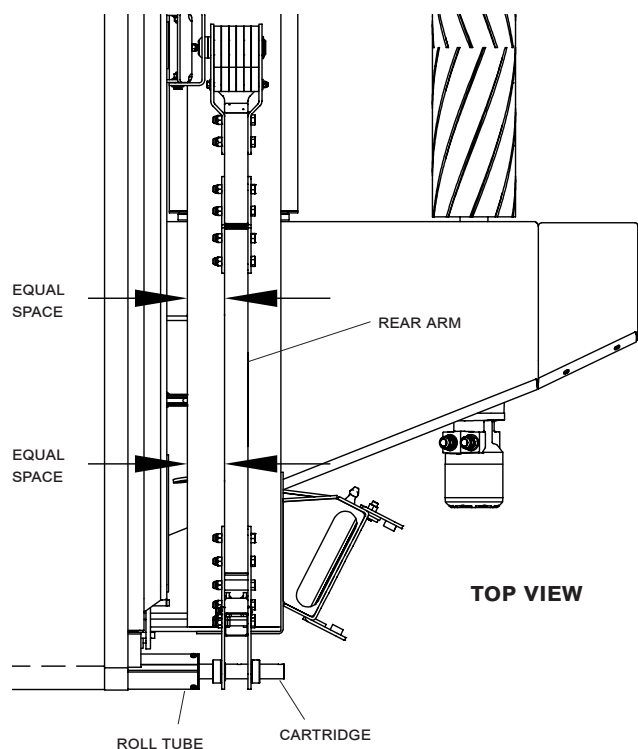

**STEP 7:** Tighten nut in cartridge to 20 ft. lbs. with socket wrench and long extension bar.

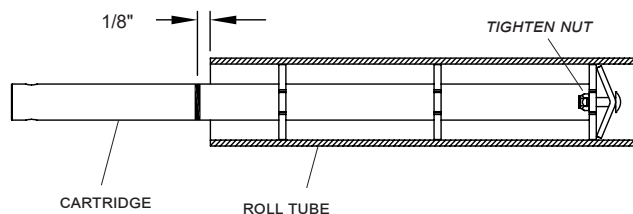
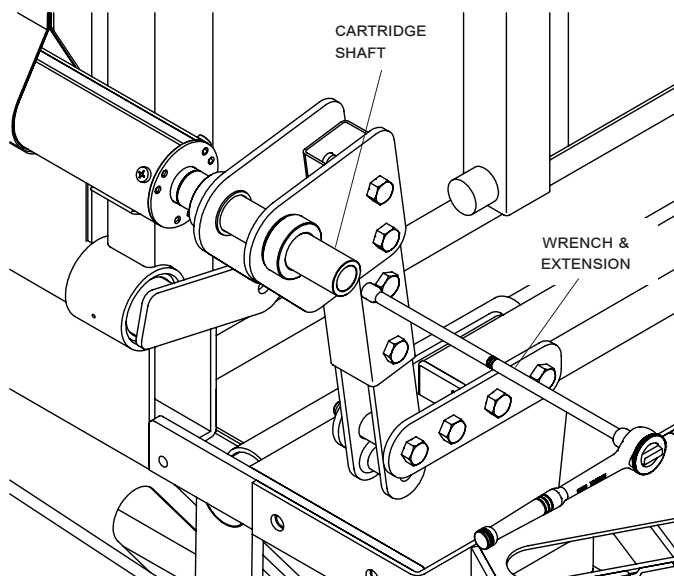

**NOTE:** Use caution because nut can only be tightened once. Pull cartridge shaft away from roll tube 1/8" before tightening because cartridge will move into roll tube as nut is tightened.

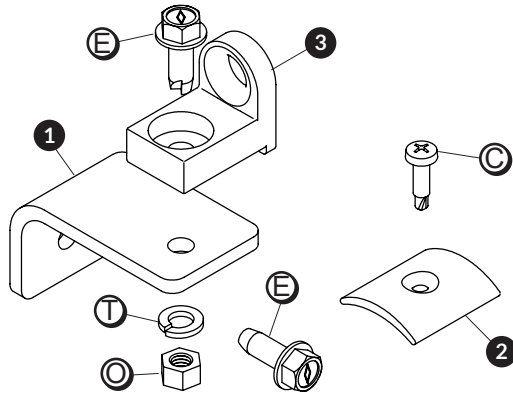

Item	Part #	Description
1.	1126369	Bungee Eye Mount
2.	1701354	Plastic U-Clamp
3.	1703445	Eye Bracket
C.	1705198	Pan Hd. Self-Drilling Screw - 1/4" x 1"
E.	1700400	Self-Tapping Screw - 3/8" x 1"
O.	1700407	Hex Nut - 3/8"
T.	1700434	Lock Washer - 3/8"

**STEP 1:** Secure end of stretch cord from rear tarp tail to roll tube with U-clamp and screw **C**.

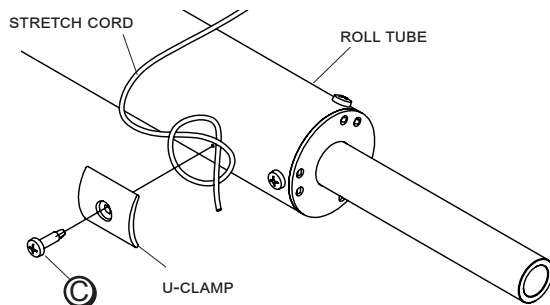

**STEP 2: Swing End.** Remove top rear screw **E** from pivot bracket. Secure stretch cord bracket with screw **E**.

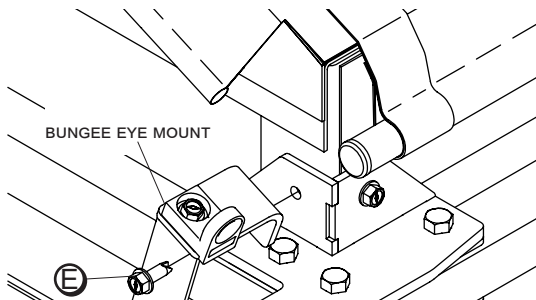

**Fixed End.** Mark location and drill 5/16" (11/32" for stainless steel) in corner tube. Use impact driver to secure bungee eye mount with screw **E**.

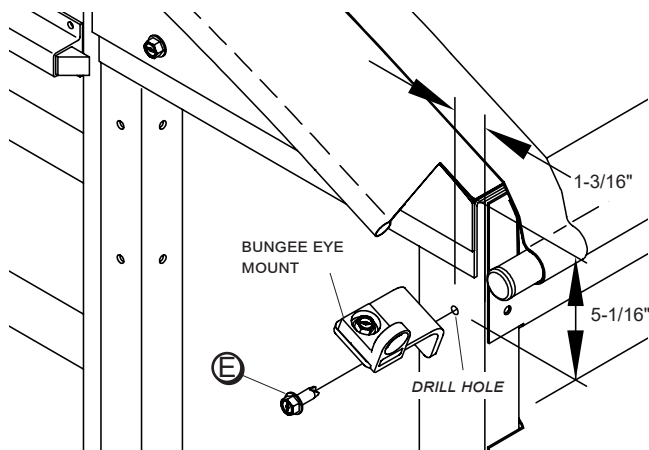

**STEP 3:** Thread stretch cord through hole in bungee eye mount. Tension cord so rear tarp flap is pulled down snugly over rear cap/bow. Tie knot to secure. Do not cut to length at this time. Open and close tarp several times and adjust stretch cord tension as needed.

**SWING END**

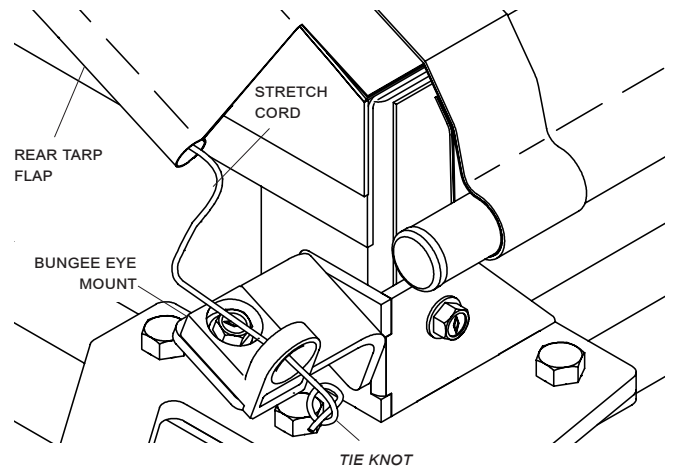

**FIXED END**

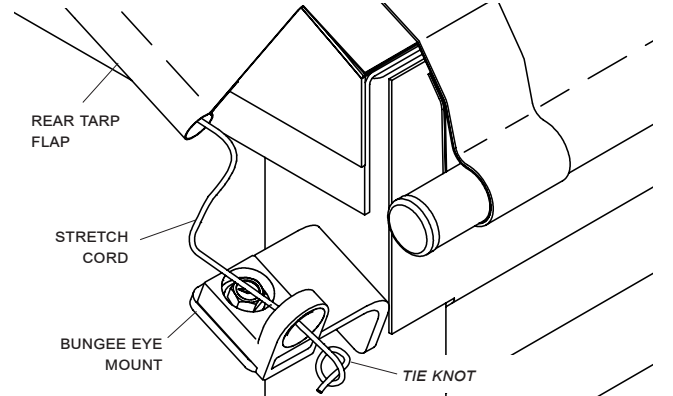

**STEP 3:** Tape end of stretch cord and cut cord to length with hot knife, or use flame to melt end of cord and prevent end from unraveling.

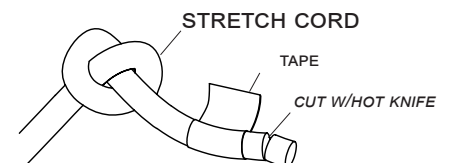

**NOTE:** For rocker switch installation, refer to electric wiring instructions P/N 1116302.

Item	Part #	Description
1.		Shur-Co® Wireless Receiver - SMARTWire™
2.	1704751	Harness Lock Pin - 1/4" x 7/8"
3.	1704338	Self-Tapping Screw - 1/4" x 1"
4.	1702926	Cap Screw - 5/16" x 7/8"
5.	1700428	Flat Washer - 5/16"
6.	1700419	Lock Nut - 5/16"
7.	1702108	Wire Clip - 3/4"
8.	1703231	Cable Tie - 8"
9.	1704994	SMARTwire™ - 6 Ga. x 40' - Socket/Blunt
10.	1120817	SMARTwire™ - 6 Ga. x 6' 3" - Socket
11.	1704706	SMARTwire™ - 6 Ga. x 2' 4" - Plug
12.	1703245	Ring Terminal - 6 Ga. x #10 Stud
13.	1703244	Ring Terminal - 6 Ga. x 3/8" Stud
14.	1704354	40-Amp Modified-Reset Circuit Breaker
15.	1704411	Circuit Breaker Rubber Boot - Red

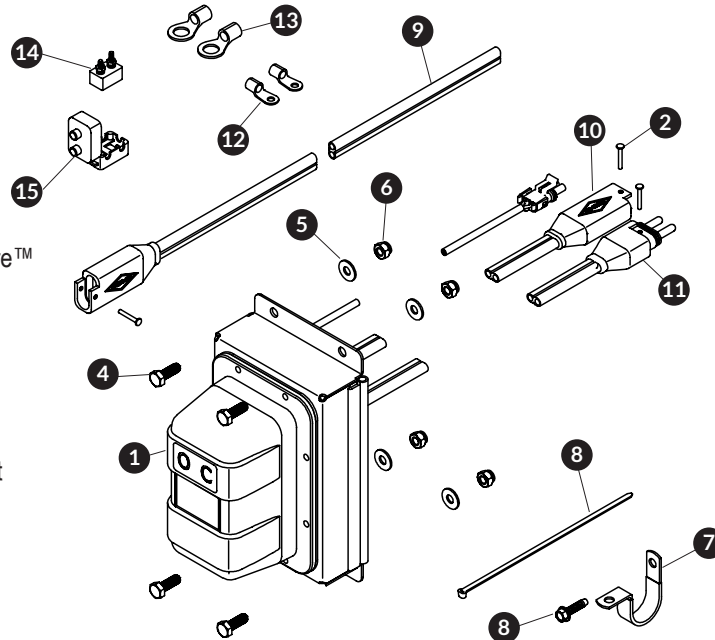

**NOTE:** Cut wires to length and strip only enough wire insulation to install ring terminals. Insert bare wire into ring terminals and crimp securely.

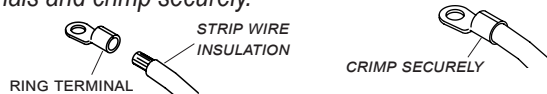

**STEP 1:** Fasten wireless receiver to front of box with screws 4, washers 5 and nuts 6.

**STEP 2:** Plug SMARTwire™ and encoder wires from receiver to arm.

**STEP 3:** Drill 7/32" holes and secure wires to face of box with wire clips and screws 3.

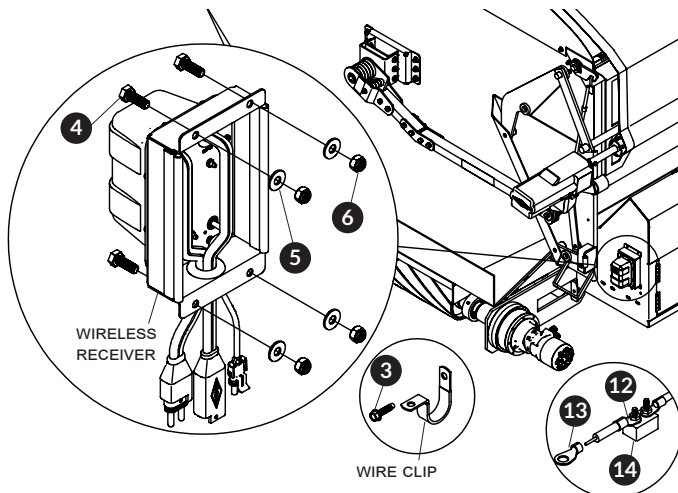

**NOTE:** Locate screws in voids in tubing or behind angle. Make sure screws do not extend into box where cargo could be damaged.

**STEP 4:** Plug SMARTwire™ 9 into receiver. Route to power supply, cut to length and add ring terminals 13.

**STEP 5:** Install circuit breaker 14, ring terminals 12 and circuit breaker boot 15. Mount circuit breaker in line on red wire, as close as possible to power supply.

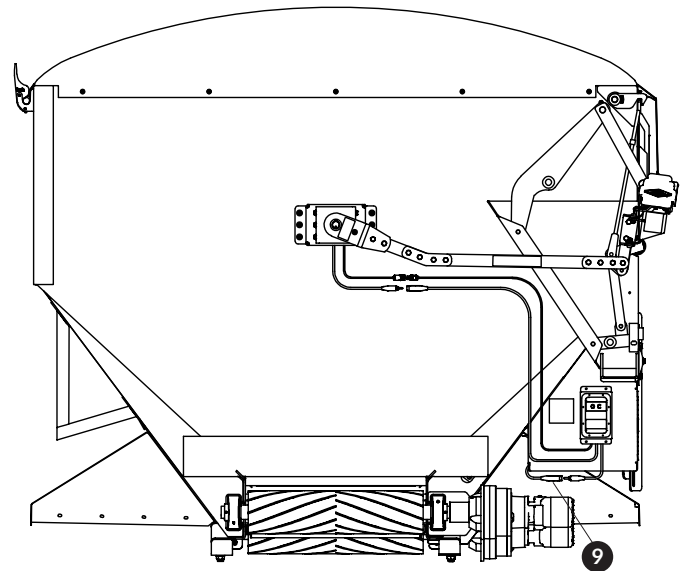

**STEP 6:** Attach to 12-volt power supply.

## ⚠ WARNING

Do not power any Shur-Co® wireless system with battery charger alone, as this will likely cause system damage and void warranty. Instead, use 12-volt truck/automobile battery to power system.

**NOTE:** Coat each connection with dielectric grease (P/N 1704378) to prevent corrosion.

**⚠ CAUTION**

Check all hardware for complete assembly before operating. Inspect system at this time and adjust as required.

**NOTE:** Receiver may be pressure washed, but keep nozzle at least 3' from system while spraying.

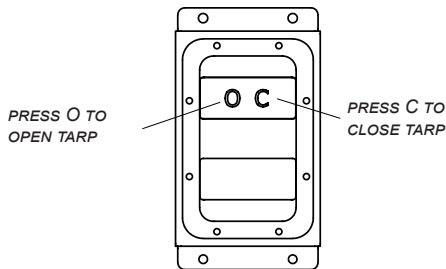

**⚠ WARNING**

Stay clear of roll tarp and arm(s) area of travel during operation. Failure to do so could result in serious injury or death.

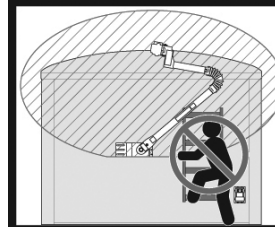

**⚠ WARNING**

Stay clear of the roll tarp and arm(s) sweep area, from front-to-back, during operation. Failure to do so may result in a fall/impact causing serious injury or death. For repair/service of equipment, reference manual for proper safety precautions before proceeding.

Decal P/N 1705523

**NOTE:** Only adjust pivot brackets if tarp does not track correctly when brackets are aligned 90° to face of box.

**STEP 1:** Loosen fasteners on sides of pivot brackets.

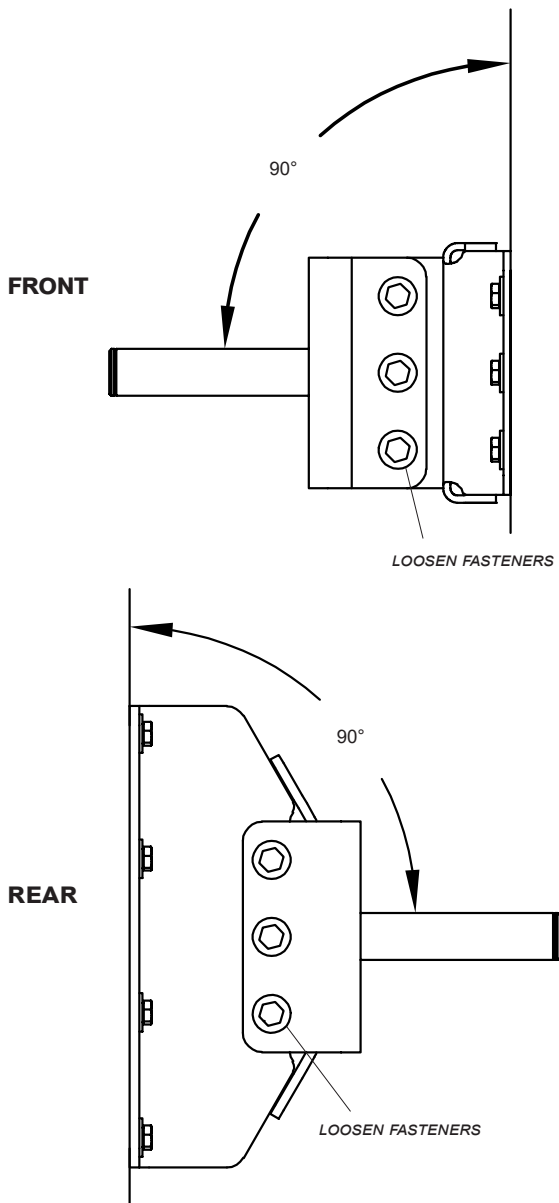

**NOTE:** Do not remove fasteners.

**STEP 2:** Turn nut on adjustment bolt to adjust angle of pivot shaft up or down. Tighten nut.

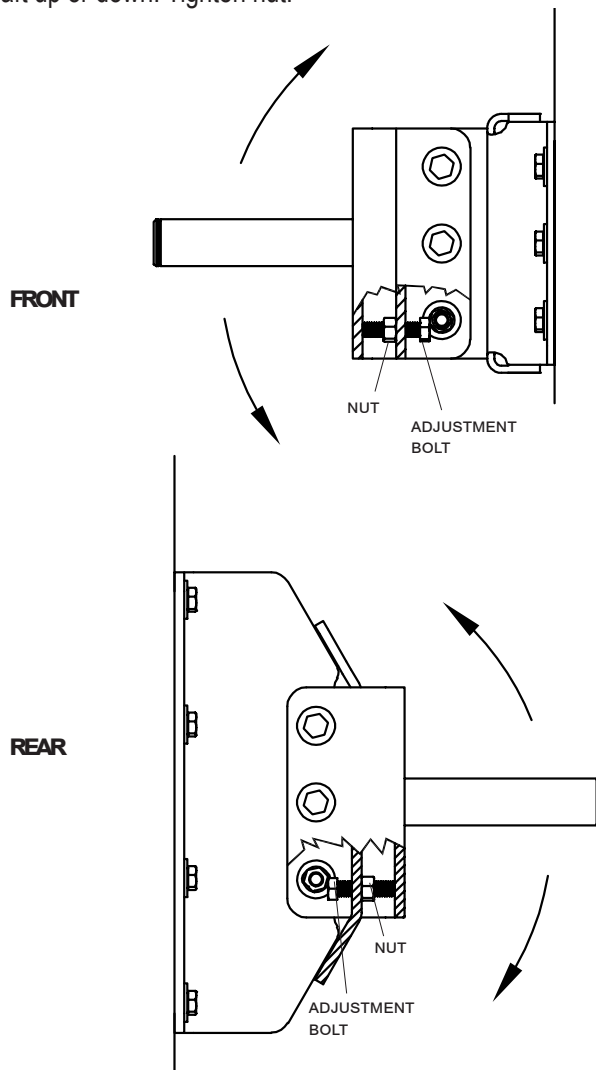

**STEP 3:** Retighten all six fasteners at sides of pivot bracket.

**STEP 4:** Operate tarp to check for correct movement. Repeat steps if needed.

**Swing End:** On front pivot bracket, adjust angle of shaft upward if tarp is walking to front of box when opening cover. Adjust shaft angle downward if tarp is walking to rear.

**Fixed End Front:** On front pivot bracket, adjust angle of shaft upward if tarp is walking to front of box when opening or downward if tarp is walking to rear.

**Fixed End Rear:** Adjust angle of shaft upward if tarp is walking to rear when opening cover and downward if tarp is walking to front.

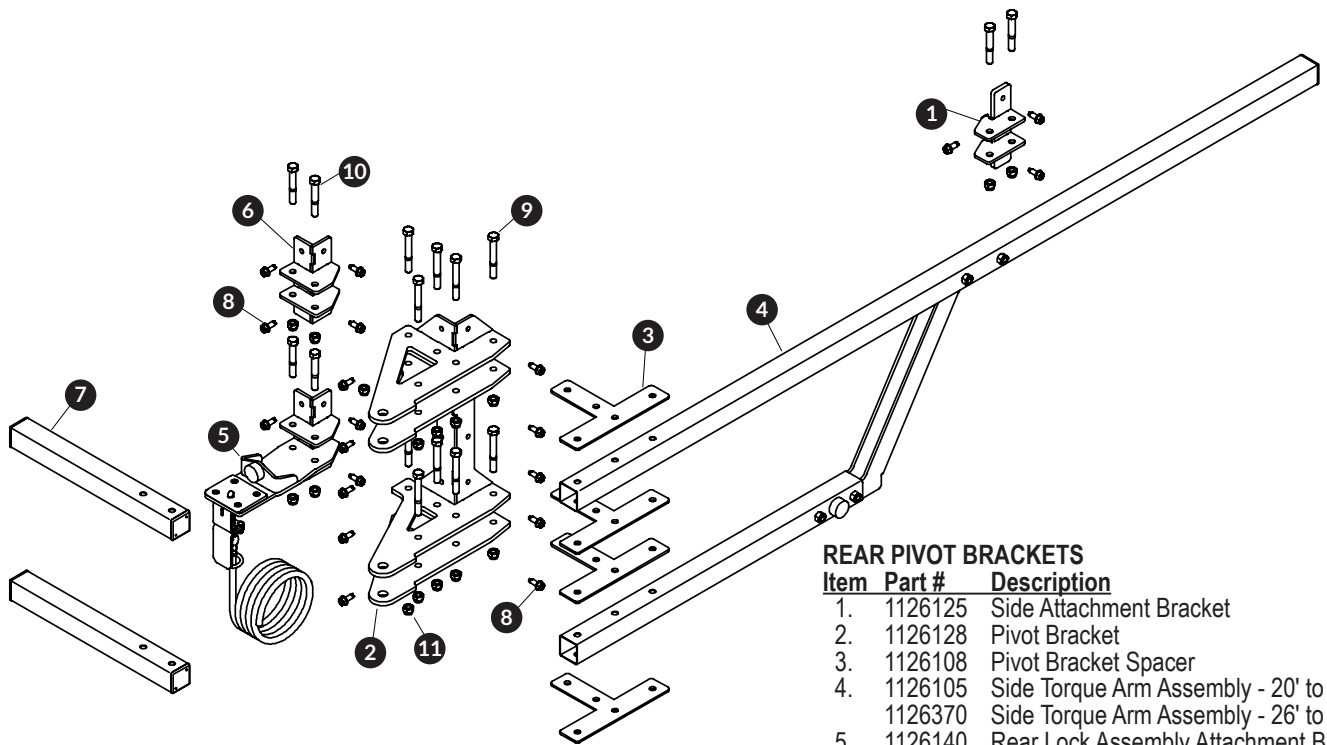

**REAR PIVOT BRACKETS**

Item	Part #	Description
1.	1126125	Side Attachment Bracket
2.	1126128	Pivot Bracket
3.	1126108	Pivot Bracket Spacer
4.	1126105	Side Torque Arm Assembly - 20' to 24'
	1126370	Side Torque Arm Assembly - 26' to 30'
5.	1126140	Rear Lock Assembly Attachment Bracket
6.	1126122	Rear Attachment Bracket
7.	1126181	Anti-Torque Tube - Rear Assembly
8.	1700400	Self-Tapping Screw - 3/8" x 1"
9.	1705687	Cap Screw - 1/2" x 3-3/4"
10.	1704808	Cap Screw - 1/2" x 3-1/4"
11.	1702115	Nylon Lock Nut - 1/2"

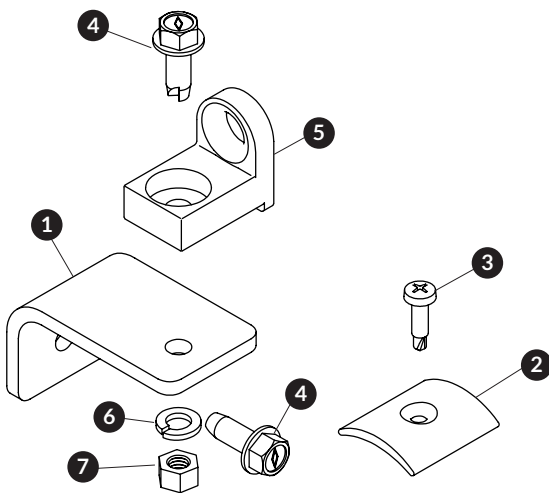

**STRETCH CORDS**

Item	Part #	Description
1.	1126369	Bungee Eye Mount
2.	1701354	Plastic U-Clamp
3.	1705198	Pan Hd. Self-Drilling Screw - 1/4" x 1"
4.	1700400	Self-Tapping Screw - 3/8" x 1"
5.	1703445	Eye Bracket
6.	1700434	Lock Washer - 3/8"
7.	1700407	Hex Nut - 3/8"

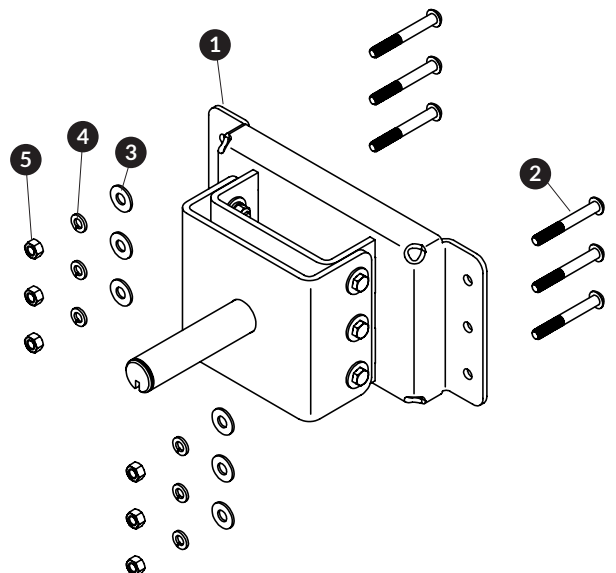

**FRONT PIVOT MOUNT BRACKETS**

Item	Part #	Description
1.	1126102	Front Pivot Mt. Bracket Assembly
2.	1705758	Button Hd. Cap Screw - 3/8" x 3"
3.	1700429	Flat Washer - 3/8"
4.	1700434	Lock Washer - 3/8"
5.	1700407	Hex Nut - 3/8"

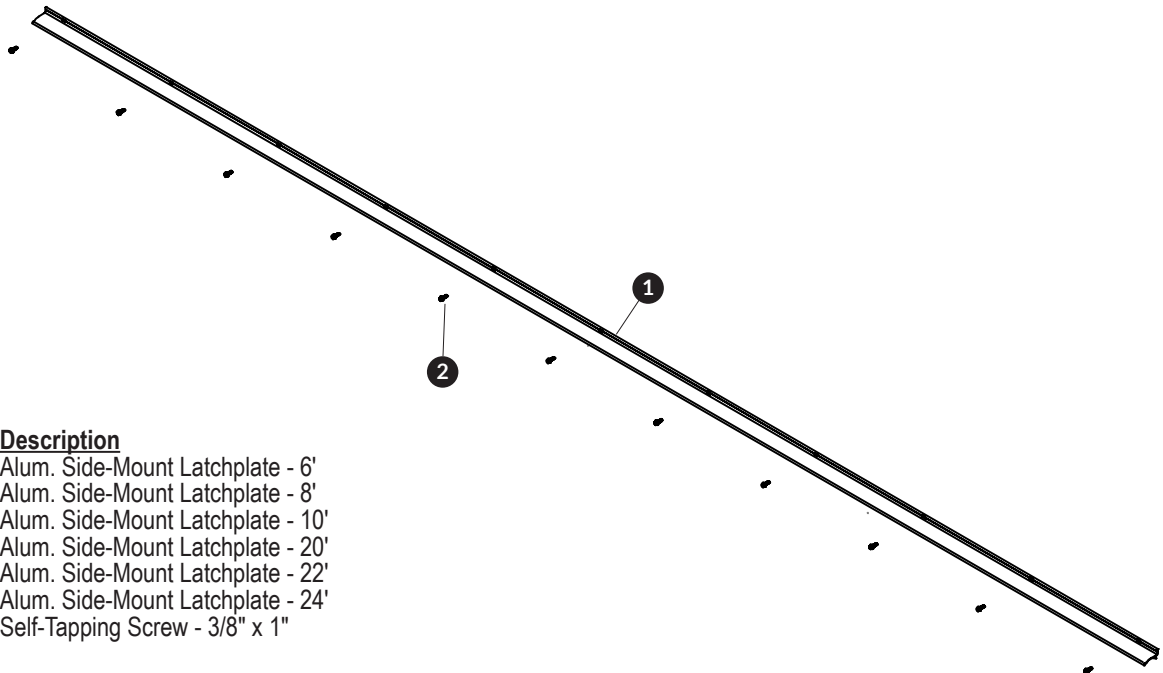

**LATCHPLATES**

Item	Part #	Description
1.	1120220	Alum. Side-Mount Latchplate - 6'
	1120221	Alum. Side-Mount Latchplate - 8'
	1122085	Alum. Side-Mount Latchplate - 10'
	1125198	Alum. Side-Mount Latchplate - 20'
	1125199	Alum. Side-Mount Latchplate - 22'
	1125200	Alum. Side-Mount Latchplate - 24'
2.	1700400	Self-Tapping Screw - 3/8" x 1"

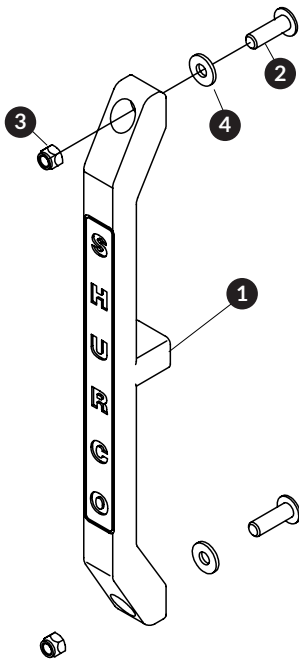

**ROLL TUBE DEFLECTORS**

Item	Part #	Description
1.	1112029	Roll Tube Deflector - Gray
	1114658	Roll Tube Deflector - Black
2.	1704441	Flanged Button Hd. Screw - 5/16" x 1"
3.	1704297	Nylon Lock Nut - 5/16"
4.	1700428	Flat Washer - 5/16"

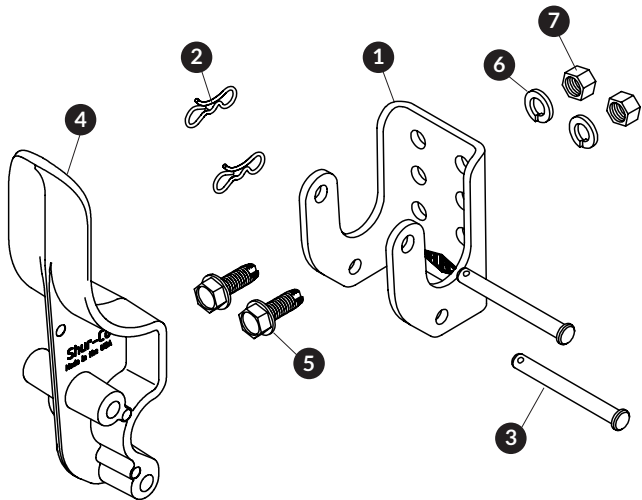

**EASY-OFF TARP STOPS**

Item	Part #	Description
1.	1100833	Easy-Off Tarp Stop Body
2.	1704380	Bowtie Cotter Pin
3.	1703604	Clevis Pin - 5/16" x 2-7/8"
4.	1705775	Easy-Off Aluminum Tarp Stop Upright
5.	1700400	Self-Tapping Screw - 3/8" x 1"
6.	1700434	Lock Washer - 3/8"
7.	1700407	Hex Nut - 3/8"



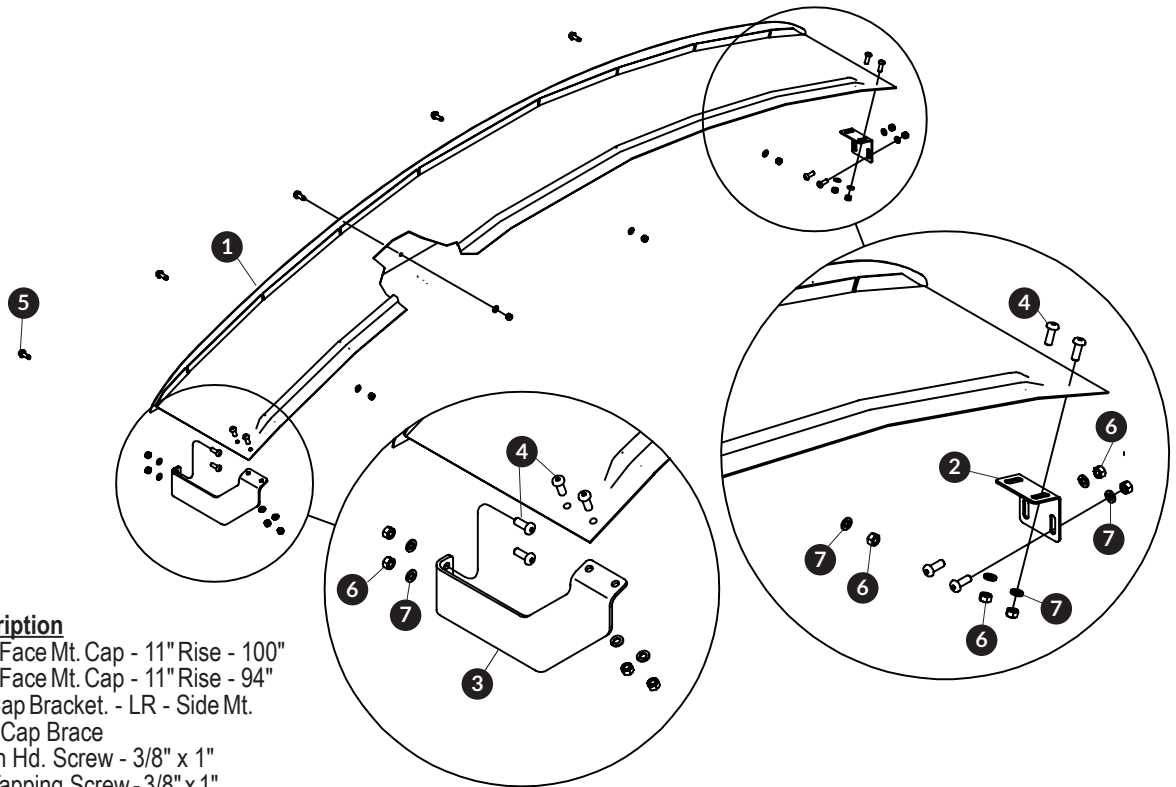

**FRONT CAPS**

Item	Part #	Description
1.	1126294	Galv. Face Mt. Cap - 11" Rise - 100"
	1126503	Galv. Face Mt. Cap - 11" Rise - 94"
2.	1118188	End Cap Bracket - LR - Side Mt.
3.	1126310	Front Cap Brace
4.	1705322	Button Hd. Screw - 3/8" x 1"
5.	1700400	Self-Tapping Screw - 3/8" x 1"
6.	1700407	Hex Nut - 3/8"
7.	1700434	Lock Washer - 3/8"

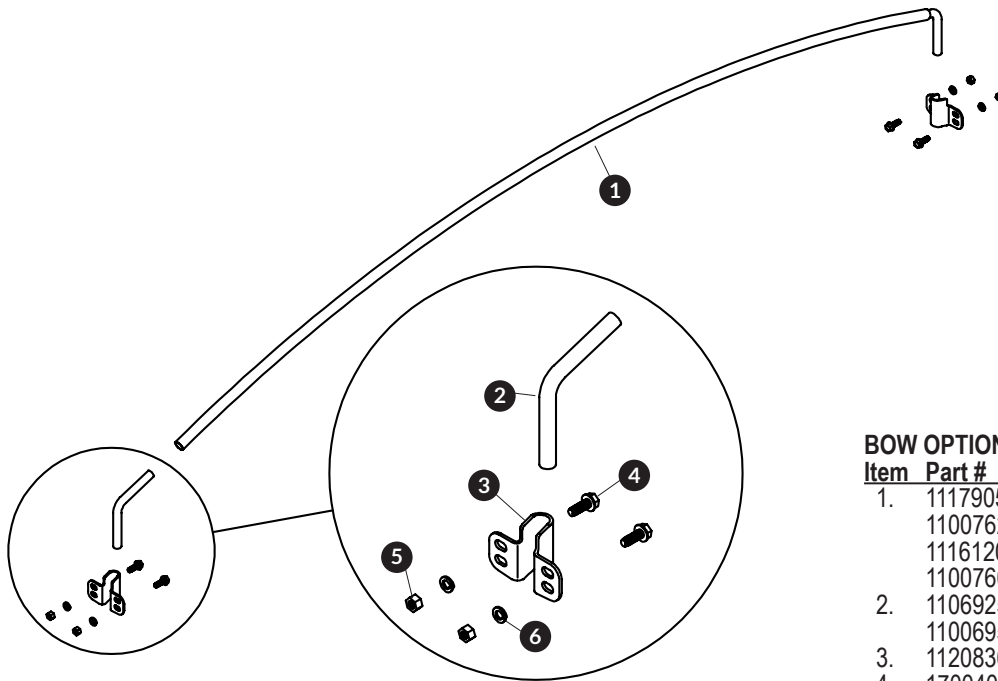

**BOW OPTIONS**

Item	Part #	Description
1.	1117905	Std. High-Rise Bow - 89" to 95"
	1100762	Std. High-Rise Bow - 96" to 102"
	1116120	Std. Low-Rise Bow - 85" to 92"
	1100760	Std. Low-Rise Bow - 93" to 102"
2.	1106925	Std. High-Rise Bow Shank
	1100695	Std. Low-Rise Bow Shank
3.	1120836	Single Bow Bracket
4.	1700400	Self-Tapping Screw - 3/8" x 1"
5.	1700407	Hex Nut - 3/8"
6.	1700434	Lock Washer - 3/8"

**TARP TUBES**

Item	Part #	Description
1.	1700051	Fixed Tube - 1-1/8" x 16'
	1700049	Fixed Tube - 1-1/8" x 20'
	1701428	Fixed Tube - 1-1/8" x 24'
2.	1120040	Alum. Roll Tube - 3" x 10'
	1118639	Alum. Roll Tube - 3" x 12'
	1704439	Alum. Roll Tube - 3" x 16'
	1704236	Alum. Roll Tube - 3" x 24'
3.	1701354	Plastic U-Clamp
4.	1704863	Splice - 3" x 36"
5.	1121040	Roll Tube Cap - 3" Spline
6.	1125923	Rear Cartridge Assembly - 3" x 24-1/4"
7.	1125921	Cartridge Assembly - 3" x 20"
8.	1700523	End Plug - 1-1/8"
9.	1704768	Flat Hd. Self-Drilling Screw - 1/4" x 3/4"
10.	1700398	Pan Hd. Self-Drilling Screw - 1/4" x 3/4"
11.	1705198	Self-Drilling Screw - 1/4" x 1"
12.	1126668	Tarp Spacer

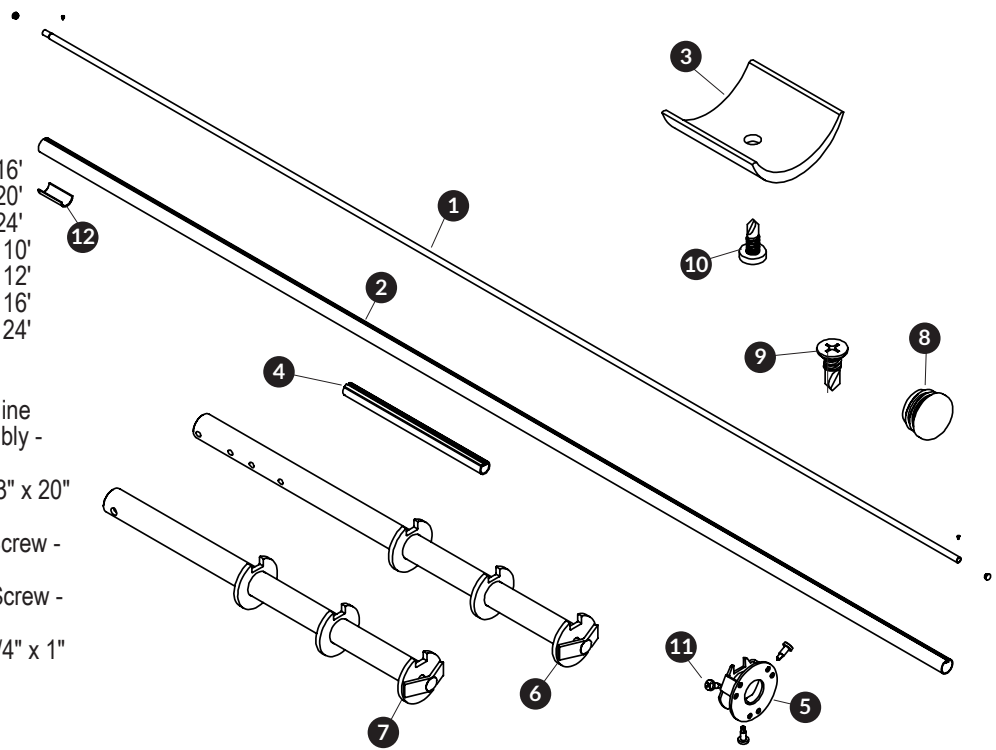

**BACK CAPS**

Item	Part #	Description
1.	1126662	Rear Bow
2.	1126297	Back Cap - 1/2 Cap - Al - 11" Rise - 100" - 10" ND - Left
	1126506	Back Cap - 1/2 Cap - Al - 11" Rise - 94" - 10" ND - Left
3.	1126300	Back Cap - 1/2 Cap - Al - 11" Rise - 100" - 10" ND - Right
	1126509	Back Cap - 1/2 Cap - Al - 11" Rise - 94" - 10" ND - Right
4.	1126311	Rear Cap Brace
5.	1700400	Self-Tapping Screw - 3/8" x 1"
6.	1704516	Carriage Bolt - 3/8" x 2-1/2"
7.	1705322	Button Hd. Screw - 3/8" x 1"
8.	1700434	Lock Washer - 3/8"
9.	1700407	Hex Nut - 3/8"

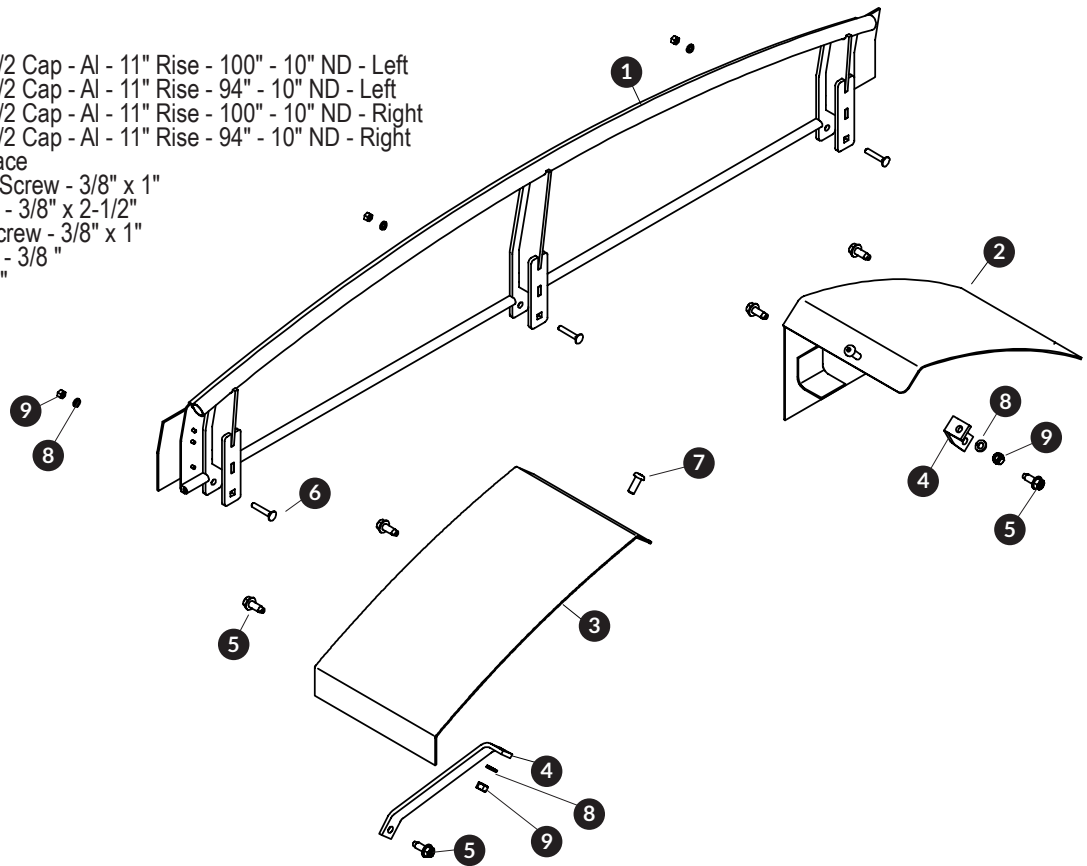

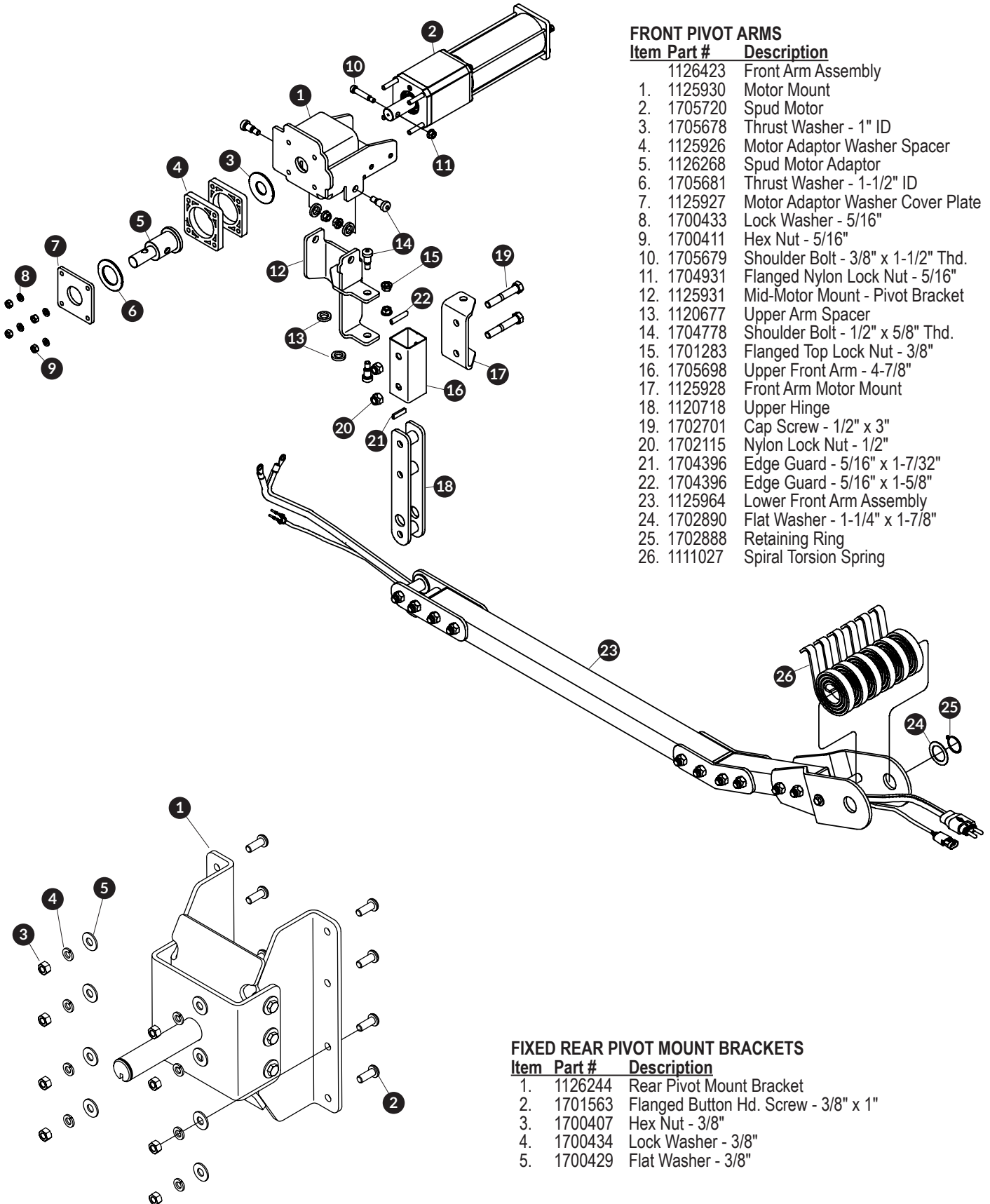

**FRONT PIVOT ARMS**

Item	Part #	Description
	1126423	Front Arm Assembly
1.	1125930	Motor Mount
2.	1705720	Spud Motor
3.	1705678	Thrust Washer - 1" ID
4.	1125926	Motor Adaptor Washer Spacer
5.	1126268	Spud Motor Adaptor
6.	1705681	Thrust Washer - 1-1/2" ID
7.	1125927	Motor Adaptor Washer Cover Plate
8.	1700433	Lock Washer - 5/16"
9.	1700411	Hex Nut - 5/16"
10.	1705679	Shoulder Bolt - 3/8" x 1-1/2" Thd.
11.	1704931	Flanged Nylon Lock Nut - 5/16"
12.	1125931	Mid-Motor Mount - Pivot Bracket
13.	1120677	Upper Arm Spacer
14.	1704778	Shoulder Bolt - 1/2" x 5/8" Thd.
15.	1701283	Flanged Top Lock Nut - 3/8"
16.	1705698	Upper Front Arm - 4-7/8"
17.	1125928	Front Arm Motor Mount
18.	1120718	Upper Hinge
19.	1702701	Cap Screw - 1/2" x 3"
20.	1702115	Nylon Lock Nut - 1/2"
21.	1704396	Edge Guard - 5/16" x 1-7/32"
22.	1704396	Edge Guard - 5/16" x 1-5/8"
23.	1125964	Lower Front Arm Assembly
24.	1702890	Flat Washer - 1-1/4" x 1-7/8"
25.	1702888	Retaining Ring
26.	1111027	Spiral Torsion Spring

**FIXED REAR PIVOT MOUNT BRACKETS**

Item	Part #	Description
1.	1126244	Rear Pivot Mount Bracket
2.	1701563	Flanged Button Hd. Screw - 3/8" x 1"
3.	1700407	Hex Nut - 3/8"
4.	1700434	Lock Washer - 3/8"
5.	1700429	Flat Washer - 3/8"

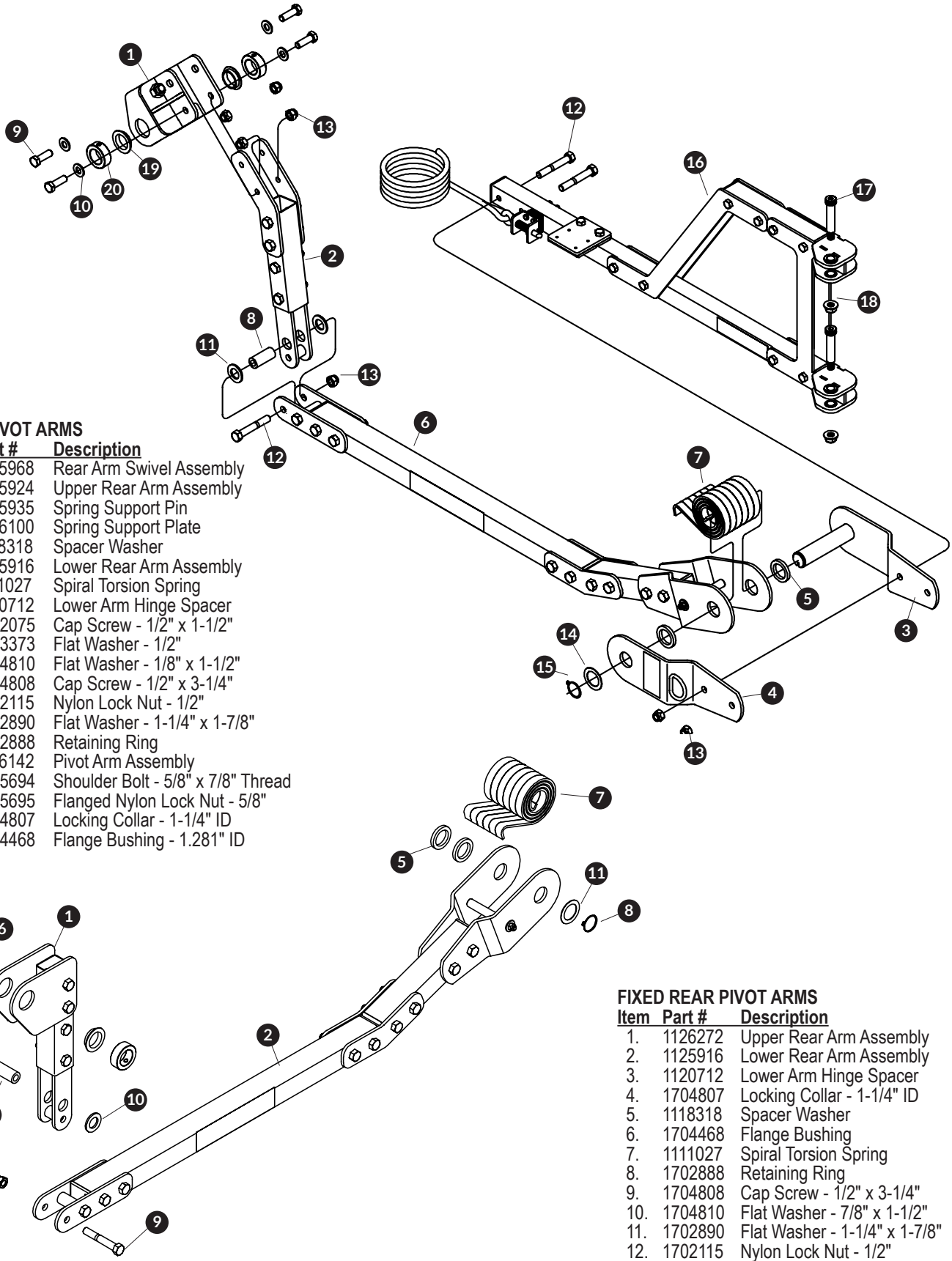

**REAR PIVOT ARMS**

Item	Part #	Description
1.	1125968	Rear Arm Swivel Assembly
2.	1125924	Upper Rear Arm Assembly
3.	1125935	Spring Support Pin
4.	1126100	Spring Support Plate
5.	1118318	Spacer Washer
6.	1125916	Lower Rear Arm Assembly
7.	1111027	Spiral Torsion Spring
8.	1120712	Lower Arm Hinge Spacer
9.	1702075	Cap Screw - 1/2" x 1-1/2"
10.	1703373	Flat Washer - 1/2"
11.	1704810	Flat Washer - 1/8" x 1-1/2"
12.	1704808	Cap Screw - 1/2" x 3-1/4"
13.	1702115	Nylon Lock Nut - 1/2"
14.	1702890	Flat Washer - 1-1/4" x 1-7/8"
15.	1702888	Retaining Ring
16.	1126142	Pivot Arm Assembly
17.	1705694	Shoulder Bolt - 5/8" x 7/8" Thread
18.	1705695	Flanged Nylon Lock Nut - 5/8"
19.	1704807	Locking Collar - 1-1/4" ID
20.	1704468	Flange Bushing - 1.281" ID

**FIXED REAR PIVOT ARMS**

Item	Part #	Description
1.	1126272	Upper Rear Arm Assembly
2.	1125916	Lower Rear Arm Assembly
3.	1120712	Lower Arm Hinge Spacer
4.	1704807	Locking Collar - 1-1/4" ID
5.	1118318	Spacer Washer
6.	1704468	Flange Bushing
7.	1111027	Spiral Torsion Spring
8.	1702888	Retaining Ring
9.	1704808	Cap Screw - 1/2" x 3-1/4"
10.	1704810	Flat Washer - 7/8" x 1-1/2"
11.	1702890	Flat Washer - 1-1/4" x 1-7/8"
12.	1702115	Nylon Lock Nut - 1/2"

**ELECTRIC COMPONENTS**

Item	Part #	Description
1.		Shur-Co® Wireless Receiver - SMARTWire™
2.	1704751	Harness Lock Pin - 1/4" x 7/8"
3.	1704338	Self-Tapping Screw - 1/4" x 1"
4.	1702926	Cap Screw - 5/16" x 7/8"
5.	1700428	Flat Washer - 5/16"
6.	1700419	Lock Nut - 5/16"
7.	1702108	Wire Clip - 3/4"
8.	1703231	Cable Tie - 8"
9.	1704994	SMARTwire™ - 6 Ga. x 40' - Socket/Blunt
10.	1120817	SMARTwire™ - 6 Ga. x 6' 3" - Socket
11.	1704706	SMARTwire™ - 6 Ga. x 2' 4" - Plug
12.	1703245	Ring Terminal - 6 Ga. x #10 Stud
13.	1703244	Ring Terminal - 6 Ga. x 3/8" Stud
14.	1704354	40-Amp Modified-Reset Circuit Breaker
15.	1704411	Circuit Breaker Rubber Boot - Red

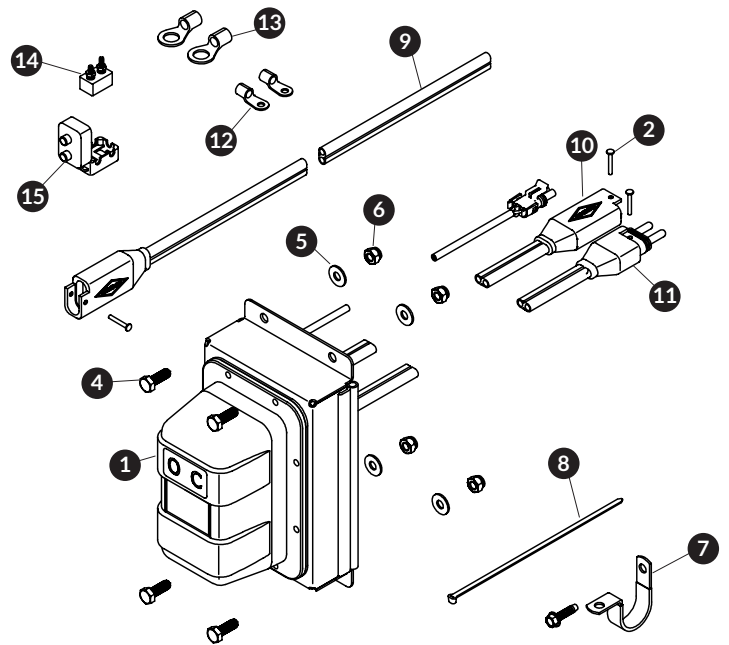





# MORE QUALITY PRODUCTS FROM SHUR-CO®

---

## GENUINE REPLACEMENT TARPS

## GENUINE REPLACEMENT PARTS

## GENUINE REPLACEMENT PARTS

- *The Original Shur-Lok*®
- Cable-Lok™
- Tater-Top™
- Premium Belt 'N Ratchet
- Turning Point™ Bow
- Shur-Lok® Junior

## SMARTTRAILER™ ACCESSORIES FOR AGRICULTURE PRODUCTS

- SMART2™ Remote
- SMART3™ Remote
- 4500 Series HD Electric
- Electric Shur-Lok®
- Electric Cable-Lok™
- Electric Tater-Top™
- ProTrap® Hopper Opener
- AutoTrap™ Hopper Opener
- Electric Gate & Hoist
- DriveMaxx™ Auger Drive Kit
- Electric Farm Swing Gate
- LiteALL™ LED Work Lights
- Solar Power Pack
- Electric Turning Point™ Bow
- Service Truck Power Kit

## CONSTRUCTION PRODUCTS

- *The Original Shur-Lok*®
- Shur-Trak™ II
- IronSide™ II
- Shur-Matic™
- Premium Belt 'N Ratchet
- Turning Point™ Bow

## SMARTTRAILER™ ACCESSORIES FOR CONSTRUCTION PRODUCTS

- SMART2™ Remote
- SMART3™ Remote
- 4500 Series HD Electric  
w/Gate Flex™
- Electric Shur-Lok®
- Electric Cable-Lok™
- Electric Shur-Trak™ II
- Solar Power Pack
- Electric Turning Point™ Bow
- Service Truck Power Kit

## CUSTOM PRODUCTS

- Fitted Truck Covers
- Flat Utility Tarps
- Bean Drill Covers
- GustBuster™ Tarp Cords
- SMARTwire™

---

TARP SYSTEMS & ACCESSORIES

