



TARPING SYSTEMS & ACCESSORIES

P/N 1127298 Rev. C

# OWNER'S MANUAL



By: Shur-Co®

*READ BEFORE INSTALLING*

PO BOX 713 ■ 2309 SHUR-LOK STREET ■ YANKTON, SD 57078-0713  
PHONE 1-800-4-SHUR-LOK (1-800-474-8756) ■ FAX 605-665-0501  
[www.shurco.com](http://www.shurco.com)

SHOP ONLINE: [www.shopshurco.com](http://www.shopshurco.com)

**SHIPPING.** Orders are shipped F.O.B. from the Shur-Co®, LLC sites listed below. No full freight is allowed or prepaid shipment accepted unless quoted and approved in writing prior to acceptance of the order. All shipments are made by the most reasonable means in accordance with size and weight of order, unless specified routing instructions are furnished by the customer. Shipments are made daily via U.P.S. and common carrier. Claims for shortages must be made within 10 days. All claims for damages or loss in transit must be made with the carrier. No collect calls will be accepted. To ensure delivery of orders, we need your full street address and phone number. When you receive your shipment, examine it carefully. Be sure all cartons listed on the delivery sheet are accounted for. Large items may be packaged separately. If a carton is damaged, open it and inspect the contents before signing for delivery. If merchandise is damaged, describe damage on the delivery receipt. Failure on your part to document damaged or missing merchandise on the delivery receipt releases the carrier of all liability; repair or replacement will be the customer's responsibility.

**WARRANTY.** We warrant all new products are free of defects in materials and workmanship.\* This warranty is effective if products are properly installed and used for the purpose for which they were intended and applies to the original buyer only. Except as set forth above or in any product-specific warranty documentation, we make no other warranties, express or implied, including but not limited to warranties of merchantability of fitness for a particular use.

Returns of a product for warranty must be accompanied by a Return Merchandise Authorization number (RMA#), obtained by calling Customer Service at 866-748-7435, and sent, with freight paid by us, to Shur-Co®, LLC, 2309 Shur-Lok St., PO Box 713, Yankton, SD 57078. All products returned without an RMA# will be refused. When we issue the RMA#, we will also issue a call tag to have UPS (or other freight company) pick up the product. C.O.D. returns not accepted. We will pay no storage fees for a warranty product return prior to pick by us or the freight company. If a warranty product return is scheduled to be picked up by us, we will pick up the product at our earliest convenience.

If a product returned is found, in our judgement, to be defective in material or workmanship, our obligation under this warranty is limited to the repair or replacement of the product, which will be made by us. Repair or replacement will be at our discretion, with replacements being made using current products performing in the equivalent function. Labor charges, other than those incurred at our factory, including, but not limited to, any labor to install a repaired or replacement product, are not covered under this warranty. All expenses associated with delivering defective products to our factory and delivering repaired or replacement products from our factory to the owner will be paid by us.

If the product returned is found, in our judgement, to be non-warrantable, the owner will be contacted to authorize repair work, purchase of a replacement product or return of the product, all of which will be at the owner's expense. Payment authorization must be received by us before any non-warrantable product is repaired, replaced or returned. All expenses associated with delivering the repaired non-warrantable product, a replacement product or the non-warrantable product from our factory to the owner will be paid by the owner.

In no event will we be liable for any damages of any kind to person, product or property, including but not limited to indirect, incidental, special, consequential or punitive damages, or damages for loss of profits or revenue, even if we have been advised of the possibility of such damages. There are no warranties for used products or products that have been repaired, altered, modified or subjected to misuse, negligence or accident. We will not repair or replace products that fail or malfunction due to ordinary wear and tear, except as expressly noted in a product-specific warranty. Use of non-Shur-Co®, LLC parts in conjunction with Shur-Co®, LLC products will void this product warranty.

\*Certain products have specific warranties that differ from this warranty, for example motors and electronics. Product-specific warranty documentation is available for these items. In the event of a conflict between this warranty and a product-specific warranty, the product-specific warranty will govern.

**RETURN POLICY.** All sales final. See WARRANTY above for return details.

**OTHER.** All prices, product listings, sizes, weights and manufacturing details are subject to change without notice. No person is authorized to modify the foregoing conditions of sale whatsoever.

**SHUR-CO®, LLC SERVICE AND DISTRIBUTION CENTERS**

*Corporate HQ and Outlet Store*  
**SHUR-CO® of SOUTH DAKOTA**  
 2309 Shur-Lok St., PO Box 713, Yankton, SD 57078  
 Ph 800.474.8756 | Fax 605.665.0501

**SHUR-CO® of FLORIDA**  
 3353 SE Gran Park Way, Stuart, FL 34997  
 Ph 800.327.8287 | Fax 772.287.0431

**SHUR-CO® of IDAHO**  
 610 N. 16th Ave., Caldwell, ID 83607  
 Ph 866.356.0246 | Fax 217.877.8270

**SHUR-CO® of ILLINOIS**  
 3993 E. Mueller Ave., Decatur, IL 62526  
 Ph 866.356.0246 | Fax 217.877.8270

**SHUR-CO® of NORTH DAKOTA**  
 1746 4th Ave. NW, West Fargo, ND 58078  
 Ph 877.868.4488 | Fax 701.277.1283

**SHUR-CO® of OHIO**  
 4676 Lynn Rd.  
 Rootstown, OH 44266  
 Ph 866.356.0242 | Fax 330.297.5599

**SHUR-CO® of VERMILLION**  
 1212 N. Norbeck St., Vermillion, SD  
 Ph 800.474.8756 | Fax 605.665.0501

**SHUR-CO® of CANADA**  
 490 Elgin St., Unit #1  
 Brantford, Ontario N3S 7P8  
 Ph 800.265.0823 | Fax 519.751.3997

**SHUR-CO® UK, Ltd.**  
 Unit 41 Rochester Airport Estates  
 Laker Rd., Rochester, Kent ME1 3QX  
 Ph +44 (0)1795.473499  
 Fax +44 (0)871.272.8278

For more information, log on to our website:

**www.shurco.com**

**MESSAGE TO OWNERS**

Thank you for buying this tarping system from Shur-Co®. We appreciate your confidence in our products. Please read and thoroughly understand this manual before installing and/or operating this system.

Pay particular attention to important safety and operating instructions, as well as warnings and cautions. The hazard symbol  is used to alert users to potentially hazardous conditions and is followed by caution, warning or danger messages.

Failure to READ AND FOLLOW INSTRUCTIONS could result in failure of your tarping system and/or personal injury. Your trailer requirements may, however, call for minor variations to these instructions.

Please inspect your tarping system periodically. Repair or replace worn or damaged parts to your system.

**QUESTIONS? CALL OUR HELP LINE:**  
**1-866-748-7435**  
 MON-FRI 8 AM-5 PM CENTRAL TIME

**SAFETY**

We at Shur-Co® are concerned with your safety and the safety of all those operating this system. Therefore, we have provided safety decals at various locations on your tarping system. Keep decals as clean as possible at all times. Replace any decal that has become worn or damaged, painted over or otherwise difficult to read. Replacement decals are available through Shur-Co® dealers.

**SAFETY INSTRUCTIONS**

- 1. Always wear safety glasses during installation and operation.**
- 2. Stay clear of moving parts.**
- 3. No other use of this system is authorized, except as designed.**

**RUST PREVENTION**

To prevent rust, paint all exposed metal, such as weld seams and/or metal exposed by grinding or cutting, with corrosion-resistant paint.

**TABLE OF CONTENTS**

Hardware Identification..... 1  
 Drive Brace Installation.....2-3  
 Jack Installation ..... 4  
 Main Beam to Swing Auger Installation .....5-8  
 Control Box Installation..... 9-11  
 Decal Installation ..... 12  
 Operation Instructions ..... 12

**TOOLS REQUIRED**

1. #3 Phillips Insert Bit
2. Air or Electric Impact Wrench (3/4" deep socket)
3. 1/2" Deep Socket
4. 3/4" Combination Wrench
5. 1/2" Combination Wrench
6. 1/2" Drill Bit
7. 3/8" Drill
8. Standard/Flathead Screwdriver
9. #2 Phillips Screwdriver
10. Utility Knife
11. Ratchet
12. Pliers
13. Side Cutter
14. Tape Measure
15. 5/16" Nut Driver
16. Aviation Snips
17. Hammer
18. Center Punch or Transfer Punch

Inspect all parts in your DriveMaxx™ electric kit upon arrival.

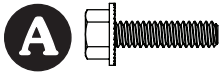

**A** 1704308 Flanged Screw #10 x 1/2"

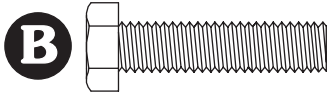

**B** 1705910 Cap Screw - 3/8" x 1-1/2" - Black

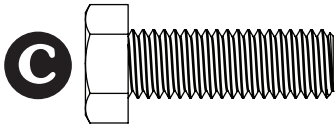

**C** 1705920 Cap Screw - 1/2" x 1-1/2" - Black

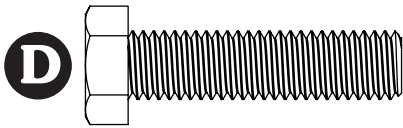

**D** 1701042 Cap Screw 1/2" x 2"

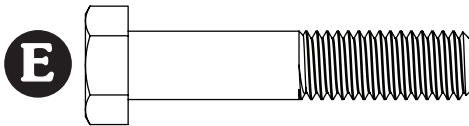

**E** 1704041 Cap Screw 1/2" x 2-1/2"

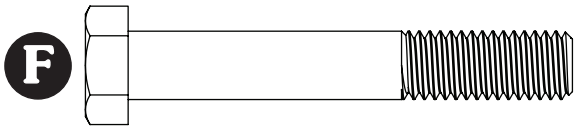

**F** 1705914 Cap Screw 1/2" x 3-1/4" - Black



**G** 1705918 Nylon Nut - 3/8" - Black

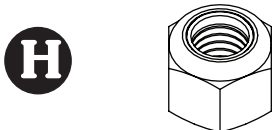

**H** 1705913 Nylon Lock Nut - 1/2" - Black



**J** 1705921 Flat Washer - 3/8" - Black

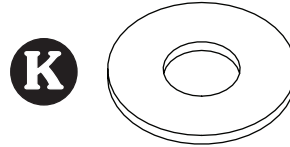

**K** 1705911 Flat Washer - 1/2" - Black

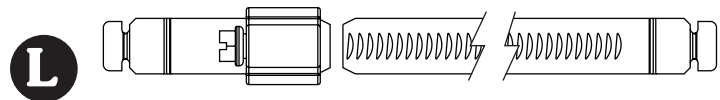

**L** 1706376 Hose Clamp Fastener Set



**M** 1703231 Cable Tie - 8"



**N** 1705977 Cable Tie - 60"

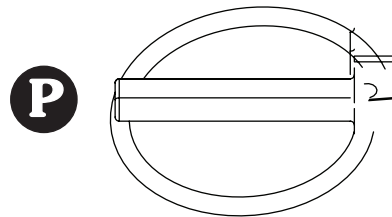

**P** 1705968 Lynch Pin

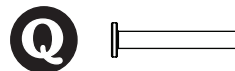

**Q** 1704751 Harness Pin - 1/8" x 7/8"

Item	Part #	Description
1.	1127464	Drive Brace - 10" to 11"
	1127468	Drive Brace - 11" to 12"
	1127229	Drive Brace - 12" to 13"
	1127424	Drive Brace - 13" to 14"
	1127273	Drive Brace - 14" to 15"
	1127425	Drive Brace - 15" to 16"
	1127274	Drive Brace - 16" to 17"
	1127426	Drive Brace - 17" to 18"
	1127275	Drive Brace - 18" to 19"
	1128621	Drive Brace - 19" to 20"
	1128622	Drive Brace - 20" to 21"
C.	1705920	Cap Screw - 1/2" x 1-1/2"
D.	1701042	Cap Screw - 1/2" x 2"
E.	1704041	Cap Screw - 1/2" x 2-1/2"
H.	1705913	Nylon Nut - 1/2"
K.	1705911	Flat Washer - 1/2"

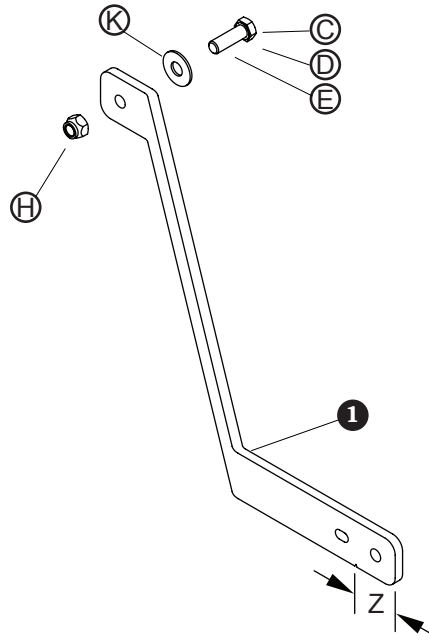

"Z"	Part #
2"	1127464
2.25"	1127468
2.5"	1127229
2.75"	1127424
3"	1127273
3.25"	1127425
3.5"	1127274
3.75"	1127426
4"	1127275
4.25"	1128621
4.5"	1128622

**STEP 1:** Find existing transition box pivot bolt location.

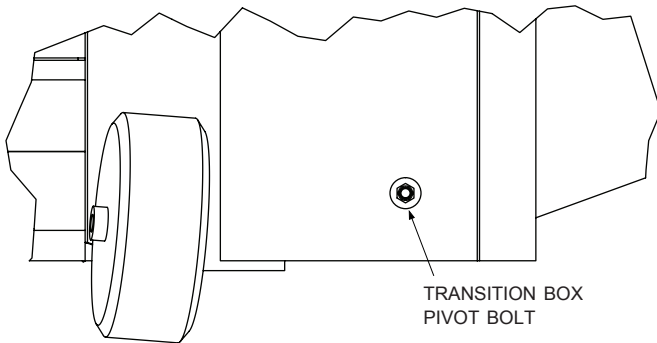

If transition box does not have pivot bolt, locate and drill a 1/2" hole approximately centered front-to-back and 8" up from ground.

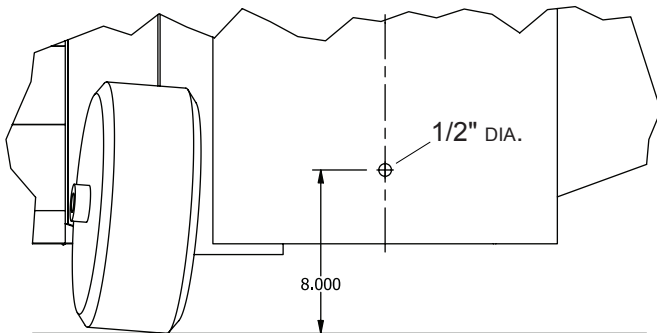

**NOTE:** Before drilling any holes, verify bolt will not interfere with operation of swing auger.

**STEP 2:** If box has flange, measure distance from flange to pivot bolt hole.

- If no flange or if distance "A" is 3-1/2" or greater, continue to Step 3A.
- If flange is between 2-1/2" and 3-1/2", skip to Step 3B.
- If flange is less than 2-1/2", skip to Step 3C.

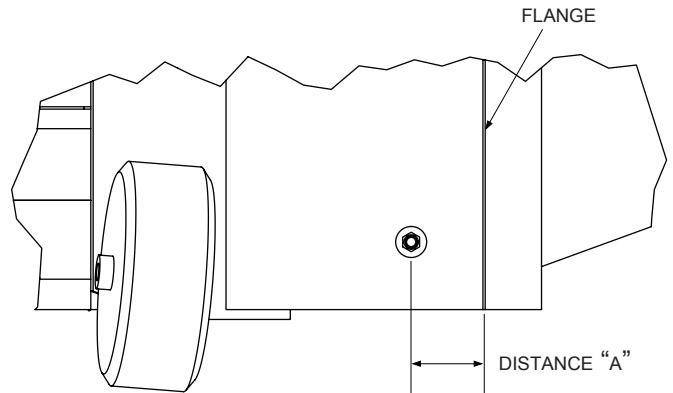

**STEP 3A:** If distance "A" is greater than 3-1/2" from flange or if there is no flange, remove existing hardware. Drill holes to accept 1/2" bolt **C**, if needed. Secure drive brace using bolt **C**, washer **K** and nylon nut **H**. Hand tighten nut.

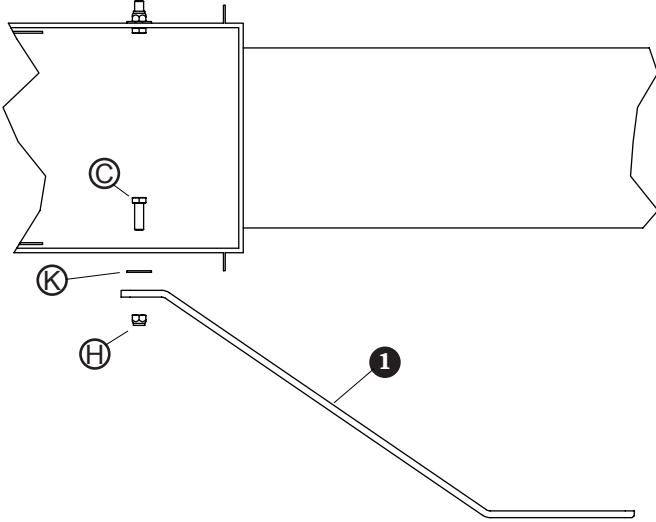

**STEP 3B:** If distance "A" is between 2-1/2" and 3-1/2" from flange, remove existing hardware. Drill holes in transition box to accept 1/2" bolt, if needed. Secure drive brace using bolt **D**, 1/2" stack of flat washer **K** and nylon nut **H**. Hand tighten nut.

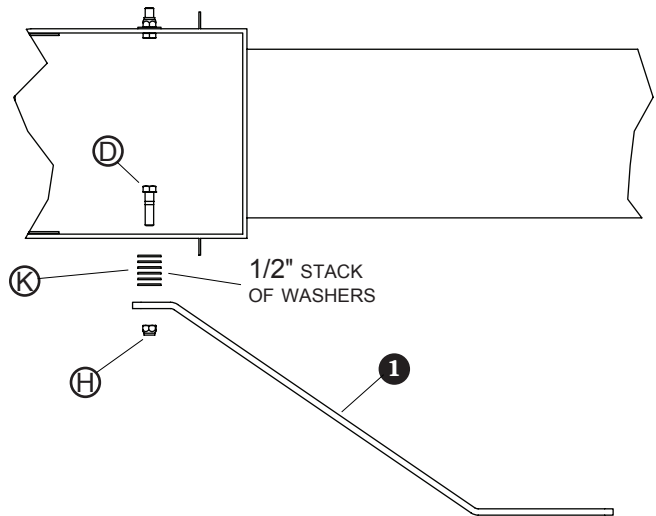

**NOTE:** Measure stack of washers; thickness can vary.

**STEP 3C:** Distance "A" is less than 2-1/2" from flange, remove existing hardware. Drill holes in transition box to accept 1/2" bolt, if needed. Secure drive brace using bolt **E**, 1" stack of flat washer **K**, and nylon nut **H**. Hand tighten nut.

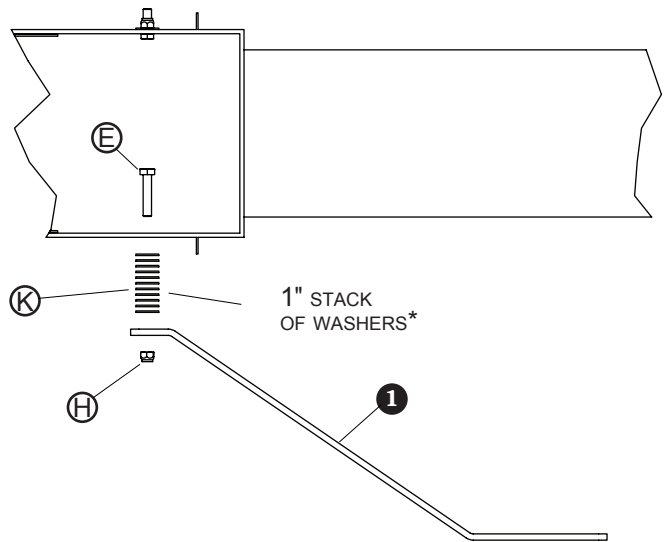

**NOTE:** Measure stack of washers; thickness can vary.

**STEP 4:** Repeat Step 3 on opposite side.

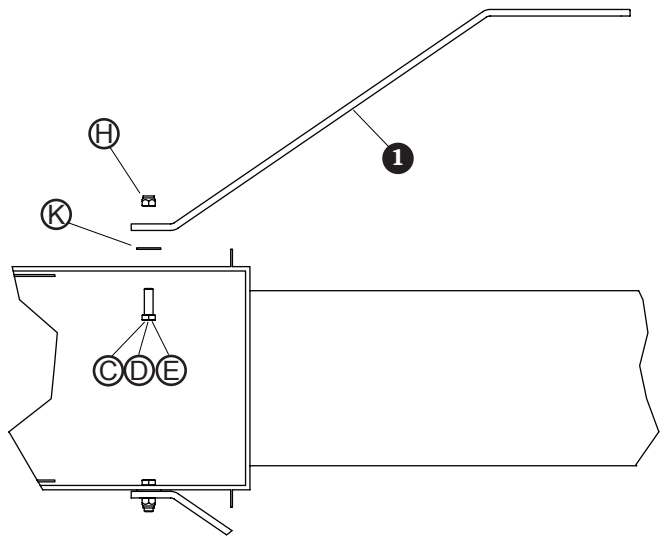

**NOTE:** Use same bolt and washer stack on both sides.

Item	Part #	Description
1.	1128470	Main Beam
2.	1127235	Jack 2-Hole
3.	1128578	Jack 2-Hole Dual
F.	1705914	Cap Screw - 1/2" x 3-1/4"
H.	1705913	Nylon Nut - 1/2"

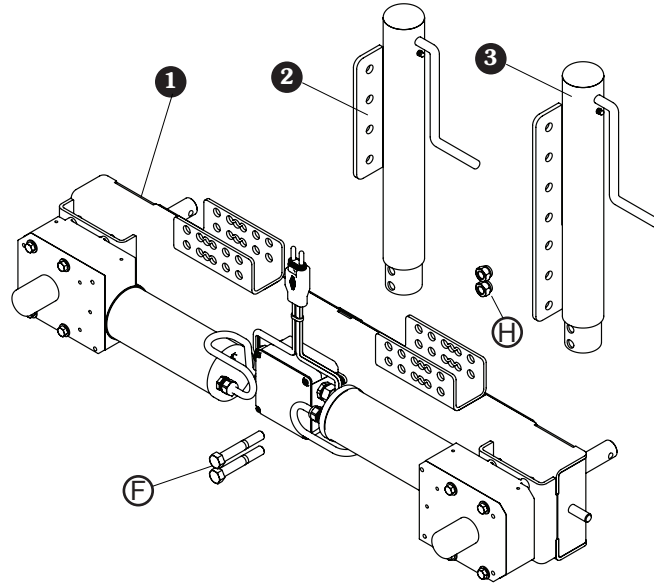

**STEP 1:** Remove bolt **F** and nylon nut **H** from main beam.

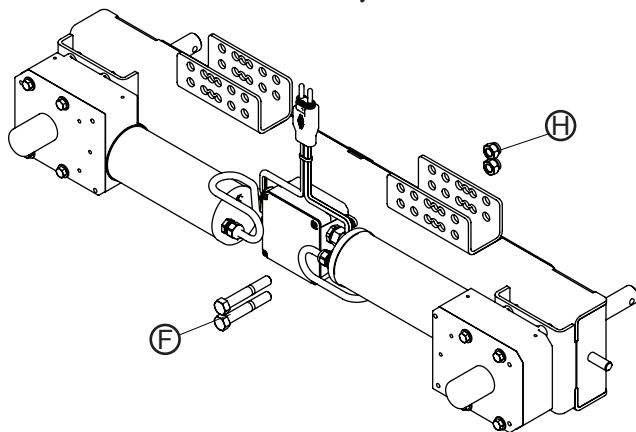

**STEP 2:** Locate correct hole in jack bracket for tube size of auger.

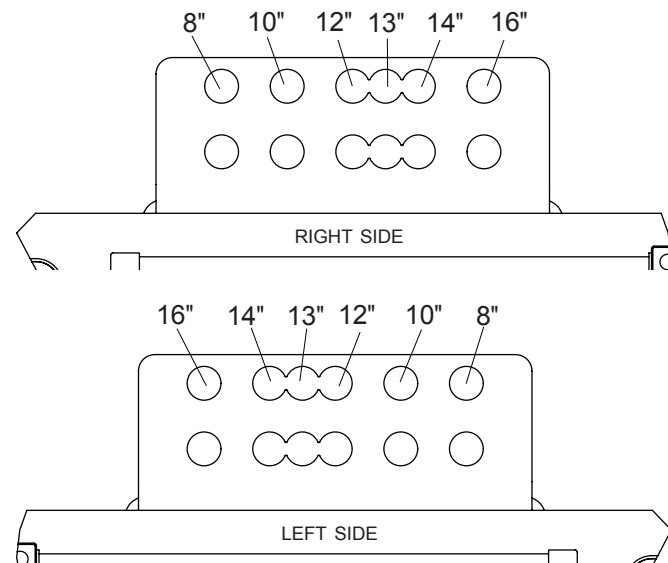

**STEP 3A:** While on level ground secure jack **2** to main beam with bolt **F** and nylon nut **H**. (For 8" to 12" auger tubes.)

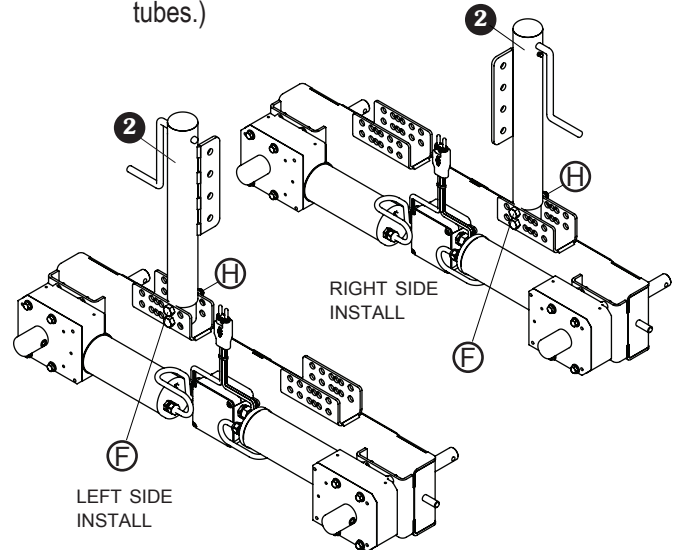

**STEP 3B:** While on level ground, secure jack **3** to main beam with bolt **F** and nylon nut **H**. (For 12" to 16" auger tubes.)

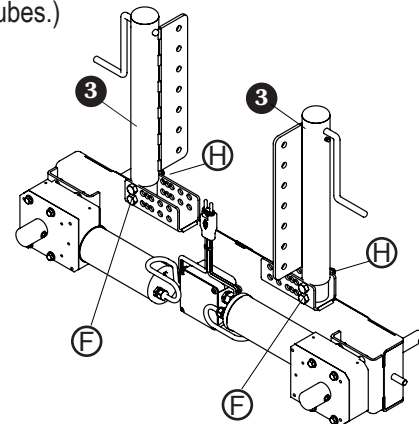

Item	Part #	Description
1.	1127230	Wheel Counter-Clockwise
2.	1127234	Wheel Clockwise
3.	1127291	Tube Band Jack Mount - 8"
	1127250	Tube Band Jack Mount - 10"
	1127252	Tube Band Jack Mount - 12"
	1127293	Tube Band Jack Mount - 13"
	1127254	Tube Band Jack Mount - 14"
	1127256	Tube Band Jack Mount - 16"
4.	1127282	Tube Band - 8"
	1127246	Tube Band - 10"
	1127247	Tube Band - 12"
	1127283	Tube Band - 13"
	1127248	Tube Band - 14"
	1127249	Tube Band - 16"
5.		For 8" to 13" Auger Tubes
6.		For 14" to 16" Auger Tubes
B.	1705910	Cap Screw - 3/8" x 1-1/2"
C.	1705920	Cap Screw - 1/2" x 1-1/2"
G.	1705918	Nylon Nut - 3/8"
H.	1705913	Nylon Nut - 1/2"
J.	1705921	Flat Washer - 3/8"
K.	1705911	Flat Washer - 1/2"
P.	1705968	Lynch-Pin 5/16" x 1-3/4"

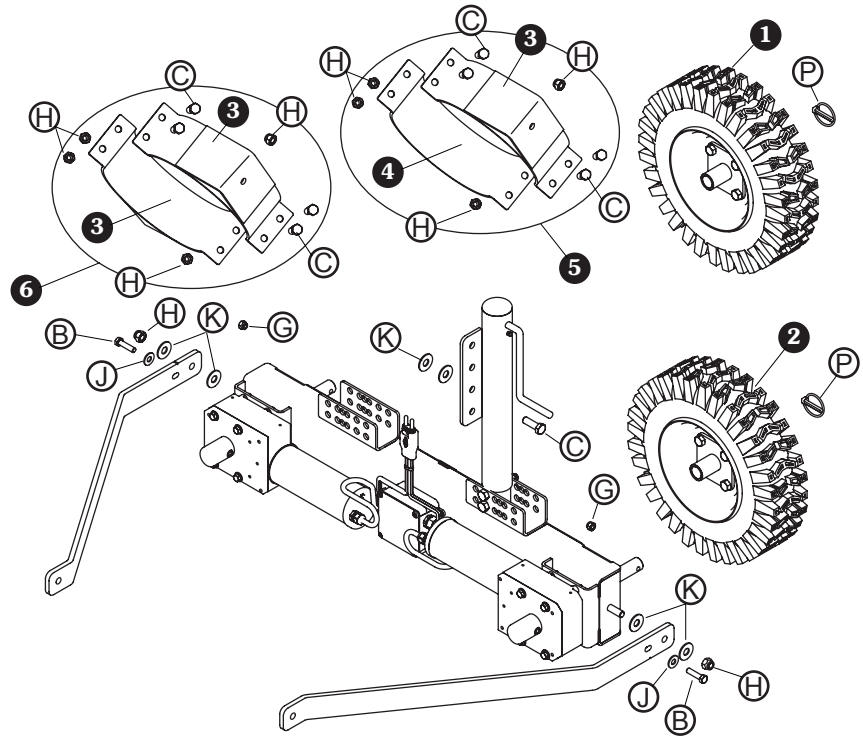

**NOTE:** 8" to 12" auger tube with right side jack installation is shown below. Left side installation is same, but jack will be on opposite side of auger tube. For 13" to 16" auger tubes, jack will be on each side of auger tube.

**STEP 1:** Install wheels on main beam and secure with lynch pin **P**.

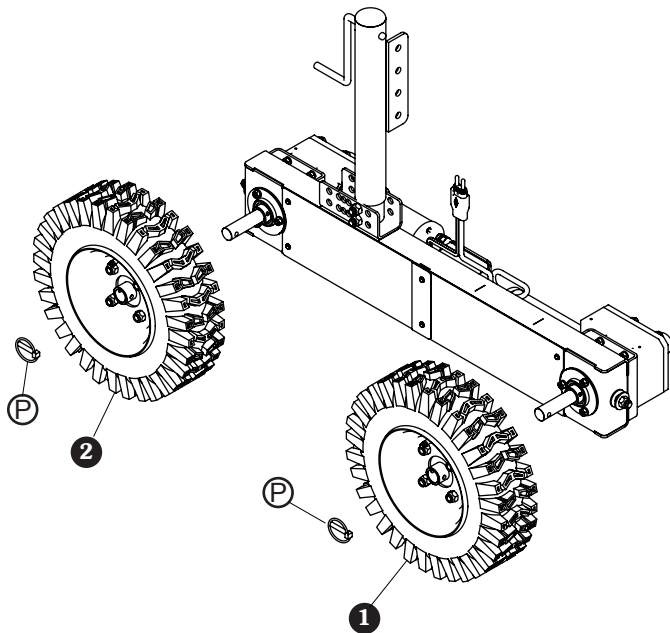

**NOTE:** Before proceeding to Step 2, position main auger tube as if filling a bin or silo.

**STEP 2:** Align main beam and jack with swing auger tube and drive braces. Secure with flat washers **K** and nylon nuts **H**. Tighten nylon nuts, then back nut off 1/4 turn so main beam can pivot at drive braces.

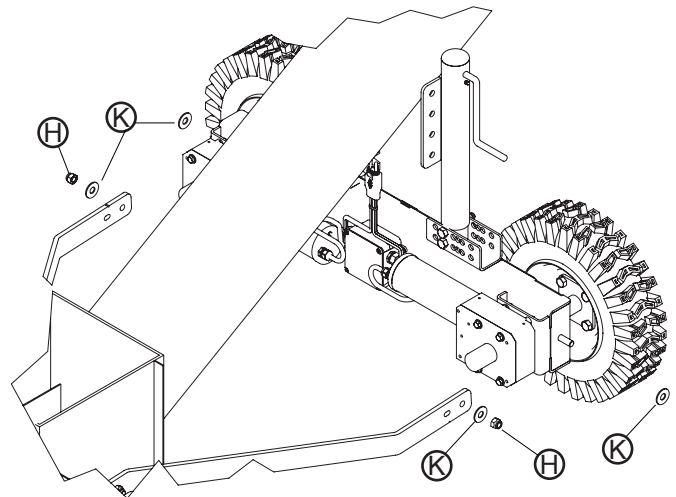



**STEP 3:** Tighten nylon nuts **H** at transition box. Then back nuts off 1/4 turn so drive brace can rotate on bolt.

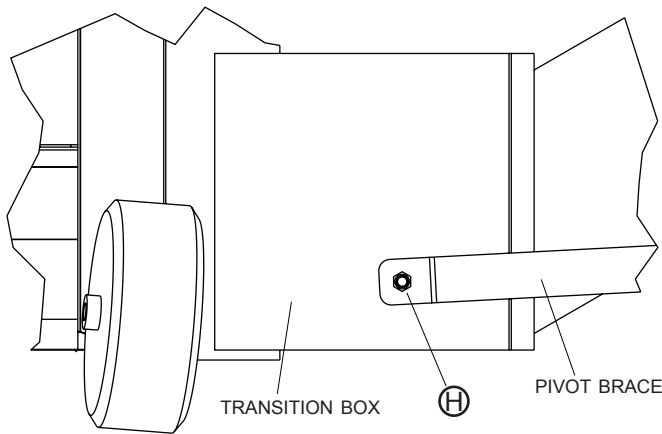

**STEP 4:** Repeat Step 3 on other side of transition box.

**STEP 5:** With drive wheels resting on ground, square main beam assembly so jack is perpendicular to ground. Placing a 5" wooden block under main beam will help determine correct position.

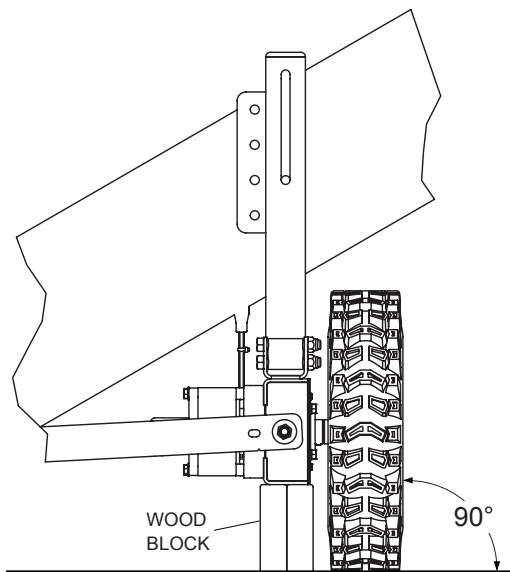

**NOTE:** Wood block may be constructed by ripping two 12" 2x6s to 5" wide and nailing or screwing together.

**STEP 6:** Turn jack handle until jack is in fully down position.

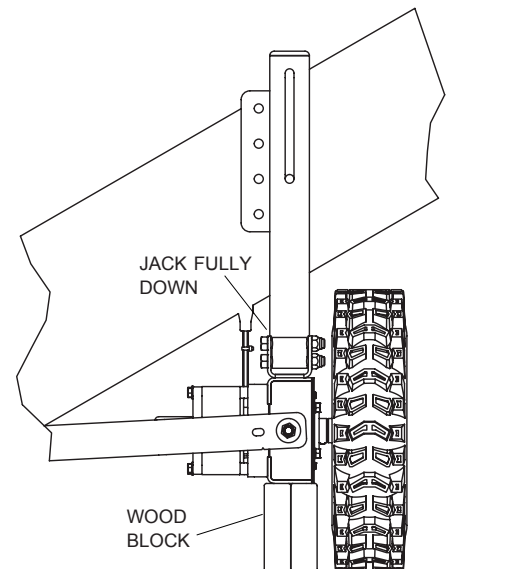

**STEP 7:** Place tube band jack mount on swing auger tube and align with plate on jack. Turn handle on jack, raising jack plate until hole in tube band jack mount is aligned with hole in jack plate.

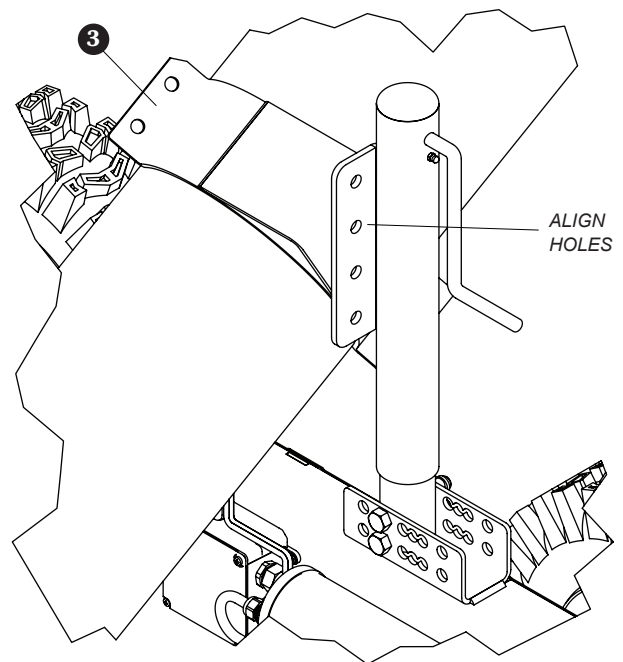

**STEP 8:** Secure jack plate to tube band jack mount using hex bolt **C**, two flat washers **K** between tube band jack mount and jack plate and nylon nut **H**. Tighten nylon nut, then back off 1/4 turn.

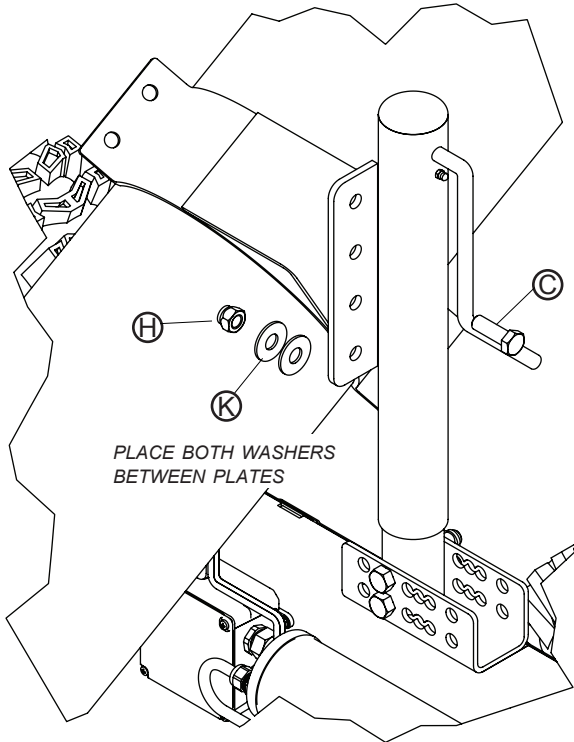

**STEP 9:** Position tube band by tube band jack mount. Secure bands together using hex bolts **C** and nylon nuts **H**. Evenly tighten fasteners securing bands to swing auger.

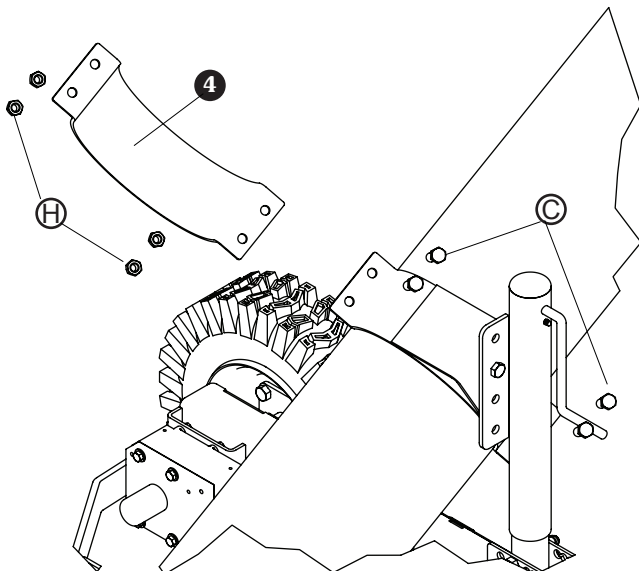

**STEP 10:** 13", 14" and 16" auger tubes will use two tube band jack mount bands.

**NOTE:** Second jack not shown for clarity of image.

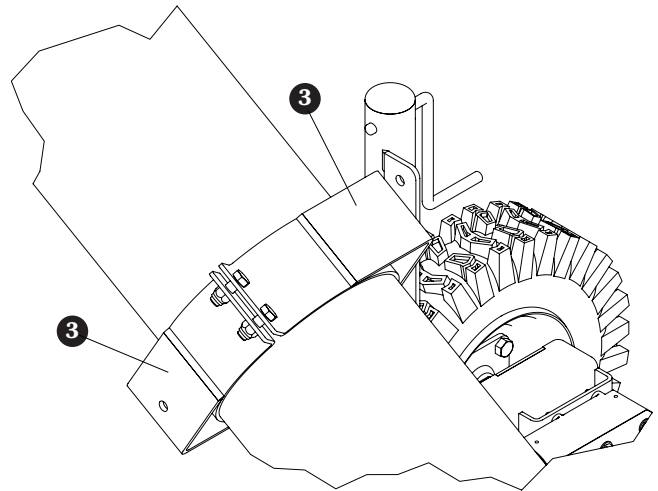

**STEP 10:** Turn jack handle to bring main beam to fully up position. Verify both wheels are off ground. If wheels do not come off ground, you will need to move to next lower hole in jack plate.

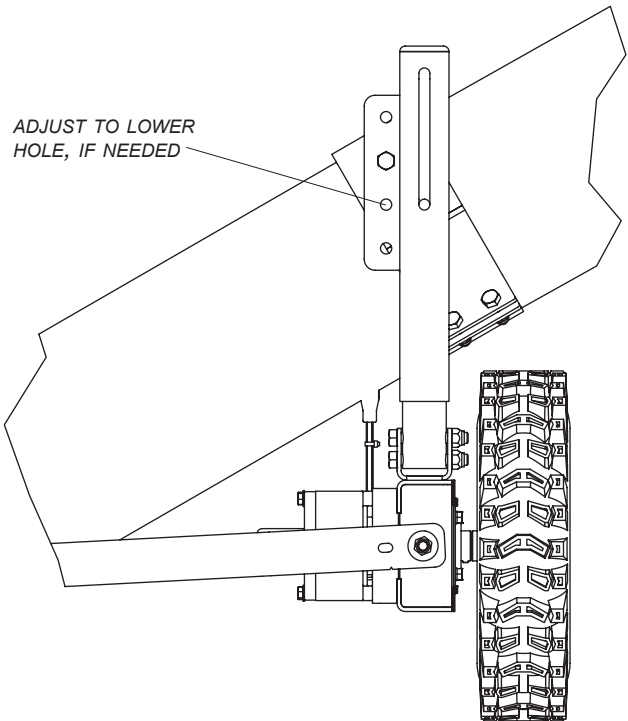

**NOTE:** Next two steps for 13", 14" and 16" augers only.

**STEP 11:** Lower main beam down to wooden blocks. Adjust left side jack so it is extended to same length as righthand jack.

Adjust jack height until holes in jack plate and tube band jack mount align. If holes will not align, match drill a 1/2" hole in tube band jack plate using jack plate as guide.

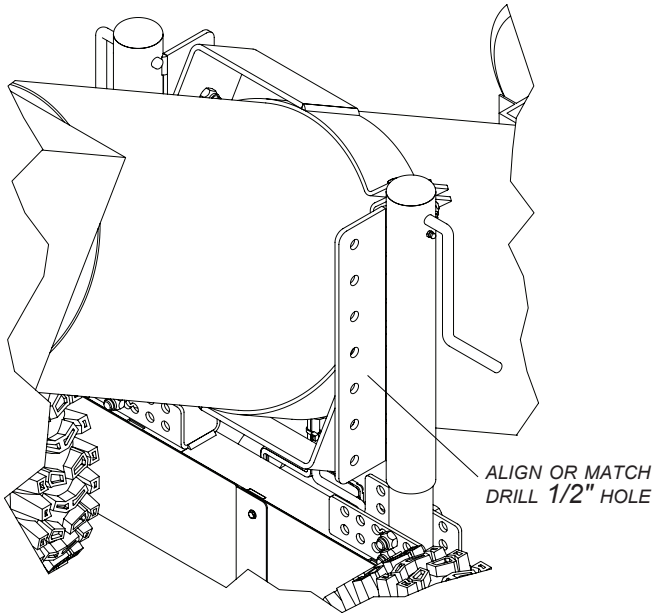

**STEP 12:** Secure jack plate to tube band jack mount using hex bolt **C**, two flat washers **K** between tube band jack mount and jack plate and nylon nut **I**. Tighten nylon nut, then back off 1/4 turn.

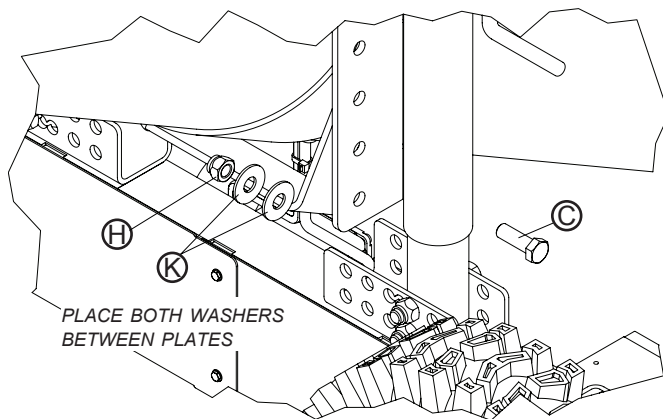

**STEP 13:** Remove wood block and lower drive wheels to ground.

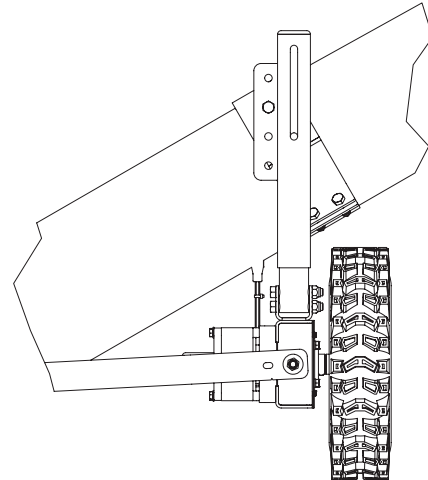

**STEP 14:** Drill 3/8" thru hole using slot as guide. Hole should be centered on flat side of motor mount bracket.

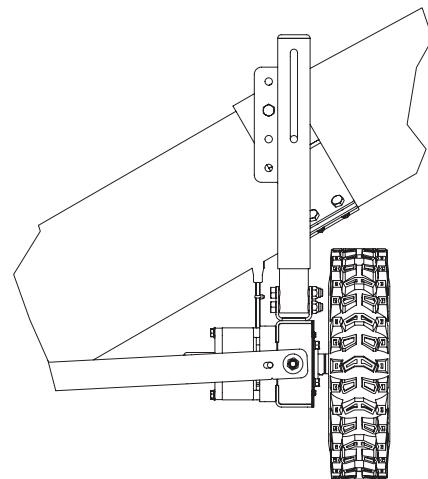

**STEP 15:** Secure brace using 3/8" bolt **I**, flat washer **J** and nut **G**. Repeat step 14 and 15 for both sides.

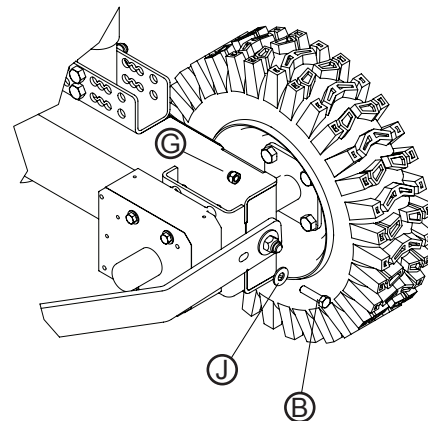

Item	Part #	Description
1.	1128584	Control Panel Mounting Plate
2.	1128576	Control Assembly SMART2™ w/SMART2™ LiteALL™
3.	1128575	Control Assembly SMART3™ w/SMART3™ LiteALL™
3.	1128572	LiteALL™ w/Magnetic Mount
A.	1704308	Flanged Screw - #10 x 1/2"
L.	1706376	Hose Clamp Fastener Set
M.	1703231	Cable Tie - 8"
N.	1705977	Cable Tie - 60"
Q.	1704751	Wire Harness Lock Pin

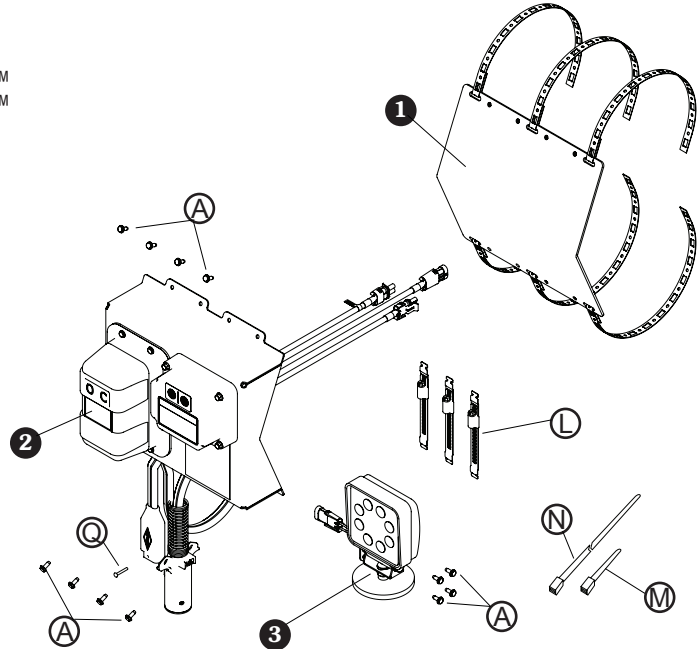

**STEP 1:** Place control panel mounting plate on auger tube and wrap bands around tube so they overlap.

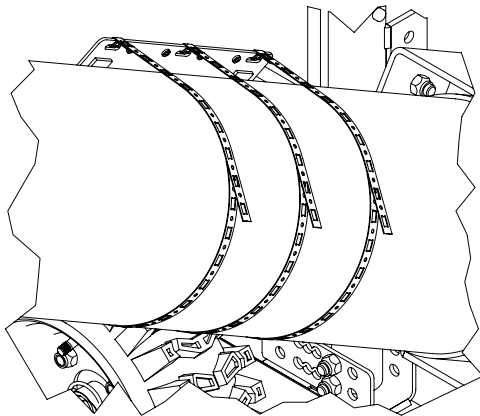

**STEP 2:** Trim top bands with an aviation snip at holes so new end is approximately 1-1/2" above center line of tube.

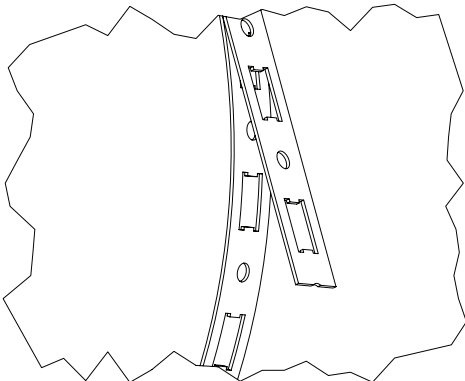

**NOTE:** Overlap is acceptable, but if bands do not overlap, a max gap of 4-1/2" is acceptable between edges of two closest square holes.

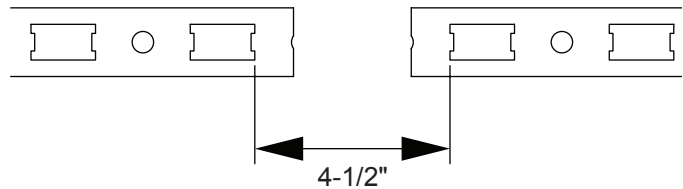

**STEP 3:** Insert screw half of hose clamp fastener (L) into last square of upper bands.

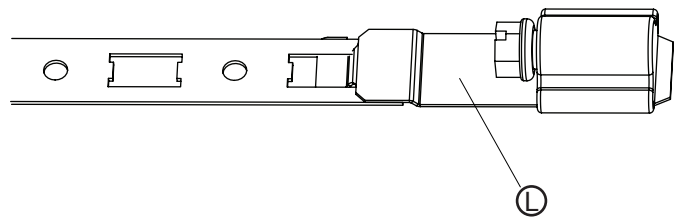

**STEP 4:** Insert slotted half of hose clamp fastener ① into square hole of lower bands, approximately 3-1/5" from end of screw half of hose clamp fastener ②.

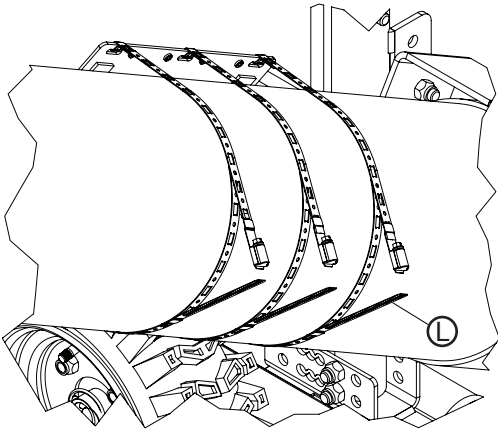

**STEP 5:** Insert end of slotted fastener into end of screw fastener and tighten each of three bands.

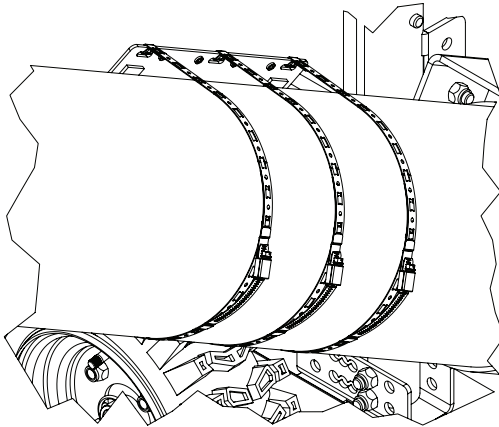

**NOTE:** Verify location of control panel will not interfere with storage of swing auger onto side of main auger tube. Adjust accordingly, if necessary.

**STEP 6:** Insert WeatherPack™ end of LiteALL™ into open hole of bottom of control panel and secure with flange screws ④.

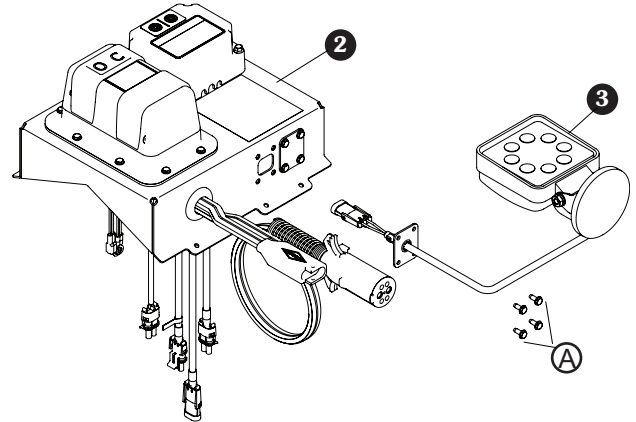

**STEP 7:** Plug LiteALL™ into mini-module wire.

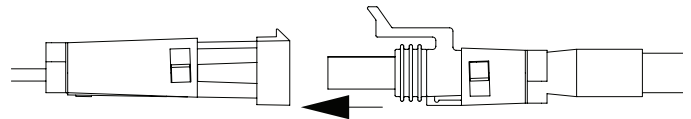

**STEP 8:** Mount control panel ② to control panel mounting plate ① with eight flange screws ④.

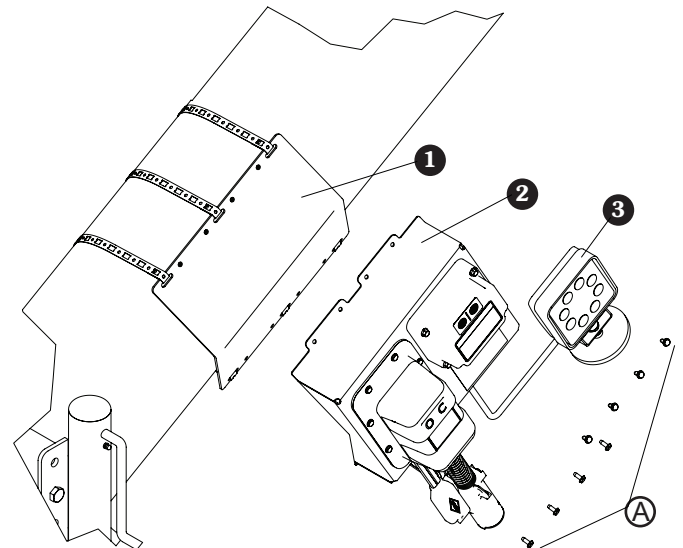

**STEP 9:** Run SMARTwire™ from rear of control box under swing auger tube and plug female end into male end.

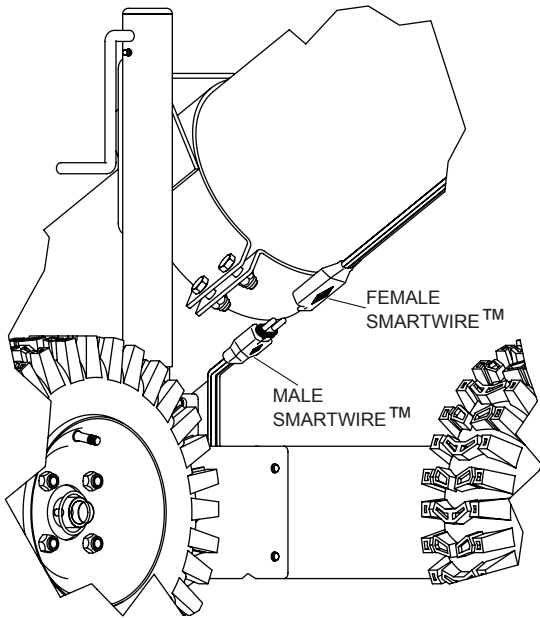

**STEP 10:** Secure SMARTwire™ to auger tube using 60" cable tie (N), leaving enough slack so auger hopper can be raised off ground without putting tension on plug or tie.

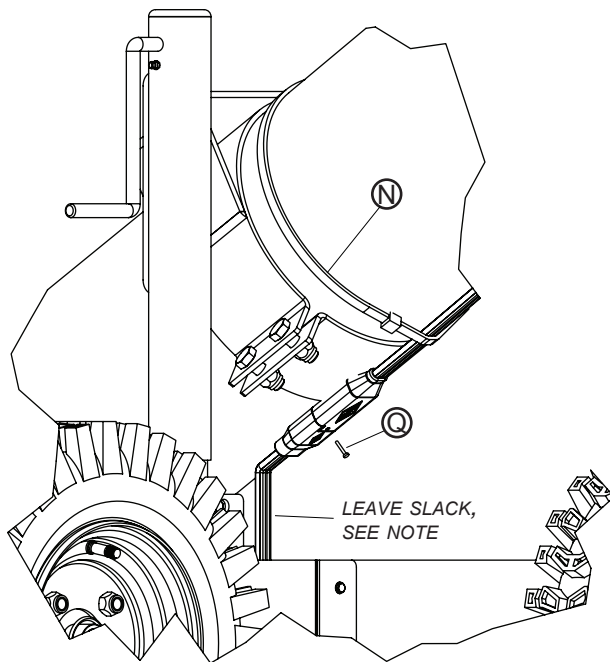

**NOTE:** Turn handle on jack so it is in fully extended position to ensure enough slack in wire before securing with cable ties.

**STEP 11:** Working up swing auger tube, gently pull SMARTwire™ snug (under swing auger tube) and secure with 60" cable tie (N) at center of tube between first cable tie and discharge box.

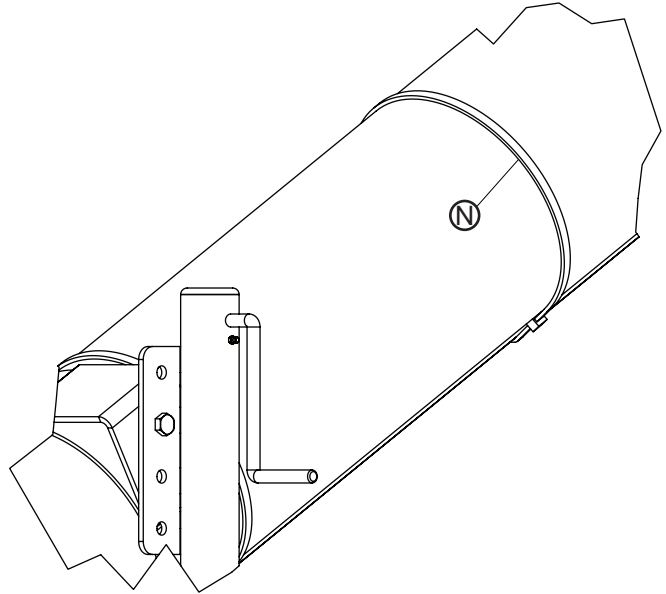

**STEP 12:** Bind excess wire with 8" cable ties (M).



**CAUTION**

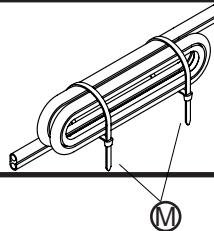

Do not cut SMARTwire™. Bind excess wire with cable ties.

Item Part #	Description
1. 1705998	Danger - Pinch Point
2. 1706000	Danger - Automatic Movement



**STEP 1:** Turn jack handle raising drive wheels off ground and push swing auger so swing auger tube and main auger tube are next to each other.

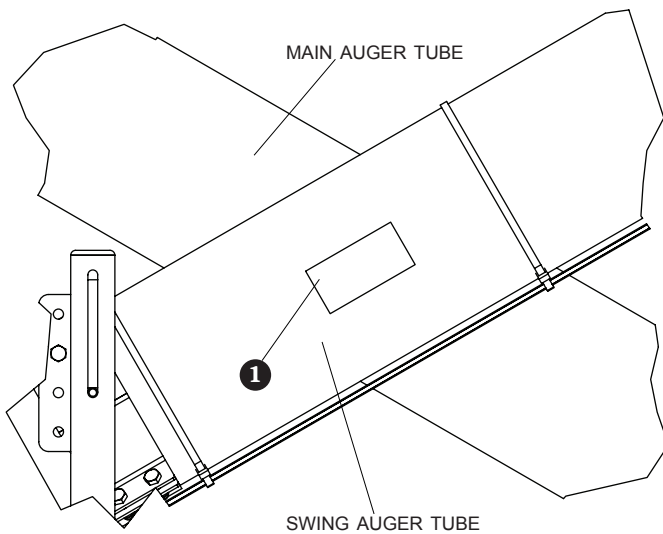

**STEP 2:** At location where tubes cross, install four Danger - Pinch Point decals on both sides of tubes.



**STEP 3:** Place Danger - Automatic Movement decal on outside of end and both sides of swing auger hopper.

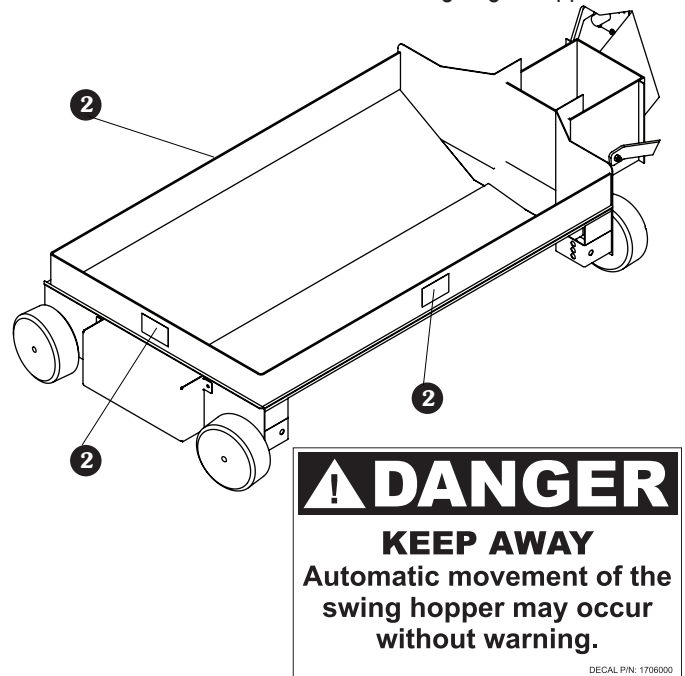

**OPERATION INSTRUCTIONS**

1. Plug male 2-pole connector into female 2-pole connector on tractor. Route SMARTwire™ so it will not be driven over.
2. Caution: Always verify path of swing auger is clear of obstacles and people before operation.
3. Stand clear of path of swing auger. Use remote of control box to activate motors and verify direction of travel. If swing auger direction of travel is not correct, remove auger control cover and switch green and yellow wires on solenoid.
4. When direction of travel has been verified, run swing auger in both directions, verifying it moves freely and along intended work path.

**NOTE:** If DriveMaxx™ wheels spin but do not move swing auger, turn jack handle to lower wheels to increase traction.

# MORE QUALITY PRODUCTS FROM SHUR-CO®

---

- Genuine Replacement Tarps
- Genuine Replacement Parts
  
- Agriculture Products
  - *The Original Shur-Lok*®
  - Turning Point™ Bow
  - Shur-Lok® Junior
  - Premium Belt 'n Ratchet
  - Cable-Lok™
  - Tater-Top™
  
- SMARTrailer™ Accessories for Agriculture Products
  - SMART2™ Remote
  - SMART3™ Remote
  - 4500 Series HD Electric
  - Electric Shur-Lok®
  - AutoTrap™ Hopper Opener
  - ProTrap® Hopper Opener
  - Electric Gate & Hoist
  - DriveMaxx™ Auger Drive
  - Electric Farm Swing Gate
  - LiteALL™ Work Lights
  - Cable-Lok™ Electric Upgrade
  - Electric Turning Point™ Bow
  - Solar Power Pack
  - Tater-Top™ Electric
  - Service Truck Power Kit
  
- Construction Products
  - *The Original Shur-Lok*®
  - Turning Point™ Bow
  - Shur-Trak II™
  - IronSide II™
  - Shur-Matic™
  
- SMARTrailer™ Accessories for Construction Products
  - 4500 Series HD Electric w/Gate Flex™
  - Shur-Trak II™ Electric Upgrade
  - Electric Turning Point™ Bow
  - Solar Power Pack
  
- Custom Products
  - Fitted Truck Covers
  - Flat Utility Tarps
  - Bean Drill Covers
  - Gustbuster™ Tarp Cords
  - SMARTwire™