



TARPING SYSTEMS & ACCESSORIES

P/N 1127551 Rev. A

OWNER'S MANUAL

LITEALL

TM

WIRELESS LED WORK LIGHT



SMART3TM Remote

READ BEFORE INSTALLING

PO BOX 713 ■ 2309 SHUR-LOK STREET ■ YANKTON, SD 57078-0713
PHONE 1-800-4-SHUR-LOK (1-800-474-8756) ■ FAX 605-665-0501
www.shurco.com

SHOP ONLINE: www.shopshurco.com

SHIPPING. Orders are shipped F.O.B. from the Shur-Co®, LLC sites listed below. No full freight is allowed or prepaid shipment accepted unless quoted and approved in writing prior to acceptance of the order. All shipments are made by the most reasonable means in accordance with size and weight of order, unless specified routing instructions are furnished by the customer. Shipments are made daily via U.P.S. and common carrier. Claims for shortages must be made within 10 days. All claims for damages or loss in transit must be made with the carrier. No collect calls will be accepted. To ensure delivery of orders, we need your full street address and phone number. When you receive your shipment, examine it carefully. Be sure all cartons listed on the delivery sheet are accounted for. Large items may be packaged separately. If a carton is damaged, open it and inspect the contents before signing for delivery. If merchandise is damaged, describe damage on the delivery receipt. Failure on your part to document damaged or missing merchandise on the delivery receipt releases the carrier of all liability; repair or replacement will be the customer's responsibility.

WARRANTY. We warrant all new products are free of defects in materials and workmanship.* This warranty is effective if products are properly installed and used for the purpose for which they were intended and applies to the original buyer only. Except as set forth above or in any product-specific warranty documentation, we make no other warranties, express or implied, including but not limited to warranties of merchantability of fitness for a particular use.

Returns of a product for warranty must be accompanied by a Return Merchandise Authorization number (RMA#), obtained by calling Customer Service at 866-748-7435, and sent, with freight paid by us, to Shur-Co®, LLC, 2309 Shur-Lok St., PO Box 713, Yankton, SD 57078. All products returned without an RMA# will be refused. When we issue the RMA#, we will also issue a call tag to have UPS (or other freight company) pick up the product. C.O.D. returns not accepted. We will pay no storage fees for a warranty product return prior to pick by us or the freight company. If a warranty product return is scheduled to be picked up by us, we will pick up the product at our earliest convenience.

If a product returned is found, in our judgement, to be defective in material or workmanship, our obligation under this warranty is limited to the repair or replacement of the product, which will be made by us. Repair or replacement will be at our discretion, with replacements being made using current products performing in the equivalent function. Labor charges, other than those incurred at our factory, including, but not limited to, any labor to install a repaired or replacement product, are not covered under this warranty. All expenses associated with delivering defective products to our factory and delivering repaired or replacement products from our factory to the owner will be paid by us.

If the product returned is found, in our judgement, to be non-warrantable, the owner will be contacted to authorize repair work, purchase of a replacement product or return of the product, all of which will be at the owner's expense. Payment authorization must be received by us before any non-warrantable product is repaired, replaced or returned. All expenses associated with delivering the repaired non-warrantable product, a replacement product or the non-warrantable product from our factory to the owner will be paid by the owner.

In no event will we be liable for any damages of any kind to person, product or property, including but not limited to indirect, incidental, special, consequential or punitive damages, or damages for loss of profits or revenue, even if we have been advised of the possibility of such damages. There are no warranties for used products or products that have been repaired, altered, modified or subjected to misuse, negligence or accident. We will not repair or replace products that fail or malfunction due to ordinary wear and tear, except as expressly noted in a product-specific warranty. Use of non-Shur-Co®, LLC parts in conjunction with Shur-Co®, LLC products will void this product warranty.

*Certain products have specific warranties that differ from this warranty, for example motors and electronics. Product-specific warranty documentation is available for these items. In the event of a conflict between this warranty and a product-specific warranty, the product-specific warranty will govern.

RETURN POLICY. All sales final. See WARRANTY above for return details.

OTHER. All prices, product listings, sizes, weights and manufacturing details are subject to change without notice. No person is authorized to modify the foregoing conditions of sale whatsoever.

SHUR-CO®, LLC SERVICE AND DISTRIBUTION CENTERS

Corporate HQ and Outlet Store

SHUR-CO® of SOUTH DAKOTA
 2309 Shur-Lok St., PO Box 713
 Yankton, SD 57078-0713
 Ph 800.474.8756 | Fax 605.665.0501

ShurTite™ Service Centers

SHUR-CO® of CANADA
 490 Elgin St., Unit #1
 Brantford, Ontario N3S 7P8
 Ph 800.265.0823 | Fax 519.751.3997

SHUR-CO® of SIOUX FALLS
 47184 258th St., Suite B
 Sioux Falls, SD 57107
 Ph 844.573.9322 | Fax 605.543.5469

SHUR-CO® of ILLINOIS
 Ph 866.356.0246 | Fax 217.877.8270

SHUR-CO® of OHIO
 Ph 866.356.0242 | Fax 330.297.5599

SHUR-CO® of COLORADO
 10220 Brighton Rd., Unit #1
 Henderson, CO 80640
 Ph 866.355.9173 | Fax 303.289.2298

SHUR-CO® of FLORIDA
 3353 SE Gran Park Way
 Stuart, FL 34997
 Ph 800.327.8287 | Fax 772.287.0431

SHUR-CO® of ILLINOIS
 3993 E. Mueller Ave.
 Decatur, IL 62526
 Ph 866.356.0246 | Fax 217.877.8270

SHUR-CO® of IOWA
 3839 Midway Blvd.
 Ft. Dodge, IA 50501
 Ph 866.356.0245 | Fax 515.576.5578

SHUR-CO® of MICHIGAN
 5100 Lakeshore Dr.
 Lexington, MI 48450
 Ph 800.327.8287 | Fax 772.287.0431

SHUR-CO® of NORTH DAKOTA
 1746 4th Ave. NW
 West Fargo, ND 58078
 Ph 877.868.4488 | Fax 701.277.1283

SHUR-CO® of OHIO
 1100 N. Freedom, St. Rt. 88 & 14
 Ravenna, OH 44266
 Ph 866.356.0242 | Fax 330.297.5599

SHUR-CO® of TEXAS
 34505 I-10 West, S. Frontage Rd.
 Brookshire, TX 77423
 Ph 866.689.0039 | Fax 281.934.3311

SHUR-CO® UK, Ltd.
 Unit 41 Rochester Airport Estates
 Laker Rd., Rochester, Kent ME1 3QX
 Ph +44 (0)1795.473499
 Fax +44 (0)871.272.8278

For more info, log on to our website:
www.shurco.com

MESSAGE TO OWNERS

Thank you for buying this product from Shur-Co®. We appreciate your confidence in our products. Please read and thoroughly understand this manual before installing and/or operating this system.

Pay particular attention to important safety and operating instructions, as well as warnings and cautions. The hazard symbol  is used to alert users to potentially hazardous conditions and is followed by caution, warning or danger messages.

Failure to READ AND FOLLOW INSTRUCTIONS could result in failure of your system and/or personal injury. Your trailer requirements may, however, call for minor variations to these instructions.

Please inspect your system periodically. Repair or replace worn or damaged parts to your system.

QUESTIONS? CALL OUR HELP LINE:

1-866-748-7435

MON-FRI 8 AM-5 PM CENTRAL TIME

SAFETY

We at Shur-Co® are concerned with your safety and the safety of all those operating this system. Therefore, we have provided safety decals at various locations on your system. Keep decals as clean as possible at all times. Replace any decal that has become worn or damaged, painted over or otherwise difficult to read. Replacement decals are available through Shur-Co® dealers.

SAFETY INSTRUCTIONS

- 1. Always wear safety glasses during installation.**
- 2. Keep body and clothing clear of moving parts.**
- 3. No other use of this system is authorized, except as designed.**

TABLE OF CONTENTS

SMART3™ LiteALL™ Features & Operation 1

SMART3™ LiteALL™ System Components 2

LiteALL™ Control Module Installation 3-4

LiteALL™ Work Light Installation 5-6

Programming SMART3™ Remote to Control Module 7

Electric Wiring - Wiring Diagrams 8-9

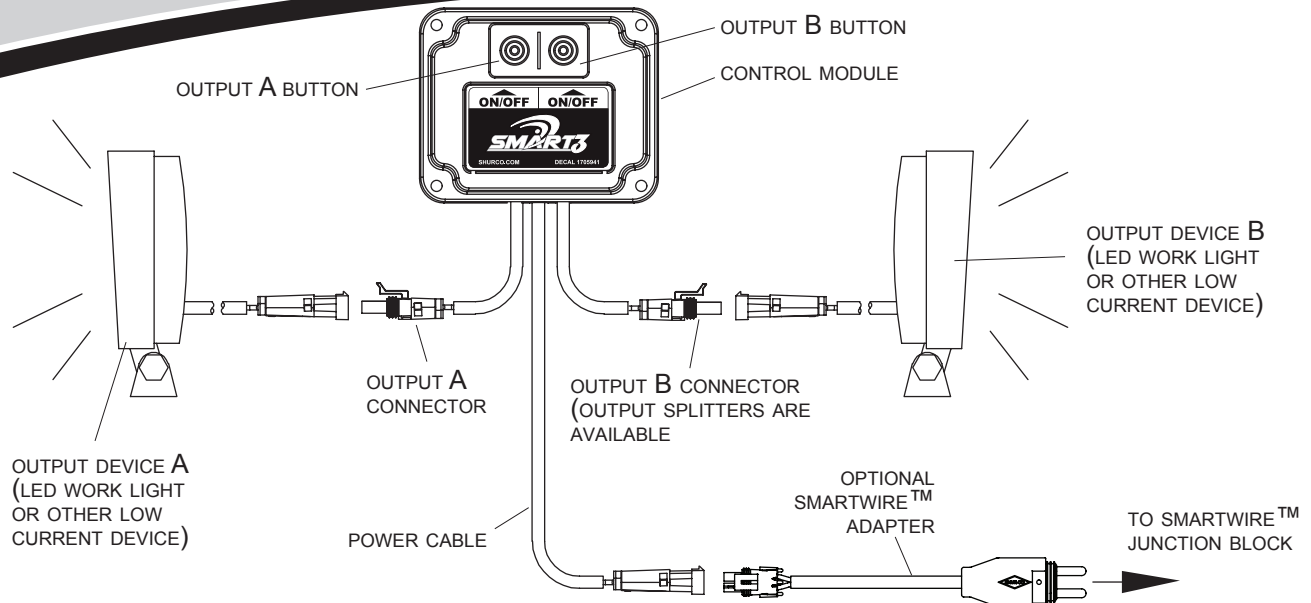

SMART3™ LiteALL™ module has been specifically designed for use with Shur-Co's exclusive SMART3™ wireless remote. Module has two outputs which operate independently using integrated push buttons or SMART3™ remote.

Utilizing optional output splitters, up to four high-intensity Shur-Co® LED work lights can be connected. Also available are output extension cables, conveniently allowing high-intensity LED work lights to be mounted where needed. SMART3™ LiteALL™ is a valuable addition to Shur-Co's SMARTrailer™ lineup.

- SMART3™ LiteALL™ control module has two independent output channels which can be controlled with a SMART3™ remote or integrated push buttons.
- Output splitters are available, allowing up to four high-intensity LED work lights to be connected.
- Extension cables are available, allowing convenient and useful mounting options for work lights and other devices.
- Control module is quick and easy to introduce to an additional SMART3™ remote.

Specifications

- System voltage: 10 to 16 volts DC
- System current: 5 amps maximum (four) Shur-Co® LED work lights
- Reverse polarity protection: Yes
- Work light output: 1600 lumens
- Work light power: 24 watts
- Work light IP rating: IP67
- Work light life: 30,000 hours estimated

SMART3™ LITEALL™ OPERATION

- When SMART3™ LiteALL™ module is connected to 12-volt power source, outputs can be turned on manually or with a paired SMART3™ remote.
- To manually control module, simply press OUTPUT A button on module to toggle device(s) connected to OUTPUT A channel. Press OUTPUT B button on module to toggle device(s) connected to OUTPUT B channel.
- To remotely control LiteALL™ module after it has been introduced to SMART3™ remote, select the channel on the remote that was paired to the LiteALL™ module. Refer to section on programming remote to control module for more information.

Press left operational button labeled Open/On to toggle device(s) connected to OUTPUT A on and off. Press right operational button labeled Close/Off to toggle device(s) connected to OUPUT B on and off.

A 1127598 SMART3™ LiteALL™ Control Module

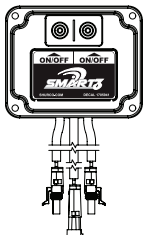

B 1122706 LED Work Light - 24 Watt (w/WeatherPack Connector)

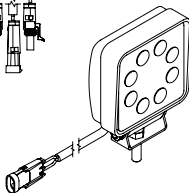

C **1126867 SMART3™ Remote Kit**
 SMART3™ Transmitter
 1705940 SMART3™ Operation Labels

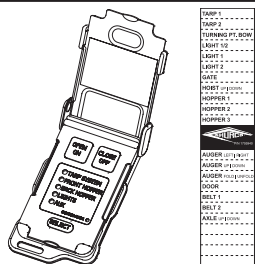

D 1122704 Extension Cable - 20' (w/WeatherPack Connector)

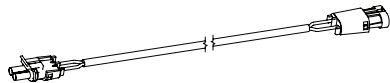

E 1122705 LiteALL™ Output Splitter (w/WeatherPack Connector)

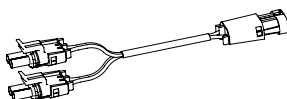

F 1122690 SMARTwire™ Power Cable Adapter (w/WeatherPack Connector)



G **1120849 Junction Block Kit w/Harness Plug**

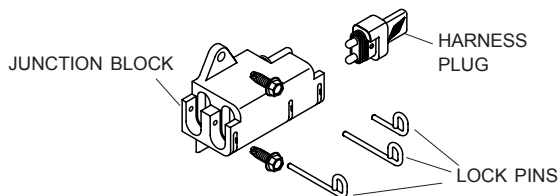

H 1120670 SMARTwire™ Dual-Conductor Socket

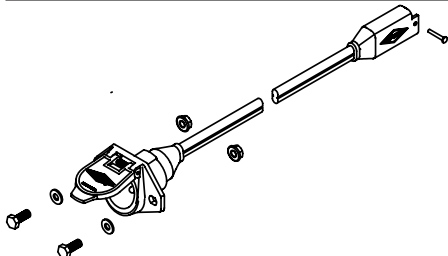

1127546 Hardware Bag

SMART2™ LiteALL™ Module Mounting Hardware (Included With Replacement Module P/N 1127810)



1704405 Pan Hd. Self-Drilling Screw - #8 x 3/4" (qty. 6)



1706007 Hex Head Self-Drilling Screw #12 x 1-1/2" (qty. 4)



1704699 Nylon Wire Clip - 5/16" Natural (White) (qty. 6)



1703282 Rubber Grommet - 7/8" x 1-5/8"

1120672 Hardware Bag

LED Work Light Cable Routing Hardware (Order One w/Each Additional Work Light)



1704405 Pan Hd. Self-Drilling Screw - #8 x 3/4" (qty. 6)



1704698 Nylon Wire Clip - 1/4" Black (qty. 8)



1704397 Rubber Grommet - 7/16" x 15/16"



1703282 Rubber Grommet - 7/8" x 1-5/8"

W **1120504 LiteALL™ Junction Box Kit**

- Allows for splicing into 12-volt power and ground connection on non-SMARTwire™ 4500 Series systems (remote systems only).
- Includes 6-ga. x 1/4" stud ring terminals (qty. 4) and 3' 6-ga. wire.

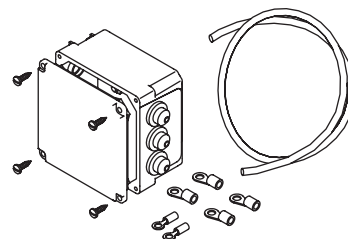

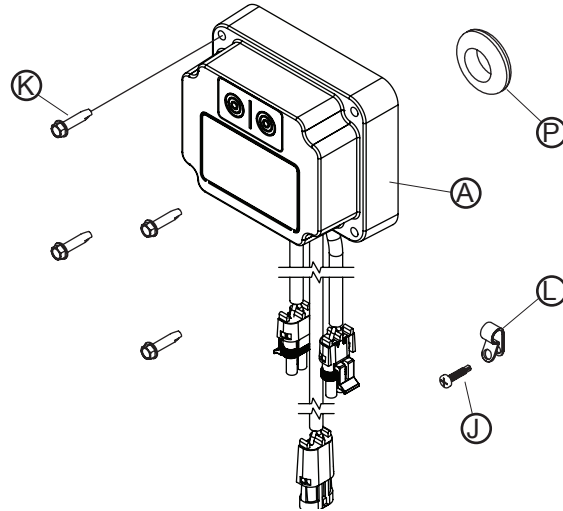

Item Description

- A. Control Module
- J. Pan Head Self-Drilling Screw #8 x 3/4"
- K. Hex Head Self-Drilling Screw - #12 x 1-1/2"
- L. Nylon Wire Clip - 5/16" Natural
- P. Rubber Grommet - 7/8" x 1-5/8"

STEP 1: Review wiring diagram. Determine mounting location for LiteALL™ control module. If SMART3™ remote will be used to operate module, it is recommended to locate module where user will have direct line of sight to module while operating remote.

NOTE: Keep in mind that power cable on module is 8' long and must be connected to 12 volts.

STEP 2: If power and/or output cables are to pass THROUGH mounting surface (.150" max. wall thickness), use 1-1/4" hole saw to cut hole directly behind module. Pass cables through grommet P, then insert grommet into hole.

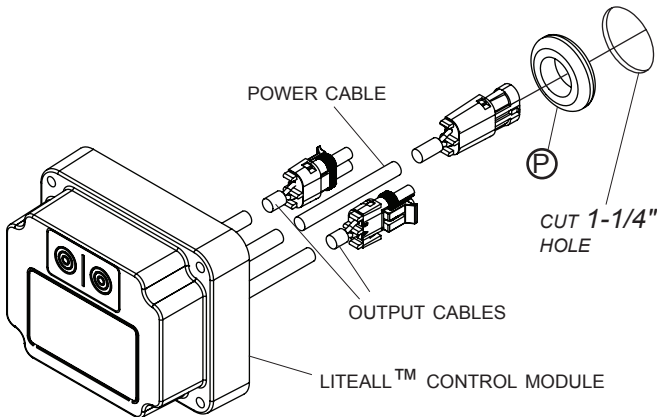

STEP 3: If power and/or output cables are NOT being routed through mounting surface, route through cutouts in bottom sidewall of LiteALL™ control module.

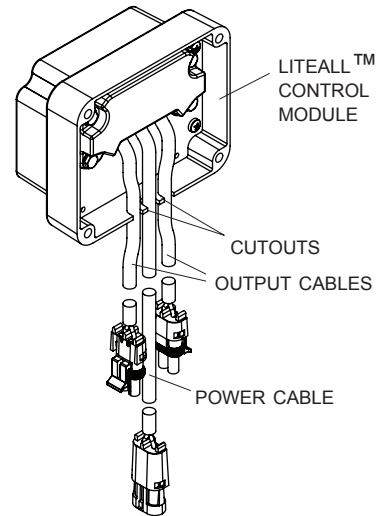

STEP 4: Fasten LiteALL™ control module to mounting surface with four self-drilling screws K.

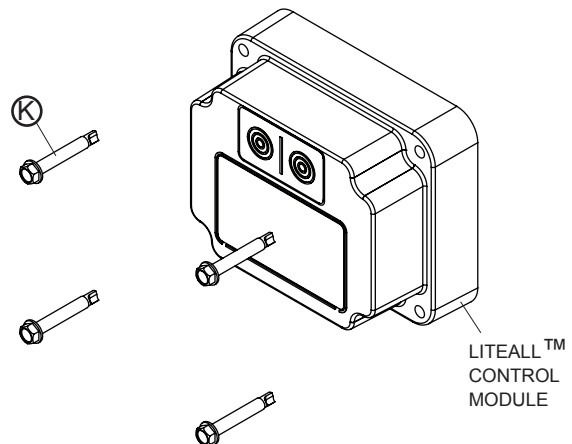

STEP 5: Route power cable from LiteALL™ module to power source. Refer to wiring diagram.

STEP 6: Disconnect power from power source. Prepare power cable for connection to power source and connect as follows:

POWER SUPPLIED FROM SMARTWIRE™ CONNECTION

- Connect LiteALL™ power cable to SMARTwire™ adapter cable.

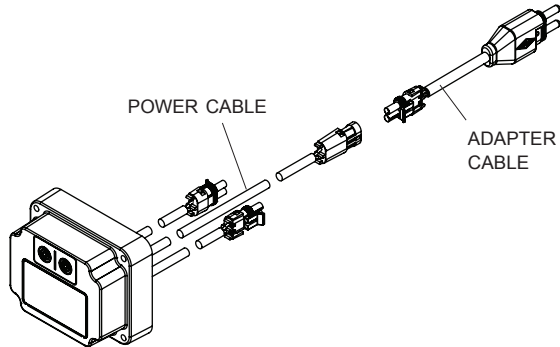

- Plug adapter cable into junction block **G** and secure with lock pins.

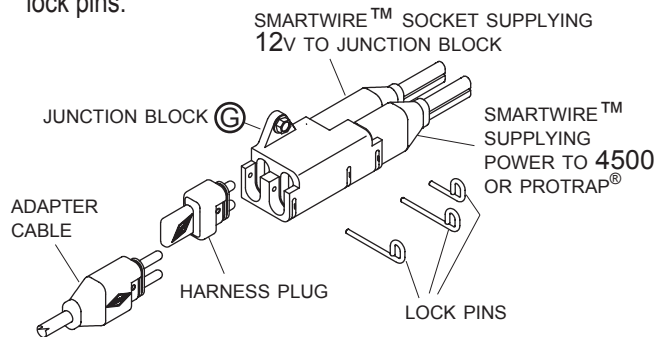

POWER SUPPLIED VIA OTHER MEANS

- White wire is positive. Connect white wire to positive 12-volt. Black wire is negative. Connect black wire to negative post.
- Do not leave power connections exposed to elements. If needed, optional sealed junction box kit **U** is available.

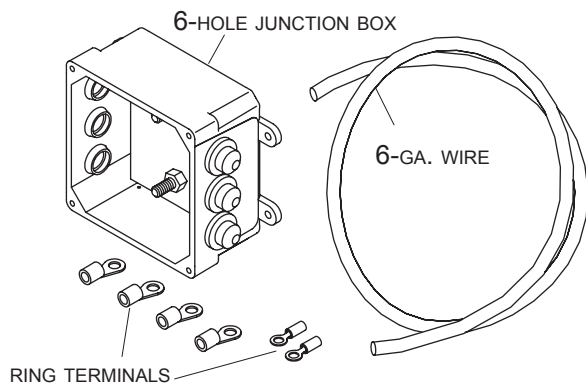

STEP 7: Use wire clips **L** and/or cable ties to secure power and output cables. Use drill and #2 Phillips bit to self-drill screws **J** and secure wire clips.

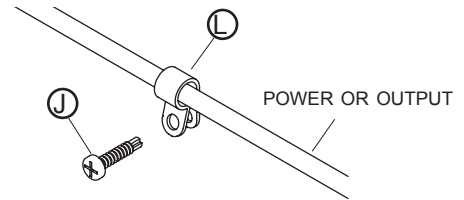

Item Description

- B. LED Work Light - 24 Watt
- D. Extension Cable - 16 Ga. 2 Conductor - 20'
- J. Pan Hd. Self-Drilling Screw - #8 x 3/4"
- M. Nylon Wire Clip - 1/4" - Black
- N. Rubber Grommet - 7/16" x 15/16"
- P. Rubber Grommet - 7/8" x 1-5/8"

HARDWARE
SUPPLIED W/
WORK LIGHT

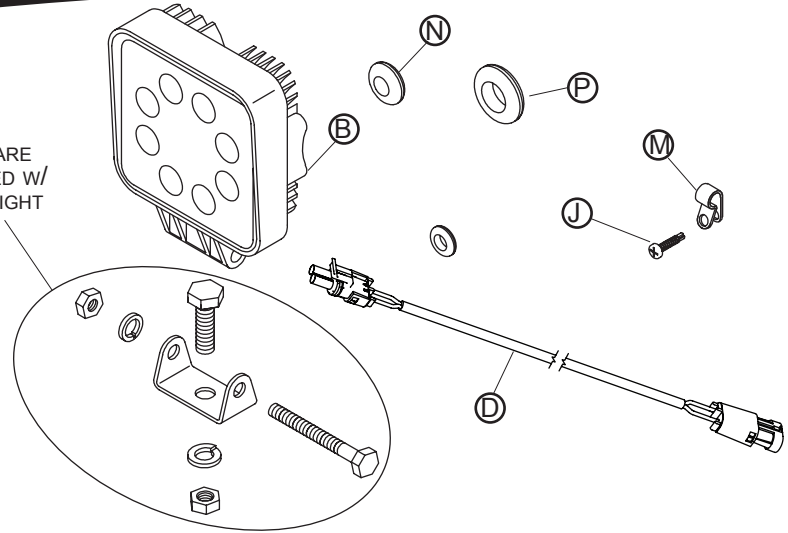

STEP 1: Use 1/2" and 9/16" combination wrenches to assemble LED work light mounting brackets. Use hardware found in LED work light boxes as shown.

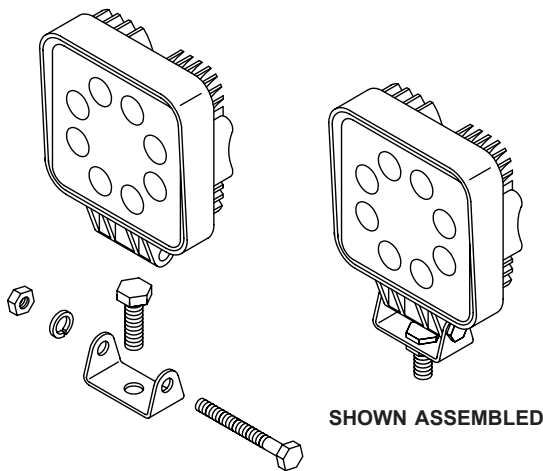

STEP 2: Drill 13/32" hole in desired location for work light mounting stud. Insert stud through hole and use 11/16" combination wrench to fasten lock washer and mounting nut.

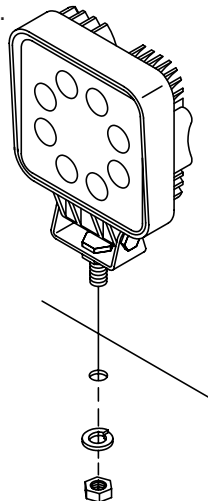

STEP 3: If work light cable is to be passed through mounting surface, use 1-1/4" hole saw to cut hole for grommet P. Thread work light cable through grommet, then insert grommet into hole.

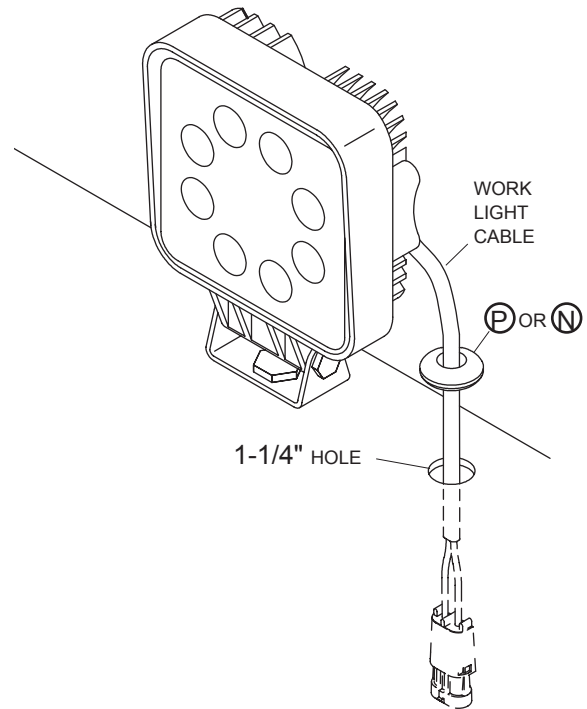

NOTE: If WeatherPack pin removal tool (Delphi P/N 12014012) is available, smaller grommet can be used. Remove plastic connector from pins, drill 11/16" hole, pass pins through grommet and drilled hole, then re-attach plastic connector (B side to black wire) and insert grommet N.

STEP 4: Route work light cable to LiteALL™ control module. Verify cable routing before securing cable. If 20' extension cable **D** is needed, route extension cable between LiteALL™ control module and work light cables.

NOTE: If needed, 20' extension cables are available (see parts list).

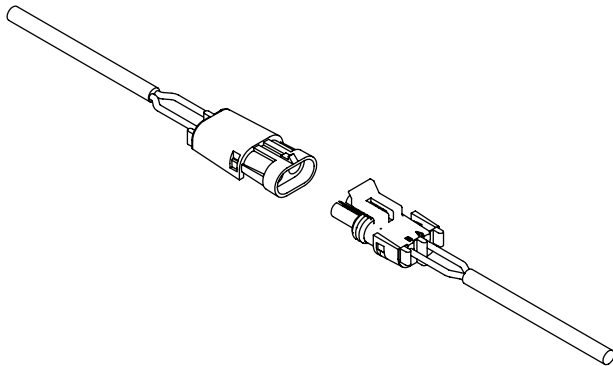

NOTICE

Do not power any Shur-Co® wireless system with battery charger alone, as this will likely cause system abnormalities and/or system malfunction. Instead, use a 12-volt truck/automobile battery to provide power to trailer.

STEP 5: Use wire clips **V** and/or cable ties to secure work light and extension cables. Use drill and #2 Phillips bit to self-drill screws **J** to secure wire clips.

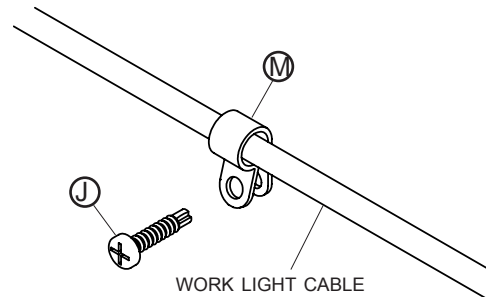

STEP 6: Coil and secure any excess cable with cable ties.

STEP 7: Repeat steps above for each additional work light. If more than one work light is to be connected to either LiteALL™ module output, insert output splitter **E**.

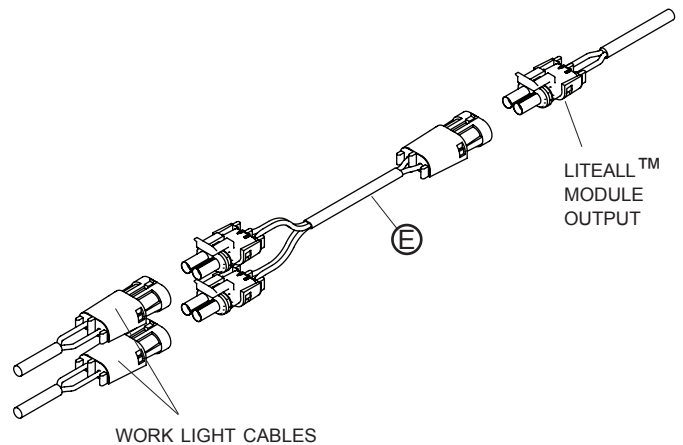

CAUTION

Disconnect LiteAll™ before welding onto truck or trailer. Failure to disconnect module may cause damage and will void warranty.

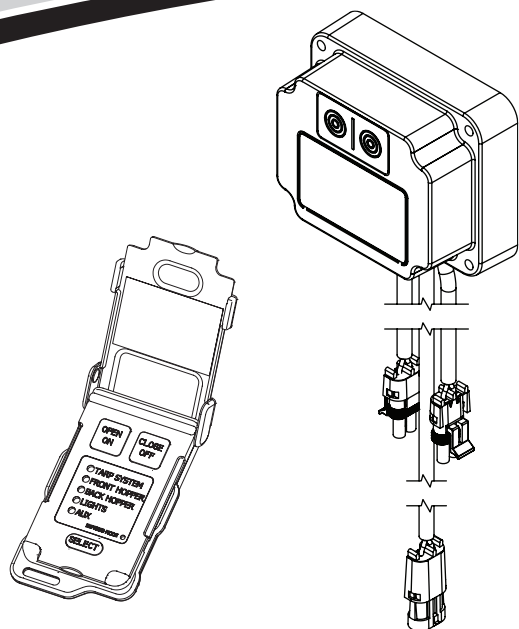

Pairing devices (introducing remote to LiteALL™):
 Before remote can operate LiteALL™ module, they must be paired, or introduced. If remote must be introduced to LiteALL™ module, or if second remote is purchased later, follow instructions below:

NOTE: Refer to SMART3™ remote Owner's Manual for complete remote instructions.

STEP 1: Connect receiver to power. Make sure target receiver is connected to 12-volt power supply. Keep remote within 20' of receiver during pairing process.

STEP 2: Prepare remote. Open remote lid and use Select button to select desired channel on remote. Set remote aside, but do not close lid.

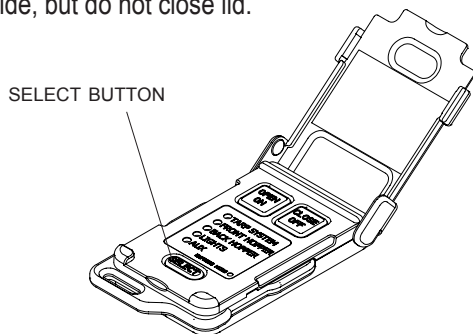

STEP 3: Put receiver into pair mode. On receiver, press and hold simultaneously both *Open* and *Close* buttons on receiver. After three seconds, you will hear buzzer beep. Release buttons. Receiver is now in pair mode.

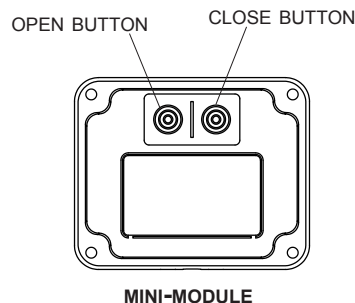

STEP 4: Put remote into pair mode. Pick up remote and press and hold simultaneously both *OPEN* and *CLOSE* buttons on remote. After three seconds, channel indicator light will go solid. Release buttons.

STEP 5: Complete pairing. Remote will now pair to receiver. If pairing was successful, receiver buzzer will beep twice. Remote can now be used to control receiver. If pairing was unsuccessful, receiver will time out of Pair Mode after 15 seconds and buzzer will beep once. Try again to pair.

STEP 6: Repeat process for any other remotes.

NOTE: When you press **OPEN** and **CLOSE** on receiver, you may hear a click from solenoid in receiver box, but outputs will not stay on while both buttons are held simultaneously.

NOTE: While in **PAIR MODE**, receiver will not turn outputs on.

**POWER SUPPLIED FROM SMARTWIRE™
(LITEALL™ WITH 4500 SERIES)**

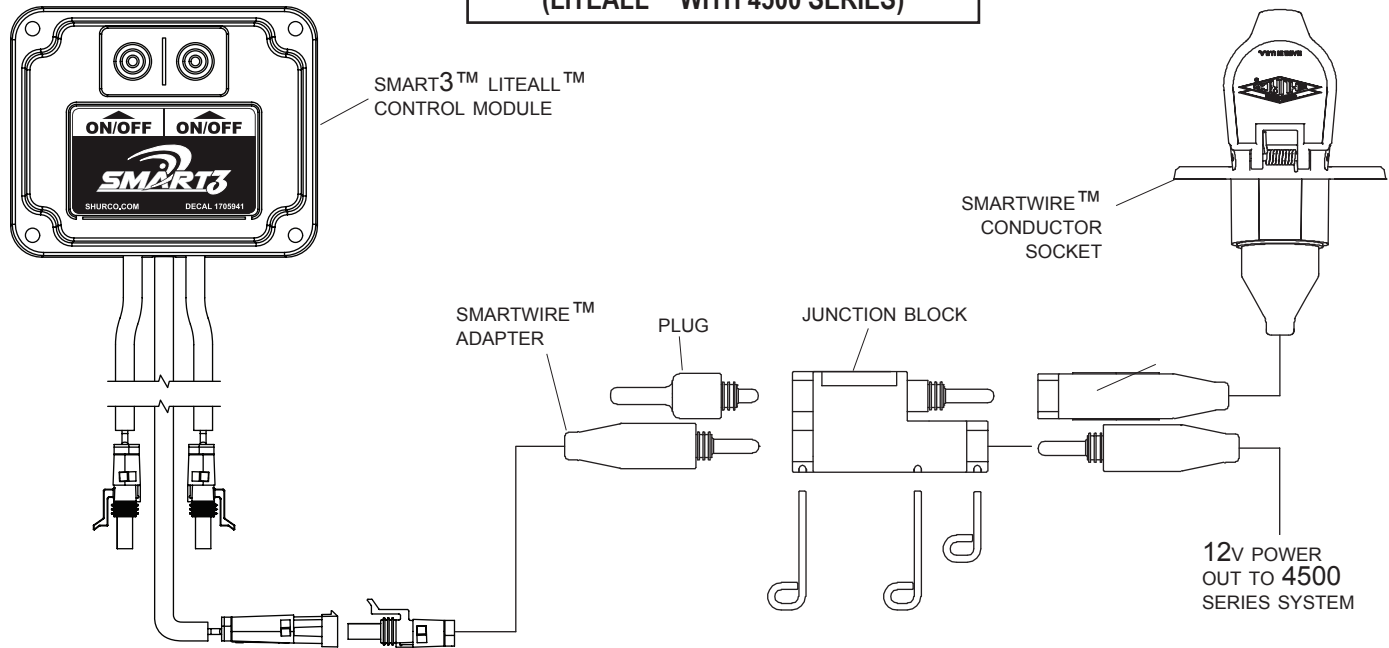

**POWER SUPPLIED FROM SMARTWIRE™
(LITEALL™ WITH PROTRAP®)**

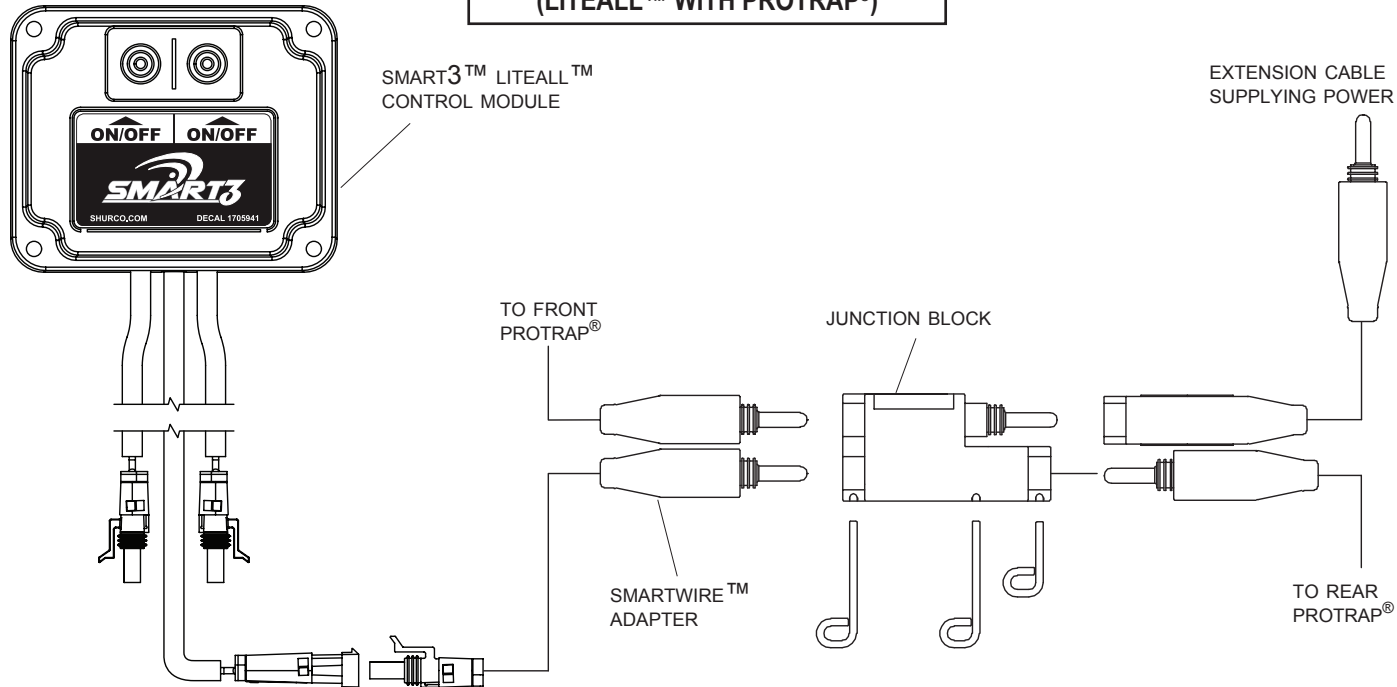

POWER SUPPLIED FROM JUNCTION BOX

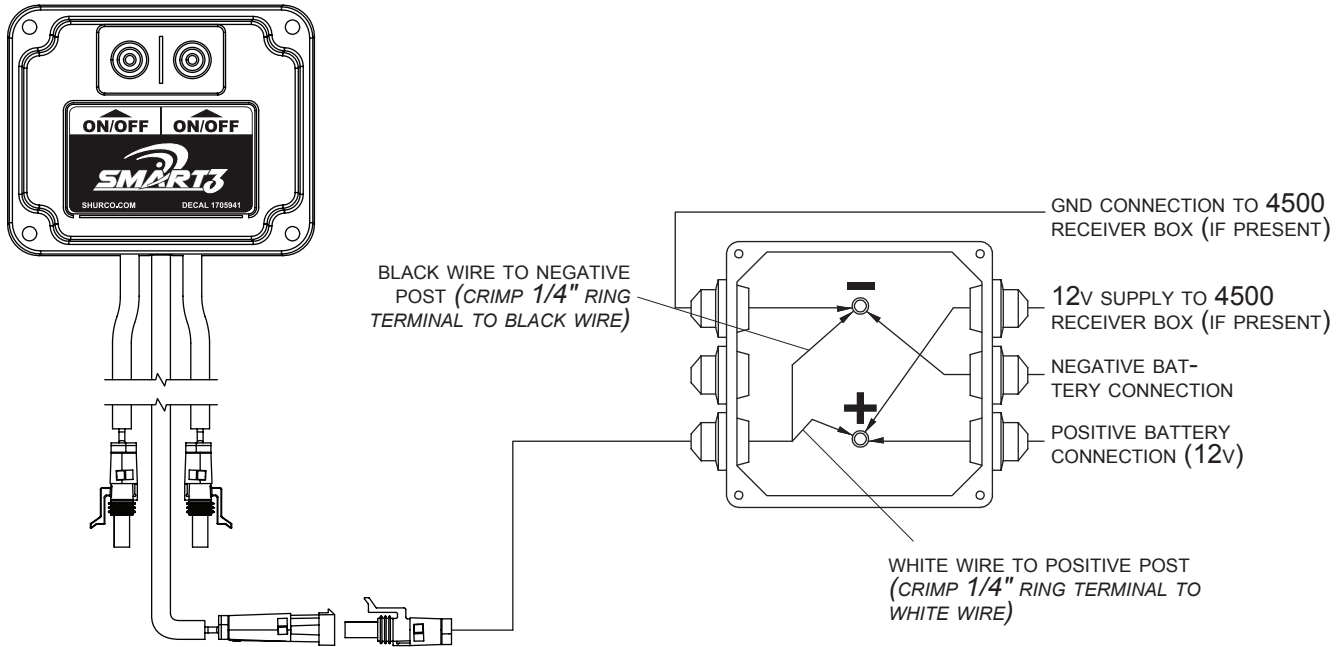

ON OTHER INSTALLATIONS, WIRING IS DETERMINED BY USER

HOOK TO POWER USING 16-GA. OR LARGER WIRE

MORE QUALITY PRODUCTS FROM SHUR-CO®

- **Genuine Replacement Tarps**
- **Genuine Replacement Parts**

- **Agriculture Products**
 - *The Original Shur-Lok®*
 - **Turning Point™ Bow**
 - **Shur-Lok® Junior**
 - **Premium Belt 'n Ratchet**
 - **Cable-Lok™**
 - **Tater-Top™**

- **SMARTrailer™ Accessories for Agriculture Products**
 - **SMART2™ Remote**
 - **SMART3™ Remote**
 - **4500 Series HD Electric**
 - **Electric Shur-Lok®**
 - **AutoTrap™ Hopper Opener**
 - **ProTrap® Hopper Opener**
 - **Electric Gate & Hoist**
 - **LiteALL™ Work Lights**
 - **Cable-Lok™ Electric Upgrade**
 - **Electric Turning Point™ Bow**
 - **Solar Power Pack**

- **Construction Products**
 - *The Original Shur-Lok®*
 - **Turning Point™ Bow**
 - **Shur-Trak II™**
 - **IronSide II™**
 - **Shur-Matic™**

- **SMARTrailer™ Accessories for Construction Products**
 - **4500 Series HD Electric w/Gate Flex™**
 - **Shur-Trak II™ Electric Upgrade**
 - **Electric Turning Point™ Bow**
 - **Solar Power Pack**

- **Custom Products**
 - **Fitted Truck Covers**
 - **Flat Utility Tarps**
 - **Bean Drill Covers**
 - **Gustbuster™ Tarp Cords**
 - **SMARTwire™**

TARPING SYSTEMS & ACCESSORIES

