

Item Part # Description

- 1. 1128281 LED Light
- 2. 1128280 Switch
- 3. 1706208 Switch Boot
- 4. 1705154 10-Amp Fuse
- A. 1704187 Lock Nut - 1/2" NPT
- B. 1703231 Cable Tie - 8"

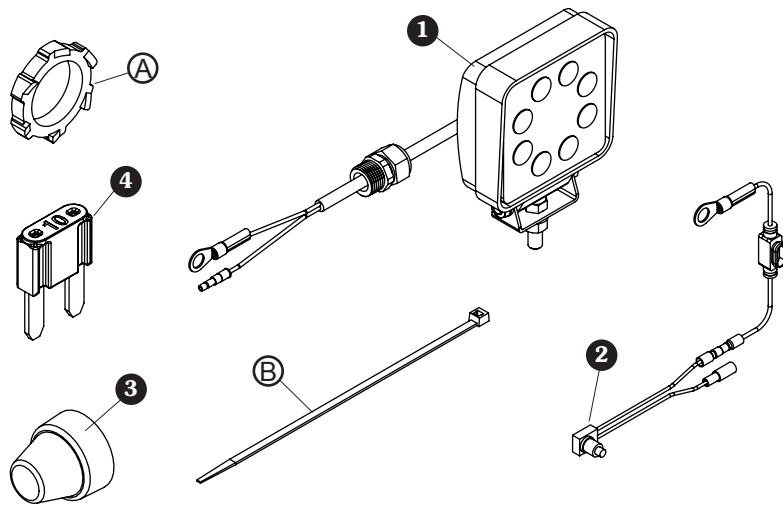

STEP 1: Remove cover from battery box. Remove 7/8" and 3/8" plugs from rear of battery box.

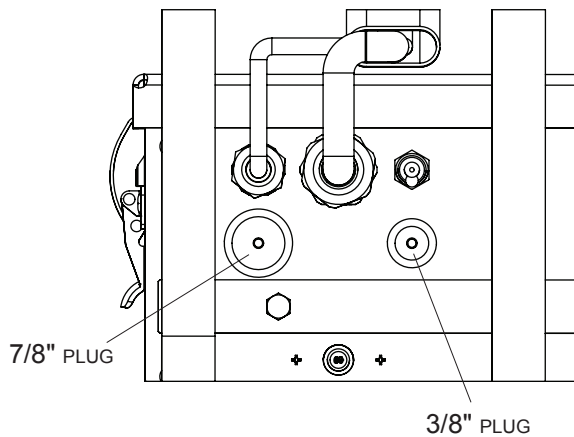

STEP 2: Install light to TrapAdapt™ cart. Secure with lock washer and nut.

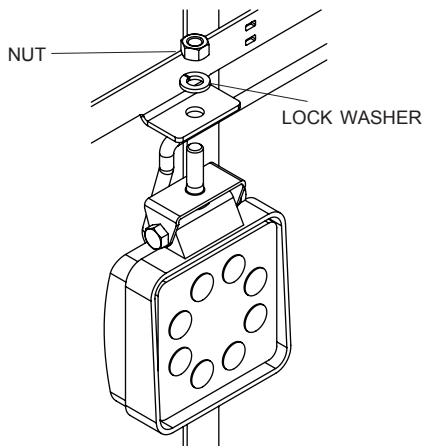

STEP 3: Route LiteALL™ wire along brace and down cart leg. Insert ends of wire through 7/8" hole and secure dome nut in hole using 1/2" NPT lock nut A.

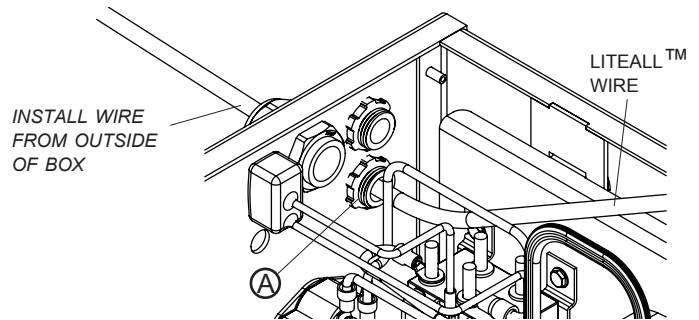

STEP 4: Remove slack from wire using cable ties B securing wire to light mounting bar and cart down tube.

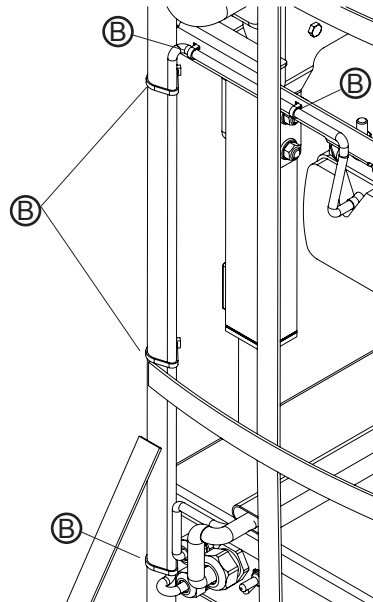

STEP 5: Install 10-Amp fuse into fuse holder on switch wire assembly. Seal using fuse holder cover.

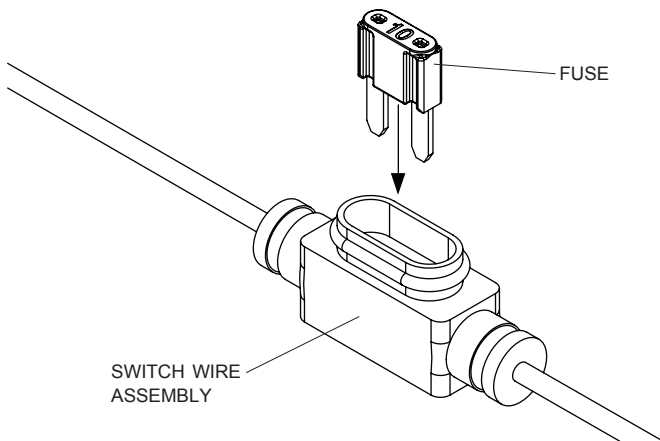

STEP 6: Install push button into 3/8" hole. Screw switch boot over switch to secure push button to battery box.

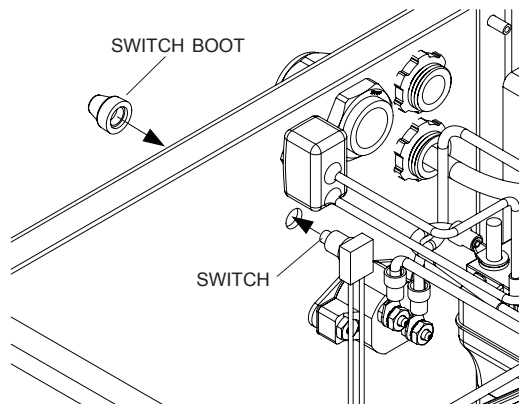

STEP 7: Plug male quick-disconnect into female quick-disconnect.

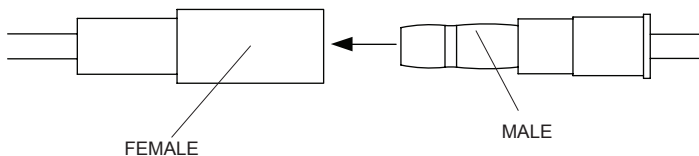

NOTE: If necessary, use pliers to gain additional grip on plug ends to ensure male plug is inserted completely into female plug. Leaving a gap could lead to shorting out of wires.

STEP 8: Secure block (-) ring terminal to negative (-) threaded battery terminal. Secure red (+) ring terminal to positive (+) threaded battery terminal.

STEP 9: Press push button switch. LED light should turn on and off. Replace battery box cover.

NOTE: If light does not turn on, confirm fuse is installed correctly and not blown. Ensure positive (+) ring (from switch) and negative (-) ring (from light) are connected to correct threaded battery post.