

# THE REAL VALUE OF QUALITY.

## YOUR CURRENT DOWNTIME COSTS

Estimated Revenue Lost Per Breakdown

	ESTIMATED COSTS	YOUR COSTS
Revenue Lost From Downtime Per Day:	\$2,000	\$ _____
Revenue Lost From Downtime Per 5-Day Period:	\$10,000	\$ _____
Freight for Replacement Parts:	\$500	\$ _____
Repair and Installation:	\$500	\$ _____
<b>Total Revenue Lost Per Breakdown:</b>	<b>\$11,000</b>	<b>\$ _____</b>
Revenue Lost From Downtime 2x Per Year:	\$22,000	\$ _____
Revenue Lost From Downtime 3x Per Year:	\$33,000	\$ _____

## INVEST IN UPTIME. INVEST IN SWAT®.

This information is an estimation of yearly revenue lost per breakdown of a typical roll-off truck tarp system. SWAT® is not your typical roll-off truck tarp system.

POWERED BY: SHUR-CO®

**SWAT**<sup>®</sup>  
PREMIUM ROLL-OFF TARP SYSTEM  
POWERED BY: SHUR-CO

## QUALITY COUNTS.

PREMIUM SOLUTIONS FOR 12' – 22'  
ROLL-OFF CONTAINERS

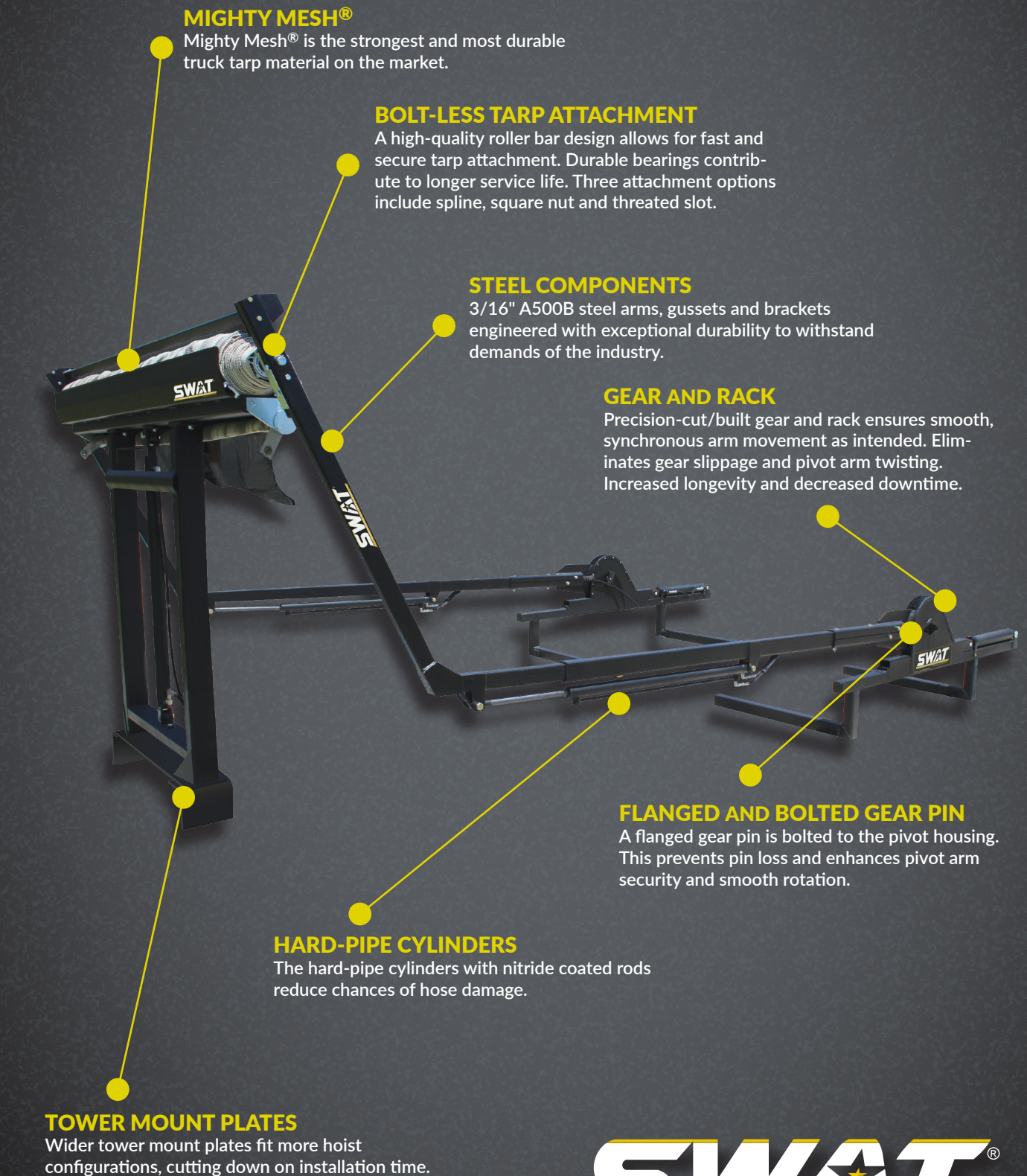

WWW.SHURCO.COM/SWAT

**PREMIUM ROLL-OFF TARP SYSTEM**

**SWAT**<sup>®</sup>  
PREMIUM ROLL-OFF TARP SYSTEM  
POWERED BY: SHUR-CO

# HIGH-VOLUME REPLACEMENT PARTS

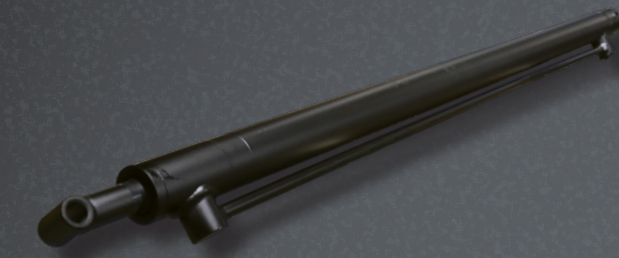

**LOWER ARM "HARD-PIPE" CYLINDER**  
 • P/N 1808892 Replaces Competitor P/N HR4752

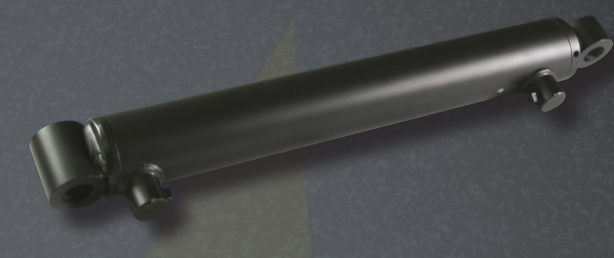

**RACK/PIVOT CYLINDER**  
 • P/N 1808890 Replaces Competitor P/N HR4719

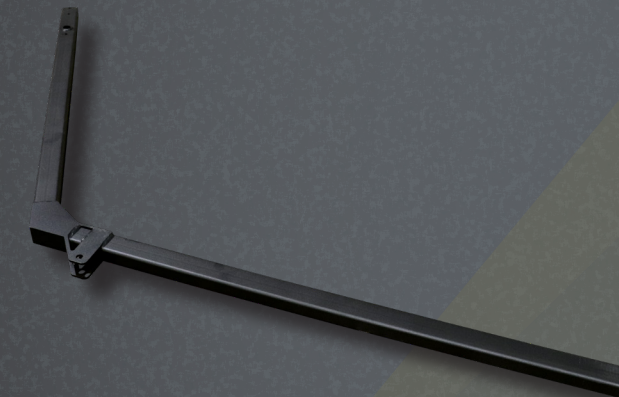

**UPPER "HOCKEY STICK" ARM**  
 • P/N 1808874 Replaces Competitor P/N HR4751



**LOWER "CYLINDER" ARM**  
 • P/N 1808879 Replaces Competitor P/N HR4750



**STABILIZER BAR**  
 • P/N 1808873 Replaces Competitor P/N HR4753

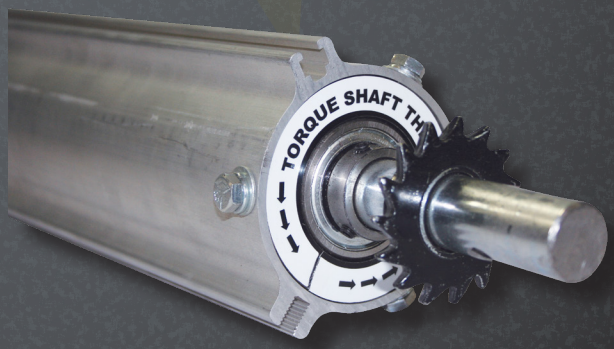

**ROLLER BAR**  
 • P/N 1803805 Replaces Competitor P/N HR47002C

## SYSTEM FEATURES

### GEAR AND RACK

- Precision Cut and Built Gear and Rack.

### HARD-PIPE CYLINDERS

- The Hard-Pipe Cylinders with Nitride Coated Rods Reduce Chances of Hose Damage.

### TARP TUBE

- One Person Quick Release Tarp Tube, with Standard Tube Spline for Easy Tarp Replacement.

### SPRING ROLLER BAR

- Industry Leading Extreme Use Spring Roller Bar.

### MIGHTY MESH®

- The Strongest Truck Tarp Material on the Market Today.

### LITEALL® WORK LIGHT

- Includes Mounting Brackets and Wiring Protection Tube are Pre-Installed.

## SYSTEM BENEFITS

- SWAT® Parts Directly Replace Most Competitor Parts.

- Secure Flanged/Bolted Pivot Gear Pins Prevent Loosening to Gear Over Time.

- 3/16" A500B Steel Arms, Gussets and Brackets Engineered with Exceptional Durability to Withstand Demands of the Industry.

- Low-Profile Arms Avoid Damage from Wide Containers and Compactors.

- Covers a Wider Range of Truck Container Sizes than Competitor Systems.

- SWAT® (Straight Arm) Covers 12'-16' OR 14'-18' Containers (Pivot Location Determines).

- SWAT® (Bent Arm) Covers 18'-21' Containers.

- SWAT® (Bent Arm) Covers 20'-22' Containers.

- Self-Contained Remote Control Operation.

- Includes Self-Contained Remote.

## DURABLE STEEL ARM SYSTEM



## REMOTE CONTROL



### SELF-CONTAINED REMOTE

SWAT® is available with a self-contained remote, making it the only steel arm pivot tarp system in the industry with remote options. The remote allow drivers to take safer positions with better visibility during tarp operation. Additionally, the self-contained design isolates the tarp's hydraulics, protecting the tarp system from debris or other possible contamination from the truck's hydraulics.

## SYSTEM WARRANTY

**6 YEAR\*** STEEL COMPONENTS AND TARP ROLLER SPRING

**1 YEAR\*** HYDRAULIC VALVES

**90 DAYS\*** TARP

\*Warranty against defects in material and workmanship. 6-YEAR non-prorated warranty covers entire system, excluding tarp. Tarp warranty: 90-DAYS from original Shur-Co® invoice date. Warranty details included in Owner's Manual.

## COMPLETE KITS

### CABLE HOIST

CONTAINER LENGTH	MIGHTY MESH® TARP	ARM STYLE	W/O WET KIT	WET KIT	SELF CONT. W/ REMOTE
12'-18'	8' x 28'	STRAIGHT ARM	1811710	1811712	1811714
	9' 8" x 28'	STRAIGHT ARM	1811711	1811713	1811715
18'-21'	8' x 28'	BENT ARM	1810407	1810409	1810411
	9' 8" x 28'	BENT ARM	1810408	1810410	1810412
20'-22'	8' x 28'	BENT ARM	1809616	1809618	1809621
	9' 8" x 28'	BENT ARM	1809617	1809619	1809622

### HOOK LIFT

CONTAINER LENGTH	MIGHTY MESH® TARP	ARM STYLE	W/O WET KIT	WET KIT	SELF CONT. W/ REMOTE	WET KIT HIGH PRESSURE
12'-18'	8' x 28'	STRAIGHT ARM	1811716	1811718	1811720	1811726
	9' 8" x 28'	STRAIGHT ARM	1811717	1811719	1811721	1811727
18'-21'	8' x 28'	BENT ARM	1810413	1810415	1810417	1810423
	9' 8" x 28'	BENT ARM	1810414	1810416	1810418	1810424
20'-22'	8' x 28'	BENT ARM	1809678	1809680	1809682	1809772
	9' 8" x 28'	BENT ARM	1809679	1809681	1809683	1809773

## TARPS

### MIGHTY MESH® FITS ALL TARPS

- 1801686 - 8' x 28'
- 1801674 - 8' x 28' w/Hook Lift Cutout

### MIGHTY MESH® TARPS W/FLAPS

- 1809640 - 9'8" x 28'
- 1801675 - 9'8" x 28' w/Hook Lift Cutout

### FEATURES

- Replacement Tarp Fits All Brands of Hydraulic Roll-Off Tarper
- Tapered Pocket End for Ease of Installation and Enhanced Appearance
- For Flap Tarps - Side Flaps on Tarp Extend Lateral Coverage
- For Flap Tarps - Pre-Installed Bungee Cord Retracts Flaps for Smooth Roll Up

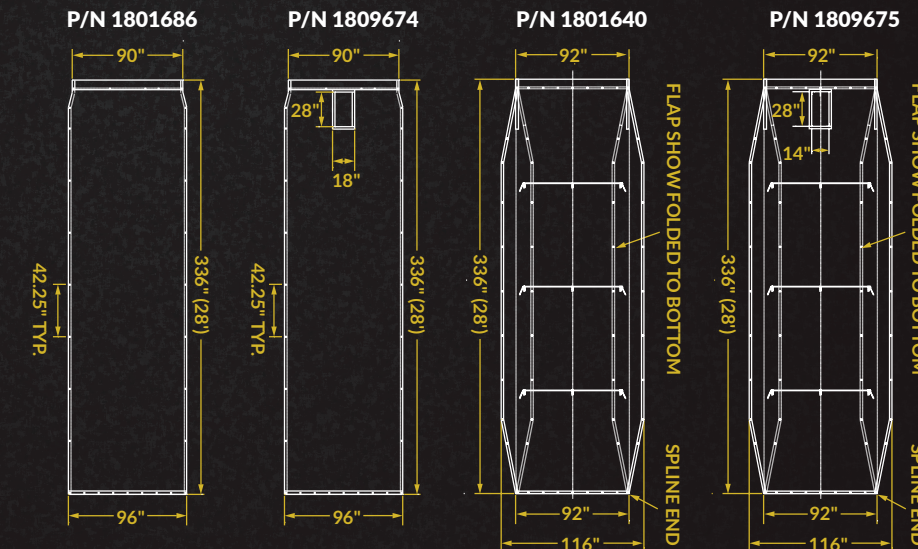

## QUICK LINKS

**SWAT® PRODUCT WEBSITE**  
 Always make sure you are receiving the most up to date product information by visiting [www.shurco.com/swat](http://www.shurco.com/swat).

**SHUR-CO® SALES TEAM**  
 Our team consistently strives to offer our customers superior products and exceptional service.

**WARRANTIES, PATENTS AND LEGAL**  
 Shur-Co® provides our customers with the most current information, visit [www.shurco.com/support](http://www.shurco.com/support).

**DEALER® LOCATOR**  
 Let us help you find an authorized Shur-Co® dealer in your area. For questions, call 1.800.437.4172.

DESCRIPTION	COMP. P/N	SHUR-CO® P/N	DESCRIPTION	COMP. P/N	SHUR-CO® P/N
SWAT® 20' to 22' Arm Kit - L		1809911	21 Square End Plug	HR4548A	1808846
SWAT® 20' to 22' Arm Kit - R		1809912	22 Gear/Pivot Assembly - 18' to 22' Container - L	HR4762A	1809355
SWAT® 18' to 21' Arm Kit - L		1811744	Gear/Pivot Assembly - 12' to 18' Container - L		1811496
SWAT® 18' to 21' Arm Kit - R		1811745	23 Gear/Pivot Assembly - 18' to 22' Container - R	HR4761A	1809360
SWAT® 12' to 18' Arm Kit - L		1811746	Gear/Pivot Assembly - 12' to 18' Container - R		1811497
SWAT® 12' to 18' Arm Kit - R		1811747	24 Pivot Pin Assembly	A3881KIT	1809284
Gantry Base Frame W/Telescoping Legs	HR4511	1809687	25 Rack Cylinder Mounting Pin	A3883	1808883
1 Stabilizer Bar	HR4753	1808873	26 Cylinder Loop Strap	HR4731	1808881
2 Roller Bar - SWAT®	H7002C	1803805	27 Rack Cylinder Connecting Pin	D18836	1809014
3 Tarp Roll Base Rest	HR4505-2	1808872	28 Castle Nut	HR4785	1809169
4 Tarp Tube Bracket Kit	HR4756	1810063	29 Pivot Hose Guide	HR4728	1809669
5 Tarp Tube Cap	HR4757	1809148	30 Hydraulic Cylinder - 2-1/2" Bore - 16" Stroke	HR4719	1808890
6 Ratchet Pawl	HR4788	1809209	31 Rack Gear	A3868B	1808886
7 Gantry Cylinder Clevis Eye	H7032	1808869	32 Brush Kit		1809776
8 Tarp Tube	HR4758-2	1808865	33 Crank Handle Assembly		1809177
9 Pawl Torsion Spring	HR4786	1808851	34 Upper Arm Assembly - L		1811491
10 Ratchet Pawl Bushing	HR4787	1808875	35 Upper Arm Assembly - R		1811492
11 Ratchet Guard Assembly - 18' to 22' Container	HR4789	1809009	36 Lower Arm Assembly - L		1810404
Ratchet Guard Assembly - 12' to 18' Container		1811487	37 Lower Arm Assembly - R		1810405
12 Upper Arm - 18' to 22' Container	HR4751	1808874	38 Ratchet Guard Assembly - 12' to 18' Container		1811487
Upper Arm - 12' to 18' Container		1811484	39 SWAT® SA Lower Arm		1810403
13 Gantry Telescoping Leg	HR4512	1808871	40 Hydraulic Hose - 1/4" x 16' x #6 - JICF One End		1808935
14 Clevis Pin - 1" OD	H7062	1809013	41 Hydraulic Fitting - #6 JICM x #6 ORBM x EL 90		1705725
15 Gantry Base Frame	HR4515	1808868	TARPS		
16 Gantry Cylinder - 2" Bore - 36" Stroke	HR4520	1808891	Mighty Mesh® w/Flaps - 9'8" x 28'	HR4616	1801640
17 Shaft Locking Collar - 1"	HR4624	1808855	Mighty Mesh® - 8' x 28'		1801686
18 SWAT® Lower Arm	HR4750	1808879	Mighty Mesh® w/Flaps & Hook Lift Cutout - 9'8" x 28'		1809675
SWAT® SA Lower Arm		1810403	Mighty Mesh® & Hook Lift Cutout - 8' x 28'		1809674
19 Lower Arm Cylinder - 1-1/2" Bore - 36" Stroke	HR4752	1808892			
20 Pivot Gear Arm	HR4760	1808887			

**ATTENTION:**  
 Utilizing non-Genuine Shur-Co® parts can void your warranty agreement.

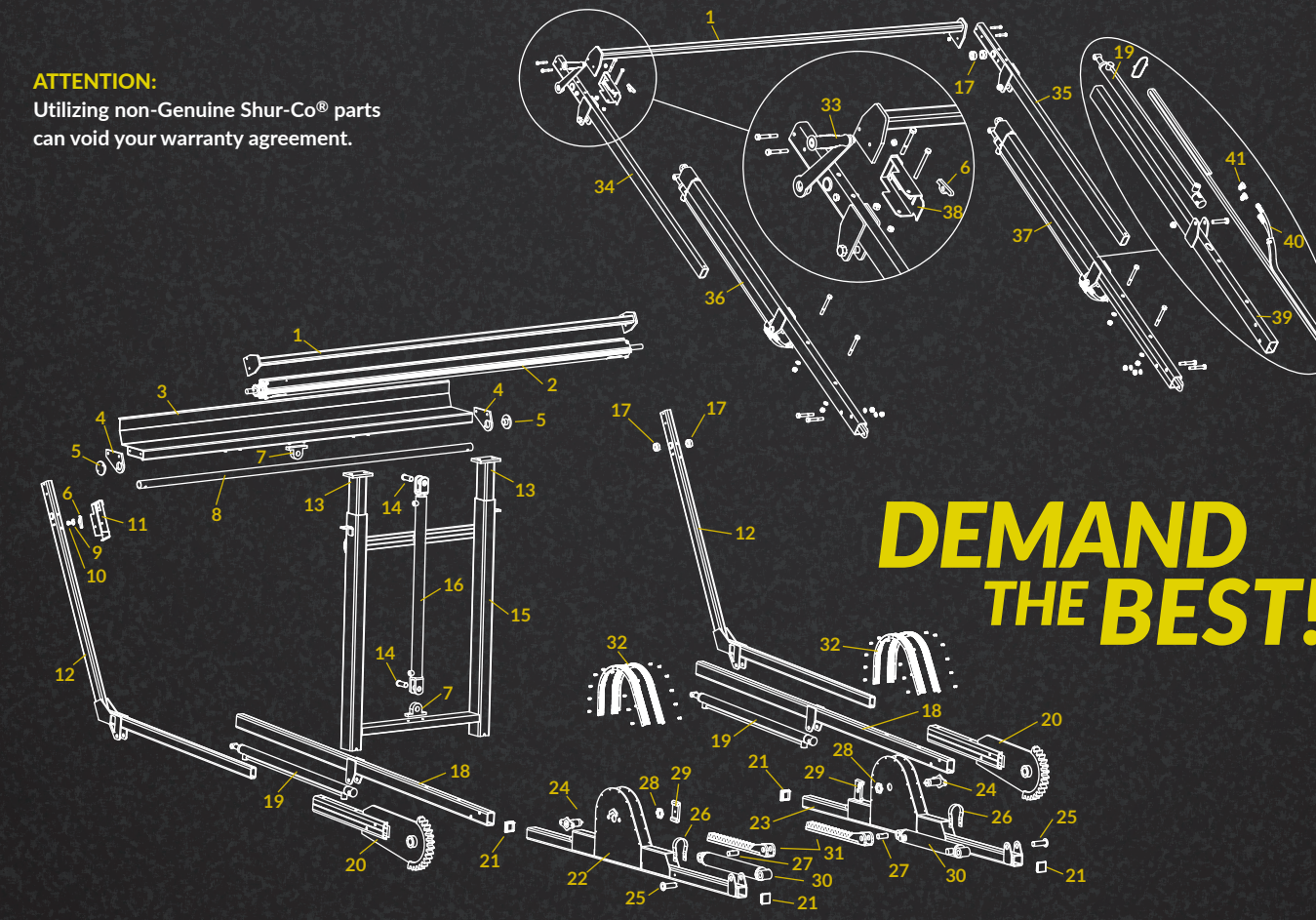

**DEMAND THE BEST!**